



Project _____
 AIA # _____ SIS # _____
 Item # _____ Quantity _____ C.S.I. Section 114000

TE Series

Freezer Equipment Stands
 Self-Contained
 Four Drawer Models



STANDARD PRODUCT FEATURES

- Stainless Steel Exterior & Interior
- Stainless Steel Top w/Drip Guard (Marine) Edge
- Reliable Microprocessor Control With LED Temperature Display
- Balanced, Self-Contained Refrigeration System Using R-448A
- Front-Breathing Design for "Zero-Clearance" Installation
- Non-Electric Automatic Condensate Evaporator
- Condenser Filter (protects coil)
- Hot Gas Defrost
- Controllable Anti-Condensate Drawer Perimeter Heaters
- Full Length Drawer Handle with Gasket Guard
- Magnetic Snap-In Drawer Gaskets
- Easily Removable Drawers Accomodate 12" x 20" x 6" Pans (pans by others)
- Self-Closing Drawers with Stay-Open Feature
- Heavy Gauge Stainless Steel Drawer Slides
- Side, Front & Rear Access Panel for Ease of Service & Maintenance
- NEMA 5-15P Plug with 9' Cord & Cord Retainer
- Set of Four (4) 4" Casters on Adjustable Caster System



Models listed to the applicable UL, CSA and NSF standards by an approved NRTL. Consult the factory or unit data plate for additional information.

ACCESSORIES & OPTIONS

- Set of 6" High Stainless Steel Legs in Lieu of Casters
- 6" Cabinet Length Extension
- Stainless Steel Exterior Finished Back

AVAILABLE CONFIGURATIONS

Two or Four Drawer Models, 34" Deep

Model

TE072LT
 TE084LT

Model Type

72" 4-Drawer Model
 84" 4-Drawer Model

Approved by _____ Date _____ Approved by _____ Date _____

MODELS

Four Drawer Models: TE072LT, TE084LT

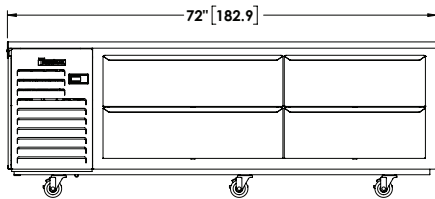
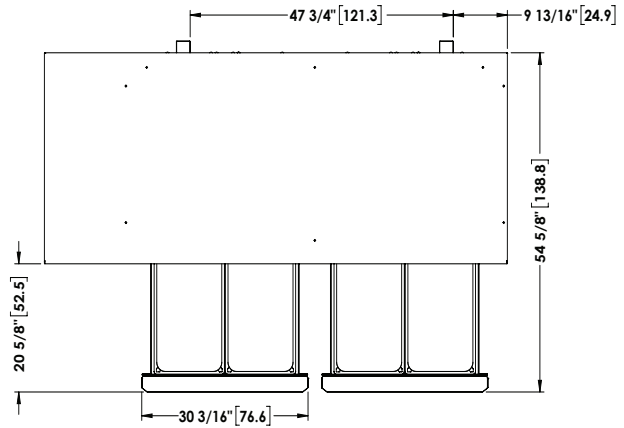
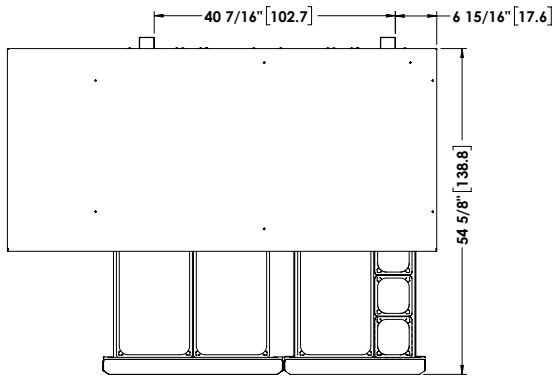

Elevation - TE072LT

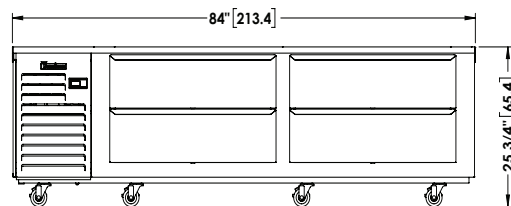

Elevation - TE084LT

Section - All Models

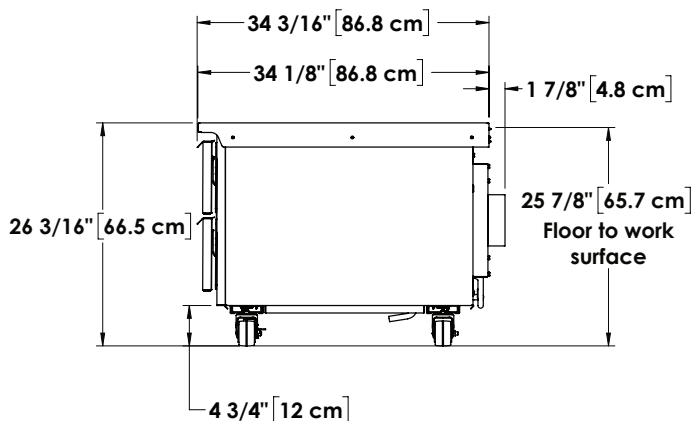

CAD and/or Revit Files Available

<https://traulsen.klccad.com/>



MODELS

TE072LT, TE084LT

MODELS	TE072LT	TE084LT
CABINET DIMENSIONAL DATA		
Length - Overall in.	72 (182.9 cm)	84 (213.4 cm)
Depth - Cabinet Only in.	32 (81.3 cm)	32 (81.3 cm)
Depth - Drawer Open in.	54 1/8 (137.5 cm)	54 1/8 (137.5 cm)
Depth - Over Handle in.	34 3/16 (86.8 cm)	34 3/16 (86.8 cm)
Height - Overall on 4" Casters ¹ in.	26 3/16 (66.5 cm)	26 3/16 (66.5 cm)
Max Top Load Capacity lbs.	1200 (544 kg)	1500 (680 kg)
Pan Capacity - 12" x 20" x 6"	6 ²	8
Pan Orientation	Side by Side	Side by Side
Drawers Per Cabinet	4	4
ELECTRICAL DATA		
Voltage	115/60/1	115/60/1
Plug	NEMA 5-15P	NEMA 5-15P
Full Load Amperes	11.2	11.2
MDEC ³	N/A	N/A
REFRIGERATION DATA		
Refrigerant	R-448A	R-448A
Refrigerant Amount oz.	21 (595.3 gr)	21 (595.3 gr)
BTU/HR HP ⁴	2570 1/2 HP	2570 3/4 HP
SHIPPING DATA		
Length - Crated in.	84 (213.4 cm)	108 (274.3 cm)
Width - Crated in.	42 (106.7 cm)	42 (106.7 cm)
Height - Crated in.	42 (106.7 cm)	35 (88.9 cm)
Volume - Crated cu. ft.	86 (2.4 cu m)	92 (2.6 cu m)
Weight - Crated lbs.	606 (275 kg)	675 (306 kg)

NOTES:

1. Height as measured without optional stainless steel work top.
2. TE072LT shown with pan capacity of six (6) 12" x 20" x 6" & an additional six (6) 1/6 size pans.
3. MDEC= Maximum Daily Energy Consumption
4. Based on a 90°F ambient and 20°F evaporator.

When ordering please specify: Voltage, Hinging, Options and any additional warranties.

Equipped with one NEMA 5-15P Plug



EQUIPMENT SPECIFICATIONS

CONSTRUCTION, HARDWARE, INSULATION

Cabinet exterior front, sides, louver assembly and drawers are constructed of heavy gauge stainless steel, exterior back and bottom are constructed of heavy gauge galvanized steel. Cabinet interior sides, top and bottom are constructed of heavy gauge stainless steel. A set of 4" high casters are included standard. Both the cabinet and drawers are insulated with an average of 2" thick high density, non-CFC foamed in place polyurethane.

SELF-CONTAINED REFRIGERATION SYSTEM

The left side mounted, self-contained, balanced refrigeration system using environmentally friendly, non-flammable R-448A refrigerant features a hot gas defrost, capillary tube, air-cooled hermetic compressor, automatic condensate evaporator, and a dedicated rear-mounted evaporator design which distributes cold air through each drawer section. A 9' cord and retainer is provided. Standard operating temperature is -5° to 0°F (-20° to -17°C).

CONTROL

The easy to use water resistant microprocessor control is supplied standard. It includes a 3-Digit LED Display, and a Fahrenheit or Celsius Temperature Scale Display Capability.

DRAWERS

Each heavy-duty drawer is designed to accommodate 12" x 20" x 6" deep pans. They are constructed using heavy gauge stainless steel drawer slides and 2" diameter stainless steel rollers. Drawers include both a self-closing and stay-open feature.

WARRANTY

Both a six year parts and labor warranty and a seven year compressor warranty (self-contained models only) are provided standard.