

"PBHS-09" PRO-BOWL HAND SINKS

Wall Mount, (1) 9"x9"x5" Deep Bowl - Space Saver

FEATURES:

- One Piece Deep Drawn Bowl
- All Sink Bowls Have Large Liberal Radii Corners
- Includes Basket Drain
- Splash Mount Faucet Holes 4" On-Center
- 1-1/2" Drain Plumbing Connection

SPECIFICATIONS:

- Bowl: Stainless Steel Tops Are TIG Welded, Exposed Welds Are Polished To Match Adjacent Surface
- Bowl: Type 300 Stainless Steel Polish, Satin Finish
- Bracket: Type 300 Stainless Steel Polish, Satin Finish
- Drain: 2" Drain Opening, With 1-1/2" NPS Outlet Connection

CERTIFICATIONS:



PBHS-W-0909

ACCESSORIES

MODEL

- Faucets
- ADA Wrist Blades
- Towel Dispenser
- Lever Wastes
- Over Flows
- P-Traps

"PBHS-0909" PRO-BOWL HAND SINKS

MODEL	BOWL SIZE (L X W X H)	OVERALL SINK SIZE (L X W X H)	FAUCET	WEIGHT (LBS)
PBHS-W-0909	9"x9"x5"	12"x14-1/2"x12-7/16"	N/A	5
PBHS-W-0909-P	9"x9"x5"	12"x14-1/2"x12-7/16"	PBF-4-SLF	9

ALL DIMENSIONS ARE TYPICAL. TOLERANCE +/- .500". JOHN BOOS & CO. RESERVES THE RIGHT TO CHANGE SPECIFICATIONS WITHOUT NOTICE.

DETAILED SPECIFICATIONS

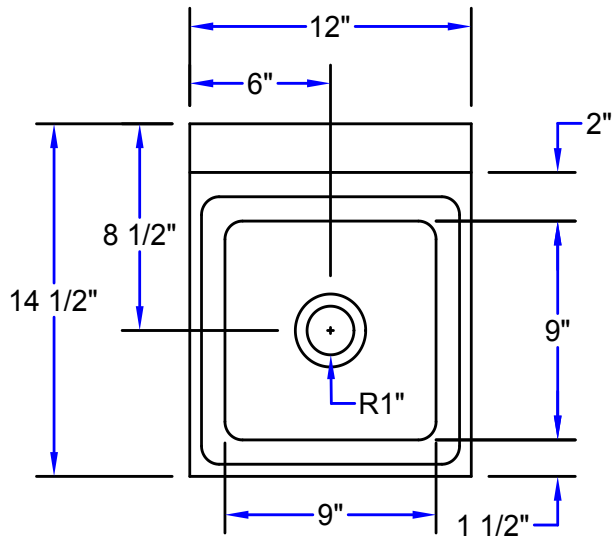

MOUNTING BRACKET

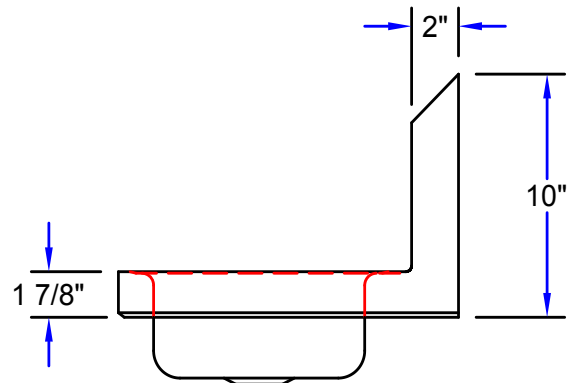
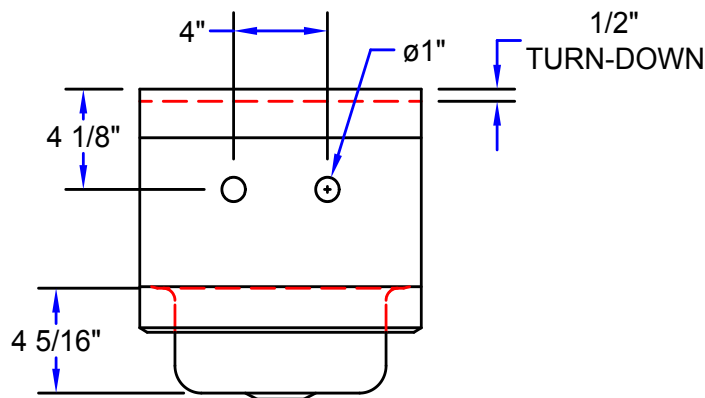
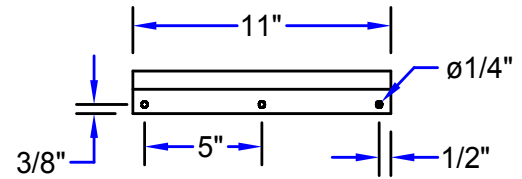

"PBHS-0909" PRO-BOWL HAND SINKS

MODEL	BOWL SIZE (L X W X H)	OVERALL SINK SIZE (L X W X H)	FAUCET	WEIGHT (LBS)
PBHS-W-0909	9"x9"x5"	12"x14-1/2"x12-7/16"	N/A	5
PBHS-W-0909-P	9"x9"x5"	12"x14-1/2"x12-7/16"	PBF-4-SLF	9

ALL DIMENSIONS ARE TYPICAL. TOLERANCE +/- .500". JOHN BOOS & CO. RESERVES THE RIGHT TO CHANGE SPECIFICATIONS WITHOUT NOTICE.