



Chef Tables - Hard Maple Top

Stainless Steel Cabinet Base Tables - No Doors

Certifications:



Shown With Optional Adjustable Shelf



Features:

- 1 3/4" Thick Hard Maple Bakers Top w/ Penetrating Oil Finish
- 1 5/8" x 6" Straight S/S Leg
- Legs Adjust 1" in Height
- 96" Units have a Center Mullion
- Casters Available

Material:

- Hard Maple Top
- T-304 18 ga. Stainless Steel Body
- Stainless Steel Legs & Feet

Options:

- Adjustable Shelf



| Length | 24" Width | 30" Width |
|--------|-----------|-----------|
| 18" | CMT-2418 | CMT-3018 |
| 24" | CMT-2424 | - |
| 30" | - | CMT-3030 |
| 36" | CMT-2436 | CMT-3036 |
| 48" | CMT-2448 | CMT-3048 |
| 60" | CMT-2460 | CMT-3060 |
| 72" | CMT-2472 | CMT-3072 |
| 96" | - | CMT-3096 |

* Has a Center Mullion

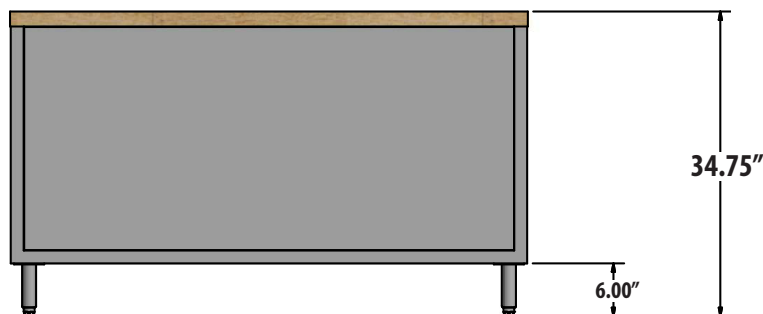
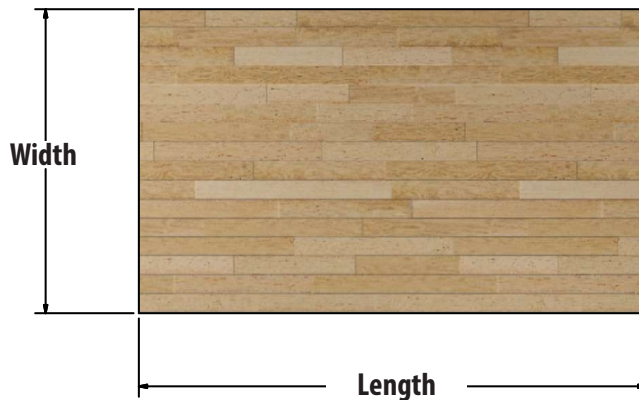

PRODUCT DATA SHEET

BK RESOURCES

