



Chef Tables - Maple Bakers Top with 4" Coved Riser

Stainless Steel Cabinet Base Tables - Sliding Doors

Certifications:



Features:

- 1 5/8" x 6" Straight S/S Leg
- 4" Coved Riser and Sides
- Sliding Doors
- Legs Adjust 1" in Height
- 96" Units have a Center Mullion with Two Sets of 48" Doors
- Casters Available

Material:

- Hard Maple Bakers Top
- T-304 18 ga. Stainless Steel Body
- Stainless Steel Legs & Feet

Options:

- Adjustable Shelf



Single Sided:

Length	24" Width	30" Width
36"	CMBT-2436S	CMBT-3036S
48"	CMBT-2448S	CMBT-3048S
60"	CMBT-2460S	CMBT-3060S
72"	CMBT-2472S	CMBT-3072S
96"	-	CMBT-3096S

Dual-Access (Doors on Both Sides):

Length	24" Width	30" Width
36"	CMBT-2436S2	CMBT-3036S2
48"	CMBT-2448S2	CMBT-3048S2
60"	CMBT-2460S2	CMBT-3060S2
72"	CMBT-2472S2	CMBT-3072S2
96"	-	CMBT-3096S2

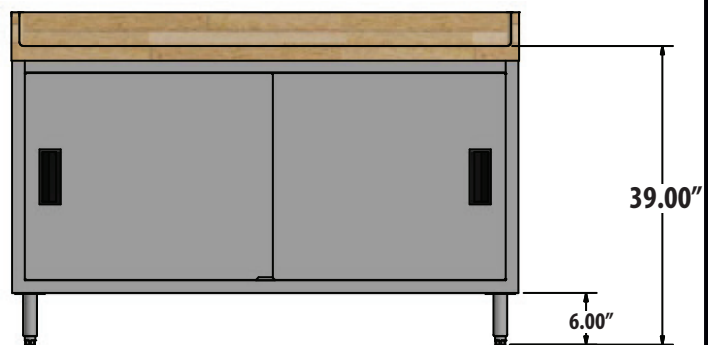

PRODUCT DATA SHEET

BK RESOURCES

