



Special Features:

- ✓ 23 cu. ft. storage capacity
- ✓ (2) solid swing doors with self-closing and 90° stay-open feature
- ✓ Locks & keys included for security
- ✓ -8°F – 0°F temperature range
- ✓ 2/3 HP bottom-mounted compressor
- ✓ Eco-friendly CFC-free R290 refrigerant
- ✓ (3) heavy-duty adjustable PVC-coated shelves
- ✓ Heavy-duty 4" casters with brakes (included)
- ✓ Durable stainless steel construction
- ✓ Freestanding installation
- ✓ 115V / 4.2 amps / NEMA 5-15P plug
- ✓ ETL & ETL-Sanitation certified, meets NSF-7 standards
- ✓ ENERGY STAR® certified for efficiency

Product Description:

The Empura 23 cu. ft. reach-in freezer delivers dependable, energy-efficient performance for commercial kitchens. Its stainless steel construction, self-closing solid door with a 90° stay-open feature, and three adjustable shelves provide durability and convenience. A bottom-mounted 2/3 HP compressor maintains a consistent -8°F to 0°F using eco-friendly R290 refrigerant, managed by a precise electronic control system. With a locking door, heavy-duty 4" casters, and ETL certification, this ENERGY STAR® unit is tested and conforms to NSF-7 standards, offering reliable, professional-grade frozen storage.

Intended For Commercial Use Only. Empura assumes no liability for component failure, factory defects or any other damages for units installed in non-commercial foodservice or residential applications.

About Empura Reach-In Freezers:

Empura reach-in freezers are built for the demands of commercial kitchens, featuring durable stainless steel construction and efficient, consistent cooling. Most models include solid swing doors with self-closing and stay-open functions, along with adjustable shelves for flexible storage. Using bottom-mounted compressors and eco-friendly refrigerants, they deliver reliable temperature control with strong energy efficiency. Empura units are tested and conform to NSF-7 standards & are ETL certified, providing dependable, professional-grade frozen storage.



TECHNICAL SPECS

Dimensions	
Overall Width	29"
Overall Depth	32.2"
Overall Height	82.5"
Storage Capacity	23 Cu. Ft.
Casters	4
Caster Height	4"
Refrigeration	
Refrigerant	R290
Temperature Range	-8°F - 0°F
Compressor Horsepower	2/3 HP
CFC Free	Yes
BTU (LBP)	N/A
Compressor Location	Bottom Mounted

Construction	
Display / Control Type	LED Display / Digital
Exterior Materials	430 Stainless Steel
Interior Materials	Sides 201 Stainless, Floor 304 Stainless
Shelves	PVC Coated
Number of Doors	1
Door Type	Solid
Door Hinge Location	Right
Number of Shelves	3
Installation	Freestanding
Electrical	
V / HZ / Phase	115v/60hz/1ph
Amps	4.2
Plug Type	NEMA 5-15P
Shipping	
Ship Weight	270 lbs.

UNIT VIEW

Front View

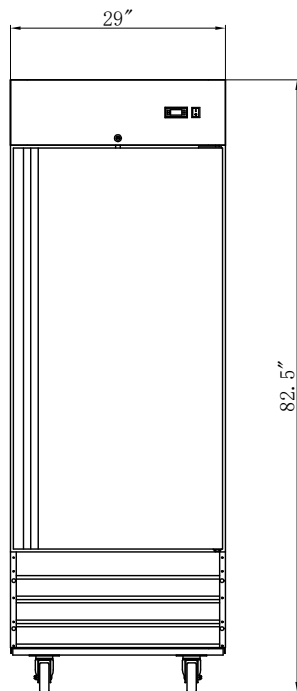

Side View

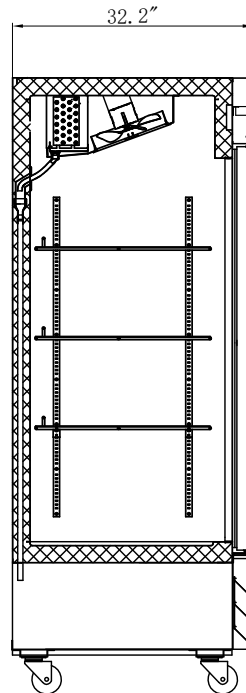

Top View

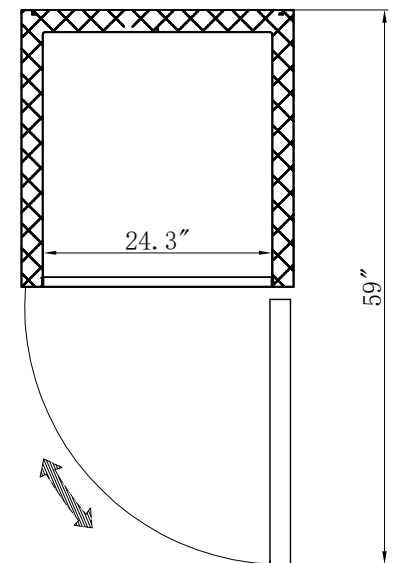

Attention CA Residents: This product can expose you to chemicals including lead, which are known to the State of California to cause cancer, birth defects, or other reproductive harm. For more information, go to www.p65warnings.ca.gov



NEMA 5-15P Plug:
This unit comes with a NEMA 5-15P plug