

# Addenda

PC Non-Refrigerated Pastry Case

**Structural Concepts®**

DELIVERING FRESH. ALWAYS.™

- **PC3982** 41"L x 39"D x 83-1/4"H
- **PC5682** 58"L x 39"D x 83-1/4"H
- **PC7482** 76"L x 39"D x 83-1/4"H

## Included

- 12" Straight blade power cord
- Angled mirror in upper display
- Clear glass swinging doors (self-closing)
- LED 3500K top & shelf lights
- Levelers
- One year parts & labor warranty
- PC5682 holds (15) 18" x 26" trays
- PC7482 holds (20) 18" x 26" trays
- Shelving removable and adjustable on 1" centers



PC5682

Specify	Standard Features	Additional Options
<b>EXTERIOR COLOR</b>	• Laminate (stock colors)	• Laminate (non-stock colors) • Powder coated stock color (specify RAL # or description)
<b>INTERIOR COLOR</b>	• Black	• White
<b>BASE</b>	• Straight base	• Angled base
<b>END PANELS</b>	• Full end panel w/mirror interior	• Cutaway w/glass • None (specify per line-up)
<b>HEADER</b>	<sup>1</sup> • Flat	<sup>1</sup> • Curved
<b>LOWER FRONT STORAGE</b>	• None	• Front storage w/ lift-up door
<b>PACKAGE LEDGE</b>	• Recessed open storage w/o waste bin	• Recessed open storage w/ waste bin
<b>REAR STORAGE</b>	• Open	• Dry storage w/ sliding solid doors
<b>REAR DOORS</b>	• None (solid back panel)	• Reflective glass rear sliding doors
<b>SHELVING</b>	• Tray support lighted shelves, (trays not included)	• Wire rack shelves, lighted
<b>MISCELLANEOUS</b>		• Header exhaust fans • Seal between doors • Second year parts & labor warranty
<b>ACCESSORIES</b>		• Price tag molding (matches interior color)

Std Notes: 1 - Laminated Only

Option Notes: 1 - Painted Only

<b>Intended Environment:</b> Type I - Designed to operate in ambient conditions of 75°F with 55% relative humidity unless noted otherwise in system information below.		
<b>Zone</b>	<b>Intended Product To Be Displayed</b>	<b>Warmest Avg Prod Temp ° F</b>
1	Unpackaged non-refrigerated products	Ambient

### PLAN VIEW

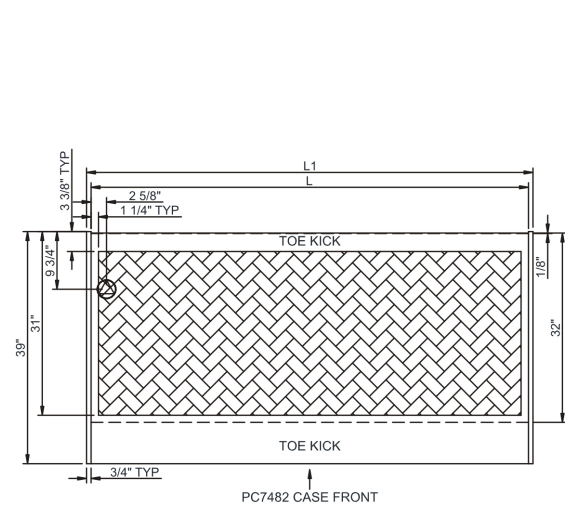

### SIDE VIEW

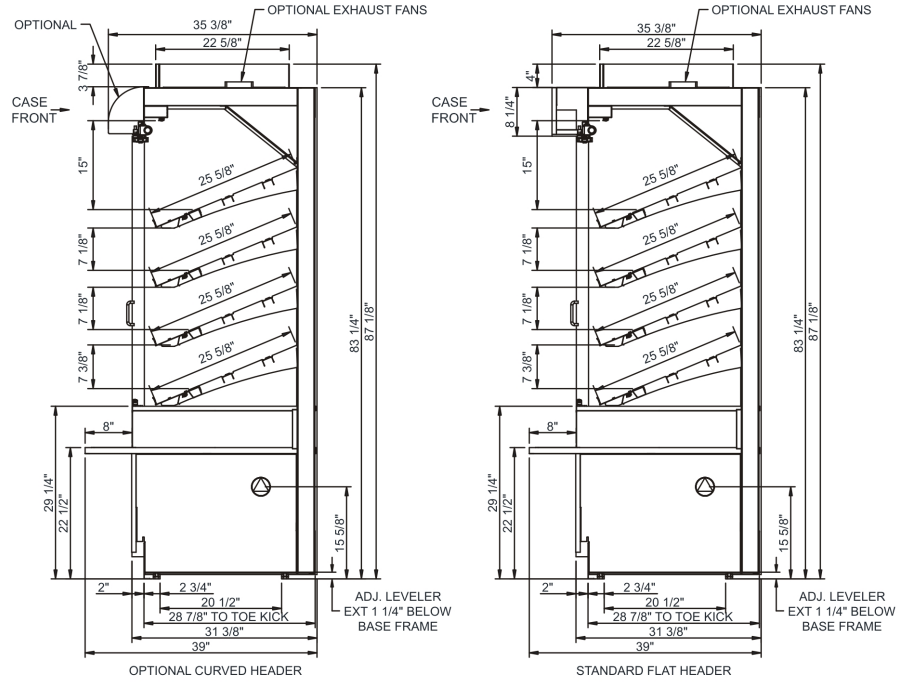

**NOTE: ALL DIMENSIONS APPROXIMATE**

- ELECTRICAL JUNCTION BOX (SUPPLIED WITH 6" LEADS OR POWER CORD).
- LOCATION OF DRAIN TUBE FOR REMOTE REF. ONLY (SUPPLIED WITH 3/4" OR 1 1/2" PVC TUBE).

- REFRIGERATION LINE CONNECTION.
- REMOTE FLOOR SINK & UTILITIES ACCESS AREA.

- SELF-CONTAINED CASE SERVICE ACCESS AREA.
- DRY CASE SERVICE ACCESS AREA.

Model Technical Specifications																
Model	L"	L1"	L2"	System Circuit Volts			Phs	Freq	Amps ***	Watts	Wires	NEMA Plug	SST	Conv. Rack RTUH	Para. Rack RTUH	Est Wt
PC3982	39.00	41.00	.00	Ambient/Lights (N/A)	Circuit #1	110-120	1	60	1.06	117	2+G	5-15P	N/A	N/A	N/A	700
				Ambient/Lights (N/A)	Circuit #1	208-240	1	50	0.47	242	2+G	Leads Single	N/A	N/A	N/A	
PC5682	56.00	58.00	.00	Ambient/Lights (N/A)	Circuit #1	110-120	1	60	1.52	160	2+G	5-15P	N/A	N/A	N/A	1,050
PC7482	74.00	76.00	.00	Ambient/Lights (N/A)	Circuit #1	110-120	1	60	1.77	200	2+G	5-15P	N/A	N/A	N/A	1,250

\*\*\* Does not include electric defrost on freezer models.

Regulatory Approvals:	
All Models	ETL Listed to UL 65 ETL Sanitation to NSF/ANSI 2



### Important Notes:

- 1) ELECTRICAL NOTE: If GFCI is required, a GFCI breaker MUST be used in lieu of a GFCI receptacle.
- 2) 40" minimum door entry clearance required (without shipping skid).
- 3) Units are supplied with levelers which must be adjusted during installation to ensure the unit is level and plumb.
- 4) Dimensions reflect levelers extended 1-1/4".

**⚠ WARNING:** This product can expose you to chemicals, including Urethane (Ethyl Carbamate), which are known to the State of California to cause cancer and birth defects or other reproductive harm. For more information go to [www.P65Warnings.ca.gov](http://www.P65Warnings.ca.gov).