

Product Specifications Refrigerator Chef Bases

- Create the ultimate chef station by stacking additional equipment on top, from grills to ovens and more
- Our trusted chef bases give staff the confidence of keeping ingredients fresh
- Casters (2 locking) included for easy mobility



UCRB536-SS61A



UCRB548-SS61A



UCRB560-SS61A



UCRB572-SS61A

Model	Description	Cooled Volume	Voltage/Hz/Phase/Amps	Shipping Weight
UCRB536-SS61A	36" Refrigerator Chef Base	4 cu ft	115v / 60hz / 1 / 7.3	340 lb
UCRB548-SS61A	48" Refrigerator Chef Base	6.7 cu ft	115v / 60hz / 1 / 7.3	410 lb
UCRB560-SS61A	60" Refrigerator Chef Base	10 cu ft	115v / 60hz / 1 / 7.3	549 lb
UCRB572-SS61A	72" Refrigerator Chef Base	13 cu ft	115v / 60hz / 1 / 8.7	653 lb

Specifications

UCRB536-SS61A dimensions: 26" H x 36" W x 32 1/2" D

UCRB548-SS61A dimensions: 26" H x 48" W x 32 1/2" D

UCRB560-SS61A dimensions: 26" H x 60" W x 32 1/2" D

UCRB572-SS61A dimensions: 26" H x 72" W x 32 1/2" D

UCRB536-SS61A: 2 drawers holds (2) standard size GN1/1 (12"x20"x4") pans (not included), top holds a static weight of 847 lb

UCRB548-SS61A: 2 drawers holds (4) standard size GN1/1 (12"x20"x4") pans (not included), top holds a static weight of 1508 lb

UCRB560-SS61A: 2 drawers holds (4) standard size GN1/1 (12"x20"x4") pans (not included), top holds a static weight of 1482 lb

UCRB572-SS61A: 4 drawers holds (8) standard size GN1/1 (12"x20"x4") pans (not included), top holds a static weight of 1411 lb

AISI 304 stainless steel interior and exterior

Autodefrost

CFC-free high-density polyurethane insulated cabinet

Electronic digital temperature control with alarms

Environmentally friendly R449a refrigerant - 16 oz (0.450 kg)

Factory pre-wired for dedicated outlet, 11 ft cord and plug included NEMA 5-15P

High efficiency compressor, side mount

High efficiency evaporator coil & condenser

NSF/ANSI Standard 7 compliant

Self-lubricating, sealed cast iron evaporator fan motor with high volume airflow design

Temperature range: 28°F to 46°F



Product Specifications • Refrigerator Chef Bases

Front (36" Model)

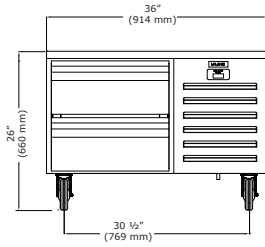

Side

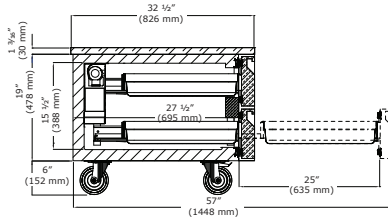

Top

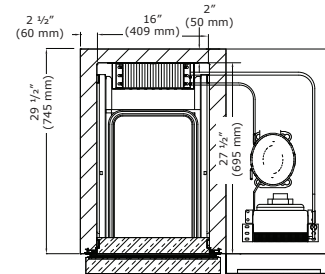

Front (48" Model)

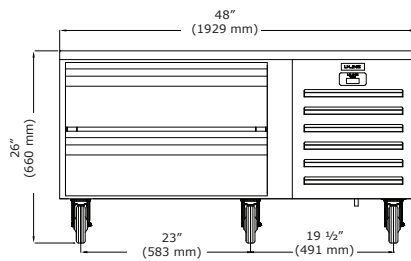

Side

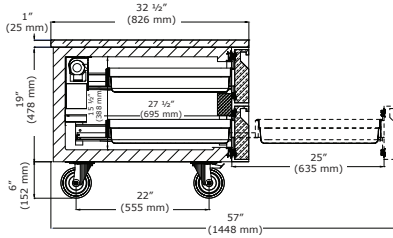

Top

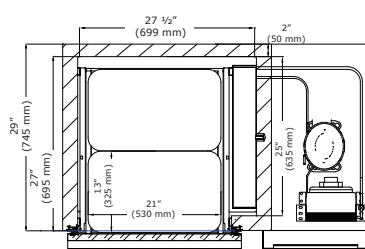

Front (60" Model)

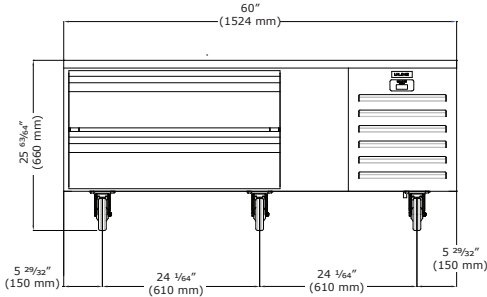

Side

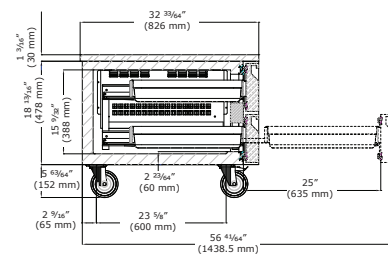

Top

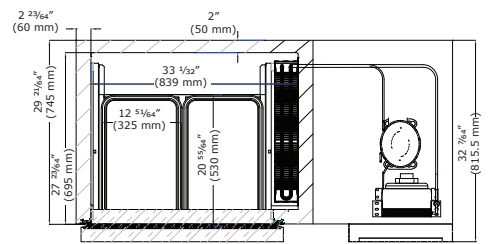

Front (72" Model)

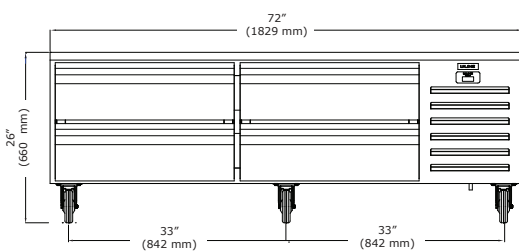

Side

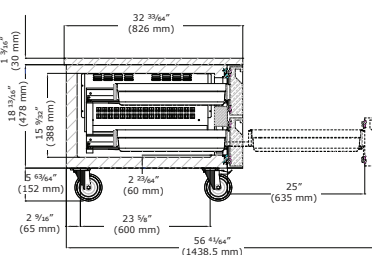

Top

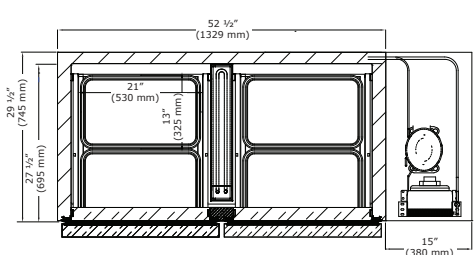

Commercial Warranty

3 Year (parts & labor) / 5 year sealed system (parts)
See complete warranty for details

