

# Reveal<sup>®</sup> Service Counter Design Guide

P/N 20-80683

**SECTION A: SERVICE CASES WITH EXHAUST GRILLE(S) AT OPPOSITE SIDE OF INTAKE**  
**SECTION B: SERVICE CASES WITH EXHAUST GRILLE(S) AT INTAKE SIDE OF CASE**

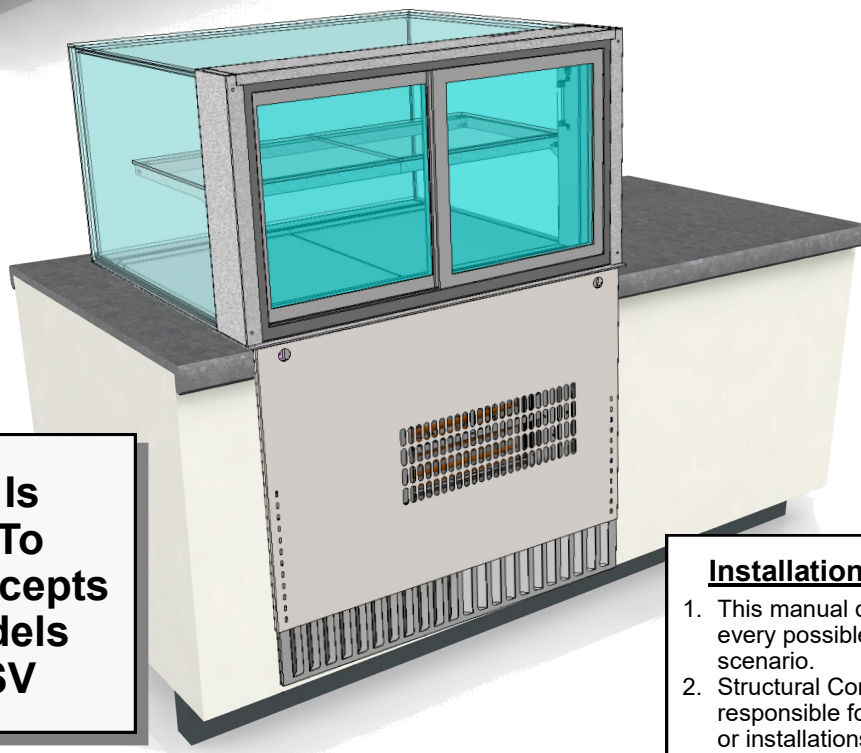
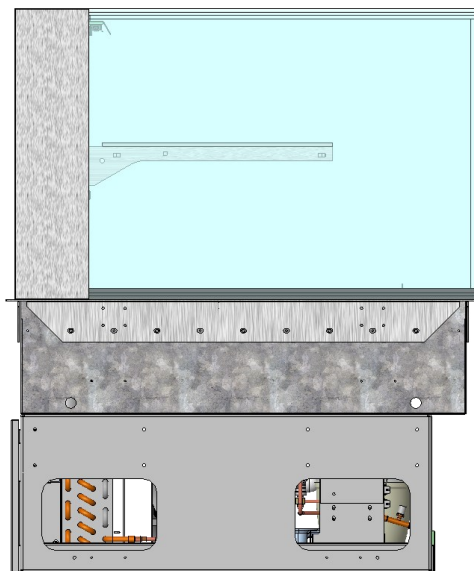
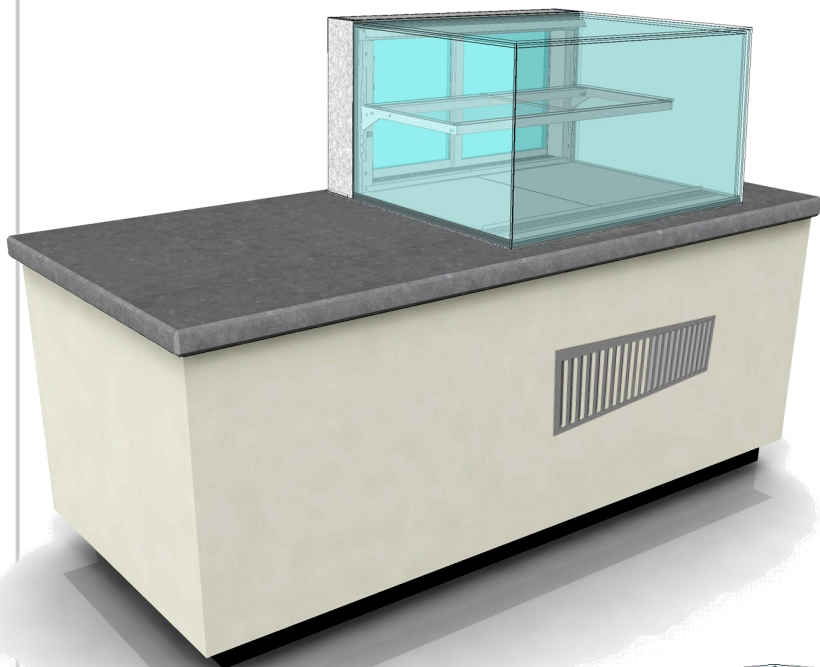

**This Guide Is  
Applicable To  
Structural Concepts  
Reveal<sup>®</sup> Models  
NE(L)(H)RSV**

### **Installation/Design Notes**

1. This manual does NOT cover every possible installation scenario.
2. Structural Concepts is not responsible for incorrect designs or installations.
3. Contact Technical Support with design or installation questions.

**Structural Concepts<sup>®</sup>**

DELIVERING FRESH. ALWAYS.™ Structural Concepts Corp. · 888 E. Porter Rd · Muskegon, MI 49441 Phone: 231.798.8888 Fax: 231.798.4960 · www.structuralconcepts.com

## TABLE OF CONTENTS

TABLE OF CONTENTS .....	2
OVERVIEW .....	3
<b>SECTION A: UNITS WITH EXHAUST GRILLE AT OPPOSITE SIDE OF INTAKE .....</b>	<b>4</b>
<b>SERVICE TOP CUTOUT DIMENSIONS / MINIMUM AIRFLOW INTAKE &amp; EXHAUST REQUIREMENTS .....</b>	<b>5</b>
<b>AIRFLOW CLEARANCE REQUIREMENTS .....</b>	<b>6</b>
<b>AIRFLOW CLEARANCE REQUIREMENTS - REAR INTAKE TO FRONT EXHAUST GRILLE ONLY .....</b>	<b>7</b>
<b>AIRFLOW CLEARANCE REQUIREMENTS - REAR INTAKE TO FRONT TOE-KICK EXHAUST ONLY .....</b>	<b>8</b>
<b>AIRFLOW CLEARANCE REQUIREMENTS - FRONT INTAKE TO REAR EXHAUST GRILLE ONLY ...</b>	<b>9</b>
<b>SECTION B: UNITS WITH EXHAUST GRILLE AT INTAKE SIDE OF CASE .....</b>	<b>10</b>
<b>SERVICE TOP CUTOUT DIMENSIONS / MINIMUM AIRFLOW INTAKE &amp; EXHAUST REQUIREMENTS .....</b>	<b>11</b>
<b>AIRFLOW CLEARANCE REQUIREMENTS - INTAKE AND EXHAUST AT REAR (DESIGN IS APPLICABLE TO INTAKE &amp; EXHAUST AT FRONT) .....</b>	<b>12</b>
<b>AIRFLOW CLEARANCE REQUIREMENTS - REAR INTAKE TO REAR EXHAUST ONLY .....</b>	<b>13</b>
<b>AIRFLOW CLEARANCE REQUIREMENTS - FRONT INTAKE TO FRONT EXHAUST ONLY .....</b>	<b>14</b>

## OVERVIEW

1. THE IDEAL CONDITION FOR REAR OF CABINET IS TO HAVE COMPLETE OPEN SPACE (WITH NO DOORS OR BLOCKING OF AIRFLOW WHATSOEVER).
2. SHOULD CABINET DOORS BE DESIRED, LOUVERS (OR SCREENING) MUST BE PROVIDED THAT MEET AIRFLOW & EXHAUST REQUIREMENTS LISTED IN THIS GUIDE.
3. THE MERCHANDISERS LISTED HEREIN HAVE SPECIFIC 'MINIMUM' VENTILATION REQUIREMENTS. ADDITIONAL VENTILATION IS RECOMMENDED TO MAINTAIN ACCEPTABLE MERCHANDISING TEMPERATURES.
4. UNITS WITH REAR CONDENSER PACKAGE SLIDE-OUT MUST MAINTAIN AT LEAST 36" SPACE BETWEEN CABINET REAR AND WALL (TO ALLOW FOR SERVICE).
5. UNITS WITH FRONT CONDENSER PACKAGE SLIDE-OUT (AND EXHAUST GRILLES AT OPPOSITE SIDE OF INTAKE) MUST MAINTAIN AT LEAST 3" SPACE BETWEEN CABINET REAR AND WALL TO ALLOW FOR PROPER AIRFLOW.
6. CABINET MUST BE CONSTRUCTED TO HOLD THE WEIGHT OF THE CASE. CASE IS SUPPORTED ON THREE SIDES (FRONT/LEFT/RIGHT) BY A TRIM RING.

**SECTION A:  
UNITS WITH  
EXHAUST  
GRILLES AT  
OPPOSITE  
SIDE OF  
INTAKE**

## SERVICE TOP CUTOUT DIMENSIONS / MINIMUM AIRFLOW INTAKE & EXHAUST REQUIREMENTS

### MINIMUM AIRFLOW INTAKE & EXHAUST REQUIREMENTS / SERVICE TOP CUTOUT DIMENSIONS

MODELS	A*	B**	MODELS	A*	B**
NE3613RSV	1 1/2" MINIMUM	35"	NE6013RSV	1 1/2" MINIMUM	59"
NE3620RSV	1 1/2" MINIMUM	35"	NE6020RSV	1 1/2" MINIMUM	59"
NE3627RSV	1 1/2" MINIMUM	35"	NE6027RSV	1 1/2" MINIMUM	59"
NE3635RSV	1 1/2" MINIMUM	35"	NE6035RSV	1 1/2" MINIMUM	59"
NE4813RSV	1 1/2" MINIMUM	47"	NE7213RSV	1 1/2" MINIMUM	71"
NE4820RSV	1 1/2" MINIMUM	47"	NE7220RSV	1 1/2" MINIMUM	71"
NE4827RSV	1 1/2" MINIMUM	47"	NE7227RSV	1 1/2" MINIMUM	71"
NE4835RSV	1 1/2" MINIMUM	47"	NE7235RSV	1 1/2" MINIMUM	71"

\* 1 1/2" MINIMUM FROM OUTSIDE EDGE OF COUNTER SURFACE TO CUTOUT  
 \*\* COUNTER SURFACE CUTOUT WIDTH

### AIRFLOW INTAKE & EXHAUST REQUIREMENTS

MODEL	MINIMUM INTAKE (in <sup>2</sup> )~	MINIMUM EXHAUST (in <sup>2</sup> )~
ALL MODELS	96	132

~ IF AIRFLOW IS SUBJECT TO A TORTURED' (CIRCUITOUS) ROUTE, YOU MUST INCREASE LISTED VALUES BY 25%.

IMPORTANT! YOU MUST  
CONSTRUCT BASE TO DIVERT  
EXHAUST AWAY FROM INTAKE!

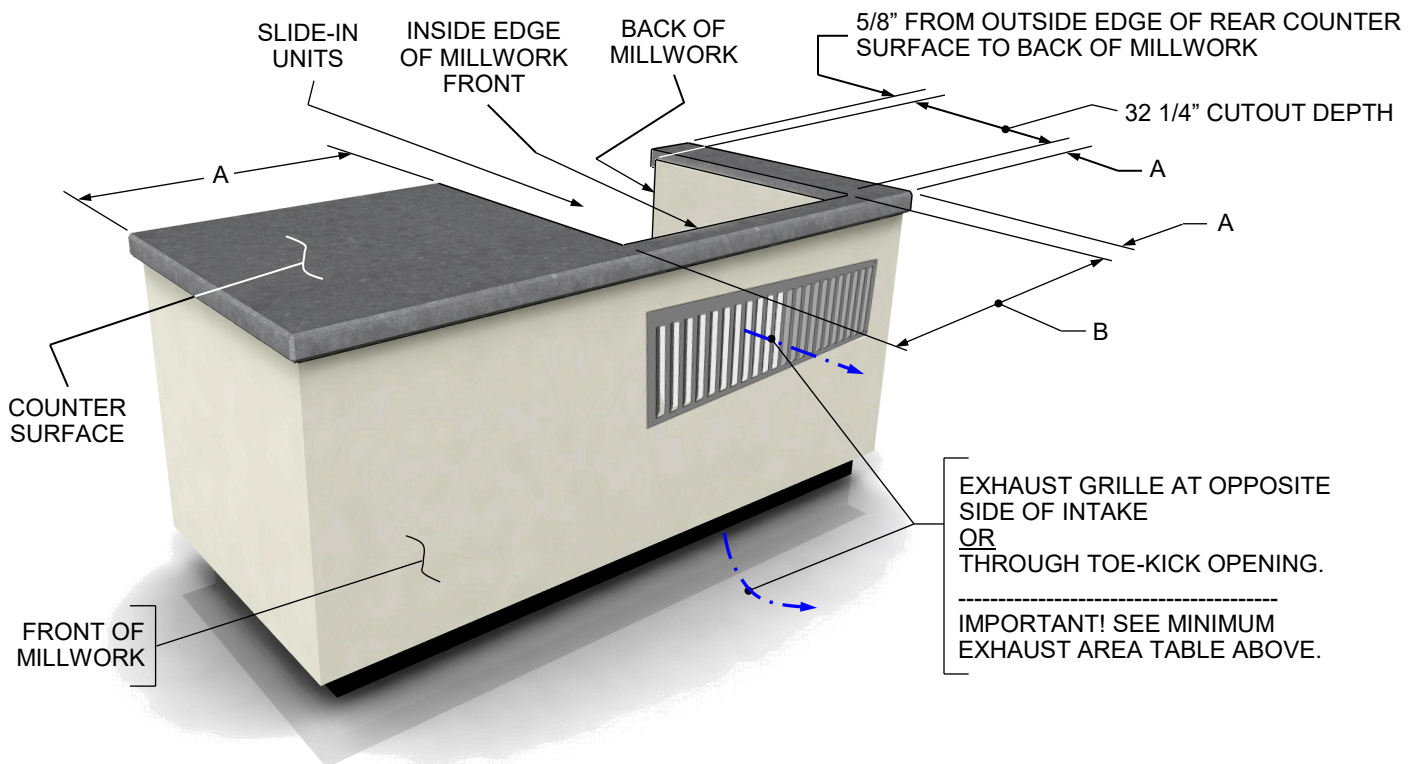

## AIRFLOW CLEARANCE REQUIREMENTS

### AIRFLOW CLEARANCE REQUIREMENTS

- 1 Cabinetry MUST provide access space to allow rear slide-out of condenser package (or front slide-out package, depending upon options chosen). You must carefully measure before building!
- 2 Note: Rear condenser package access is shown. However, instructions are also applicable to front access units.

### SPACE REQUIREMENTS FROM CUTOUT OF COUNTER TO EXHAUST GRILLE

MODEL	DISTANCE FROM CUTOUT OF INNER COUNTER SURFACE TO EDGE OF FRONT EXHAUST GRILLE*	MODEL	DISTANCE FROM CUTOUT OF INNER COUNTER SURFACE TO EDGE OF FRONT EXHAUST GRILLE*
NE3613RSV	7 1/2"	NE6013RSV	25 1/2"
NE3620RSV	7 1/2"	NE6020RSV	25 1/2"
NE3627RSV	7 1/2"	NE6027RSV	25 1/2"
NE3635RSV	7 1/2"	NE6035RSV	25 1/2"
NE4813RSV	13 1/2"	NE7213RSV	25 1/2"
NE4820RSV	13 1/2"	NE7220RSV	25 1/2"
NE4827RSV	13 1/2"	NE7227RSV	25 1/2"
NE4835RSV	13 1/2"	NE7235RSV	25 1/2"

### AIRFLOW INTAKE & EXHAUST REQUIREMENTS

MODEL	MINIMUM INTAKE (in <sup>2</sup> )~	MINIMUM EXHAUST (in <sup>2</sup> )~
ALL MODELS	96	132

~ IF AIRFLOW IS SUBJECT TO A 'TORTURED' (CIRCUITOUS) ROUTE, YOU MUST INCREASE LISTED VALUES BY 25%.

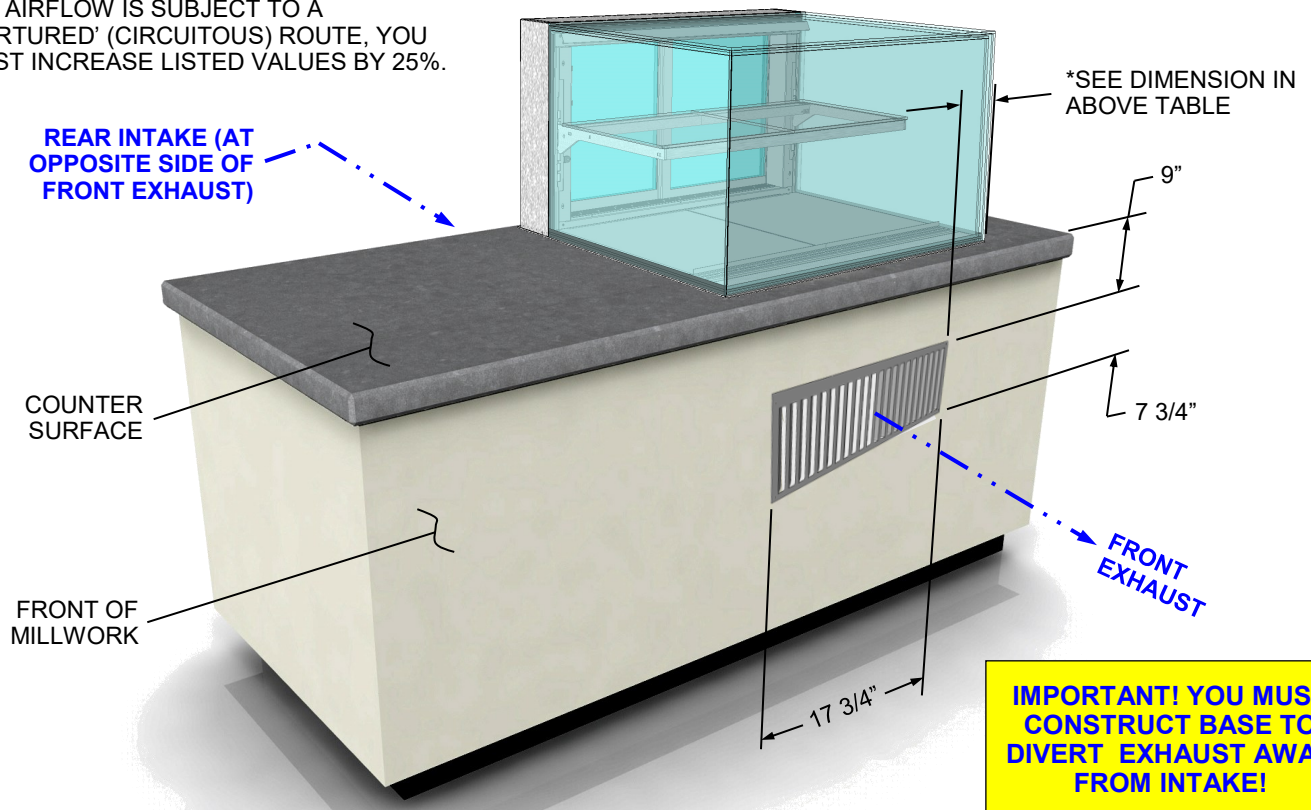

--- Airflow Clearance Requirements ---

(Note: Unit With Rear Condenser Package Access Shown / Instructions Are Applicable to Units With Front Condenser Package Access) ---

## AIRFLOW CLEARANCE REQUIREMENTS - REAR INTAKE TO FRONT EXHAUST ONLY

### AIRFLOW CLEARANCE REQUIREMENTS

1	9 1/2" maximum countertop/fascia enclosure space allowed on cabinets or counter for condenser package slide-out.
2	36" minimum opening at back of cabinet or counter required to allow condenser package to slide out from under case.

### AIRFLOW INTAKE & EXHAUST REQUIREMENTS

MODEL	MINIMUM INTAKE (in <sup>2</sup> )~	MINIMUM EXHAUST (in <sup>2</sup> )~
ALL MODELS	96	132

**IMPORTANT! YOU MUST  
CONSTRUCT BASE TO  
DIVERT EXHAUST  
AWAY FROM INTAKE!**

~ IF AIRFLOW IS SUBJECT TO A TORTURED' (CIRCUITOUS) ROUTE, YOU MUST INCREASE LISTED VALUES BY 25%.

--- CASE SIDE VIEW ---

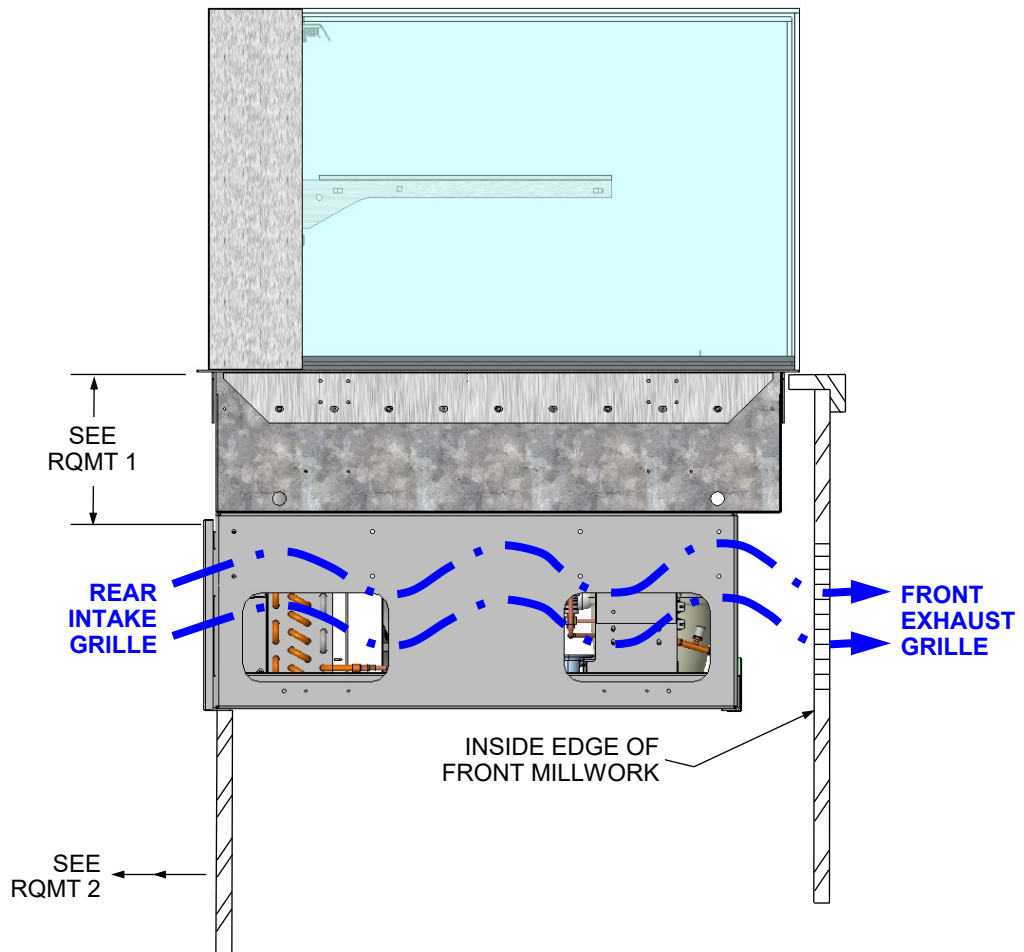

**--- Airflow Clearance Requirements ---  
(Side View / Pre-Install) / Model NE3620RSV Is Shown Above /  
Your Model May Vary**



## AIRFLOW CLEARANCE REQUIREMENTS - REAR INTAKE TO FRONT TOE-KICK EXHAUST ONLY

### AIRFLOW CLEARANCE REQUIREMENTS - FRONT TOE-KICK EXHAUST ONLY

1	9 1/2" maximum countertop/fascia enclosure space allowed on cabinets or counter for condenser package slide-out.
2	36" minimum opening at back of cabinet or counter required to allow condenser package to slide out from under case.
3	1 1/2" minimum space from sides of case to internal sides of cabinetry is required for adequate airflow for units with front toe-kick exhaust only.
4	2 3/4" minimum unobstructed toe-kick opening is required for adequate airflow for units with front toe-kick exhaust only.

### AIRFLOW INTAKE & EXHAUST REQUIREMENTS

MODEL	MINIMUM INTAKE (in <sup>2</sup> )~	MINIMUM EXHAUST (in <sup>2</sup> )~
ALL MODELS	96	132

~ IF AIRFLOW IS SUBJECT TO A TORTURED' (CIRCUITOUS) ROUTE, YOU MUST INCREASE LISTED VALUES BY 25%.

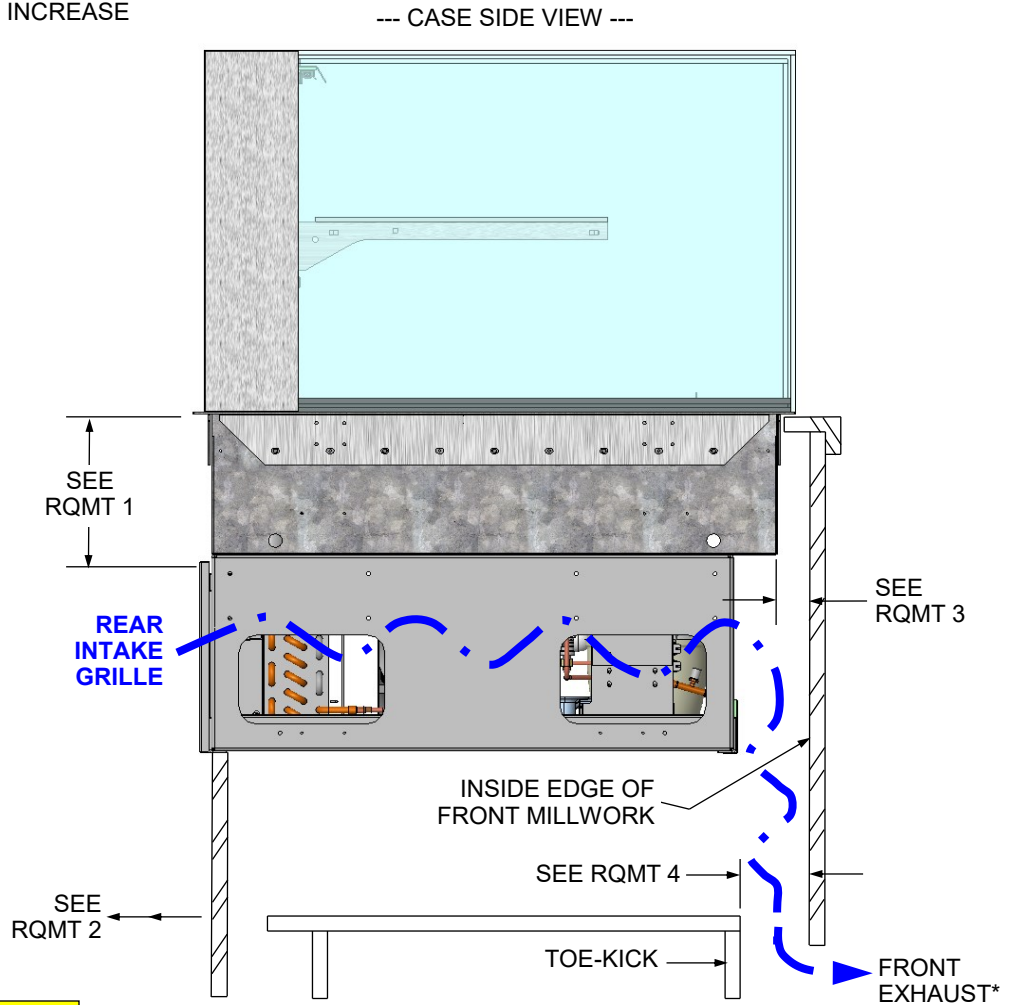

**IMPORTANT! YOU MUST CONSTRUCT BASE TO DIVERT EXHAUST AWAY FROM INTAKE!**



## AIRFLOW CLEARANCE REQUIREMENTS - FRONT INTAKE TO REAR EXHAUST ONLY

### AIRFLOW CLEARANCE REQUIREMENTS

1	9 1/2" maximum countertop/fascia enclosure space allowed on cabinets or counter for condenser package slide-out.
2	3" minimum space from rear of case to wall for adequate airflow.

### AIRFLOW INTAKE & EXHAUST REQUIREMENTS

MODEL	MINIMUM INTAKE (in <sup>2</sup> )~	MINIMUM EXHAUST (in <sup>2</sup> )~
ALL MODELS	96	132

~ IF AIRFLOW IS SUBJECT TO A 'TORTURED (CIRCUITOUS) ROUTE, YOU MUST INCREASE LISTED VALUES BY 25%.

**IMPORTANT! YOU MUST  
CONSTRUCT BASE TO DIVERT  
EXHAUST AWAY FROM INTAKE!**

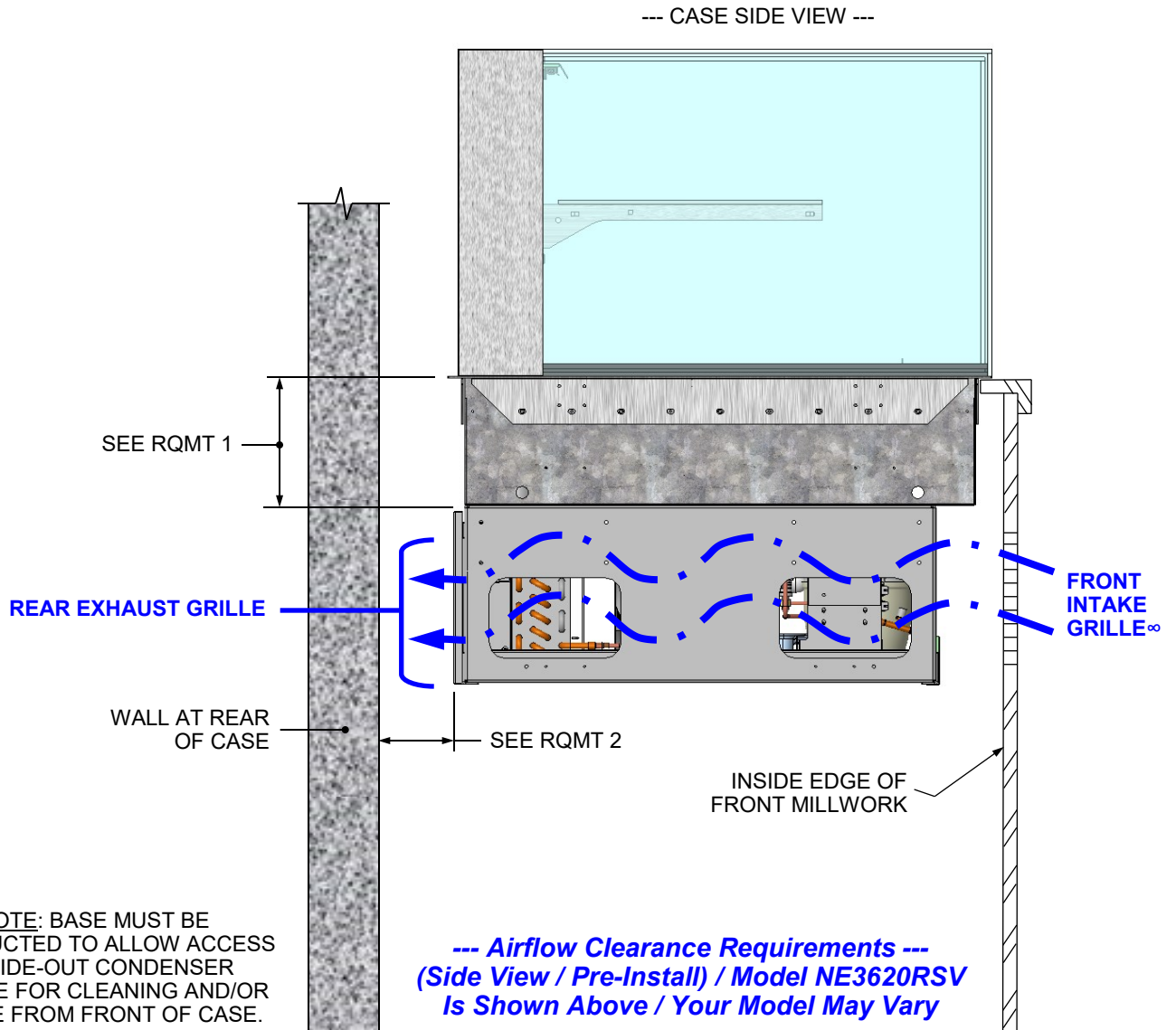

**SECTION B:  
UNITS WITH  
EXHAUST  
GRILLES AT  
INTAKE  
SIDE OF  
CASE**

## SERVICE TOP CUTOUT DIMENSIONS / MINIMUM AIRFLOW INTAKE & EXHAUST REQUIREMENTS

### MIN. AIRFLOW INTAKE & EXHAUST REQUIREMENTS / SERVICE TOP CUTOUT DIMENSIONS

MODELS	A*	B**	MODELS	A*	B**
NE3613RSV	1 1/2" MINIMUM	35"	NE6013RSV	1 1/2" MINIMUM	59"
NE3620RSV	1 1/2" MINIMUM	35"	NE6020RSV	1 1/2" MINIMUM	59"
NE3627RSV	1 1/2" MINIMUM	35"	NE6027RSV	1 1/2" MINIMUM	59"
NE3635RSV	1 1/2" MINIMUM	35"	NE6035RSV	1 1/2" MINIMUM	59"
NE4813RSV	1 1/2" MINIMUM	47"	NE7213RSV	1 1/2" MINIMUM	71"
NE4820RSV	1 1/2" MINIMUM	47"	NE7220RSV	1 1/2" MINIMUM	71"
NE4827RSV	1 1/2" MINIMUM	47"	NE7227RSV	1 1/2" MINIMUM	71"
NE4835RSV	1 1/2" MINIMUM	47"	NE7235RSV	1 1/2" MINIMUM	71"

\* 1 1/2" MINIMUM FROM OUTSIDE EDGE OF COUNTER SURFACE TO CUTOUT

\*\* COUNTER SURFACE CUTOUT WIDTH

IMPORTANT! YOU MUST  
CONSTRUCT BASE TO DIVERT  
EXHAUST AWAY FROM INTAKE!

### AIRFLOW INTAKE & EXHAUST REQUIREMENTS

MODEL	MINIMUM INTAKE (in <sup>2</sup> )~	MINIMUM EXHAUST (in <sup>2</sup> )~
ALL MODELS	96	132

~ IF AIRFLOW IS SUBJECT TO A 'TORTURED' (CIRCUITOUS) ROUTE, YOU MUST INCREASE LISTED VALUES BY 25%.

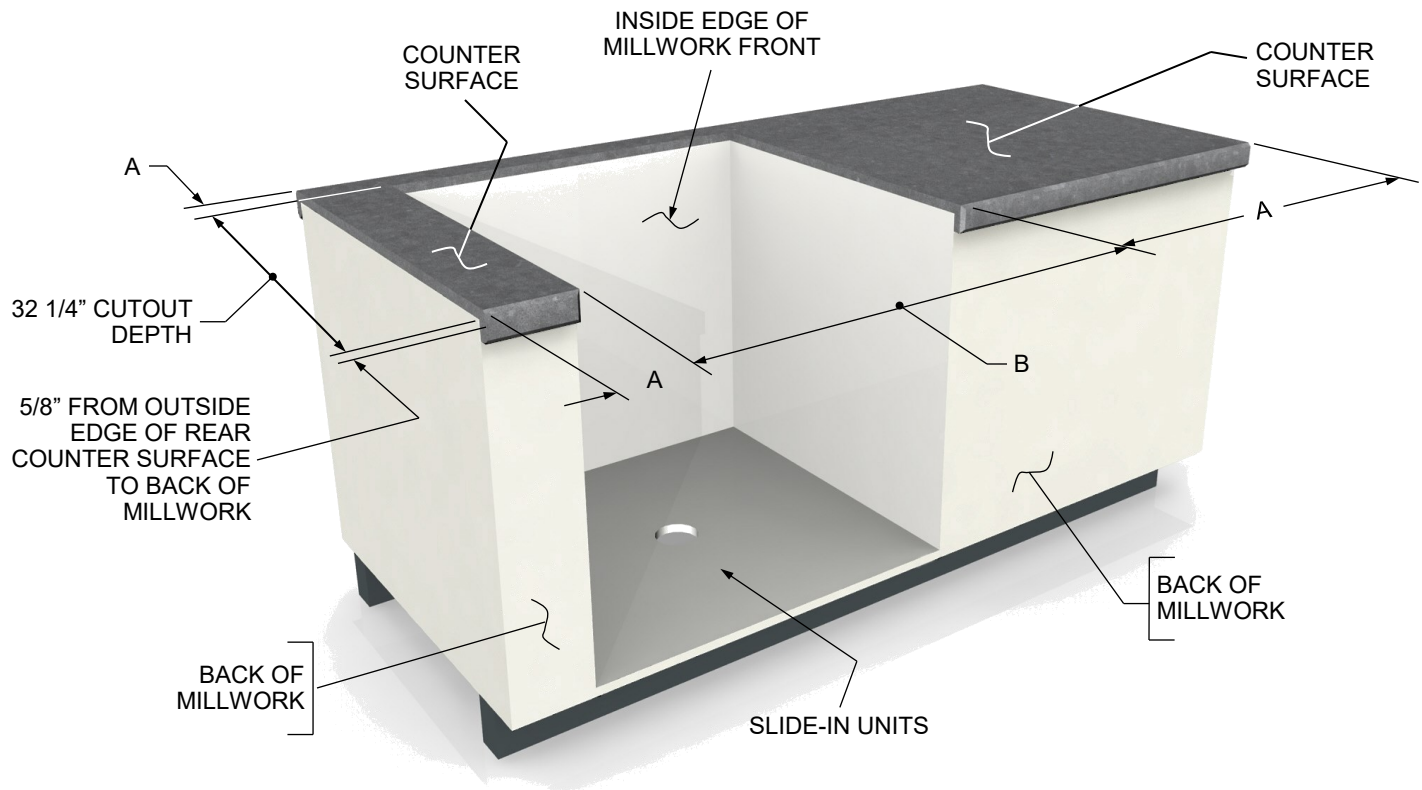

--- Airflow Intake & Exhaust Requirements ---  
--- Service Top Slide-In Unit Dimensions ---

## AIRFLOW CLEARANCE REQUIREMENTS - INTAKE AND EXHAUST AT REAR∞

### AIRFLOW CLEARANCE REQUIREMENTS

- |   |  |
|---|--|
| 1 | 1 1/2" minimum space is required at inside edge of front millwork to case's fascia to allow proper air intake and exhaust. See illustration and note #3 on next page.  |
| 2 | Cabinetry MUST provide access space to allow rear slide-out of condenser package (or front slide-out package, depending upon options chosen). See illustration and note #2 on next page. You must measure before building! |

MODEL	A*	B	C	MODEL	A*	B	C
NE3613RSV	34 5/8"	7 1/2"	17 3/4"	NE6013RSV	58 5/8"	25 1/2"	17 3/4"
NE3620RSV	34 5/8"	7 1/2"	17 3/4"	NE6020RSV	58 5/8"	25 1/2"	17 3/4"
NE3627RSV	34 5/8"	7 1/2"	17 3/4"	NE6027RSV	58 5/8"	25 1/2"	17 3/4"
NE3635RSV	34 5/8"	7 1/2"	17 3/4"	NE6035RSV	58 5/8"	25 1/2"	17 3/4"
NE4813RSV	46 5/8"	18 1/2"	17 3/4"	NE7213RSV	70 5/8"	25 1/2"	17 3/4"
NE4820RSV	46 5/8"	18 1/2"	17 3/4"	NE7220RSV	70 5/8"	25 1/2"	17 3/4"
NE4827RSV	46 5/8"	18 1/2"	17 3/4"	NE7227RSV	70 5/8"	25 1/2"	17 3/4"
NE4835RSV	46 5/8"	18 1/2"	17 3/4"	NE7235RSV	70 5/8"	25 1/2"	17 3/4"

### AIRFLOW INTAKE & EXHAUST REQUIREMENTS

MODEL	MIN. INTAKE (in <sup>2</sup> )~	MIN. EXHAUST (in <sup>2</sup> )~
ALL MODELS	96	132

∞NOTE: THIS LAYOUT OF REAR INTAKE/ EXHAUST IS ALSO APPLICABLE TO UNITS WITH FRONT INTAKE/EXHAUST. SEE NEXT TWO (2) PAGES FOR SIDE VIEWS OF BOTH DESIGNS.

\*ILLUSTRATION SHOWN REFLECTS FACTORY OPTION (CHOSEN BY CUSTOMER) WHICH ALLOWS BACK PANEL VERTICAL ADJUSTABILITY. IF CUSTOMER IS CONSTRUCTING OWN BACK PANEL, NO ADJUSTABILITY MAY BE REQUIRED. HOWEVER, OTHER DESIGN FEATURES (AND DIMENSIONS) SHOWN MUST BE INCORPORATED INTO CUSTOMER'S OWN BACK PANEL DESIGN.

~IF AIRFLOW IS SUBJECT TO A 'TORTURED' (CIRCUITOUS) ROUTE, YOU MUST INCREASE LISTED VALUES BY 25%.

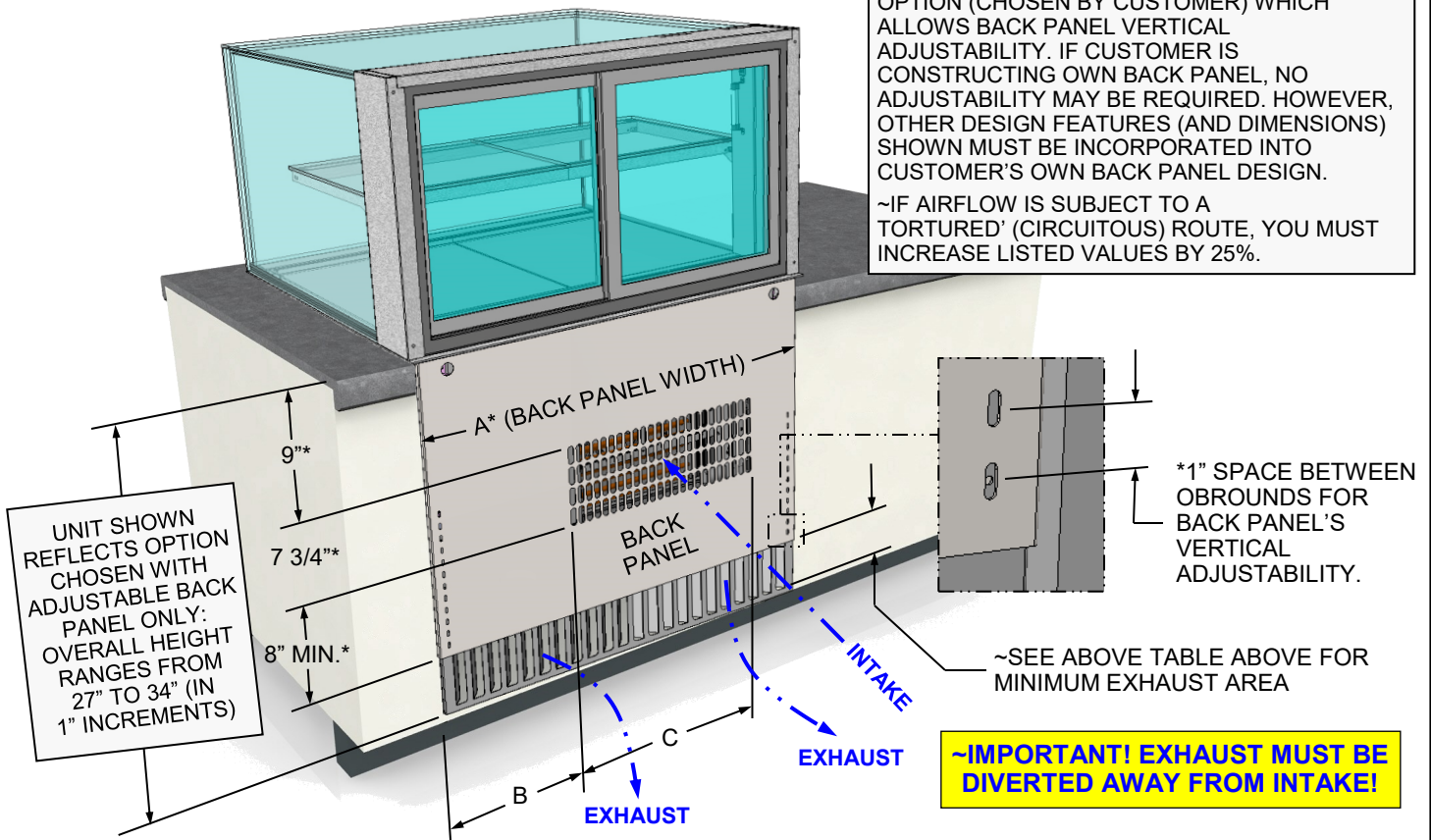

--- Airflow Clearance Requirements ---  
 (Note: Slide-In Unit With Rear Condenser Package Access Shown Above)

## AIRFLOW CLEARANCE REQUIREMENTS - REAR INTAKE TO REAR EXHAUST ONLY

### AIRFLOW CLEARANCE REQUIREMENTS

1	9 1/2" maximum countertop/fascia enclosure space allowed on cabinets or counter for condenser package slide-out.
2	36" minimum opening at back of cabinet or counter required to allow condenser package to slide out from under case.
3	1 1/2" minimum space is required at inside edge of front millwork to case's fascia to allow proper air intake & exhaust.

### AIRFLOW INTAKE & EXHAUST REQUIREMENTS

MODEL	MINIMUM INTAKE (in <sup>2</sup> )~	MINIMUM EXHAUST (in <sup>2</sup> )~
ALL MODELS	96	132

~ IF AIRFLOW IS SUBJECT TO A 'TORTURED' (CIRCUITOUS) ROUTE, INCREASE LISTED VALUES BY 25%.

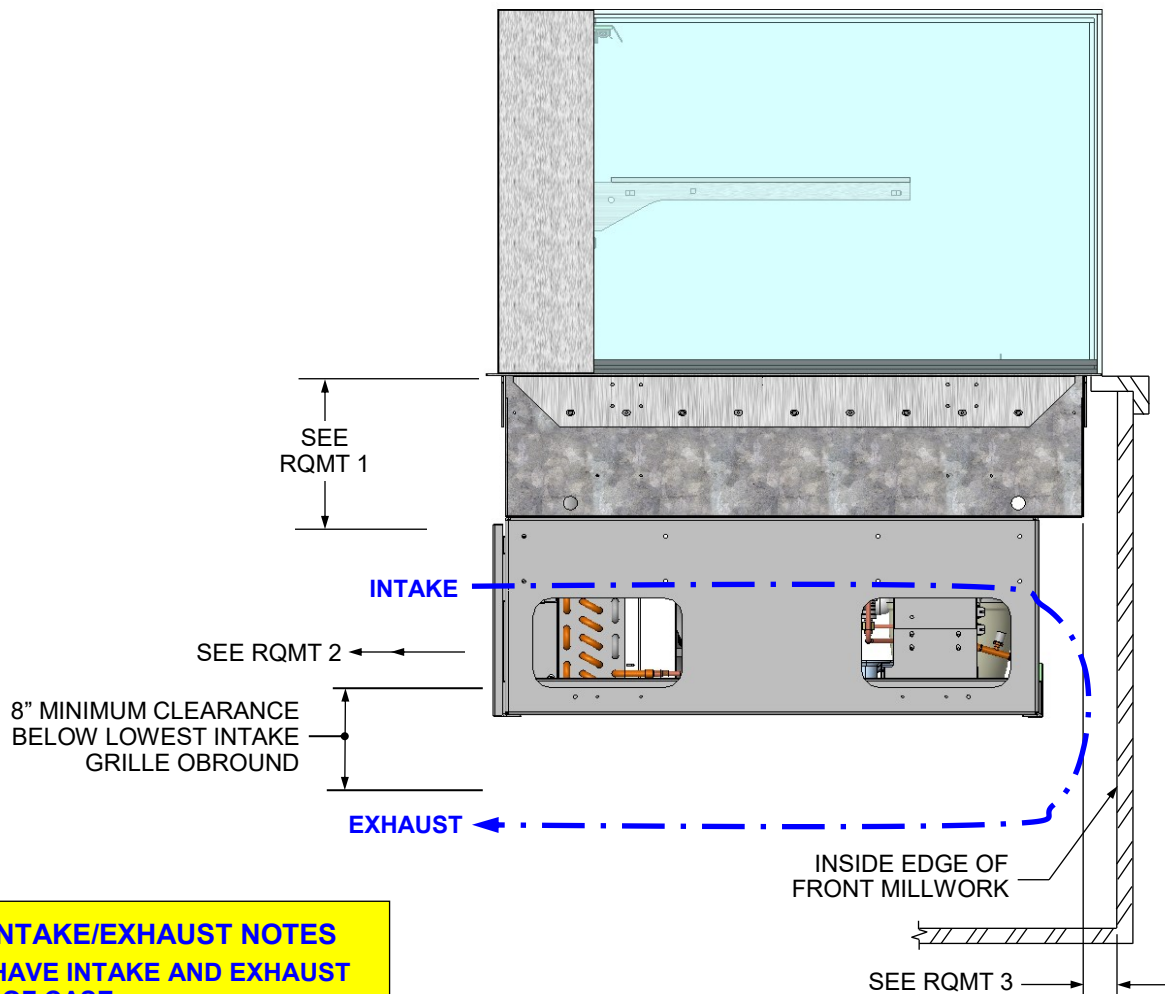

**IMPORTANT INTAKE/EXHAUST NOTES**

1. THESE UNITS HAVE INTAKE AND EXHAUST AT SAME SIDE OF CASE.
2. EXHAUST MUST BE DIVERTED AWAY FROM INTAKE!
3. SEE ILLUSTRATION ON PREVIOUS PAGE.

--- Airflow Clearance Requirements ---  
(Side View Shown Above)

## AIRFLOW CLEARANCE REQUIREMENTS - FRONT INTAKE TO FRONT EXHAUST ONLY

### AIRFLOW CLEARANCE REQUIREMENTS

1	9 1/2" maximum countertop/fascia enclosure space allowed on cabinets or counter for condenser package slide-out.
2	3" minimum space from rear of case to wall for adequate airflow.
3	Close-off must prevent airflow between underside of case and inside edge of front millwork.

### AIRFLOW INTAKE & EXHAUST REQUIREMENTS

MODEL	MINIMUM INTAKE (in <sup>2</sup> )~	MINIMUM EXHAUST (in <sup>2</sup> )~
ALL MODELS	96	132

~ IF AIRFLOW IS SUBJECT TO A 'TORTURED' (CIRCUITOUS) ROUTE, YOU MUST INCREASE LISTED VALUES BY 25%.  
 ∞ NOTE: BASE MUST BE CONSTRUCTED TO ALLOW ACCESS TO SLIDE-OUT CONDENSER PACKAGE FOR CLEANING AND/OR SERVICE FROM FRONT OF CASE.

