

"PRTC-3" POT RACKS - TABLE MOUNT

Fits 84"-144" Tables, Square Stainless Steel w/Stainless Steel Hooks

FEATURES:

- Type 300 Stainless Steel
- All Racks Provided With Type 300 Stainless Steel Hooks (See Table For Quantity Per Size)
- Welded Setup
- Standard Table Mount

SPECIFICATIONS:

- Made Of 3/16"x2" Stainless Steel
- Uprights: 1-5/8" O.D. Round Tube, 16GA Type 300 Stainless Steel

CERTIFICATIONS:



"PRTC-3" POT RACK - TABLE MOUNT

MODEL	# OF UPRIGHTS	TABLE LENGTH	LENGTH	# OF HOOKS	WT. (LBS)
PRTC3A	3	84"	79-1/4"	21	46
PRTC4	3	96"	91-1/4"	24	51
PRTC4A	3	108"	103-1/4"	27	55
PRTC5	3	120"	115-1/4"	30	59
PRTC6	3	132"	127-1/4"	33	63
PRTC7	3	144"	139-1/4"	36	68

ALL DIMENSIONS ARE TYPICAL. TOLERANCE +/- .500". JOHN BOOS & CO. RESERVES THE RIGHT TO CHANGE SPECIFICATIONS WITHOUT NOTICE.

DETAILED SPECIFICATIONS

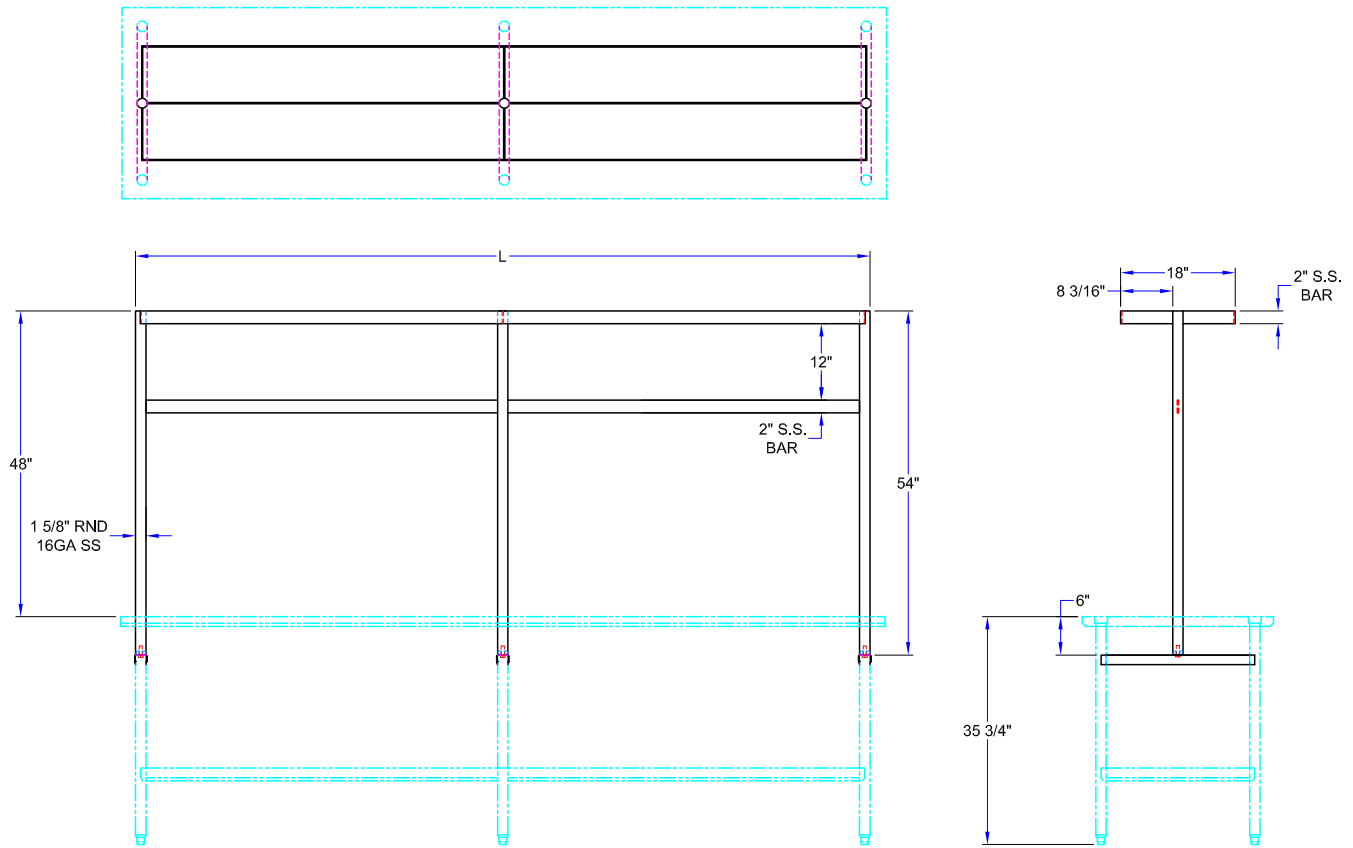

TABLE NOT INCLUDED

"PRTC-3" POT RACK - TABLE MOUNT

MODEL	# OF UPRIGHTS	TABLE LENGTH	LENGTH	# OF HOOKS	WT. (LBS)
PRTC3A	3	84"	79-1/4"	21	46
PRTC4	3	96"	91-1/4"	24	51
PRTC4A	3	108"	103-1/4"	27	55
PRTC5	3	120"	115-1/4"	30	59
PRTC6	3	132"	127-1/4"	33	63
PRTC7	3	144"	139-1/4"	36	68

ALL DIMENSIONS ARE TYPICAL. TOLERANCE +/- .500". JOHN BOOS & CO. RESERVES THE RIGHT TO CHANGE SPECIFICATIONS WITHOUT NOTICE.