

Project: _____

Item: _____

Quantity: _____

Slant Display Rack



1139

This rack is designed to provide an attractive display with high product visibility. Slanted shelves allow you to easily see a variety of product at a glance.

- Frame is constructed of 1" x 1" x .070" wall tubing.
- Angle runners are 1 1/4" x 1 5/8" x .100" wall.
- Uprights are reinforced with a channel to help prevent breakage from the stem casters.
- Equipped with four 5" stem type swivel casters.
- Five-Year Guarantee against material defects and workmanship.
- Lifetime Guarantee against rust and corrosion.
- NSF Certified.

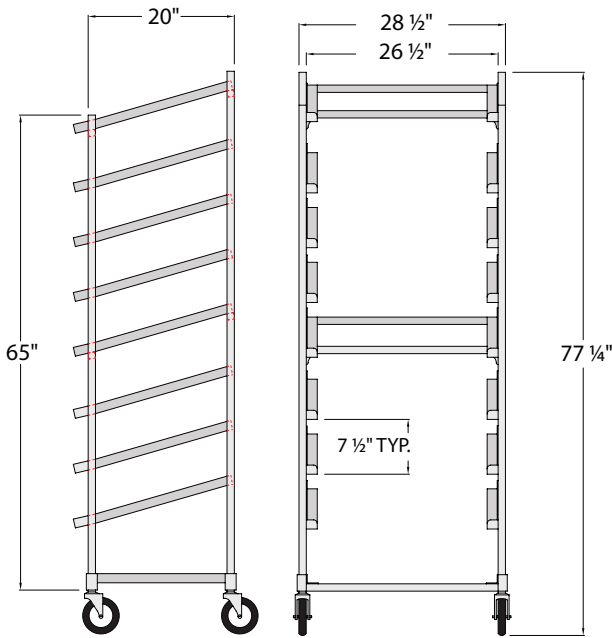

1139

► Slant Display Rack

Model No.	Size W-H-D	Pan Capacity	Runner Spacing	Ship Lbs.
1137	28 1/2" x 70" x 22"	7	8 3/4"	32
1139	28 1/2" x 77 1/4" x 22"	9	7 1/2"	38

Four 5" stem type swivel casters.

Designed to accommodate 18" x 26" pans.

Options: Options may not be NSF Certified. Contact the factory.

Caster Locks (2) - Add "CL" suffix to model #.

Vertical Bumpers (4) - Add "VB" suffix to model #.



All sheet pan racks quoted hold USA standardized 18" x 26" sheet pans (17 7/8" x 25 7/8" actual). We are not responsible for pans that do not meet the industry standard, which may not fit our racks.

New Age Industrial Corp., Inc. || NewAgeIndustrial.com || Made in the USA

PO Box 520 • 16788 US Hwy 36 • Norton, Kansas 67654 || Phone: (800) 255-0104 • (785) 877-5121 || Fax: (877)-877-7687 • (785) 877-2616

This information is for general sales and engineering use only. New Age Industrial reserves the right to modify or make changes at any time, without notice, to materials and specifications.