



WCA25
Café **DECO™**

2.5-Liter Stainless Steel Airpot



Café **DECO™**
2.5-liter Stainless Steel Airpot



MAIN FEATURES

- For use with airpot brewers
- 2.5-liter capacity
- Stainless steel lined
- Keeps liquids hot for hours
- Vacuum-insulated design
- Removable lid for easy cleaning



The Waring Stainless Steel Airpot is best used in conjunction with Waring Commercial Airpot Brewers, to ensure you always have hot and fresh coffee!

WCM70PAP

Stainless steel airpot not included with coffeemakers.

SALES FEATURES

Fresh, delicious coffee is always hot and ready to serve with the Waring Commercial® Café Deco™ Stainless Steel Airpot. Specially designed for use with airpot brewers, it features a vacuum-insulated chamber that keeps coffee at just the right temperature for hours. The extra-large, 2.5-liter capacity makes it ideal for serving groups, and the removable lid ensures easy cleaning. Perfect for meeting rooms, breakfast bars, restaurants, and other operations where hot coffee is in high demand.



@waringcommercial

©2020 Waring Commercial
314 Ella T. Grasso Avenue, Torrington, CT 06790
Tel. 800-492-7464 • Fax 860-496-9008

waringcommercialproducts.com

WCA25



DIMENSIONS

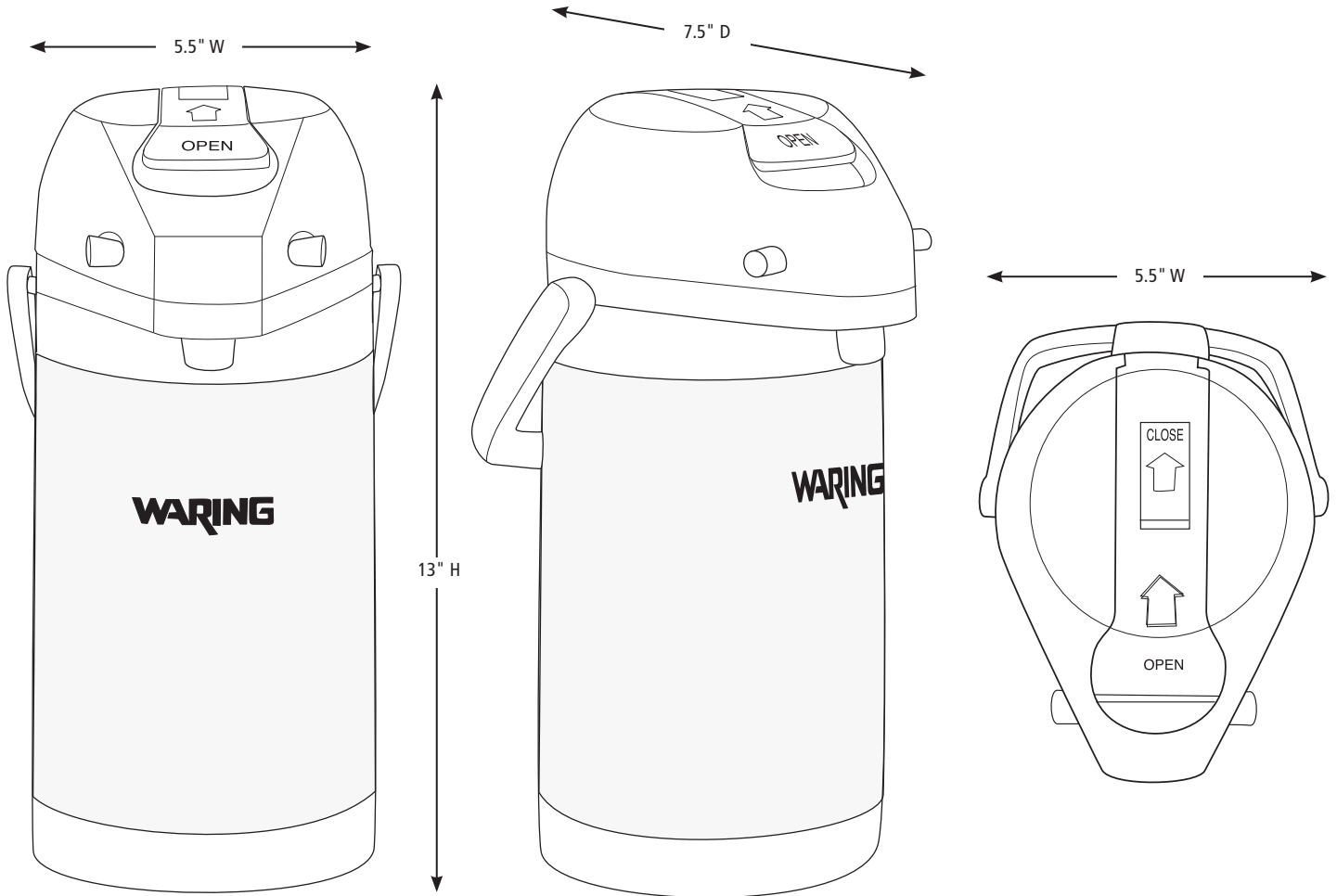

Out of Box Weight: 3 lb.

ORDERING INFORMATION	#STD. PKG.	GIFTBOX WEIGHT	CUBIC FEET	BOX DIMENSIONS D X W X H	UPC	CASE PKG.	MC WEIGHT	MC DIMENSIONS D X W X H	MBC
WCA25 – 2.5-Liter Stainless Steel Airpot	1	4	.42	7.125" x 7.125" x 14.625"	040072093692	6	24	15.625" x 15" x 22.125"	10040072093699



@waringcommercial

©2020 Waring Commercial
314 Ella T. Grasso Avenue, Torrington, CT 06790
Tel. 800-492-7464 • Fax 860-496-9008

waringcommercialproducts.com

20WC076274/ REV 11/20