



---

# CTM

---

## Heavy Duty Countertop Cooler

4094 Paul Buchman Highway  
Plant City, FL 33565  
800.441.4014 | 813.870.0340  
[www.excellenceindustries.com](http://www.excellenceindustries.com)

The company reserves the right to change the design and/or specifications of these products without notice. Printed in the USA.  
Current version 09.22

# KEY ASPECTS

## SPECIAL FEATURES:

- Heavy duty self closing door
- Heavy duty shelving
- Forced air evaporator
- Internal LED lighting
- Environmentally friendly hydrocarbon refrigerant

## OPTIONS:

- Graphics



Complies with 2017 DOE standards for commercial cooler

## TECHNICAL SUMMARY

MODEL	SIZE				ELECTRICAL		REFRIGERATION			OTHER		
	Dimensions (inches)* Width x Depth x Height	Cubic Feet	Net Weight (lbs.)	Shipping Weight (lbs.)**	Voltage/Hz/Phase	Running Amps	Compressor HP	Refrigerant	Temperature	Number of 20 oz bottles	Number of shelves	Container Quantity
CTM-7HC	21 1/4 x 25 x 37 3/4	7.0	141	149	115/60/1	1.4	1/8	R-290	+32°F to +39°F	102	3	144

\*Dimensions are all nominal lengths

\*\*Does not include weight of pallet when needed

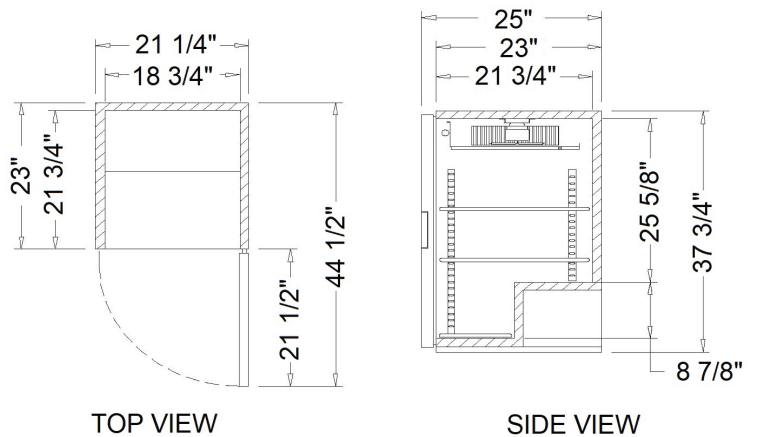

4094 Paul Buchman Highway  
 Plant City, FL 33565  
 800.441.4014 | 813.870.0340  
 www.excellenceindustries.com  
 ver. 09.22