

## Performance Data Sheet

**Model: SGLP200-CL Reverse Osmosis System**

**Use Replacement Cartridge Models: HF65-CL (prefilter) and CFS M RO Membrane**

**Note: SGLP200-CL Reverse Osmosis System uses 2 CFS M Membranes**

Reverse Osmosis / Activated Carbon Drinking Water Appliance

The concentration of the indicated substances in water entering the system was reduced to a concentration less than or equal to the permissible limit for water leaving the system as specified in NSF/ANSI Standard 42, Standard 58 and CSA B483.1.



System tested and certified by NSF International against NSF/ANSI Standard 42, Standard 58, and CSA B483.1 for the reduction of substances as listed below.

Contaminant Reduction Determined by NSF testing.

Contaminant Reduction	Average Influent	NSF Specified Challenge Concentration	Avg % Reduction	Average Product Water Concentration	Max Permissible Product Water Concentration	NSF Reduction Requirements	NSF Test Report
<b>NSF/ANSI Standard 42</b>							
Chloramines	3.0 mg/L	Minimum 50,000 cysts/L	92.8%	0.5 mg/L	N/A	≥99.95%	J-00112395
Chlorine Taste and Odor	2.1 mg/L	2.0 mg/L ± 10%	97.6%	0.05 mg/L	N/A	≥ 50%	J-00097231
Nominal Particulate Class V ≥30.0µm to ≤1.0µm	6,133 pts/mL	At least 1,000 particles/mL	97.4%	159 pts/mL	N/A	≥85%	J-00099135
<b>NSF/ANSI Standard 58</b>							
Total Dissolved Solids (TDS)	771 mg/L	750 mg/L ± 40 mg/L (added as sodium chloride)	94.6%	42 mg/L	N/A	≥ 75%	J-00174430

Contaminant reduction testing is conducted every five years by certifying agency to maintain certification.

**Systems must be installed and operated in accordance with manufacturer's recommended procedures and guidelines. Failure to follow installation, operation, and maintenance instructions may result in leakage and will void warranty.** See Installation Manual for Warranty information.

# Performance Data Sheet

## Model: SGLP200-CL Reverse Osmosis System

Use Replacement Cartridge Models: HF65-CL (prefilter) and CFS M RO Membrane

Note: SGLP200-CL Reverse Osmosis System uses 2 CFS M Membranes

Reverse Osmosis / Activated Carbon Drinking Water Appliance

Application Guidelines/Water Supply Parameters			
Membrane Type	TFCM	Water Supply Parameters	
Water Supply, chlorinated or non-chlorinated		Component	Limit
		Hardness	<171 mg/L
Water Pressure	60-125 psi (414 -862 kPA)	Iron	<0.1 mg/L
Water Temperature	40° F - 100° F (4.4° C - 38° C)	Manganese	<0.05 mg/L
pH Range	4.0 – 11.0	Hydrogen Sulfide	0
Maximum TDS level	2000 ppm	Turbidity	<1 NTU

### FOR COMMERCIAL USE ONLY

Nominal production rate of membranes when running to atmosphere (i.e., with empty tank) at 77° F and 60 PSI is 200 gallons/day (757 liters/day). Production varies based on pressure (fullness) of storage tank. As measured using NSF 58 protocol, the production rate of SGLP100-CL is 61.97 gallons/day (234.5 liters/day)

**HF65-CL (prefilter) Capacity:** 15,000 gallons (56,781 liters) @ 1 gpm

**System Efficiency:** 22.12%. Efficiency rating means the percentage of the influent water to the system that is available to the user as reverse osmosis treated water under operating conditions that approximate typical daily usage.

**System Recovery:** 23.53%. Recovery rating means the percentage of the influent water to the membrane portion of the system that is available to the user as reverse osmosis treated water when the system is operated without a storage tank or when the storage tank is bypassed.

It is essential that the manufacturer's recommended installation, maintenance and filter replacement requirements be carried out for the product to perform as advertised. See Installation Manual for Warranty information.

**Note:** While the testing was performed under standard laboratory conditions, actual performance may vary.

**Important Quality Assurance Requirements:** These Reverse Osmosis Drinking Water Appliances contain treatment components that are critical for effective reduction of Total Dissolved Solids as well as inorganic contaminants. We strongly recommend that the user test the water a minimum of every 6 months to verify that the appliance is performing satisfactorily.

For estimated costs of replacement elements please call: 1-866-990-9785 or visit our website at [www.3Mfoodservice.com](http://www.3Mfoodservice.com).

### WARNING

Read entire manual. Failure to follow all guides and rules could cause personal injury or property damage.

- Check with your local public works department for plumbing codes. You must follow their guidelines as you install the water filtration system.
- Your water filtration system will withstand up to 125 pounds per square inch (psi) water pressure. If your house water supply pressure is higher than 80 psi, install a pressure reducing valve before installing the water filtration system.

**To reduce the risk associated with the ingestion of contaminants:**

- DO NOT use with water that is microbiologically unsafe or of unknown quality without adequate disinfection before or after the system.

### NOTICE

**To reduce the risk associated with water leakage or flooding:**

- Read and follow Use Instructions before installation and use of this system.
- Change the disposable HF65-CL prefilter cartridge at the recommended interval; the disposable HF65-CL cartridge MUST be replaced every 12 months or sooner.
- Change the disposable membrane filter cartridge at the recommended interval; the disposable CFS M RO Membrane cartridges MUST be replaced 24 months or sooner.
- Failure to replace the disposable filter and membrane cartridges at recommended intervals may lead to reduced filter performance and failure of the filters, causing property damage from water leakage or flooding.



# Performance Data Sheet

## Model: SGLP100-CL Reverse Osmosis System

Use Replacement Cartridge Models: HF65-CL (prefilter) and CFS M (RO Membrane Module)  
Reverse Osmosis / Activated Carbon Drinking Water Appliance

### Routine Maintenance

**HF65-CL Prefilter:** Change at least every twelve months or sooner depending on feed water quality.

**CFS M RO Membrane (Qty: 2 cartridges):** Change as required based on periodic TDS rejection tests or an on-site monitor (PR). The maximum recommended service life is 24 months.

**Please refer to the Installation and Operation Manual for complete maintenance requirements.**

### Parts Diagram

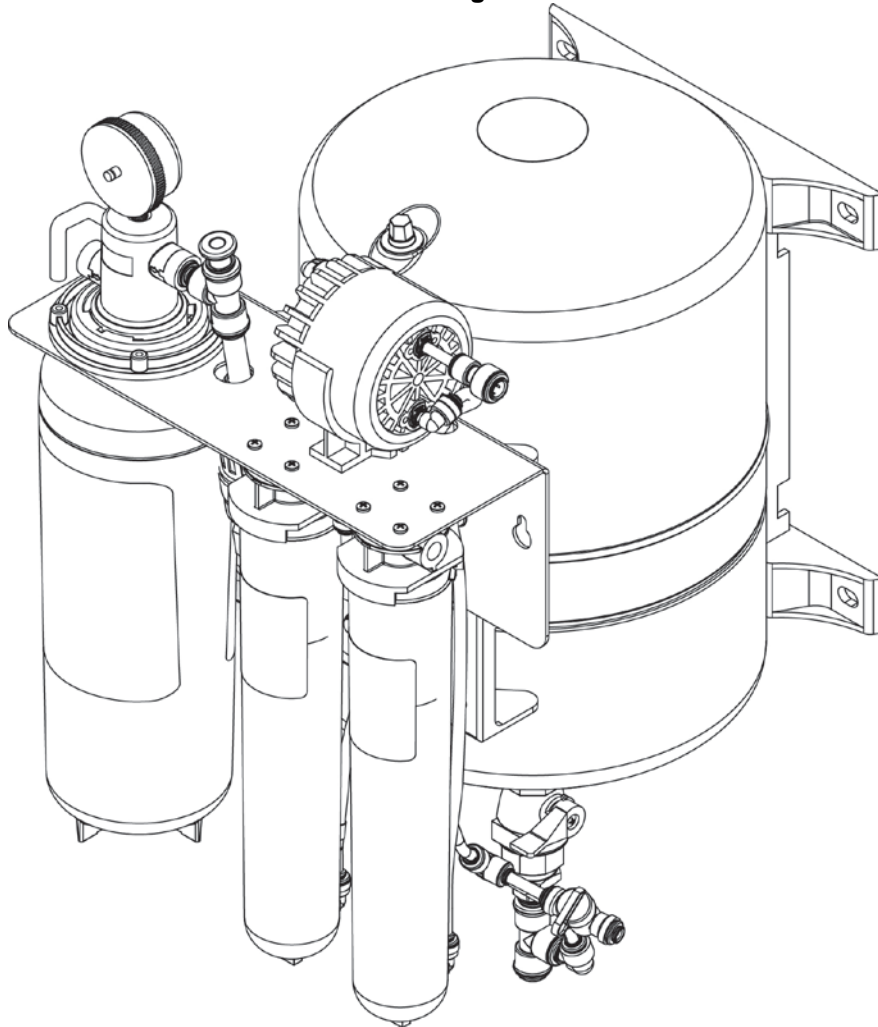

### Parts List

- 1) HF65-CL (Prefilter) : Part No.5628902 / 70020322767
- 2) CFS M (RO Membrane Cartridges): Part No. 5625004 /70020322767
- 3) Permeate Pump: Part No. 89-1331202 / 70020030642
- 4) Flow Control: Part No. 99-103301 / 70020260652
- 5) Automatic Shut-off Valve: Part No. 60-931401
- 6) Storage Tank: Part No.56-123001
- 7) Tank Shut-off Valve: Part No. 50-93707 / 70020330174
- 8) SGLP Bypass Kit : Part No. 50-94201 / 70020337799

**3M**

3M Purification Inc.  
400 Research Parkway  
Meriden, CT 06450 USA  
Toll Free: 1-866-990-9785  
Worldwide: 203-237-5541  
[www.3Mfoodservice.com](http://www.3Mfoodservice.com)