

## Glass Storage Cabinets

## Royal Series Underbar



**KR24-GSB1**  
Adjustable Slides (3 racks)



**KR24-GSB3**  
Middle Shelf (2 racks)



**KR24-GSB4**  
Middle Shelf/Cutting Board (2 racks)



**KR24-GSB5**  
Roll Out Shelves (2 racks)



**KR24-24SC**  
Storage with Hand Sink

Model	Description	Length	Depth	20" x 20" Glass Rack Capacity	Weight
<b>KR24-GSB1</b>	Glass Storage with Drainboard Top and Adjustable (3) Rack Slides	24"	24"	3	40
<b>KR24-GSB3</b>	Glass Storage with Drainboard Top and Middle Shelf	24"	24"	2	48
<b>KR24-GSB4</b>	Glass Storage with Drainboard Top, Middle Shelf, Cutting Board	24"	24"	2	60
<b>KR24-GSB5</b>	Glass Storage with Drainboard Top and Roll Out Shelves	24"	24"	2	60
<b>KR24-24SC</b>	Glass Storage with Drainboard Top and Right Side Sink	24"	24"	-	70
<b>KR24-24SC-L</b>	Glass Storage with Drainboard Top and Left Side Sink	24"	24"	-	70

### Standard Features

- Open front base for glass storage
- Drainboard top, optional perforated insert available
- Glass racks not included
- Royal Series faucet included with hand sink models KR24-24SC and KR24-24SC-L

### Optional Accessories

<b>KR-313</b>	Left and Right End Side Splashes
<b>KR-314</b>	Right End Side Splash
<b>KR-315</b>	Left End Side Splash
<b>30-160</b>	Glass Storage with Left Side Sink (For KR24-24SC and KR24-24SC-L)
<b>30-152</b>	Glass Storage with Right Side Sink (For KR24-24SC and KR24-24SC-L)
<b>21-443L</b>	E-Z Install Flexible Water Line Kit (For KR24-24SC and KR24-24SC-L)
<b>KR24-PE24</b>	24" Perforated Insert (For KR24-GSB1 and KR24-GSB3 and KR24-GSB5)

### Specifications

- 20 gauge embossed stainless steel reinforced with welded braces every 6"
- Drainboard**
- 3/4" radius on all vertical and horizontal edges
  - Perforated insert is optional except for model KR24-GSB4 where it is included
- Material**
- Front apron: 20 gauge stainless steel
  - Shelf: 20 gauge stainless steel
  - Backsplash: 20 gauge stainless steel
  - Sides: 20 gauge stainless steel
  - Back and bottom: 20 gauge galvanized steel
- Legs**
- 1-5/8" tubular 16 gauge stainless steel with grey plastic bullet foot
- Plumbing**
- 1/2" drain on right rear of drainboard (23-110) (KR24-24SC and KR24-24SC-L does not have this drain as liquid drains directly to sink bowl)
  - 1" bottom shelf drain (23-111)
  - 1-1/2" drain on KR24-24SC sink bowl (23-122)
- Cutting Board**
- Non-slip flush mounted cutting board on model KR24-GSB4 (CB-127)



## Glass Storage Cabinets

## Royal Series Underbar



**KR24-GSB1**

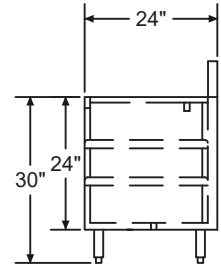
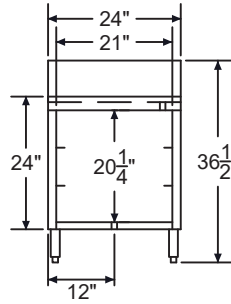
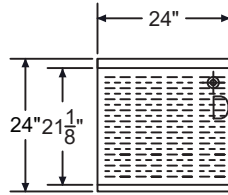

**KR24-GSB3**

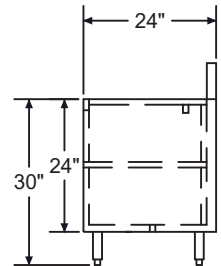
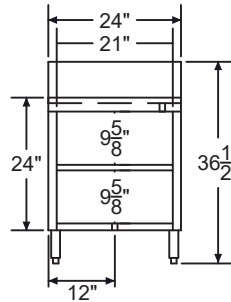
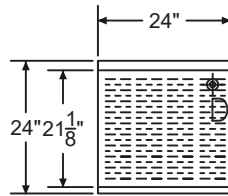

**KR24-GSB4**

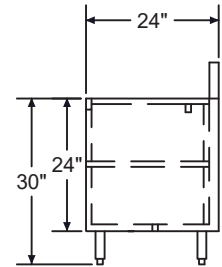
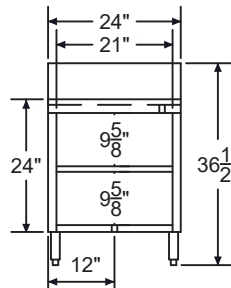
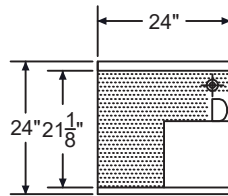

**KR24-GSB5**

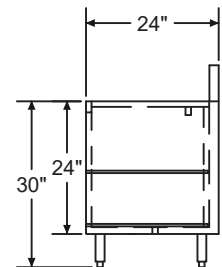
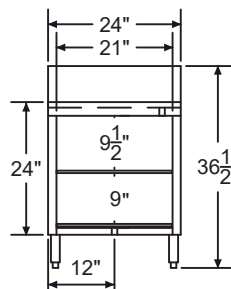
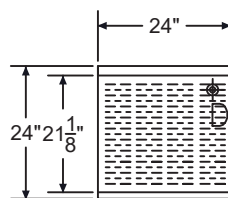

**KR24-24SC  
KR24-24SC-L**

KR24-24SC shown

KR24-24SC-L  
is exact opposite  
with sink on left.

