



# Sleek Shields™

## CAFETERIA GLASS FOOD SHIELDS

For Advance Tabco Hot/Cold Tables

Protected By: Patent No. US 9,010,883 B2

Item #: \_\_\_\_\_ Qty #: \_\_\_\_\_  
 Model #: \_\_\_\_\_  
 Project #: \_\_\_\_\_



**FEATURING ADVANCE TABCO'S REVOLUTIONARY CHAMBER LOCK™ ROTATION SYSTEM**  
 Front Glass Locks Into Place At 15° Intervals



NSGC-15-4WELL Shown

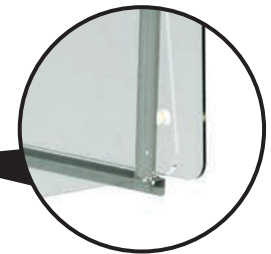

**Includes TA-47 Mounting Brackets**  
 For In-Field Installation

**FEATURES:**

- Front glass locks in place at 15° intervals.
- Attractive, low profile design & easy to clean.
- 1" Stainless steel posts.
- Chamber lock™ is mounted to post in a fixed position.
- Includes two 16-3/8" high side panels.
- 1/4" Thick heat-tempered front & side glass.
- (3/8" Thick heat-tempered front glass for 4 well unit).
- Includes 15" wide stainless steel shelving.
- Shelf has square edges on all four sides.
- Ships KD.

**MATERIAL:**

- 1/4" Thick Heat-Tempered Front & Side Glass.
- (3/8" Thick Heat-Tempered Front Glass For 4 Well Unit).
- Shelf - 18 Ga., Type 430 Stainless Steel with 1" Post - Stainless Steel.
- Chamber Lock™ - Anodized Aluminum.
- TA-47 Mounting Brackets
- Finish - Aluminum components manufactured with a standard Satin Clear Finish. Other colors available for Aluminum Components Only. Please consult factory for additional colors.

15" Wide Stainless Steel Shelf					
Model #	O.A. Size L x W x H	(A) Length	Description	Approx. Wt.	Approx. Cubes
NSGC-15-2WELL	33 13/16" x 18" x 18 3/4"	31 13/16"	Fits 2-Well Unit	135 lbs.	15
NSGC-15-3WELL	47 1/8" x 18" x 18 3/4"	47 1/8"	Fits 3-Well Unit	176 lbs.	22
NSGC-15-4WELL*	62 7/16" x 18" x 18 3/4"	62 7/16"	Fits 4-Well Unit	232 lbs.	29
NSGC-15-5WELL**	77 3/4" x 18" x 18 3/4"	77 3/4"	Fits 5-Well Unit	265 lbs.	38
NSGC-15-6WELL**	93 1/16" x 18" x 18 3/4"	93 1/16"	Fits 6-Well Unit	300 lbs.	47

\*3/8" Thick Heat-Tempered Glass Required For Front Glass \*\*Requires a Single Center Post (Factory Print Included)

**NOTE: Due to mounting requirements, food shields extend 15/16" beyond the end of the hot or cold food table on each end. Units set side by side must allow for this additional space.**



Meets Latest NSF Standards



**Customer Service Available To Assist You 1-800-645-3166 8:30 am - 7:00 pm E.S.T.**

For Orders & Customer Service:  
 Email: customer@advancetabco.com or Fax: 631-242-6900

For Smart Fabrication™ Quotes:  
 Email: smartfab@advancetabco.com or Fax: 631-586-2933

# DIMENSIONS and SPECIFICATIONS

TOL ± .125"

ALL DIMENSIONS ARE TYPICAL

Maximum Front Glass Opening is 1 1/2" From Table To Bottom Of Glass. NSF Requires Side Glass To Be 18" Wide Minimum.

**NOTE: Due to mounting requirements, food shields extend 15/16" beyond the end of the hot or cold food table on each end. Units set side by side must allow for this additional space.**

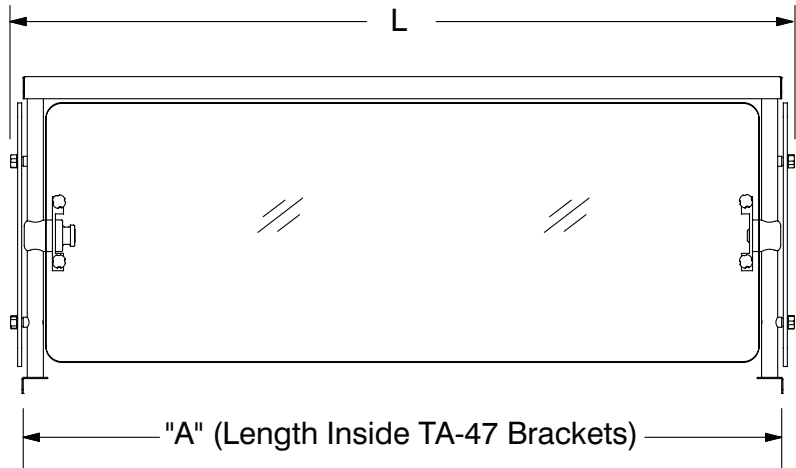
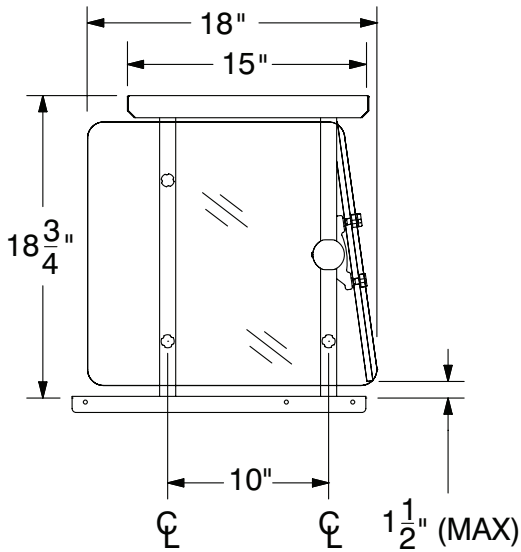

## Single Post w/ Cantilever Bracket Available

- Can not replace standard end posts/brackets
- May be used to eliminate a post located in the middle of the unit

### SG-C

