

"PBHS-14-4D" PRO-BOWL HAND SINKS

Wall Mount, (1) 14"x10"x5" Deep Bowl - 3½" Drain

FEATURES:

- One Piece Deep Drawn Bowl
- All Sink Bowls Have Large Liberal Radii Corners
- Includes Basket Drain
- Splash Mount Faucet Holes 4" On-Center

SPECIFICATIONS:

- Bowl: Stainless Steel Tops Are TIG Welded, Exposed Welds Are Polished To Match Adjacent Surface
- Bowl: Type 300 Stainless Steel Polish, Satin Finish
- Bracket: Type 300 Stainless Steel Polish, Satin Finish
- Drain: 3-1/2" Drain Opening, With 1-1/2" NPS Outlet Connection

CERTIFICATIONS:



PBHS-W-1410-4D

ACCESSORIES

MODEL
Faucets
ADA Wrist Blades
Towel Dispenser
Lever Wastes
Over Flows
P-Traps

"PBHS-14-4D" PRO-BOWL HAND SINKS

MODEL	BOWL SIZE (L X W X H)	OVERALL SINK SIZE (L X W X H)	SIDE SPLASH	FAUCET	WEIGHT (LBS)
PBHS-W-1410-4D	14"x10"x5"	17"x15-1/2"x13-1/8"	LH & RH	PBF-4-S-LF	9

ALL DIMENSIONS ARE TYPICAL. TOLERANCE +/- .500". JOHN BOOS & CO. RESERVES THE RIGHT TO CHANGE SPECIFICATIONS WITHOUT NOTICE.

DETAILED SPECIFICATIONS

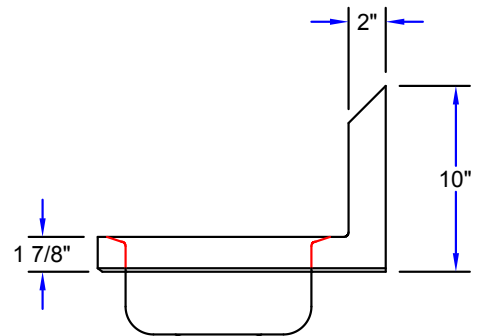
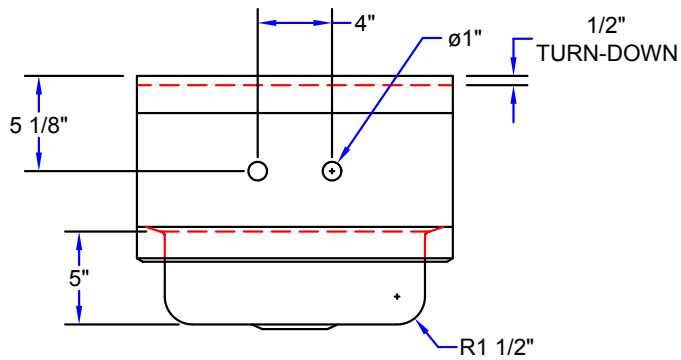
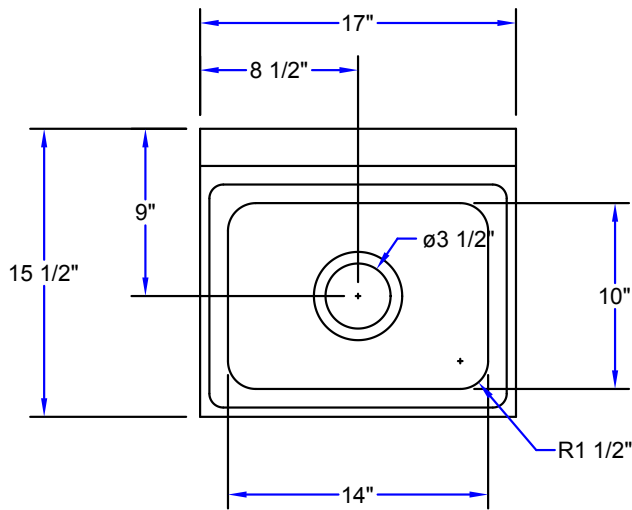

"PBHS-14-4D" PRO-BOWL HAND SINKS

MODEL	BOWL SIZE (L X W X H)	OVERALL SINK SIZE (L X W X H)	SIDE SPLASH	FAUCET	WEIGHT (LBS)
PBHS-W-1410-4D	14"x10"x5"	17"x15-1/2"x13-1/8"	LH & RH	PBF-4-S-LF	9

ALL DIMENSIONS ARE TYPICAL. TOLERANCE +/- .500". JOHN BOOS & CO. RESERVES THE RIGHT TO CHANGE SPECIFICATIONS WITHOUT NOTICE.