

EXTRUDED SIDEWALL UTILITY RACK MODEL 252-1840

FEATURES AND BENEFITS:

- Durable utility rack for transport and storage of products on 18" x 26" pans and plastic food boxes.
- Fully welded framework of structural aluminum extrusions for rigidity and durability.
- Constructed of non-corrosive, Hi-Tensile aluminum for strength.
- Easy to clean; interlocking, extruded sidewalls hold pans on 1-1/2" centers. Provides added strength.
- Offers complete flexibility for operator's selection of pan spacing. Eliminates potential of product damage.
- Heavy duty 5" swivel casters, two with brakes. Provides mobility when fully loaded.

Note: Designed to hold standard 18 x 26" pans by the lip. Due to the variability of pan manufacturers/quality of pans being held/pan sizes, please contact manufacturer or provide a sample pan to ensure a proper fit.



252-1840



ACCESSORIES and OPTIONS (Available at extra cost):

- Pan Stop
- Corner Bumpers
- Vertical Bumpers
- Perimeter Bumper
- Rotary Bumpers (for use with 5" casters)
- Floor Lock (for use with 5" casters)
- Various Caster Options

See page G-36 for accessory details.

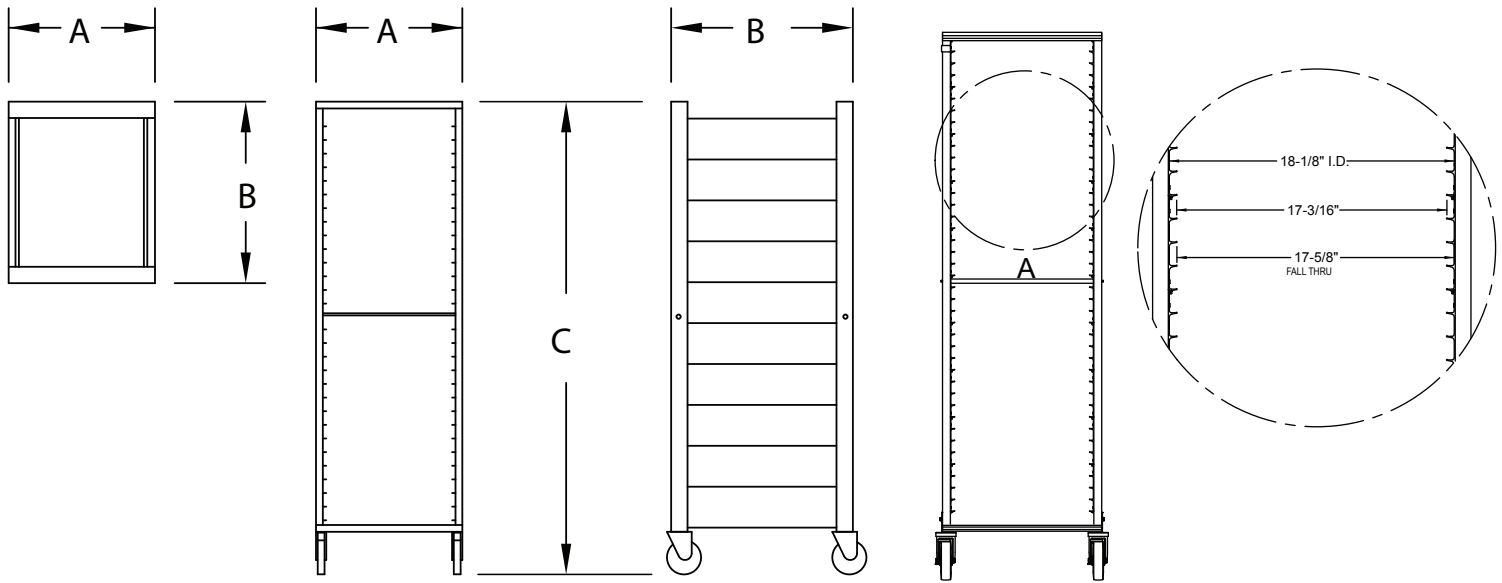

| CRES COR MODEL NO. | PAN | | | DIM "A" | DIM "B" | DIM "C" | INSIDE DIMENSIONS | | | | WEIGHT ACT. |
|-----------------------|-----|-----------|----|---------|---------|----------|-------------------|--------|--------|-----|----------------|
| | CAP | SIZE | | WIDTH | DEPTH | HEIGHT | WIDTH | DEPTH | HEIGHT | | |
| 252-1840 | 39 | 18 X 26 | IN | 21-5/16 | 26-5/8 | 69-11/16 | 18-1/8 | 25-1/2 | 61-1/2 | LBS | 70 |
| | | 460 X 660 | MM | 560 | 680 | 1770 | 460 | 650 | 160 | KG | 32 |

When ordering bumpers, add 2" to overall dimensions.

ALL ALUMINUM CONSTRUCTION IS RIVETED, WELDED AND FINISHED.

RACK:

- Posts: Extruded channels, 1 x 2 x .125.
- Top and bottom: Extruded channels, 1-1/16 x 2-3/8 x .188; welded to posts.
- Tie rods (2): 5/16 dia. steel rods enclosed in aluminum tubing; fastened to posts.
- Sides: Interlocking extruded 6" panels, smooth outer sides; riveted to posts.
- Casters: 5" dia., swivel, modulus tires, 1-1/4 wide, load cap. 250 lbs. each, temp. range -45°/+180°F. Delrin bearings. Two casters equipped with brakes.

PAN SLIDES:

- Extruded interlocking side wall panels act as pan slides on 1-1/2" centers.

Note: Designed to hold standard 18 x 26" pans by the lip. Due to the variability of pan manufacturers/quality of pans being held/pan sizes, please contact manufacturer or provide a sample pan to ensure a proper fit.

SHORT FORM SPECIFICATIONS

Cres Cor Utility Rack Model 252-1840. Extruded aluminum welded construction. Tie rods (2) applied at front and rear. Interlocking extruded sides for (39) 18" x 26" pans on 1-1/2" centers. 5" swivel modulus casters, Delrin bearings. Load capacity 250 lbs. each, temperature -45° to +180°F. 2-Year Parts / 1-Year Labor warranty. Provide the following accessories: _____ . NSF listed.



5925 Heisley Road • Mentor, OH 44060-1833
 Phone: 877/CRESCOR • Fax: 440/350-7267
 www.crescor.com

© Crescent Metal Products, Inc. 2016 All rights reserved.

In line with its policy to continually improve its products, CRES COR reserves the right to change materials and specifications without notice.