



Profit from the Eagle Advantage®

# Specification Sheet

## Short Form Specifications

Eagle Bulk Wine Storage Unit, model \_\_\_\_\_. (Chrome plated / black powder coated mild steel) panels. Bottles are retained by removable dividers, back panels, and end panels. Capacity: 12 bottles per compartment. Compartments adjustable for bottle diameter.

Eagle Bulk Wine Storage Unit with Security Doors, model \_\_\_\_\_. (Chrome plated / black powder coated mild steel) panels and hinged security doors. Bottles are retained by removable dividers, back panels, and end panels. Capacity: 12 bottles per compartment. Compartments adjustable for bottle diameter.

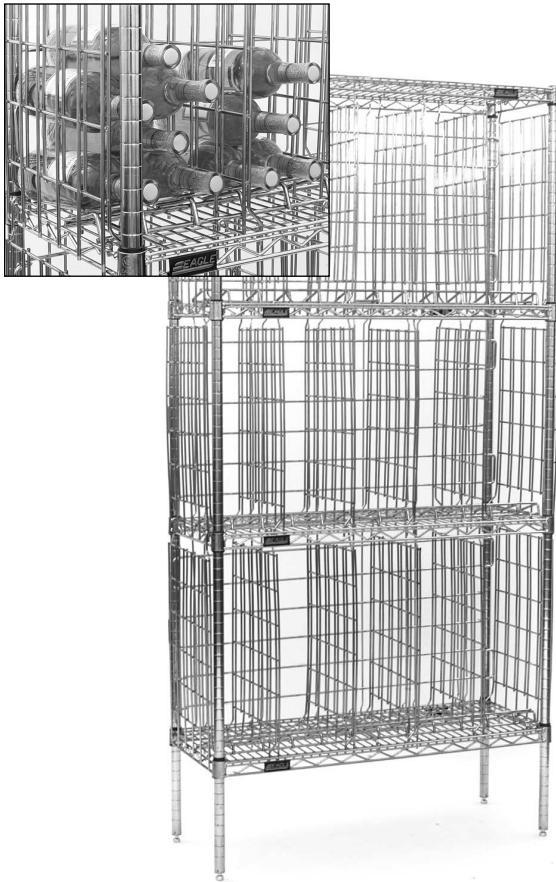

bulk wine storage unit

Item No.:	_____
Project No.:	_____
S.I.S. No.:	_____

## Bulk Wine Shelving and Display

### MODELS:

- BW1436C
- BW1448C
- BW1436BL
- BW1448BL
- BW1436C-SC
- BW1448C-SC
- BW1436BL-SC
- BW1448BL-SC

### Design and Construction Features

- Panels are chrome or black powder coated mild steel.
- Bottles are retained with removable dividers, back panels and end panels.
- Adjustable leveling feet accommodates uneven floors.
- Adjustable compartments for bottle diameter.
- Available with security doors.
- Holds one dozen bottles per compartment.
- Height is 74" (1880mm).
- 36" (914mm) unit capacity is 180 bottles (750ml).
- 48" (1219mm) unit capacity is 240 bottles (750ml).

Please note: Units are for stationary applications only.

### EAGLE GROUP

100 Industrial Boulevard, Clayton, DE 19938-8903 USA  
 Phone: 302-653-3000 • 800-441-8440 • Fax: 302-653-2065  
[www.eaglegrp.com](http://www.eaglegrp.com)  
[www.eaglegrpnews.com](http://www.eaglegrpnews.com)  
[www.eaglemhc.com](http://www.eaglemhc.com)

For custom configuration or fabrication needs, contact our **SpecFAB® Division**.  
 Phone: 302-653-3000 • Fax: 302-653-2065 • e-mail: [quotes@eaglegrp.com](mailto:quotes@eaglegrp.com)



EG01.24 Rev. 05/23

Spec sheets available for viewing, printing or downloading from our online literature library at our websites



Item No.: \_\_\_\_\_  
 Project No.: \_\_\_\_\_  
 S.I.S. No.: \_\_\_\_\_

## Bulk Wine Shelving and Display

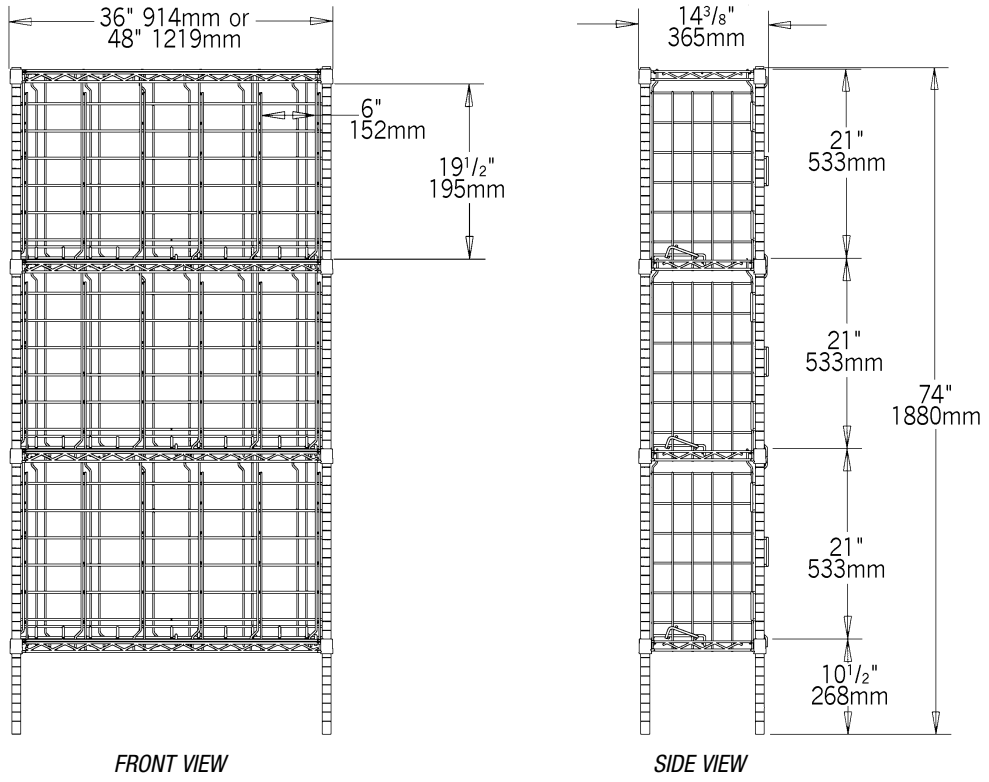

### Bulk Wine Storage Units

chrome model #	black model #	width in.	width mm	x	length in.	length mm	weight lbs.	weight kg	capacity (750ml bottles)
BW1436C	BW1436BL	14"	356		36"	914	140	63.5	180
BW1448C	BW1448BL	14"	356		48"	1219	160	72.5	240

### Bulk Wine Storage Units with Security Doors

chrome model #	black model #	width in.	width mm	x	length in.	length mm	weight lbs.	weight kg	capacity (750ml bottles)
BW1436C-SC	BW1436BL-SC	14"	356		36"	914	183	83.0	180
BW1448C-SC	BW1448BL-SC	14"	356		48"	1219	205	93.0	240

Because units are only 14" (356mm) wide, units are for stationary application only. Cradle wine shelves also available for wine display and storage. See specification sheet #EG01.20.

**EAGLE GROUP**  
 100 Industrial Boulevard, Clayton, DE 19938-8903 USA  
 Phone: 302-653-3000 or 800-441-8440 • Fax: 302-653-2065  
 www.eaglegrp.com • www.eaglegrpnews.com • www.eaglehmc.com

Printed in U.S.A.  
 ©2023 by Eagle Group  
 Rev. 05/23

Spec sheets available for viewing, printing or downloading from our online literature library at our websites

Although every attempt has been made to ensure the accuracy of the information provided, we cannot be held responsible for typographical or printing errors. Information and specifications are subject to change without notice. Please confirm at time of order.