

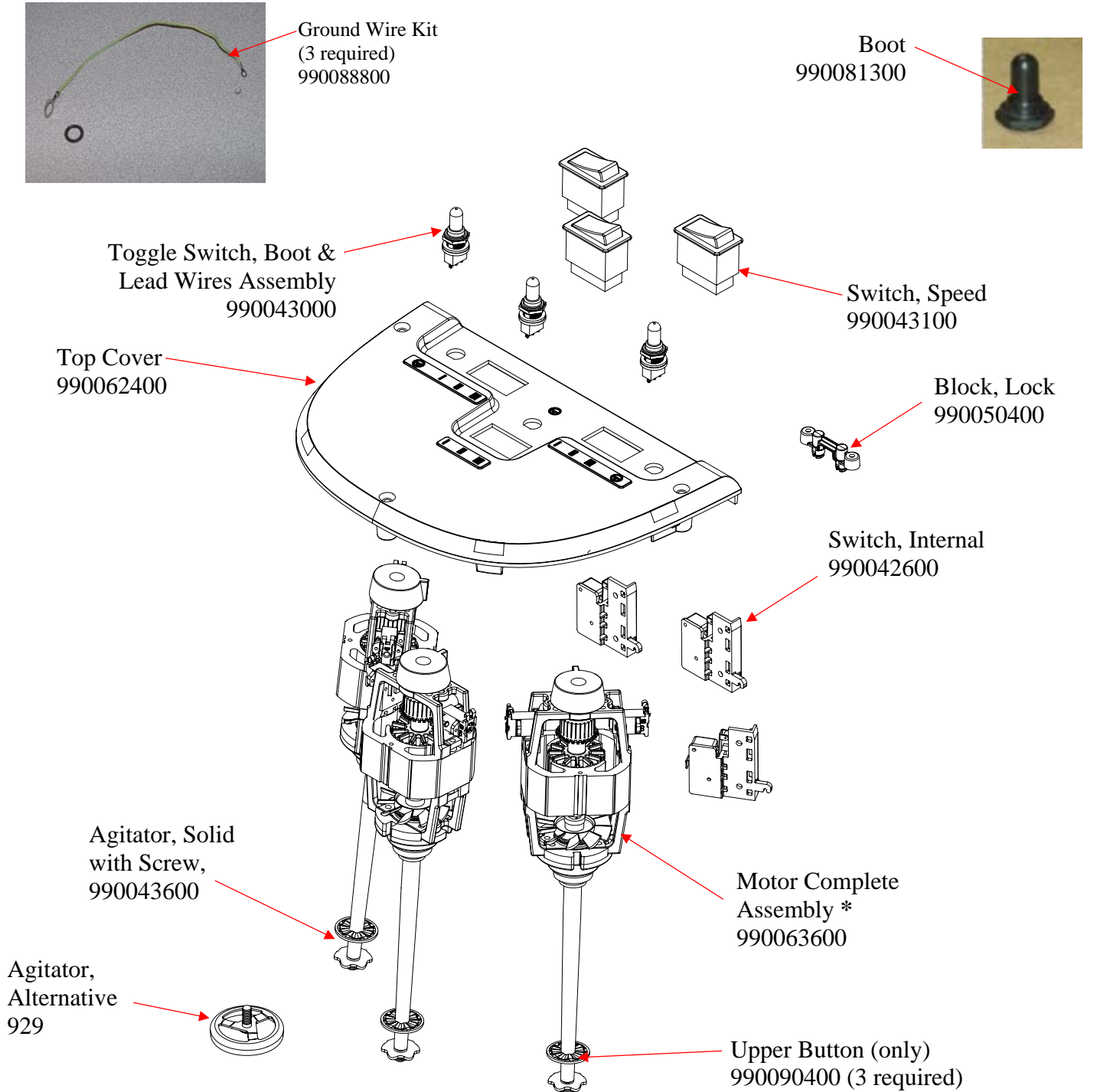

Replacement Parts Diagram HMD400 (Series A-B)

PROPRIETARY RIGHTS NOTICE This document and all information contained within it is the property of Hamilton Beach Brands, Inc. (HBB). It is confidential and proprietary and has been provided to you for a limited purpose. It must be returned or destroyed upon request. Disclosure, reproduction or use of this document and any information contained within it, in full or in part, for any purpose is forbidden without the prior written consent of HBB. No photographs may be taken of any article fabricated or assembled from this document without the prior written consent of HBB.



*** Factory Assembled, Not Available As Separate Pieces**

 4421 Waterfront Drive Glen Allen, VA 23060	Revision Description:		Added part number 990092900					
	Request Number:	HQE-7554	Revision Date:	5/20/09	Approved by:			
	Issue Code(s):	CS, SP	Page:	1 of 2	Document #:	510001200	Rev:	G

Replacement Parts Diagram HMD400 (Series A-B)

PROPRIETARY RIGHTS NOTICE This document and all information contained within it is the property of Hamilton Beach Brands, Inc. (HBB). It is confidential and proprietary and has been provided to you for a limited purpose. It must be returned or destroyed upon request. Disclosure, reproduction or use of this document and any information contained within it, in full or in part, for any purpose is forbidden without the prior written consent of HBB. No photographs may be taken of any article fabricated or assembled from this document without the prior written consent of HBB.

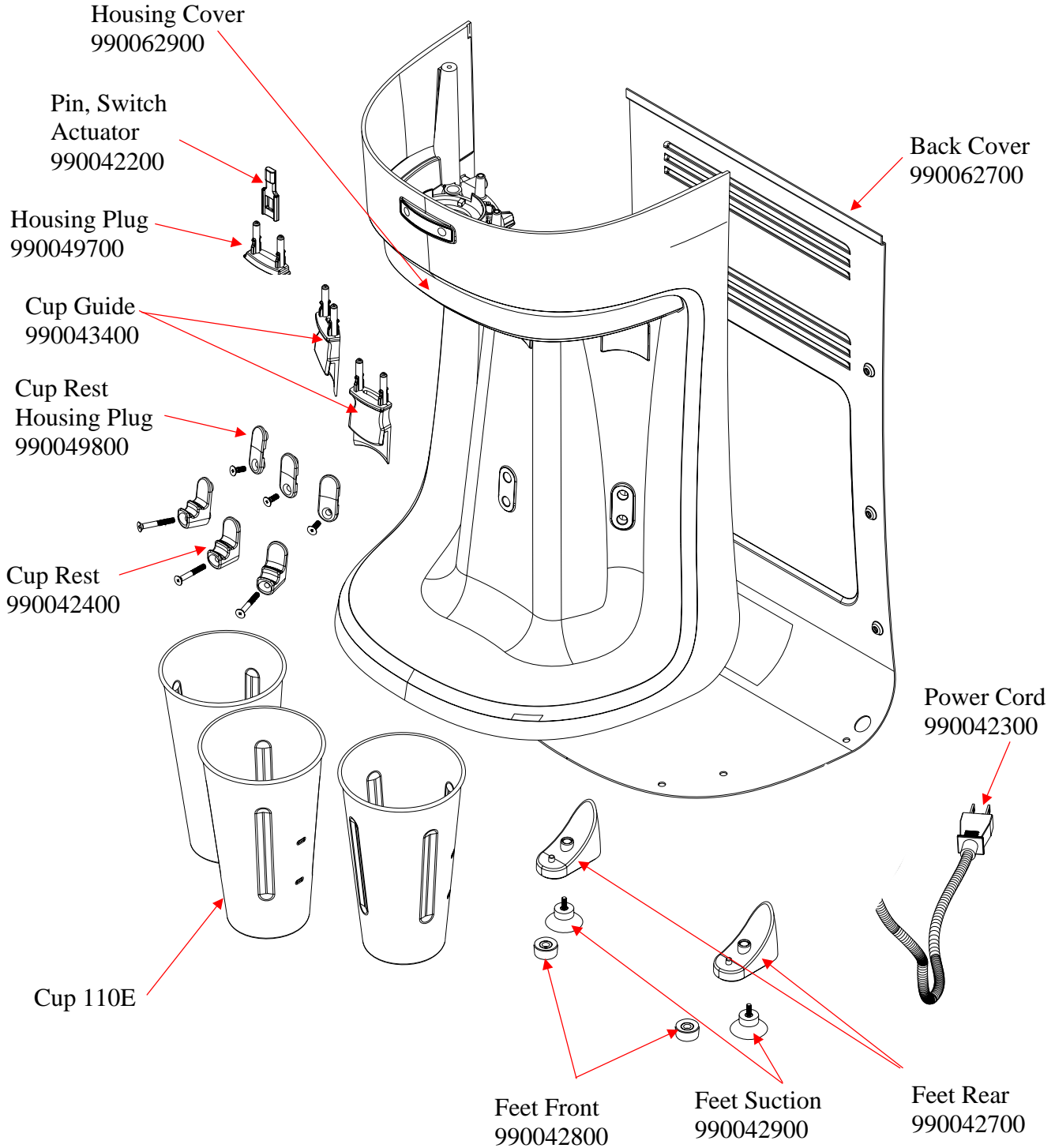

*Switch Upgrade Kit – 990092900

Includes: (1) Upper Lid, (3) Toggle Switch, (3) Boot, (3) Grounding Wire, and (3) Switch Adaptor

 4421 Waterfront Drive Glen Allen, VA 23060	Revision Description:		Added part number 990092900					
	Request Number:	HQE-7554	Revision Date:	5/20/09	Approved by:			
	Issue Code(s):	CS, SP	Page:	2 of 2	Document #:	510001200	Rev:	G