



Ice Machine Cleaning & Sanitizing

HOSHIZAKI

FS-1001MLH-C
FS-1022MLH-C
FS-1500MLH-C

The icemaker and dispenser must be cleaned & sanitized at least twice a year.

Cleaning Prep:

- 1 Close the icemaker water supply line shut-off valve.
- 2 Remove the **Front Panel**, move the power switch to **OFF**. Move the control switch is **DRAIN**, then move the power switch to **ON**. Replace the **Front Panel**.
- 3 Allow the water system to drain completely. Remove the **Front Panel**, move the power switch to **OFF**. Remove the **Top Panel**.
- 4 Unplug the icemaker from the electrical outlet.
Remove all ice from the ice storage bin and/or dispenser.

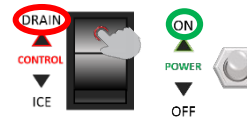
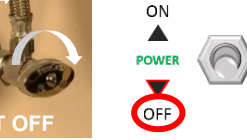

- ⚠ **ATTENTION! IF ON DISPENSER**, turn off the dispenser power supply after dispensing all the leftover ice.

⚠ ATTENTION!

DO NOT leave icemaker unattended when panels are off

AMMONIA Cleaners



Sanitizing:

- Dilute 5.25% chlorine bleach[‡] with warm water (see Table below) **15**

Sanitizing Solution	
Bleach	2.5 fl. oz (0.74 ml)
Warm Water	5 gal. (19 l)

[‡] Use bleach without additives.

- Remove the top panel **16**
- Remove the spout-to-chute strap (includes drip guide on FS-1500)
- Remove the spout, O-rings, packing and chute bracket (FS-1022 and smaller) or drip guide (FS-1500) between spout and chute

- Pour the sanitizing solution over the extruding head until the evaporator assembly and reservoir are full, and it starts to overflow into the drain pan **17**

- Remove the proximity switch from the chute assembly, then remove the chute assembly **18**

- Remove the packing at the bottom of the ice chute. Remove the 3 ties, the chute insulation, and 2 baffles

- Remove the plate and the packing from the top of the ice chute. Remove the backup bin control (by sliding it towards the chute opening & lifting it off)

- Disassemble the backup bin control assembly by removing the 2 snap pins, shaft, and actuator **19**

- Soak the spout, O-rings, packings, chute bracket (FS-1022 and smaller), drip guide (FS-1500), chute, baffles, plate, and backup bin control assembly in the sanitizing solution for 10 minutes then wipe them down **20**

Cleaning:

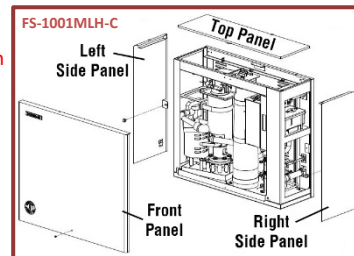
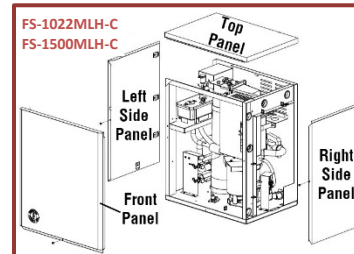
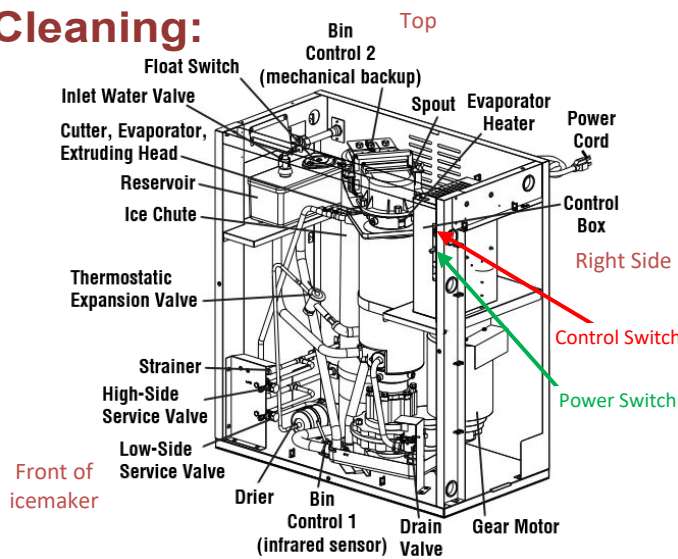

- 5 Remove the **Spout-to-Chute Strap** (includes **Drip Guide** on FS-1500), then remove the **Spout**.
- 6 Dilute Hoshizaki **Scale Away** with warm water (see Table).

Cleaning Solution	
Scale Away	9.6 fl. oz (0.29 l)
Warm Water	1.6 gal. (6.0 l)

Pour the cleaning solution over the **Extruding Head** until the **Evaporator Assembly** and the **Reservoir** are full and the solution starts to overflow into the drain pan.



Replace the **Spout**, **Spout-to-Chute Strap**, and **Drip Guide** (if applicable) in their correct positions.

Allow the icemaker to soak for **10 minutes** before operation.

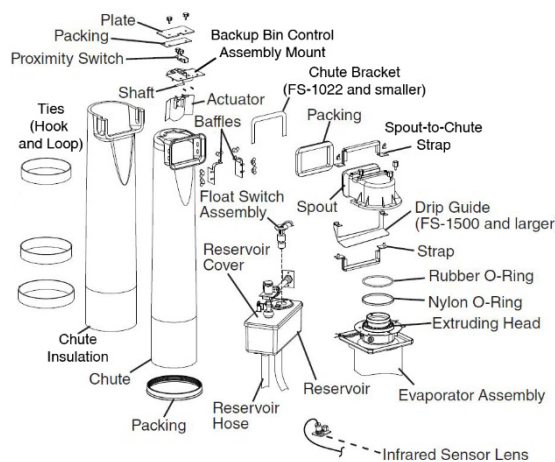

↪ continued on the back...

7 In bad water conditions, a more thorough soaking may be required. Remove the **Left Side Panel** and remove the **Float Switch** from the **Reservoir** cover. Clean the **Float Switch** with the solution, rinse thoroughly with clean water, and replace it back in the cover. Follow Step **6**, then place a clamp on the **Reservoir Hose** that will block the flow to the **Evaporator Assembly**. Pour additional cleaning solution over the **Extruding Head** until the **Evaporator Assembly** is full.

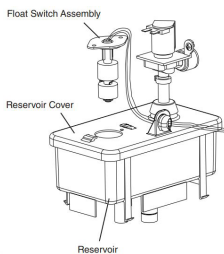

Allow to soak for **10 minutes**, remove the clamp before operation.

Otherwise, continue to Step **8**.

8 Wipe down the **Infrared Sensor Lens**, (located on the bottom of the icemaker). Rinse the lens with cleaning solution, then a clean, damp cloth.

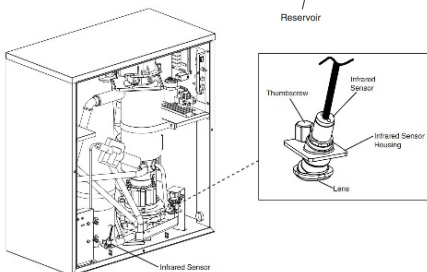

If the bottom of the icemaker is not accessible: Remove the thumbscrew securing the infrared sensor housing, then remove the housing from the base. After cleaning lens – replace the housing and secure thumbscrew.

9 Replace the **Top Panel**. Move the **control switch** to **ICE**, then **plug in** the icemaker. Move the **power switch** to **ON**. Replace the **Front Panel**. Make ice using the solution until it stops.

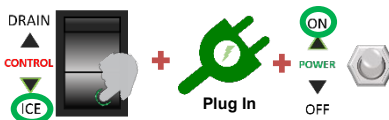

10 Remove the **Front Panel**, then move the **power switch** to **OFF**. Move the **control switch** to **DRAIN**. Move the **power switch** to **ON**, replace the **Front Panel**. Allow the icemaker to drain completely.

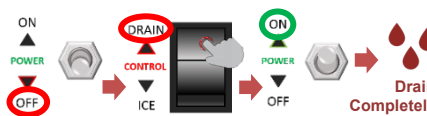

11 Remove the **Front Panel**. Move the **power switch** to **OFF**. Open the water supply line shut-off valve to supply water to the icemaker.

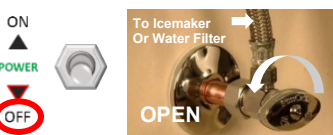

12 Move the **control switch** to **ICE** and the **power switch** to **ON**. Allow the icemaker to fill the reservoir with water.



13 After the gear motor starts, move the **power switch** to **OFF**, the **control switch** to **DRAIN**, then the **power switch** to **ON**. Replace the **Front Panel**. Allow the icemaker to drain completely.



The icemaker might make a noise/squealing when first started due to scale removal from auger/evaporator. This is normal in bad water conditions and will subside after 20 minutes.

14 Remove the **Front Panel**. Move the **power switch** to **OFF**. **Unplug** the icemaker. Close the icemaker water supply line shut-off valve.



Continue to **Sanitation – Step 15** on front...

↓ sanitizing continued...

- Rinse the parts thoroughly with clean water (if solution is left on these parts, they will rust) **21**
- Replace all parts in their correct positions (When installing the baffles, make sure the bent surface (the one without the studs) faces the actuator so that the bent surface can guide the ice to the center of the actuator)
- Replace all panels except the front panel in their correct positions
- Follow **Steps 9-14** using the sanitizing solution. **22**

SANITIZE 2:

- Repeat **Steps 15–17** then **Step 22** for complete ice/food safety **23**
- Remove the front panel **24**
- Move the **control switch** to **ICE**, plug in the icemaker
- Move the **power switch** to **ON**, replace the front panel
- Allow the icemaker to run for 30 minutes
- Remove the front panel **25**
- Move the **power switch** to **OFF**, unplug the icemaker
- Pour warm water into the dispenser/storage bin to melt any remaining ice
- Clean the dispenser/storage bin liner and cover with dish soap and a damp cloth. Rinse thoroughly with clean water
- Plug in icemaker, make sure **control switch** is set to **ICE**.
- Move the **power switch** to **ON**, replace the front cover to start the automatic icemaking process

DOWNLOAD COMPLETE INSTRUCTION MANUAL:



hoshizakiamerica.com/manuals

Type in the model number of your icemaker (including dashes) to download manuals

CLEANING SCHEDULE

- **Scoop** Dish soap, rinse well
 - **Water Filters** Check psi, change if req'd
 - **Exterior** Stainless Steel Cleaner
 - **Underside/Top Kit** Dish soap & damp cloth
 - **Icemaker/Dispenser** Follow these instructions
 - **Water Supply Inlet** Clean inlet screen/valves
 - **Extruding Head** Inspect seal bolts/ bearing wear. Tighten or replace
 - **Water Hoses** Inspect. Replace if req'd
- **DAILY** | • **MONTHLY** | • **BI-ANNUAL**

ATTENTION!

DO NOT use ammonia type cleaners. Can cause damage to icemaker

WEAR liquid-proof gloves and goggles to protect skin & eyes from cleaning & sanitizing chemicals



ATTENTION!

IF ICEMAKER IS ON DISPENSER, remember to turn on the dispenser after cleaning