



HR24C

Compact Undercounter Reach-in Refrigerator



HR24C
09/29/23
Item # 13556

Item #: _____
 Project: _____
 Qty: _____
 AIA#: _____

W x D x H
23.4" x 24.7" x 31.5"

ADA Compliant 



Features

- ▶ **Stainless steel interior and exterior front, sides and top**
- ▶ **UL approved for outdoor use**
- ▶ **Interior LED lighting**

- Stainless steel exterior door with aluminum interior comes standard with locks
- Field reversible door with full length tubular handle
- Magnetic door gasket is easily removable for cleaning
- Environmentally friendly insulation
- Electronic controls with LED Temperature Display and Audio/Visual Alarm
- High and low temperature alarms as well as "Door Open" alarm
- Automatic time-initiated defrost
- (3) Epoxy coated shelves standard
- 9 ft. cord and 5-15P NEMA plug
- Three year parts and labor warranty



Dimensions / Capacity

One Section HR24C

Interior Storage Capacity (CF) (AHAM)	3.87 ft ³
Overall Width x Depth (with handle)	23.4" x 26.5"
Height	31.5"
Depth with Door Open at 90°	46.7"
Adjustable Shelves	3
Shelf Dimensions (W x D)	(1) 18.5" x 17" , (2) 18.5 x 12"
Crated Weight	115 lbs.
Crated Shipping Dimensions (WxDxH)	26.8" x 24" x 36.6"

Electrical / Refrigeration

One Section HR24C

Voltage	115/60/1
HACR Breaker	15.0 Amps
Electrical Connection (NEMA)	5-15P 
Voltage Range	115-127
Ambient Temp. Range	45° to 100°F
Control Setpoint Range	34° to 52°F
Amperage	1.1
Energy Consumption (kWh/day) @ASHRAE	0.64
Heat Rejection (BTU/Hr.) @NSF	648
Approx. Nominal Compres. BTU/HR (HP)	501 (1/8HP)
Refrigerant (charge amount, oz.)	R600a (0.9 oz.)

Options

Warranty

3 Year - parts and Labor on entire machine.

Valid in United States, Canada, Puerto Rico and U.S. Territories. Contact factory for warranty in other countries.

If GFCI is required, a GFCI breaker MUST be used in lieu of GFCI receptacle

Hoshizaki reserves the right to change specifications without notice.



HR24C

Compact Undercounter Reach-in Refrigerator

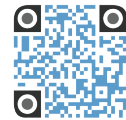

HR24C
09/29/23
Item # 13556

FRONT VIEW

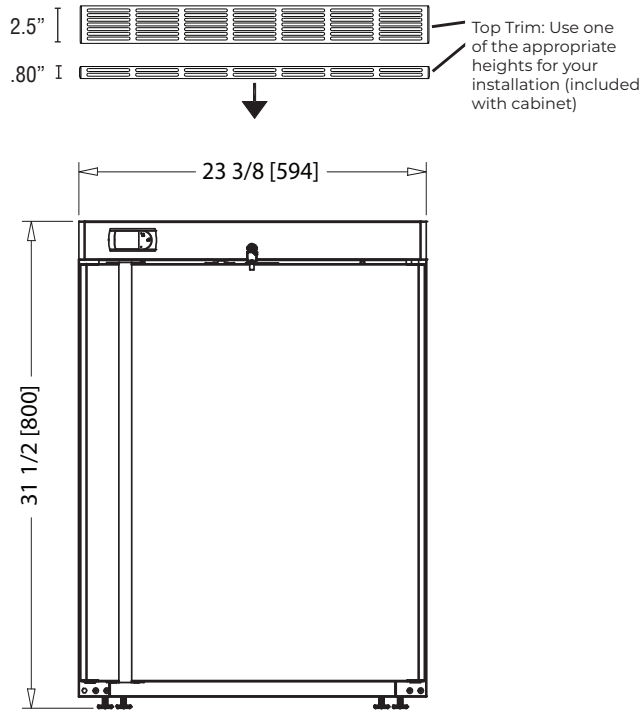

SIDE VIEW

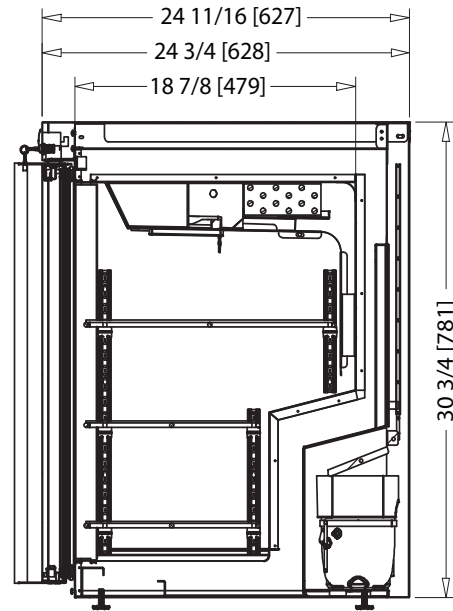

inch
[mm]

PLAN VIEW

