



Profit from the Eagle Advantage®

Specification Sheet

Short Form Specifications

Eagle 2200 Series Liquor Display Unit, model _____.
Top, front and backsplash to be heavy gauge type 304 stainless steel. Nominal 4 3/8" steps equipped with bottle guards to keep bottles from tipping over. 1 1/2" O.D. galvanized tubular legs with adjustable bullet feet.



liquor display unit



lower-tier liquor display unit

Options / Accessories

- Stainless steel leg kits

EAGLE GROUP

100 Industrial Boulevard, Clayton, DE 19938-8903 USA
Phone: 302-653-3000 • 800-441-8440 • Fax: 302-653-2065
www.eaglegrp.com
www.eaglegrpnews.com
www.eaglemhc.com

For custom configuration or fabrication needs, contact our SpecFAB® Division.
Phone: 302-653-3000 • Fax: 302-653-2065 • e-mail: quotes@eaglegrp.com

Item No.: _____
Project No.: _____
S.I.S. No.: _____

2200 Series Liquor Display Units

MODELS:

- LD24-22
- LLD24-22

Design and Construction Features

- Body is stainless steel all-welded construction.
- Provides storage under the bar for liquor and glass storage.
- Features bottle guard to keep bottles from tipping over.
- Enclosed sides.
- Adjustable bullet feet.
- Galvanized zinc plated gussets.
- 23 1/2" (597mm) front-to-back and 24" (610mm) side-to-side.
- 4 3/8" (111mm)-wide steps.
- 33 1/2" (851mm) overall height.
- Lower-tier liquor display unit is NSF-approved.



EG40.22 Rev. 08/23

Spec sheets available for viewing, printing or downloading from our online literature library at our websites

Eagle Foodservice Equipment, Eagle MHC, and SpecFAB® are divisions of Eagle Group. ©2023 by the Eagle Group



Item No.: _____
 Project No.: _____
 S.I.S. No.: _____

2200 Series Liquor Display Units

Liquor Display Unit

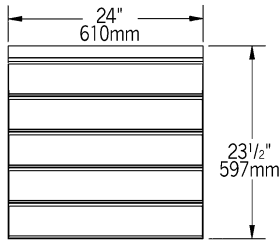

TOP VIEW

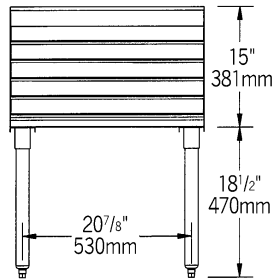

FRONT VIEW

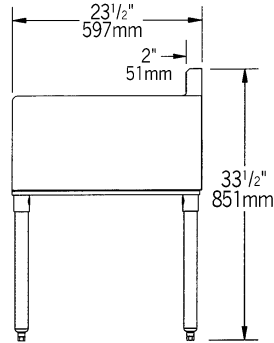

SIDE VIEW

| model # | width | | length | | weight | |
|---------|---------|-----|--------|-----|--------|------|
| | in. | mm | in. | mm | lbs. | kg |
| LD24-22 | 23 1/2" | 597 | 24" | 610 | 48 | 21.8 |

Lower-Tier Liquor Display Unit

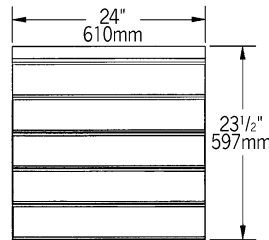

TOP VIEW

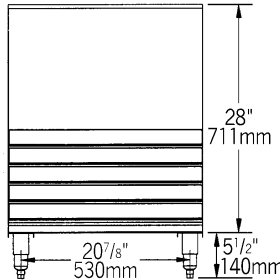

FRONT VIEW

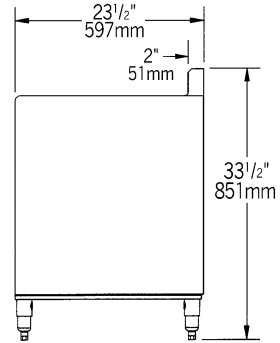

SIDE VIEW

| model # | width | | length | | weight | |
|----------|---------|-----|--------|-----|--------|------|
| | in. | mm | in. | mm | lbs. | kg |
| LLD24-22 | 23 1/2" | 597 | 24" | 610 | 48 | 21.8 |

Optional Stainless Steel Leg Kits

| add suffix # | description |
|--------------|--|
| -SL | stainless steel leg assemblies |
| -SLF | stainless steel leg assemblies & stainless steel feet |
| -SLG | stainless steel leg assemblies & stainless steel gussets |
| -SLGF | stainless steel leg assemblies, stainless steel feet & gussets |

EAGLE GROUP

100 Industrial Boulevard, Clayton, DE 19938-8903 USA

Phone: 302-653-3000 or 800-441-8440 • Fax: 302-653-2065

www.eaglegrp.com • www.eaglegrpnews.com • www.eaglehmc.com

Printed in U.S.A.

©2023 by Eagle Group

Rev. 08/23

Spec sheets available for viewing, printing or downloading from our online literature library at our websites

Although every attempt has been made to ensure the accuracy of the information provided, we cannot be held responsible for typographical or printing errors. Information and specifications are subject to change without notice. Please confirm at time of order.