



WSM7LE/K



6.6 L Planetary Mixer

6.6 L Planetary Mixer

Luna⁷



MAIN FEATURES

- Large, 6.6 liter stainless steel bowl with stainless steel handle
- Heavy-duty, ½ HP motor
- Front-mounted controls and LED power light
- 11 mixing speeds with variable speed control dial
- Removable, clear-view splash guard with feed chute
- Tilt-back head for easy removal of attachments and cleaning
- Heavy-duty head-lift/release lever
- Gear driven, permanent lube transmission
- Thermal overload protection
- Includes stainless steel bowl, chef's whisk, dough hook and mixing paddle
- Dishwasher-safe accessories
- Nonslip rubber feet

ELECTRICAL

Voltage: 220–240

Frequency: 50–60 Hz

Watts: 350

Amps: 1.5

Plug Type: WSM7LE – F Plug 

WSM7LK – G Plug 

Cord Length: 1.8 meters



SALES FEATURES

Equipped with a powerful, ½ HP motor, this heavy-duty, 6.6 liter planetary mixer is perfect for foodservice operations in need of a dependable mixing solution. Quickly mix ingredients for baked goods and desserts. Power through batters, mashed potatoes, and more. The variable control with 11 mixing speeds ensures efficiency and versatility. The tilt-back head makes it easy to add and remove attachments and simplifies cleanup.



@waringcommercial

©2022 Waring Commercial
314 Ella T. Grasso Avenue, Torrington, CT 06790
Tel. 800-492-7464 • Fax 860-496-9008

waringcommercialproducts.com

WSM7LE/K



PARTS & ACCESSORIES



WSM7LMP Stainless Steel Mixing Paddle



WSM7LW Stainless Steel Chef's Whisk



WSM7LDH Stainless Steel Dough Hook



WSM7LSG Splash Guard/Feed Chute



WSM7LBL 6.6 Liter Stainless Steel Bowl

DIMENSIONS (CM)

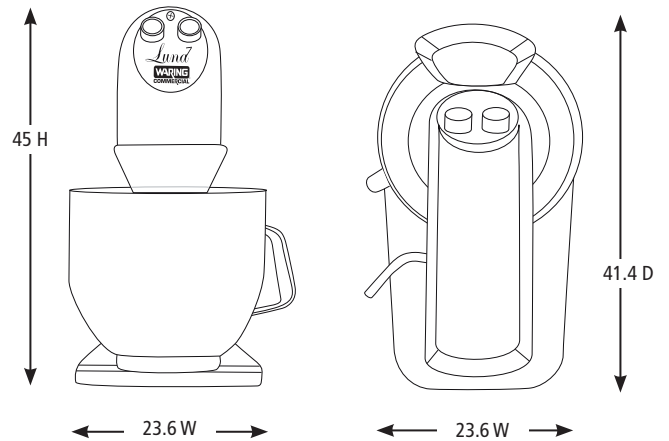
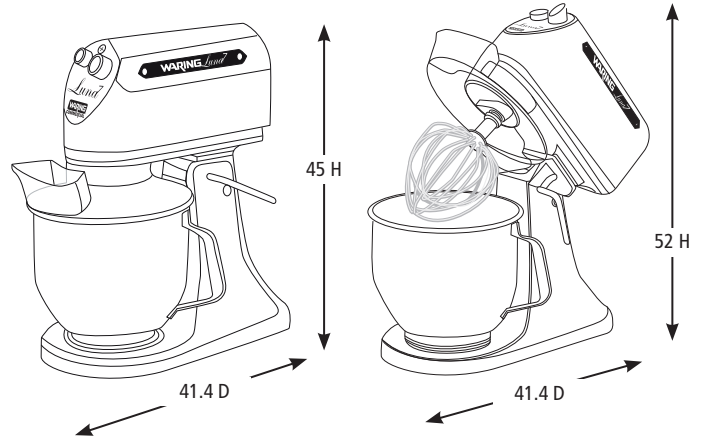

Out-of-Box Weight: 15.7 kg

ORDERING INFORMATION	#STD. PKG.	GIFTBOX WEIGHT (KG)	CUBIC METER	BOX DIMENSIONS D X W X H (CM)	UPC	CASE PKG.	MC WEIGHT (KG)	MC DIMENSIONS D X W X H (CM)	MBC
WSM7LE – 6.6 L Planetary Mixer	1	17.7	0.05	48.26 x 32.38 x 53.97	040072091773	1	18.8	49.53 x 35.56 x 55.56	10040072091770
WSM7LK – 6.6 L Planetary Mixer	1	17.7	0.05	48.26 x 32.38 x 53.97	040072091780	1	18.8	49.53 x 35.56 x 55.56	10040072091787



@waringcommercial

©2022 Waring Commercial
314 Ella T. Grasso Avenue, Torrington, CT 06790
Tel. 800-492-7464 • Fax 860-496-9008

waringcommercialproducts.com

21WI082317 / REV 12/21