



Model: \_\_\_\_\_ Item #: \_\_\_\_\_ Date: \_\_\_\_\_  
 Project: \_\_\_\_\_ Qty: \_\_\_\_\_ Approved By: \_\_\_\_\_

## Drainboards and Corner Drainboards

Royal Series Underbar



KR19-GS24



KR19-C24R

### Standard Features

- Stainless embossed drainboard top
- Optional perforated inserts available
- Built-in 1-1/4" drain (23-120)

### Specifications

<b>Drainboard</b>	<ul style="list-style-type: none"> <li>▪ 20 gauge embossed stainless steel reinforced with welded braces every 6"</li> <li>▪ 3/4" radius on all vertical and horizontal edges</li> </ul>
<b>Front Apron</b>	<ul style="list-style-type: none"> <li>▪ 20 gauge stainless steel clad over 20 gauge galvanized steel</li> </ul>
<b>Sides</b>	<ul style="list-style-type: none"> <li>▪ 20 gauge stainless steel</li> </ul>
<b>Backsplash</b>	<ul style="list-style-type: none"> <li>▪ 20 gauge stainless steel</li> </ul>
<b>Back and Bottom</b>	<ul style="list-style-type: none"> <li>▪ 20 gauge stainless steel</li> </ul>
<b>Legs</b>	<ul style="list-style-type: none"> <li>▪ 1-5/8" tubular 16 gauge stainless steel with gray plastic bullet feet</li> </ul>
<b>Plumbing</b>	<ul style="list-style-type: none"> <li>▪ 1-1/4" IPS drain connection</li> </ul>

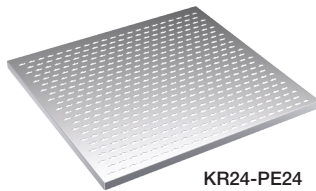

KR24-PE24

### Optional Perforated Inserts for Drainboards

- Stainless perforated top with hemmed edges & welded corners
- Removable for easy cleaning
- Applies to standard and corner drainboards

**NOTE:** Perforated Inserts must be ordered with drainboard and cannot be added in the field.

Model	Length	Depth	Model	Length	Depth
KR19-PE12	12"	19"	KR24-PE12	12"	24"
KR19-PE18	18"	19"	KR24-PE18	18"	24"
KR19-PE24	24"	19"	KR24-PE24	24"	24"
KR19-PE30	30"	19"	KR24-PE30	30"	24"
KR19-PE36	36"	19"	KR24-PE36	36"	24"
KR19-PE42	42"	19"	KR24-PE42	42"	24"
KR19-PE48	48"	19"	KR24-PE48	48"	24"

### Optional Accessories

Model	Description
KR-303	Left and Right End Side Splashes for KR19
KR-310	Right End Splash for KR19
KR-311	Left End Splash for KR19
KR-313	Left and Right End Side Splashes for KR24
KR-314	Right End Splash for KR24
KR-315	Left End Splash for KR24
KR-201	4" x 4" Chase for Beer/Soda lines
KR-203	3/4" x 3-1/2" Soda Line Cutout in Backsplash
KR-204	3-1/2" Round Cutout for Soda/Beer Lines in Drainboard
RS-"XX"	Single Speed Rail ("XX" indicates size)
RD-"XX"	Double Speed Rail ("XX" indicates size)

### Product Compliance



- NSF-2

#### WARNING:

Plumbing connections should be made by qualified personnel who will observe all applicable plumbing, sanitary and safety codes.

#### California Prop 65 Warning:

This product can expose you to chemicals including lead and lead compounds, which are known to the State of California to cause cancer and birth defects or other reproductive harm. For more information go to [www.P65Warnings.ca.gov](http://www.P65Warnings.ca.gov).



Model: \_\_\_\_\_ Item #: \_\_\_\_\_ Date: \_\_\_\_\_  
 Project: \_\_\_\_\_ Qty: \_\_\_\_\_ Approved By: \_\_\_\_\_

## Drainboards and Corner Drainboards

### Royal Series Underbar

#### Standard Drainboards

Model	Overall Length (A)	Left Side to Drain (B)	Depth	Back Side to Drain	Weight (lbs.)
KR19-GS12	12"	6"	19"	9-1/2"	38
KR19-GS18	18"	14"	19"	9-1/2"	44
KR19-GS24	24"	20"	19"	9-1/2"	50
KR19-GS30	30"	26"	19"	9-1/2"	56
KR19-GS36	36"	32"	19"	9-1/2"	62
KR19-GS42	42"	21"	19"	9-1/2"	68
KR19-GS48	48"	24"	19"	9-1/2"	74
KR24-GS12	12"	6"	24"	11-1/2"	43
KR24-GS18	18"	14"	24"	11-1/2"	49
KR24-GS24	24"	20"	24"	11-1/2"	55
KR24-GS30	30"	26"	24"	11-1/2"	61
KR24-GS36	36"	32"	24"	11-1/2"	68
KR24-GS42	42"	21"	24"	11-1/2"	75
KR24-GS48	48"	24"	24"	11-1/2"	82

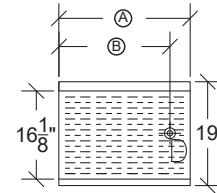
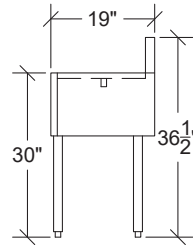

KR19 Standard Drainboard

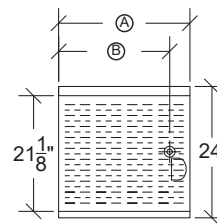
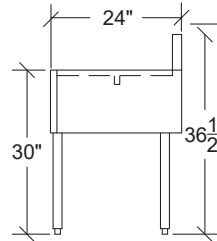

KR24 Standard Drainboard

#### Corner Drainboards

Model	Overall Length (A)	Left Side to Drain (B)	Depth	Back Side to Drain	Return End	Weight (lbs.)
KR19-C18L	18"	4"	19"	9-1/2"	Left	41
KR19-C18R	18"	14"	19"	9-1/2"	Right	41
KR19-C24L	24"	4"	19"	9-1/2"	Left	47
KR19-C24R	24"	20"	19"	9-1/2"	Right	47
KR19-C30L	30"	4"	19"	9-1/2"	Left	53
KR19-C30R	30"	26"	19"	9-1/2"	Right	53
KR19-C36L	36"	4"	19"	9-1/2"	Left	59
KR19-C36R	36"	32"	19"	9-1/2"	Right	59
KR19-C42L	42"	4"	19"	9-1/2"	Left	65
KR19-C42R	42"	38"	19"	9-1/2"	Right	65
KR19-C48L	48"	4"	19"	9-1/2"	Left	71
KR19-C48R	48"	44"	19"	9-1/2"	Right	71
KR24-C18L	18"	4"	24"	11-1/2"	Left	51
KR24-C18R	18"	14"	24"	11-1/2"	Right	51
KR24-C24L	24"	4"	24"	11-1/2"	Left	57
KR24-C24R	24"	20"	24"	11-1/2"	Right	57
KR24-C30L	30"	4"	24"	11-1/2"	Left	64
KR24-C30R	30"	26"	24"	11-1/2"	Right	64
KR24-C36L	36"	4"	24"	11-1/2"	Left	70
KR24-C36R	36"	32"	24"	11-1/2"	Right	70
KR24-C42L	42"	4"	24"	11-1/2"	Left	77
KR24-C42R	42"	38"	24"	11-1/2"	Right	77
KR24-C48L	48"	4"	24"	11-1/2"	Left	85
KR24-C48R	48"	44"	24"	11-1/2"	Right	85

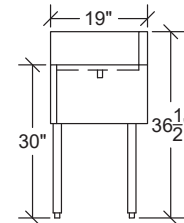
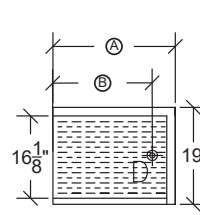

KR19 Corner Drainboard with Right Return

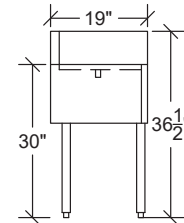
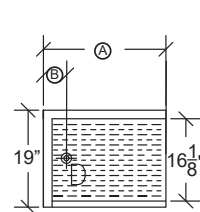

KR19 Corner Drainboard with Left Return

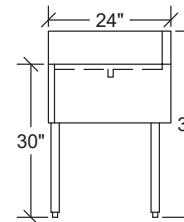
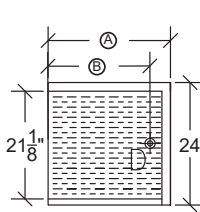

KR24 Corner Drainboard with Right Return

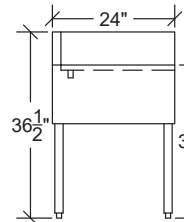
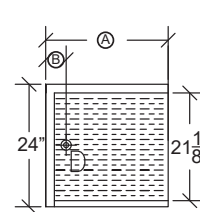

KR24 Corner Drainboard with Left Return