



**GOLD MEDAL® PRODUCTS CO.**

# Combo Candy King

Model No. 2182-00-200 and 2182-00-210

## Specifications



Left Hand Dump; Unit shown with Corn Treat Drum.

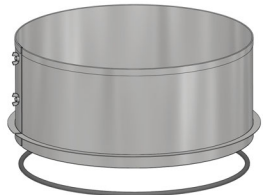

**Short Drum**  
(for Frosted Nuts/Fudge)



**Pralinator Paddle**

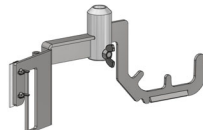

**Fudge Paddle**

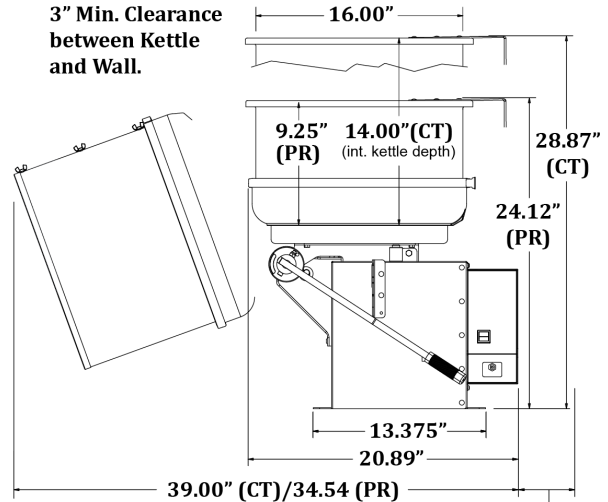

3" Min. Clearance between Kettle and Wall.

6" Recommended Min. Clearance between Wall and Cntl Box for Service.

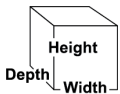

Unit includes Paddles and Drums shown

General RH Unit shown above for dim. reference.

### Overall Dimensions:

**Width:** 20.89" (53 cm)  
**Depth:** 17.6" (44.7 cm)  
**Height:** 28.87" (73.4 cm)

Reference drawing shown for additional dimensions and clearances required.

### Electrical - Domestic

120/208 OR 120/240V  
3408 WATTS 60 Hz  
(NEMA L14-20P) Plug

Unit designed to operate on single phase, 20 AMP, 4 wire supply (2 Hot, 1 Neutral, 1 Ground). Wall receptacle is supplied with unit.

### Features:

- **Model 2182 (200)** - Right Hand Dump  
**Model 2182 (210)** - Left Hand Dump
- Combination Unit with Paddles/Drums for making:
  - Caramel Corn:** 5 gal. capacity (3-4 batches/hour)
  - Frosted Nuts:** yields 4 to 4.5 lbs. finished product per batch
  - Fudge:** uses 7 lbs. of dry fudge mix/batch; yields approx. 8 lbs. of fudge
- Membrane Keypad Control with 2-line digital display
- Cast Aluminum Kettle with Stainless Steel Drum

**Plug Type:**



**Agency Approvals:**



**Gold Medal Products Co.**  
10700 Medallion Drive, Cincinnati, OH 45241

Ph: (513) 769-7676, (800) 543-0862; Fax: (513) 769-8500  
gmpopcorn.com info@gmpopcorn.com