

"4CO4R1.5" MODULAR BASE WORK TABLES

14GA Stainless Steel Top w/1½" Rear Riser - Open Front

FEATURES:

- 1-1/2" Rear Riser With 1-1/2" Stallion Edge On Front And 90 Degree Bend Down Side Edge For Table Line-Up
- Top Is Sound Deadened Reinforced With 2"x3" Channel Running Entire Length Of Top
- Stainless Steel Leg With Adjustable Feet
- Optional Fixed (Suffix "-1S") Or Adjustable (Suffix "-1AS") Intermediate Shelf Available
- 36" Working Height
- Shipped Standard Welded Set-Up

SPECIFICATIONS:

- Top: Stainless Steel Cabinet Tops TIG Welded, Exposed Welds Are Polished To Match Adjacent Surface #4 Polished, Satin Finish
- Removable Stainless Steel Legs
- Top: 14GA Type 300 Stainless Steel With #4 Polish, Satin Finish
- Body: 18GA Type 430 Stainless Steel
- Legs: Stainless Steel With Adjustable Feet



4CO4R1.5-3048

CERTIFICATIONS:



"4CO4R1.5" MODULAR BASE WORK TABLES

LENGTH	24" WIDE	WT (LBS)	30" WIDE	WT (LBS)	36" WIDE	WT (LBS)
36"	4CO4R1.5-2436	200	4CO4R1.5-3036	225	4CO4R1.5-3636	250
48"	4CO4R1.5-2448	240	4CO4R1.5-3048	260	4CO4R1.5-3648	290
60"	4CO4R1.5-2460	280	4CO4R1.5-3060	300	4CO4R1.5-3660	330
72"	4CO4R1.5-2472	325	4CO4R1.5-3072	340	4CO4R1.5-3672	375
84"	4CO4R1.5-2484	365	4CO4R1.5-3084	380	4CO4R1.5-3684	415
96"	4CO4R1.5-2496	415	4CO4R1.5-3096	425	4CO4R1.5-3696	460
108"	4CO4R1.5-24108	455	4CO4R1.5-30108	465	4CO4R1.5-36108	460
120"	4CO4R1.5-24120	490	4CO4R1.5-30120	540	4CO4R1.5-36120	540
132"	4CO4R1.5-24132	525	4CO4R1.5-30132	570	4CO4R1.5-36132	583
144"	4CO4R1.5-24144	560	4CO4R1.5-30144	600	4CO4R1.5-36144	625

ALL DIMENSIONS ARE TYPICAL. TOLERANCE +/- .500". JOHN BOOS & CO. RESERVES THE RIGHT TO CHANGE SPECIFICATIONS WITHOUT NOTICE.

DETAILED SPECIFICATIONS

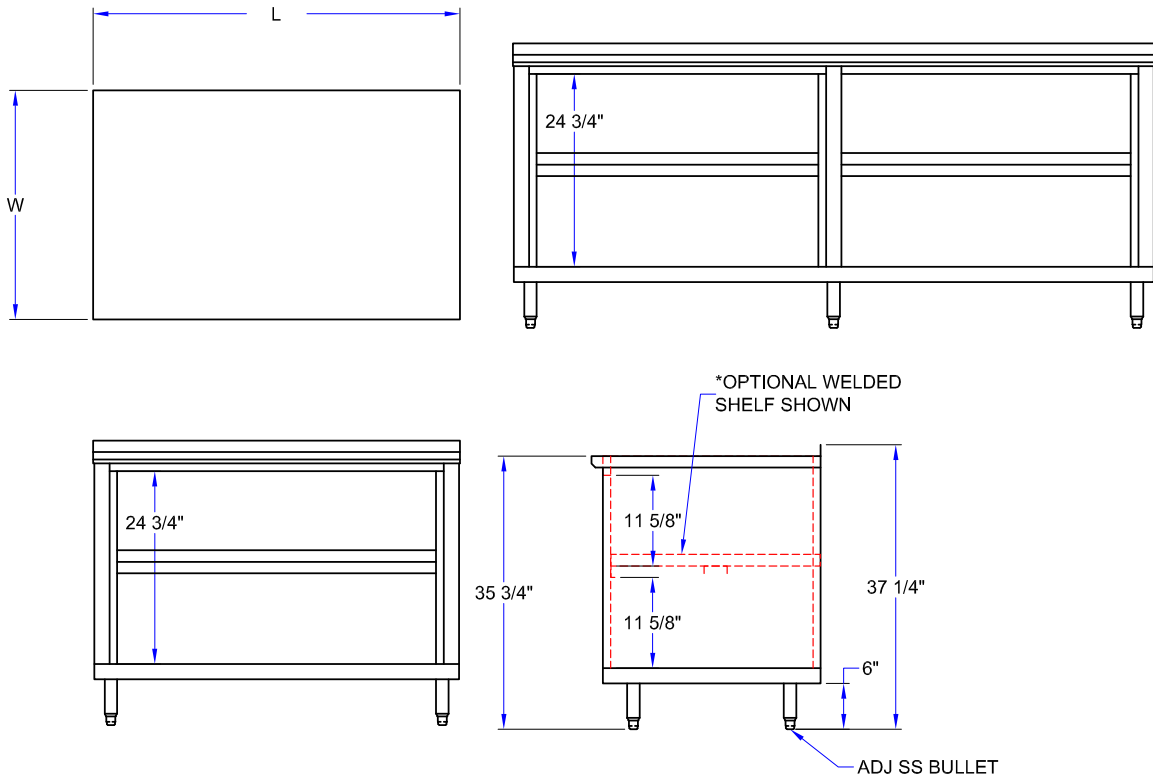

MODEL # STRUCTURE

R = Riser
 4 = 14GA
 CO = Open Front
 4 = 430 S.S. Body

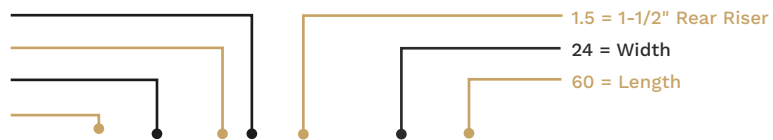

4CO4R1.5-2460

"4CO4R1.5" MODULAR BASE WORK TABLES

LENGTH	24" WIDE	WT (LBS)	30" WIDE	WT (LBS)	36" WIDE	WT (LBS)
36"	4CO4R1.5-2436	200	4CO4R1.5-3036	225	4CO4R1.5-3636	250
48"	4CO4R1.5-2448	240	4CO4R1.5-3048	260	4CO4R1.5-3648	290
60"	4CO4R1.5-2460	280	4CO4R1.5-3060	300	4CO4R1.5-3660	330
72"	4CO4R1.5-2472	325	4CO4R1.5-3072	340	4CO4R1.5-3672	375
84"	4CO4R1.5-2484	365	4CO4R1.5-3084	380	4CO4R1.5-3684	415
96"	4CO4R1.5-2496	415	4CO4R1.5-3096	425	4CO4R1.5-3696	460
108"	4CO4R1.5-24108	455	4CO4R1.5-30108	465	4CO4R1.5-36108	460
120"	4CO4R1.5-24120	490	4CO4R1.5-30120	540	4CO4R1.5-36120	540
132"	4CO4R1.5-24132	525	4CO4R1.5-30132	570	4CO4R1.5-36132	583
144"	4CO4R1.5-24144	560	4CO4R1.5-30144	600	4CO4R1.5-36144	625

ALL DIMENSIONS ARE TYPICAL. TOLERANCE +/- .500". JOHN BOOS & CO. RESERVES THE RIGHT TO CHANGE SPECIFICATIONS WITHOUT NOTICE.