

"UBGR-21" UNDERBAR GLASS RACK

21" Width

FEATURES:

- 18GA Stainless Steel Construction
- Type 300 Stainless Steel With #4 Polish, Satin Finish
- Standard Pre-Drilled Holes On Sides For Attaching Adjacent Units Together
- Adjustable Glass Rack Rails For Tall Stemware
- Removable Perforated Drainboard Insert For Increased Air Circulation
- Top And Bottom Drains With Hose And Fittings
- Stainless Steel Front To Back Bracing

SPECIFICATIONS:

- Top: 18GA Type 300 Stainless Steel
- Front Apron: 18GA Type 300 Stainless Steel
- Backsplash: 18GA Type 300 Stainless Steel
- Sides: 18GA Type 300 Stainless Steel
- Bolt On 1-5/8" Stainless Steel Legs For Fast Installation
- 1" Adjustable Stainless Steel Bullet Feet
- Z-Clip To Mount To Wall
- Bolt To Adjacent Underbar Piece
- Mounting Options Allow For Flexible Installation Options To Remove Back Or Front And Back Legs For A Clean Installation
- Two Barbed 1/2" Drains With 1/2" Clear Hose And Fittings



UBGR-2124

CERTIFICATIONS:



ACCESSORIES

MODEL	DESCRIPTION
UBSS-21-L	Slim-Line Left Hand Side Splash
UBSS-21-R	Slim-Line Right Hand Side Splash

"UBGR-21" UNDERBAR GLASS RACK

MODEL	SIZE (LXWXH)	WEIGHT (LBS)
UBGR-2124	24"x21"x32-1/2"	64

ALL DIMENSIONS ARE TYPICAL. TOLERANCE +/- .500". JOHN BOOS & CO. RESERVES THE RIGHT TO CHANGE SPECIFICATIONS WITHOUT NOTICE.

DETAILED SPECIFICATIONS

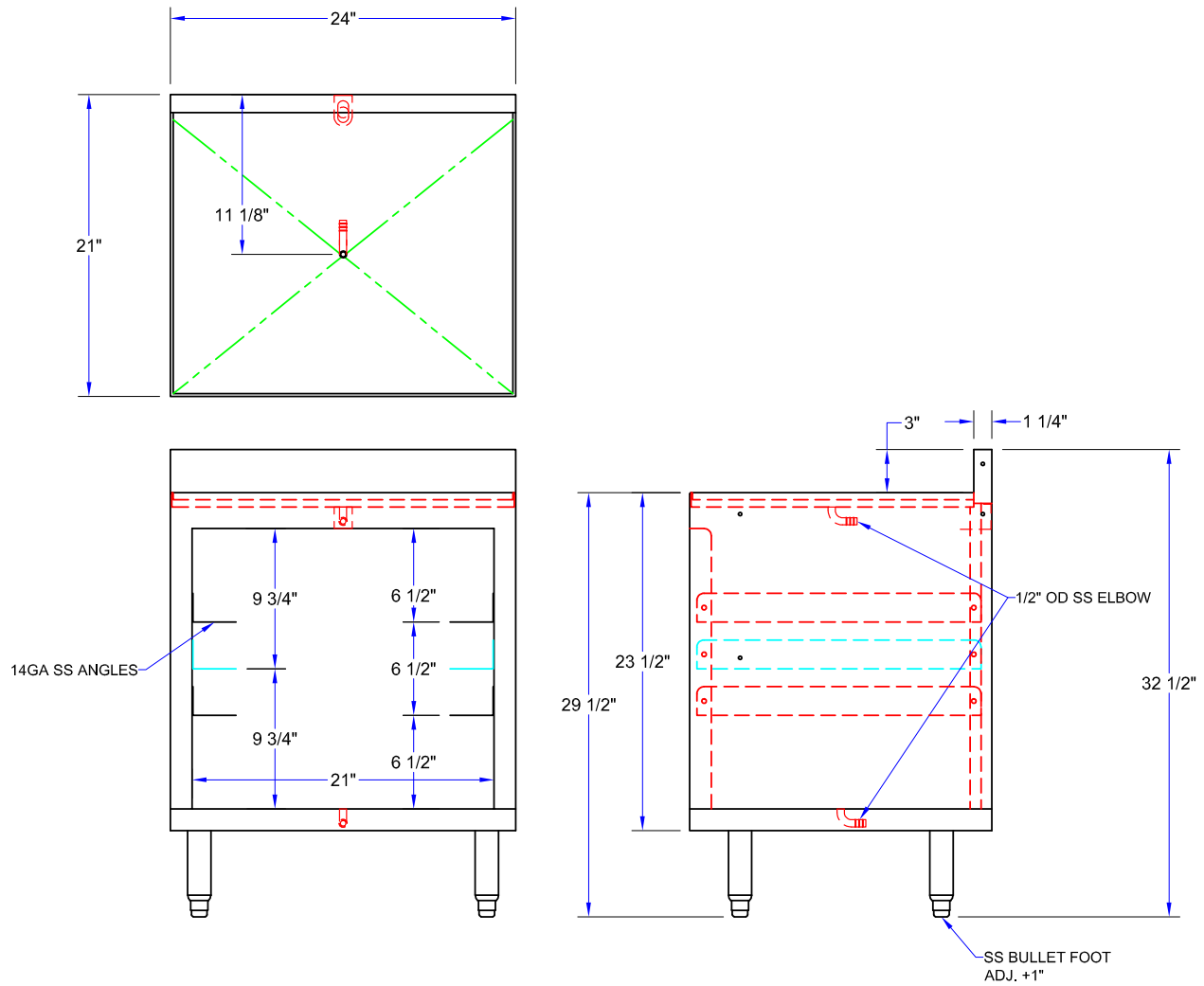

"UBGR-21" UNDERBAR GLASS RACK

MODEL	SIZE (LXWXH)	WEIGHT (LBS)
UBGR-2124	24"x21"x32-1/2"	64

ALL DIMENSIONS ARE TYPICAL. TOLERANCE +/- .500". JOHN BOOS & CO. RESERVES THE RIGHT TO CHANGE SPECIFICATIONS WITHOUT NOTICE.