



PASS THRU STATION EQUIPMENT
TSS Series Ice Chest Accessories



TSS12U2

| | |
|-----------|--|
| JOB | |
| AREA | |
| ITEM NO. | |
| MODEL NO. | |

| MODELS | |
|---------|---------|
| TSS6CO | TSS6CO2 |
| TSS6FA | TSS12U |
| TSS12U2 | TSS12U3 |
| TSS6U | TSS6U2 |

KEY PRODUCT FEATURES AND BENEFITS

- All stainless construction for durability and ease of cleaning
- Insulated to hold ice for an entire shift and keep your mixes or condiments chilled
- Speed rails can land on or span across these units
- Matches up to the ice bins for appearance and easy assembly
- Keeps you juice and mixes cold without putting directly into the ice for increased sanitation

Quick Features:

- Available in 6" or 12" wide and 18" and 24" front to back
- Stainless construction with seamless interior lining for easy cleaning
- Bottle wells hold your juices, mixes, or condiments right where you need it
- Mounts easily to the ice chest to keep your cocktail supplies close at hand

MODEL NUMBERS - TSS6CO, TSS6CO2, TSS6FA, TSS12U, TSS12U2, TSS12U3, TSS6U, TSS6U2



PASS THRU STATION EQUIPMENT
TSS Series Ice Chest Accessories

MODEL NUMBERS - TSS6CO, TSS6CO2, TSS6FA, TSS12U, TSS12U2, TSS12U3, TSS6U, TSS6U2

| MODEL NOS. | TSS6CO | TSS6CO2 | TSS6FA | TSS6U | TSS6U2 | TSS12U | TSS12U2 | TSS12U3 |
|------------------|---|---|----------------|----------------|--|---|--|--|
| DESCRIPTION | Flat top both sides | Flat top customer side 3 bottle wells on bartender side | Fat top filler | One open chest | 3 bottle wells | One open chest | 6 bottle wells | 12 bottle wells |
| LENGTH IN (mm) | 6" (152) | | | | | 12" (305) | | |
| SHIP WT LBS (kg) | 38 (17) | 38 (17) | 30 (14) | 30 (14) | 30 (14) | 36 (16) | 36 (16) | 36 (16) |
| GENERAL | Top, front, bottom, back, and sides are stainless steel | | | | | | | |
| INTERIOR | Stainless steel with 1/4" radius corners, welded and sealed | | | | | | | |
| BACKSPLASH | No backsplash on pass thru equipment | | | | | | | |
| LEGS | Not provided. Requires adjacent support | | | | | 1-5/8" tubular, stainless steel with 1" adjustable thermoplastic feet | | |
| INSULATION | Fiberglass | | | | | Foamed-in-place polyurethane | | |
| BOTTLE WELLS | NA | Black, high Impact, polypropylene, QTY 3 | NA | NA | Black, high Impact, polypropylene, QTY 3 | NA | Black, high Impact, polypropylene, QTY 6 | Black, high Impact, polypropylene, QTY 8 |
| PLUMBING | Drain connection: 1/2" NPS | | | | | | | |

TSS12U2

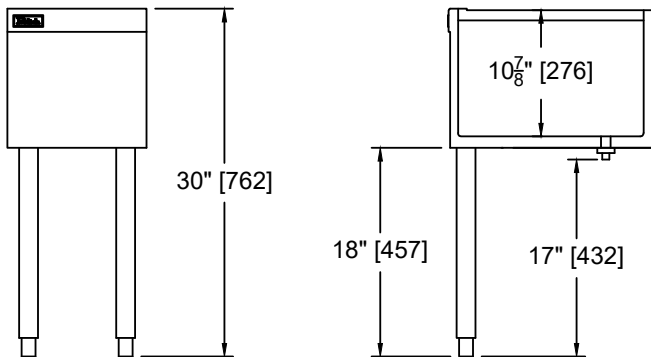
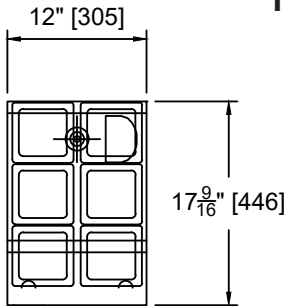

TSS Bottle Wells

