

# "EPT6R5-SSK" STAINLESS STEEL PREP TABLE W/SINK

## 16GA Top w/Stainless Base & Adjustable Undershelf - 5" Riser

**FEATURES:**

- 16GA Stainless Steel Top w/5" Riser & Turndown
- Type 300 Stainless Steel With #4 Polish, Satin Finish
- 1-1/2" Stallion Edge On Front With Side Edges 90 Degree Bend Down For Table Line-Up
- (1) 16"x20"x12" Bowl
- Stainless Steel Base With Adjustable Undershelf
- Adjustable Bullet Feet
- Shipped Knocked-Down, Easy-To-Assemble
- Includes (1) Deck Mounted Faucet 4" O/C w/10" Swing Spout

**SPECIFICATIONS:**

- Top: Stainless Steel Tops Are Tig Welded, Exposed Welds Are Polished To Match Adjacent Surface
- Top: 16GA Stainless Steel Type 300 Stainless Steel With #4 Polish, Satin Finish
- Shelf: 18GA Stainless Steel,
- Legs: 1-5/8" Round O.D. 16GA Tubular Stainless Steel
- Gussets: Stainless Steel
- Feet: 1" Adjustable Stainless Bullet Feet



EPT6R5-3060SSK-R

**CERTIFICATIONS:**



### "EPT6R5-SSK" STAINLESS STEEL PREP TABLE W/SINK

MODEL	SINK BOWL LOCATION	SIZE (L X W X H)	WEIGHT (LBS)
EPT6R5-3048SSK-L	Left	48"x30"x35-3/4"	145
EPT6R5-3048SSK-R	Right	48"x30"x35-3/4"	145
EPT6R5-3060SSK-L	Left	60"x30"x35-3/4"	171
EPT6R5-3060SSK-R	Right	60"x30"x35-3/4"	171
EPT6R5-3072SSK-L	Left	72"x30"x35-3/4"	202
EPT6R5-3072SSK-R	Right	72"x30"x35-3/4"	202

ALL DIMENSIONS ARE TYPICAL. TOLERANCE +/- .500". JOHN BOOS & CO. RESERVES THE RIGHT TO CHANGE SPECIFICATIONS WITHOUT NOTICE.

# DETAILED SPECIFICATIONS

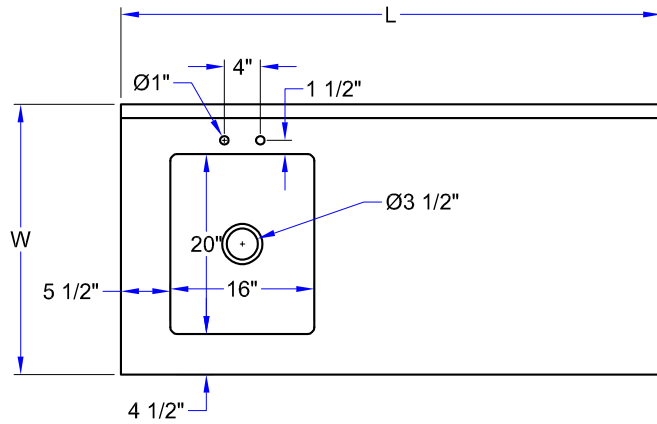

Units 7 Ft. & Larger Are  
Furnished With Six Legs  
Shelf Length = Length Minus 4.875"  
Shelf Width = Width Minus 4.25"

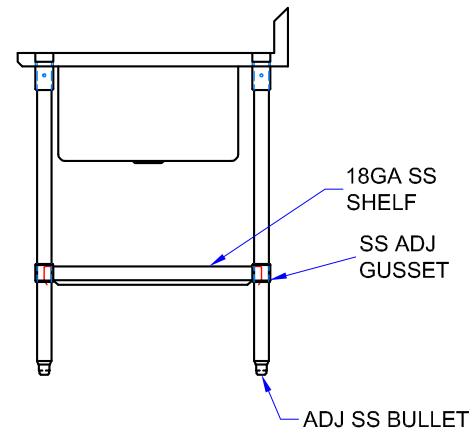
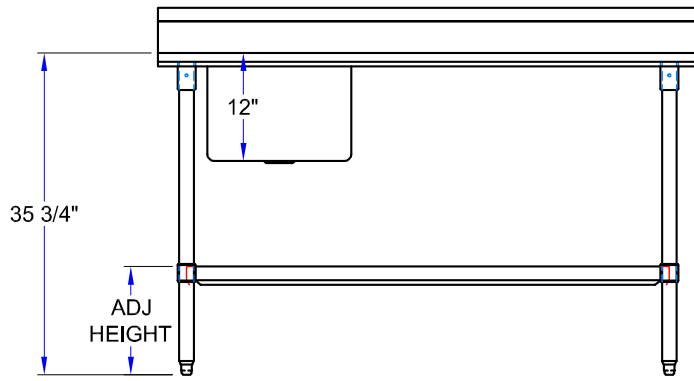

## MODEL # STRUCTURE

- 30 = Width Of Work Surface
- 5 = Ht. Of Riser w/Turndown
- R = Riser Top Work Table
- 6 = 16GA Work Surface
- EPT = Economy Prep Table



- 60 = Length Of Work Surface
- SS = Stainless Steel Base & Shelf
- K = Ships Knocked Down
- L = Bowl Location

### "EPT6R5-SSK" STAINLESS STEEL PREP TABLE W/SINK

MODEL	SINK BOWL LOCATION	SIZE (L X W X H)	WEIGHT (LBS)
EPT6R5-3048SSK-L	Left	48"x30"x35-3/4"	145
EPT6R5-3048SSK-R	Right	48"x30"x35-3/4"	145
EPT6R5-3060SSK-L	Left	60"x30"x35-3/4"	171
EPT6R5-3060SSK-R	Right	60"x30"x35-3/4"	171
EPT6R5-3072SSK-L	Left	72"x30"x35-3/4"	202
EPT6R5-3072SSK-R	Right	72"x30"x35-3/4"	202

ALL DIMENSIONS ARE TYPICAL. TOLERANCE +/- .500". JOHN BOOS & CO. RESERVES THE RIGHT TO CHANGE SPECIFICATIONS WITHOUT NOTICE.