



# SPEC SHEET

## KoolMore 25 in. Commercial Stainless Steel 1-Door Reach-In Freezer, 12 cu. ft.

SKU: RIF-1D-SS12C

### FEATURES

- Ideal for restaurants, cafes, hotels, and commercial kitchens. A bottom-mounted compressor and raised bottom shelf make for convenient loading, unloading, and maintenance. Features recessed handles for easy access, a self-closing feature that ensures food remains frozen and fresh and three deep adjustable shelves coated in epoxy for maximum corrosion resistance.
- This tall freezer can hold up to 12 cu. ft. of space, counts with external digital controls, and display to easily monitor and control temperature.
- Highly certified: ETL Listed for Safety and Sanitation, making it NSF ANSI 7 Standard for Commercial refrigerators. It's time to make your kitchen more. It's time for KoolMore.



### CLOSE UP IMAGES



# TECHNICAL SPECS

## Dimensions

|                                 |      |
|---------------------------------|------|
| Depth                           | 23.5 |
| Width                           | 24.8 |
| Height                          | 63.3 |
| Interior Depth                  | 18.7 |
| Interior Width                  | 21.1 |
| Interior Height                 | 44.5 |
| Shelf Width                     | 20.2 |
| Shelf Depth                     | 17.7 |
| Depth Including Handles         | 23.5 |
| Depth Excluding Handles         | 23.5 |
| Depth Less Door                 | 20.7 |
| Depth With Door Open 90 Degrees | 46.4 |
| Power Cord Length               | 98.5 |

## Capacity

|                           |         |
|---------------------------|---------|
| Gross Cubic Feet          | 11      |
| Net Capacity Cu. Ft.      | 10.1    |
| Individual Shelf Capacity | 88l bs. |

## Features & Material

|                           |                     |
|---------------------------|---------------------|
| Door Style                | Swing               |
| Number Of Doors           | 1                   |
| Number Of Shelves         | 3                   |
| Defrost Type              | Automatic           |
| Refrigerant Type          | R-290               |
| Temperature Control Type  | External Digital    |
| Ambient Temperature Range | 100 F               |
| Temperature Range         | - 7 F~0 F           |
| Casters                   | 4                   |
| Light Type                | Fluorescent Bulb    |
| Shelf Material Type       | Epoxy Coated        |
| Interior Material         | Stainless Steel 201 |
| Exterior Material         | Stainless Steel 304 |

## Electric Data & Certifications

|                |                                      |
|----------------|--------------------------------------|
| Amps           | 4.7                                  |
| Phase          | 1                                    |
| Plug Type      | NEMA 5-15P                           |
| Voltage        | 115                                  |
| Certifications | ETL Listed for Safety and Sanitation |

# Plan View

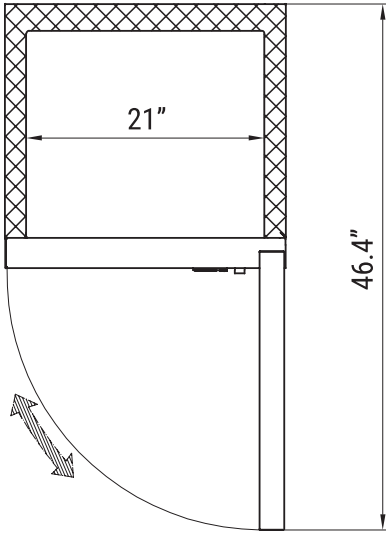
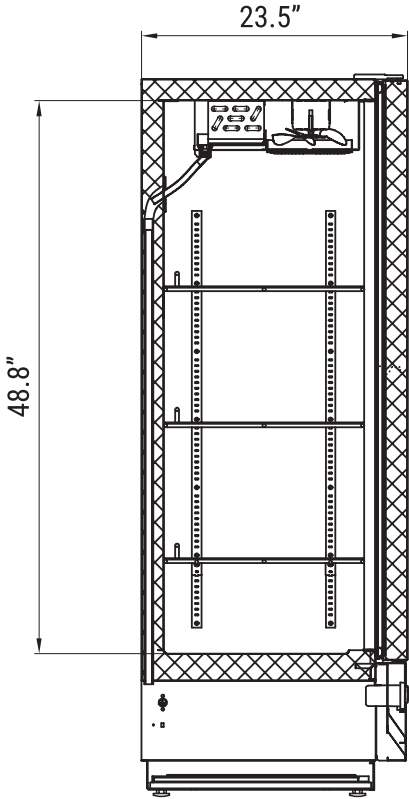
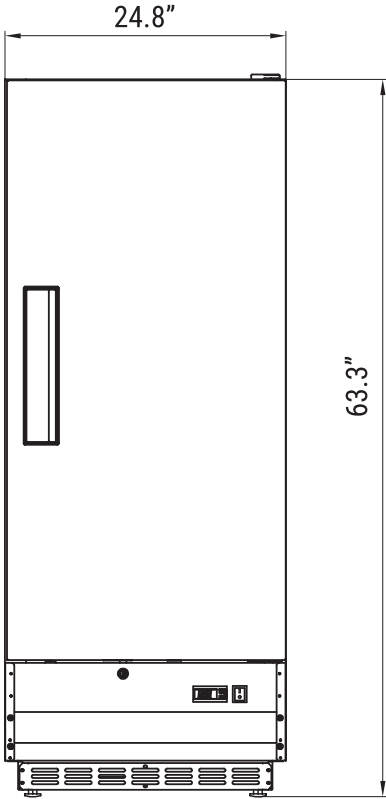

**CERTIFICATIONS**



Intertek Intertek



706 Eastern Parkway STE 1G, Brooklyn NY 11213  
718-576-6342  
info@koolmore.com