

KEG CAPACITY OF STANDARD SINGLE DOOR CABINETS (1 HALF BARREL)

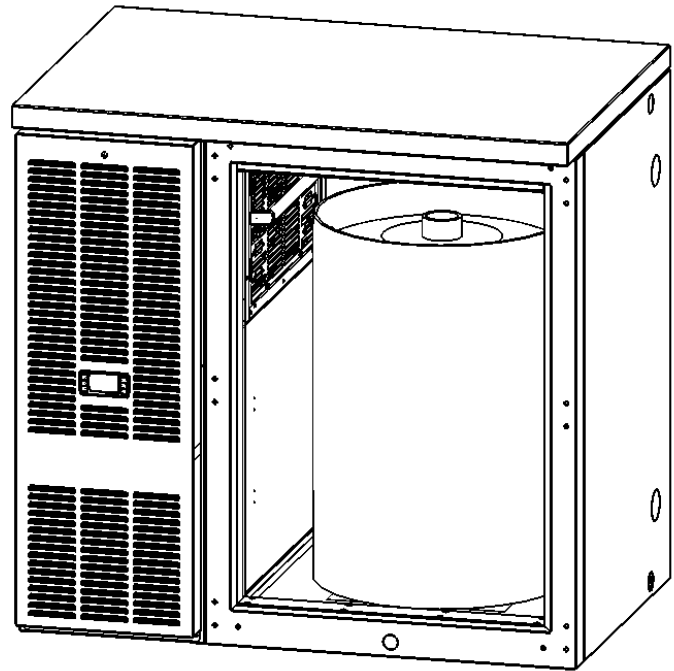

NOTES:

1. KEG CAPACITY DIAGRAM IS SHOWN FOR MAXIMUM CABINET SPACE ONLY. CUSTOMER TO DETERMINE OPTIMUM PLACEMENT OF DIFFERENT KEG SIZES.
2. KEG TO WALL SPACING IS SHOWN AT 1/8"
3. REFERENCE ASSEMBLY NUMBER: BBS36

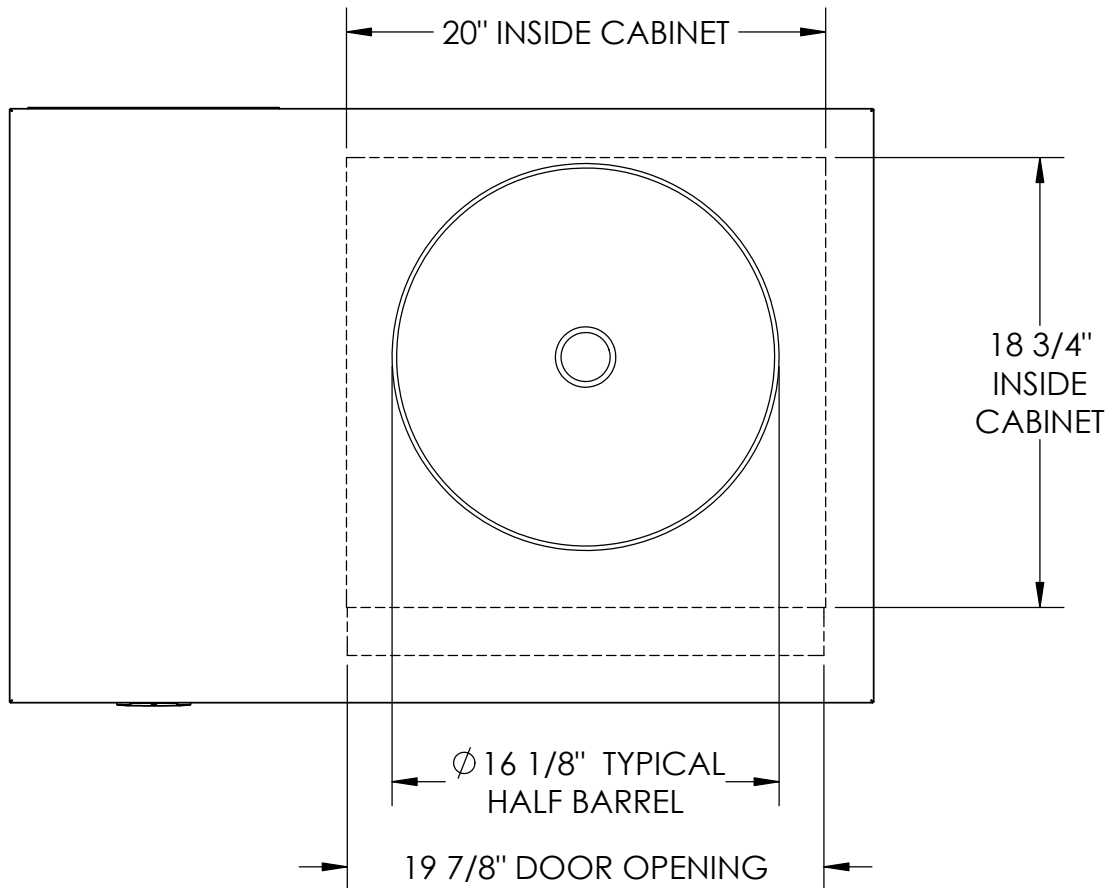

Perlick Corporation

Milwaukee, WI 53223

SHEET 1 OF 4

SCALE	1:8
DRAWN	JMP DATE 4/30/2013

95142

KEG CAPACITY OF STANDARD SINGLE DOOR CABINETS (2 SLIM QUARTER BARRELS)

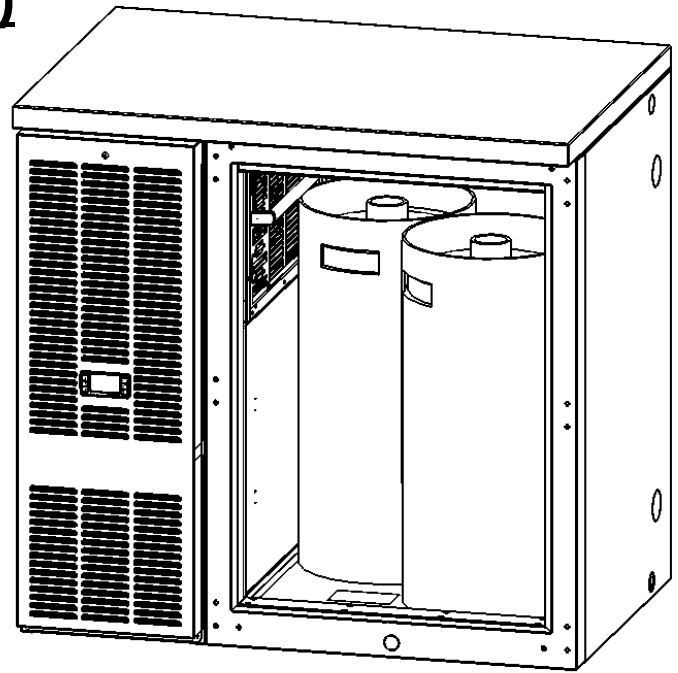

NOTES:

1. KEG CAPACITY DIAGRAM IS SHOWN FOR MAXIMUM CABINET SPACE ONLY. CUSTOMER TO DETERMINE OPTIMUM PLACEMENT OF DIFFERENT KEG SIZES.
2. KEG TO KEG SPACING & KEG TO WALL SPACING IS SHOWN AT 1/8"
3. REFERENCE ASSEMBLY NUMBER: BBS36

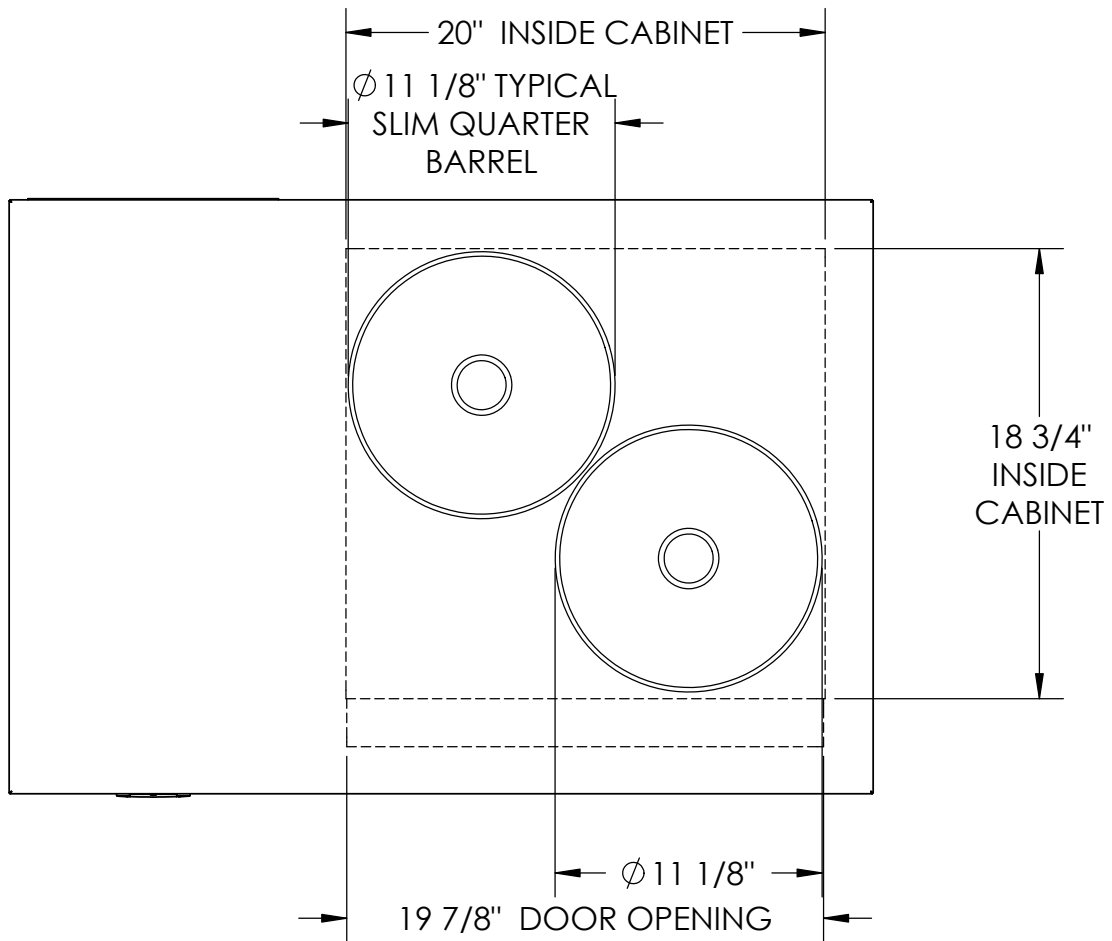

Perlick Corporation
Milwaukee, WI 53223

SHEET 2 OF 4

SCALE	1:8
DRAWN	JMP DATE 4/30/2013

95142

KEG CAPACITY OF STANDARD SINGLE DOOR CABINETS (1 SLIM QUARTER BARREL, 2 SIXTH BARRELS)

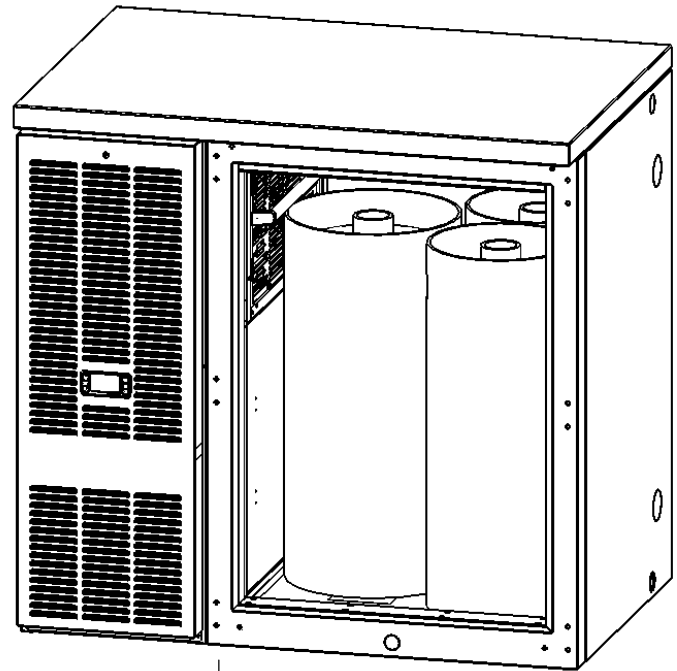

NOTES:

1. KEG CAPACITY DIAGRAM IS SHOWN FOR MAXIMUM CABINET SPACE ONLY. CUSTOMER TO DETERMINE OPTIMUM PLACEMENT OF DIFFERENT KEG SIZES.
2. KEG TO KEG SPACING & KEG TO WALL SPACING IS SHOWN AT 1/8"
3. REFERENCE ASSEMBLY NUMBER: BBS36

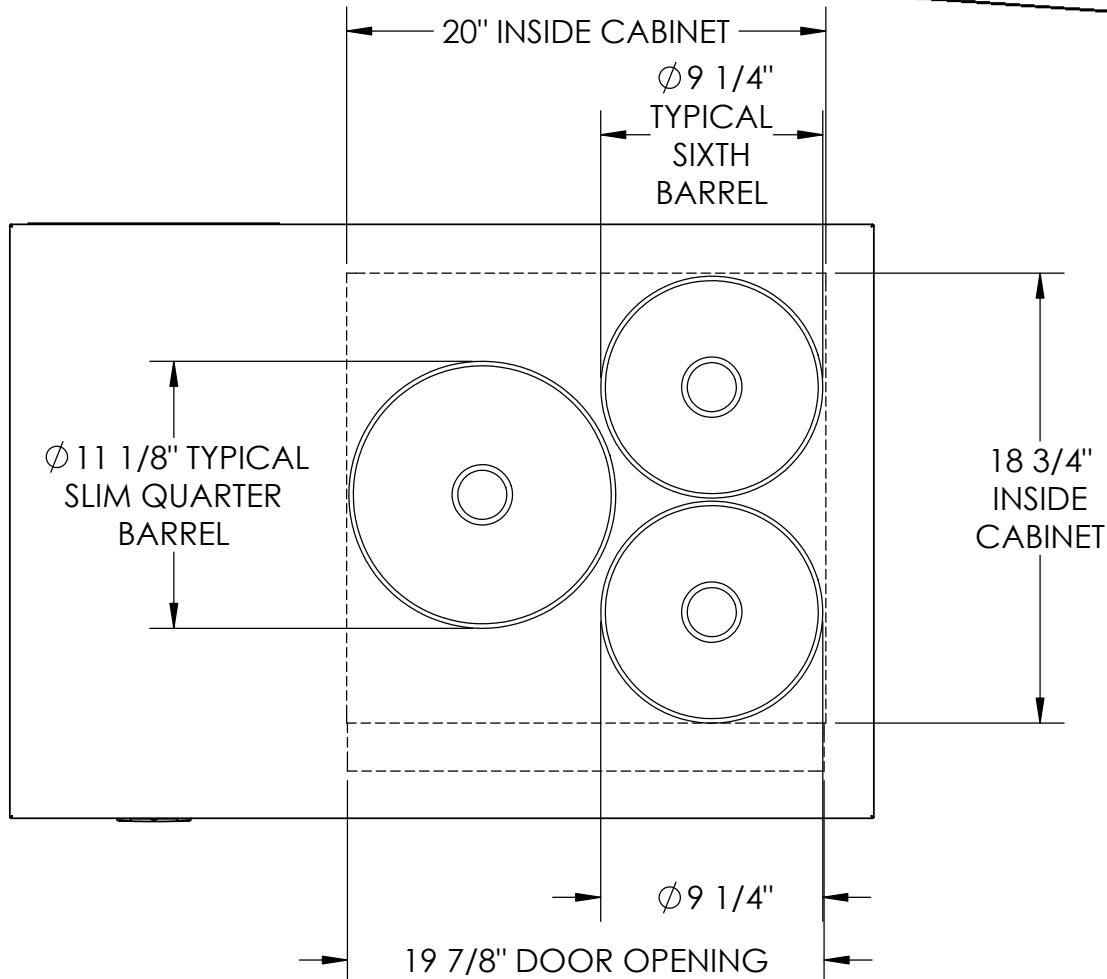

Perlick Corporation
Milwaukee, WI 53223

SHEET 3 OF 4

SCALE	1:8
DRAWN	JMP DATE 4/30/2013

95142

KEG CAPACITY OF STANDARD SINGLE DOOR CABINETS (4 SIXTH BARRELS)

NOTES:

1. KEG CAPACITY DIAGRAM IS SHOWN FOR MAXIMUM CABINET SPACE ONLY. CUSTOMER TO DETERMINE OPTIMUM PLACEMENT OF DIFFERENT KEG SIZES.
2. KEG TO KEG SPACING & KEG TO WALL SPACING IS SHOWN AT 1/8"
3. REFERENCE ASSEMBLY NUMBER: BBS36

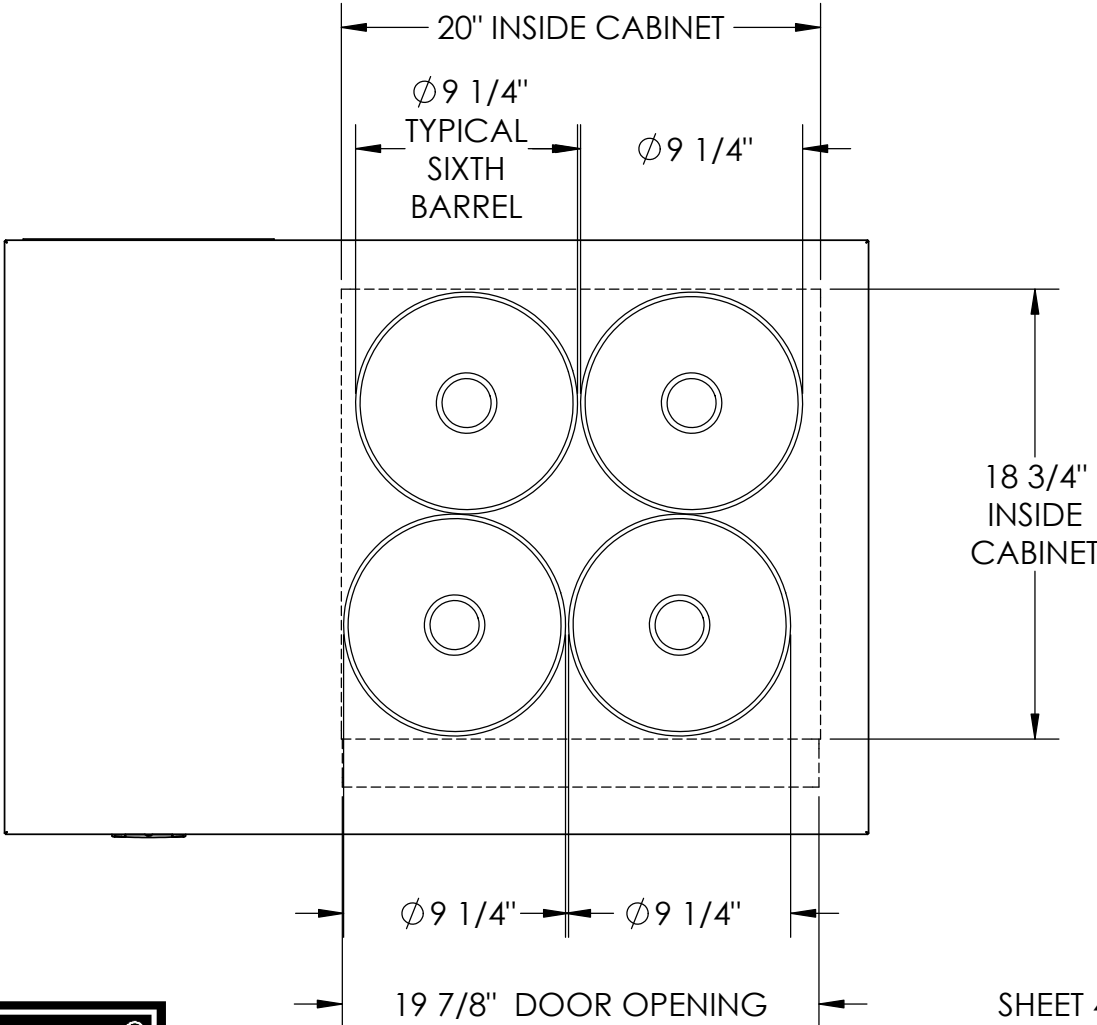
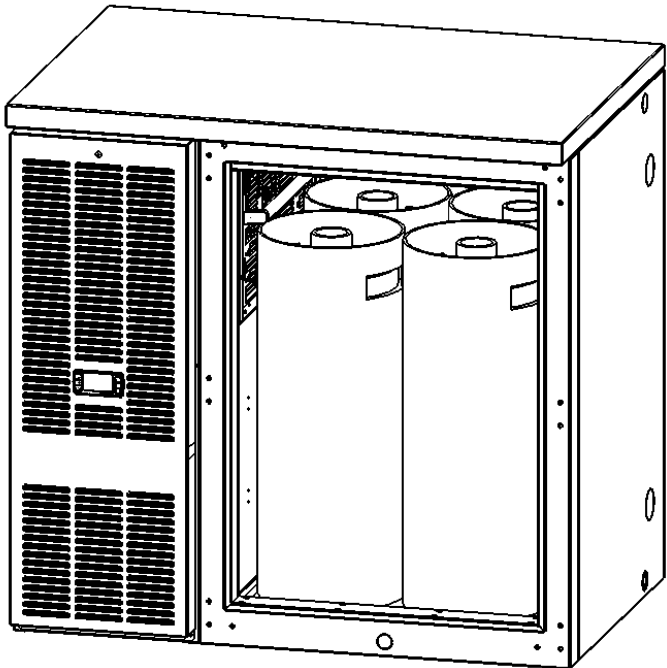

Perlick Corporation
Milwaukee, WI 53223

SCALE	1:8
DRAWN	JMP DATE 4/30/2013
95142	

SHEET 4 OF 4