

KEG CAPACITY OF STANDARD 3 DOOR CABINETS (4 HALF BARRELS)

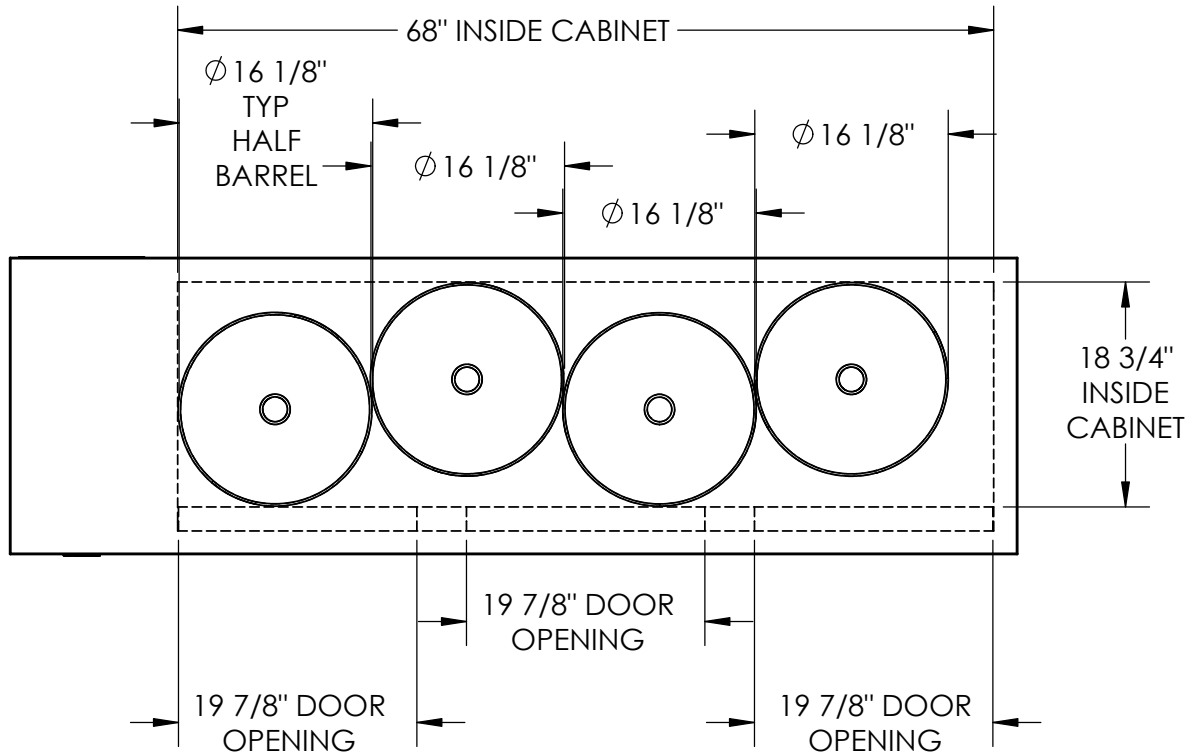

- NOTES:
1. KEG CAPACITY DIAGRAM IS SHOWN FOR MAXIMUM CABINET SPACE ONLY. CUSTOMER TO DETERMINE OPTIMUM PLACEMENT OF DIFFERENT KEG SIZES.
 2. KEG TO KEG SPACING & KEG TO WALL SPACING IS SHOWN AT 1/16".
 3. REFERENCE ASSEMBLY NUMBER: BBS84

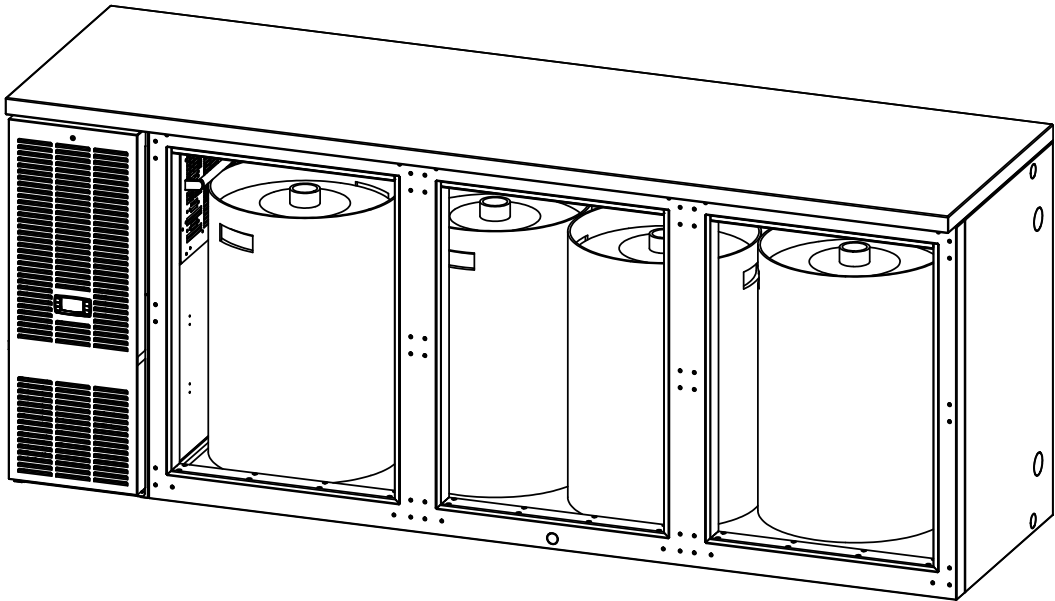

PERLICK CORPORATION
MILWAUKEE, WI 53223
PROPERTY OF THE PERLICK CORP.
NOT TO BE COPIED OR USED DETRIMENTAL TO OUR INTERESTS

SCALE:	1:16
DR.:	TJZ DATE: 5/22/13
95144	
SHEET 1 OF 9	

PRINTED
5/30/2013

KEG CAPACITY OF STANDARD 3 DOOR CABINETS (3 HALF BARRELS, 2 SLIM QUARTER BARRELS)

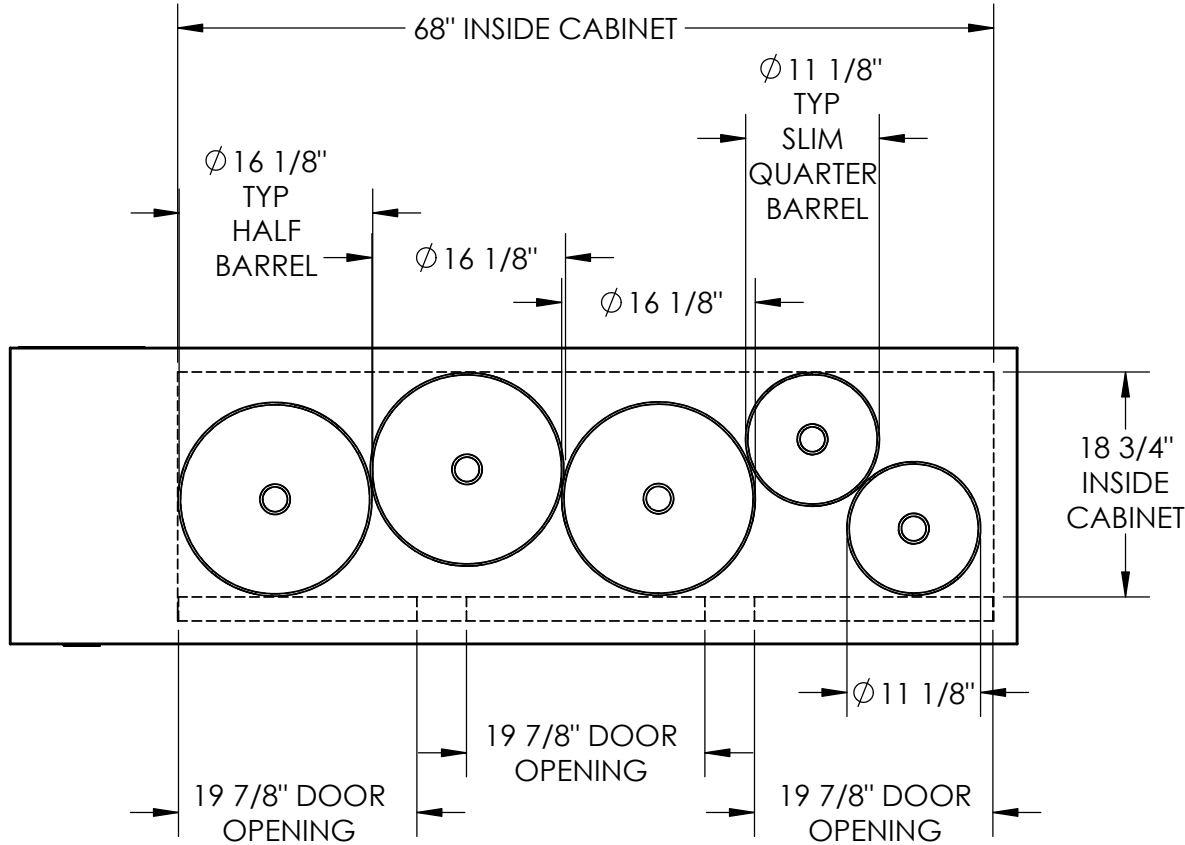
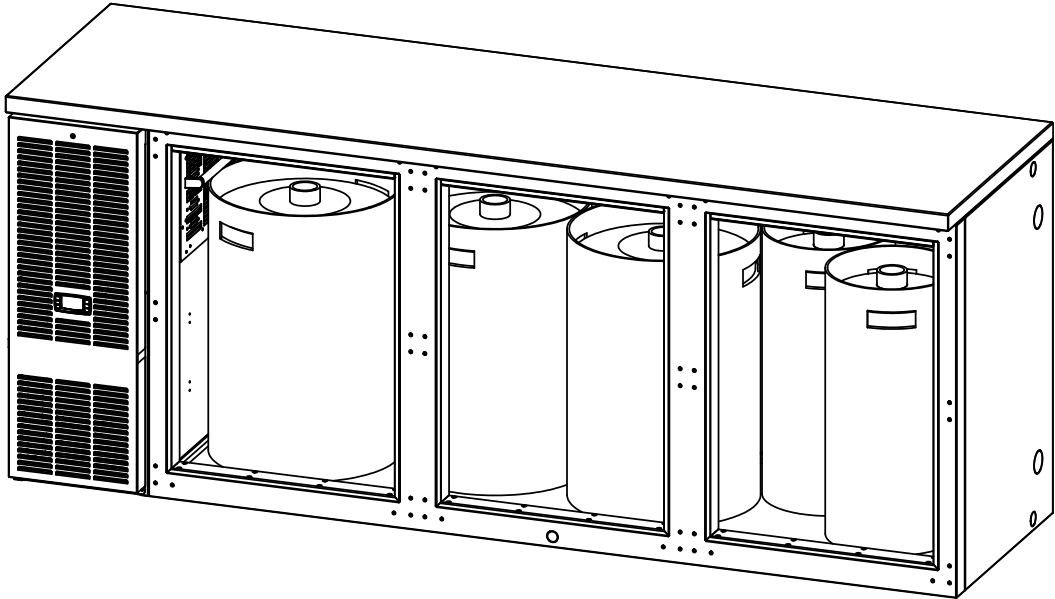

- NOTES:
1. KEG CAPACITY DIAGRAM IS SHOWN FOR MAXIMUM CABINET SPACE ONLY. CUSTOMER TO DETERMINE OPTIMUM PLACEMENT OF DIFFERENT KEG SIZES.
 2. KEG TO KEG SPACING & KEG TO WALL SPACING IS SHOWN AT 1/16".
 3. REFERENCE ASSEMBLY NUMBER: BBS84



PERLICK CORPORATION
MILWAUKEE, WI 53223
PROPERTY OF THE PERLICK CORP.
NOT TO BE COPIED OR USED DETRIMENTAL TO OUR INTERESTS

SCALE:	1:16
DR.:	TJZ DATE: 5/22/13
95144	
SHEET 2 OF 9	

PRINTED
5/30/2013

KEG CAPACITY OF STANDARD 3 DOOR CABINETS (2 HALF BARRELS, 4 SLIM QUARTER BARRELS)

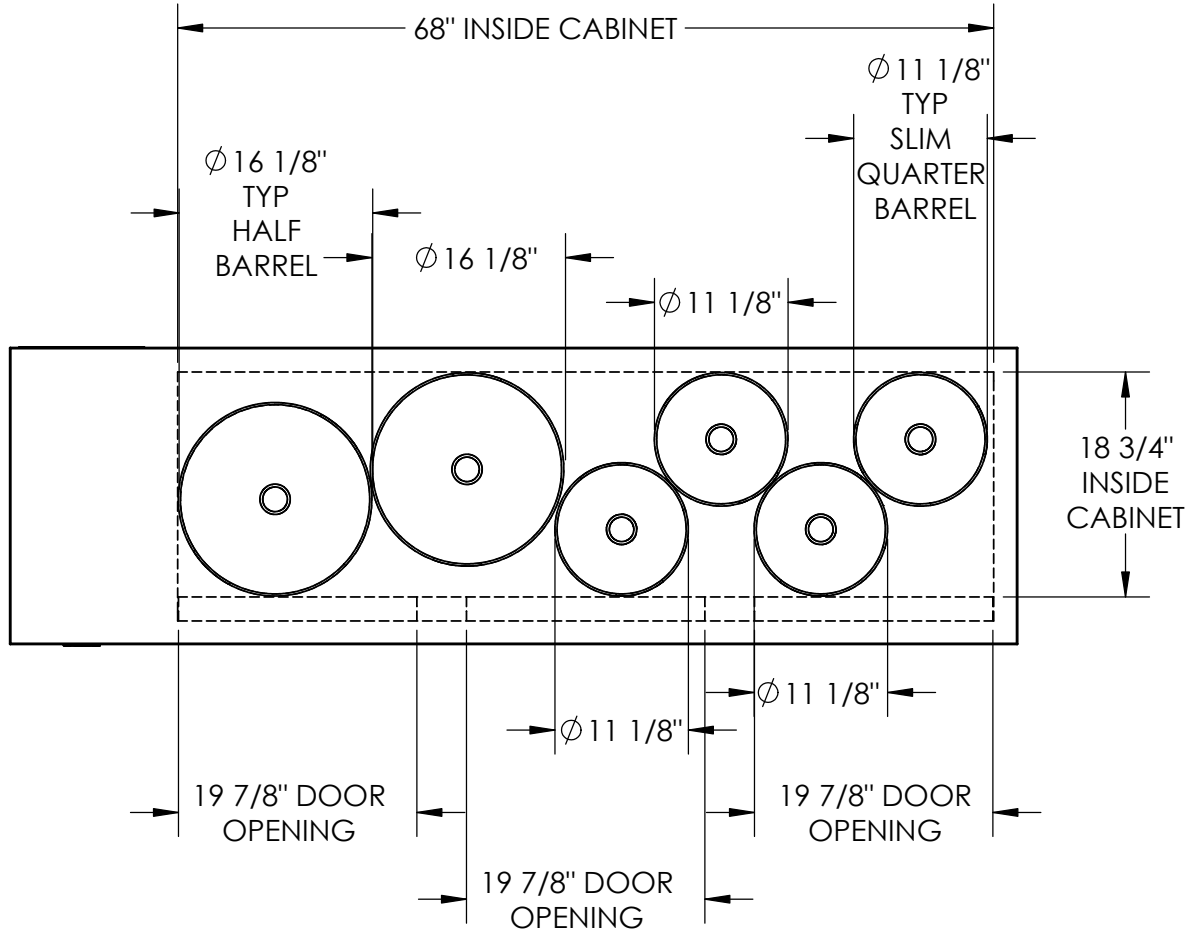
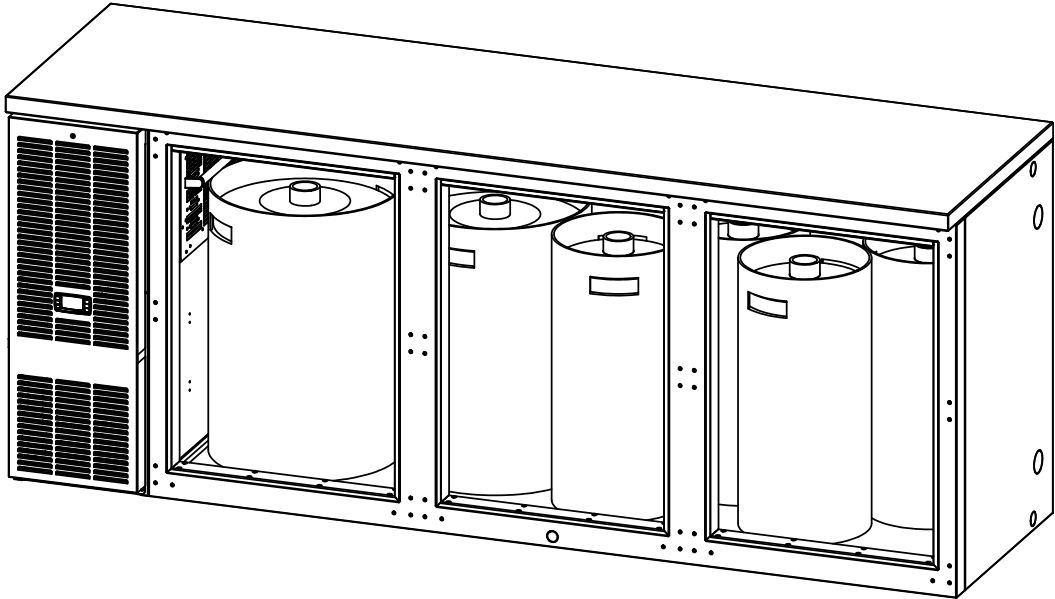

- NOTES:
1. KEG CAPACITY DIAGRAM IS SHOWN FOR MAXIMUM CABINET SPACE ONLY. CUSTOMER TO DETERMINE OPTIMUM PLACEMENT OF DIFFERENT KEG SIZES.
 2. KEG TO KEG SPACING & KEG TO WALL SPACING IS SHOWN AT 1/16".
 3. REFERENCE ASSEMBLY NUMBER: BBS84



PERLICK CORPORATION
MILWAUKEE, WI 53223

PROPERTY OF THE PERLICK CORP.
NOT TO BE COPIED OR USED DETRIMENTAL TO OUR INTERESTS

SCALE:	1:16
DR.: TJZ	DATE: 5/22/13
95144	
SHEET 3 OF 9	

PRINTED
5/30/2013

KEG CAPACITY OF STANDARD 3 DOOR CABINETS (1 HALF BARREL, 6 SLIM QUARTER BARRELS)

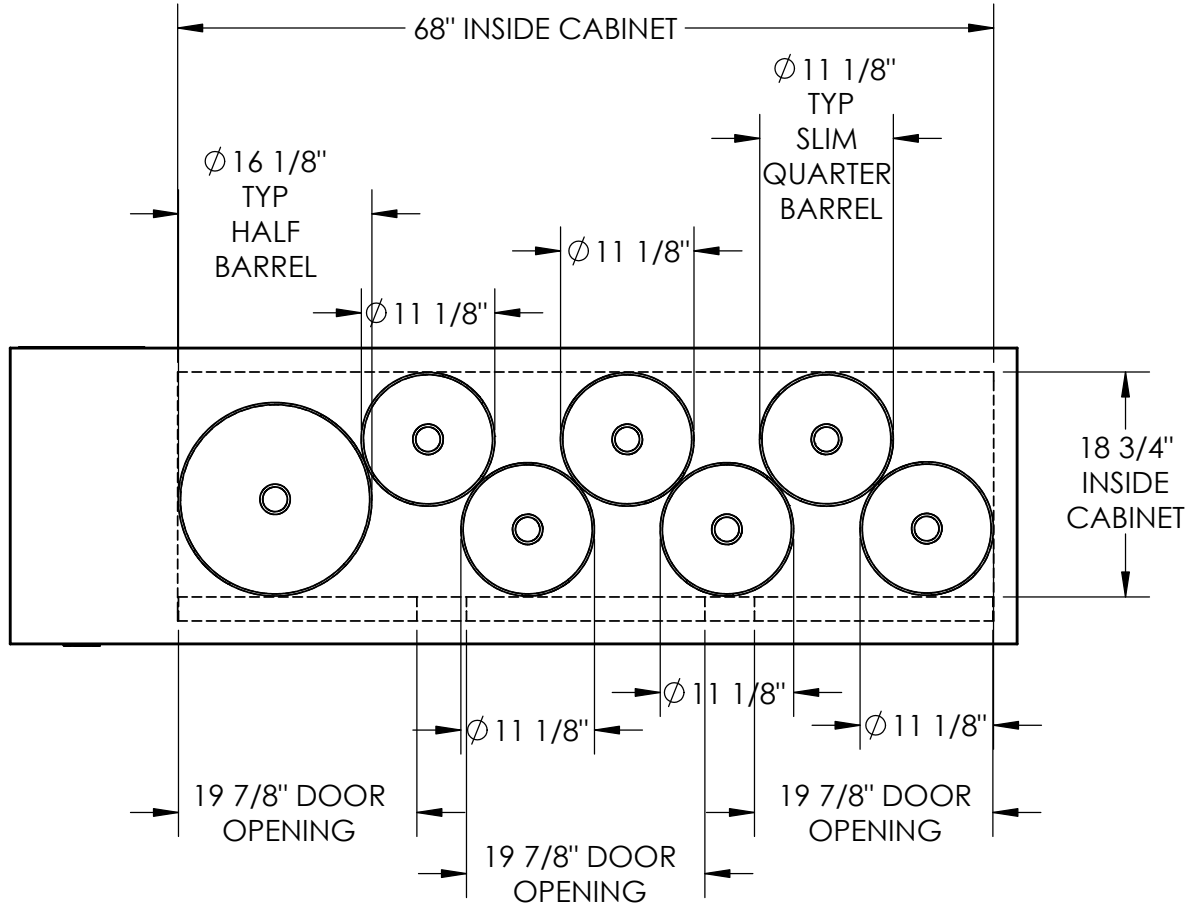
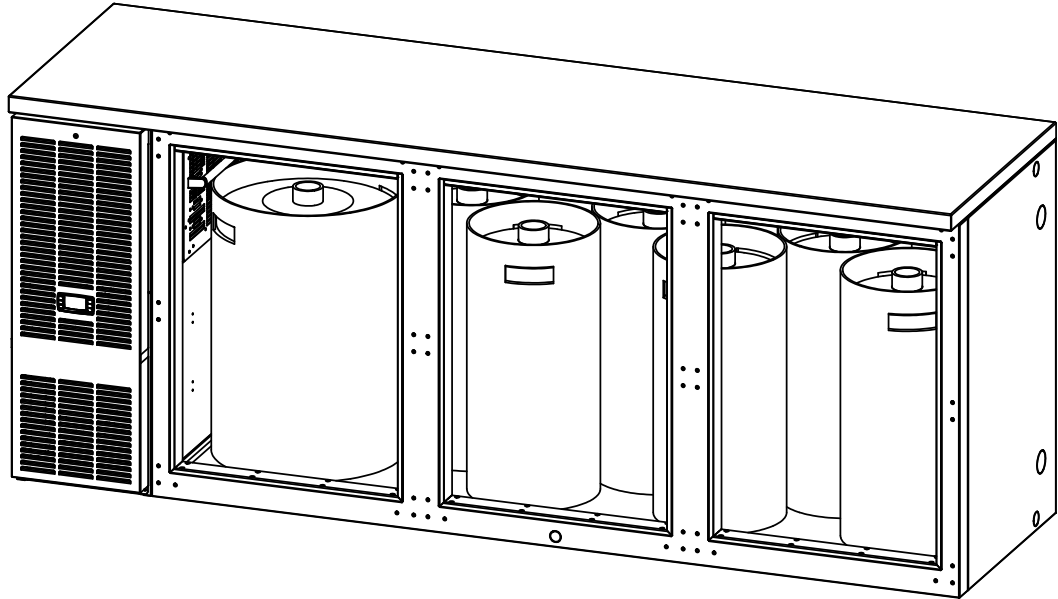

- NOTES:
1. KEG CAPACITY DIAGRAM IS SHOWN FOR MAXIMUM CABINET SPACE ONLY. CUSTOMER TO DETERMINE OPTIMUM PLACEMENT OF DIFFERENT KEG SIZES.
 2. KEG TO KEG SPACING & KEG TO WALL SPACING IS SHOWN AT 1/16".
 3. REFERENCE ASSEMBLY NUMBER: BBS84

PERLICK CORPORATION
MILWAUKEE, WI 53223
PROPERTY OF THE PERLICK CORP.
NOT TO BE COPIED OR USED DETRIMENTAL TO OUR INTERESTS

SCALE:	1:16
DR.: TJZ	DATE: 5/22/13
95144	
SHEET 4 OF 9	

PRINTED
5/30/2013

KEG CAPACITY OF STANDARD 3 DOOR CABINETS (3 HALF BARRELS, 4 SIXTH BARREL)

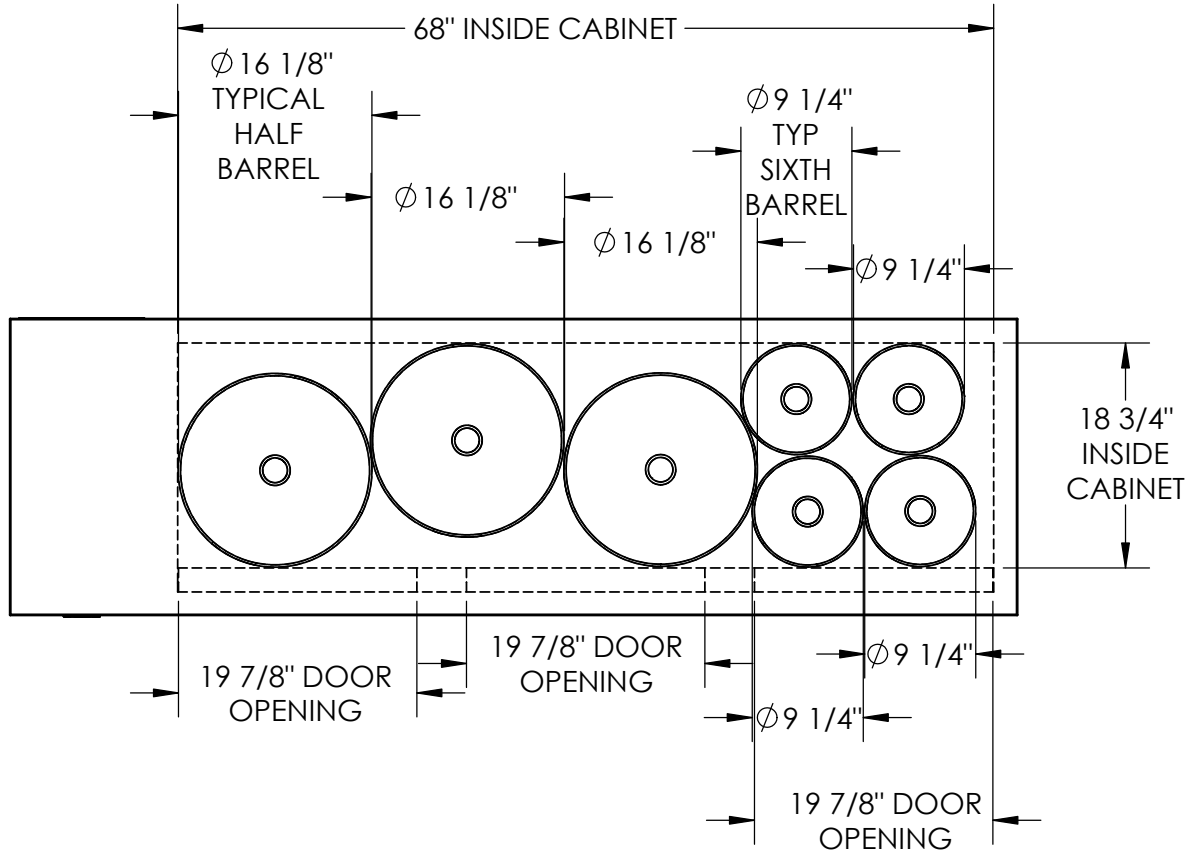
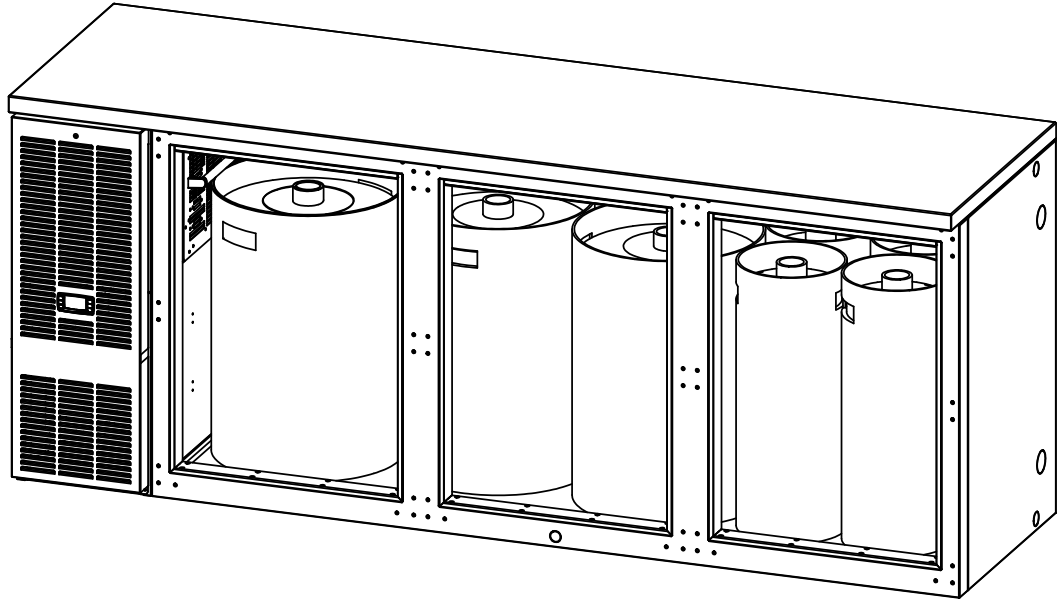

- NOTES:
1. KEG CAPACITY DIAGRAM IS SHOWN FOR MAXIMUM CABINET SPACE ONLY. CUSTOMER TO DETERMINE OPTIMUM PLACEMENT OF DIFFERENT KEG SIZES.
 2. KEG TO KEG SPACING & KEG TO WALL SPACING IS SHOWN AT 1/16".
 3. REFERENCE ASSEMBLY NUMBER: BBS84

PERLICK CORPORATION
MILWAUKEE, WI 53223

PROPERTY OF THE PERLICK CORP.
NOT TO BE COPIED OR USED DETRIMENTAL TO OUR INTERESTS

SCALE:	1:16
DR.: TJZ	DATE: 5/22/13
95144	
SHEET 6 OF 9	

PRINTED
5/30/2013

KEG CAPACITY OF STANDARD 3 DOOR CABINETS (2 HALF BARRELS, 7 SIXTH BARREL)

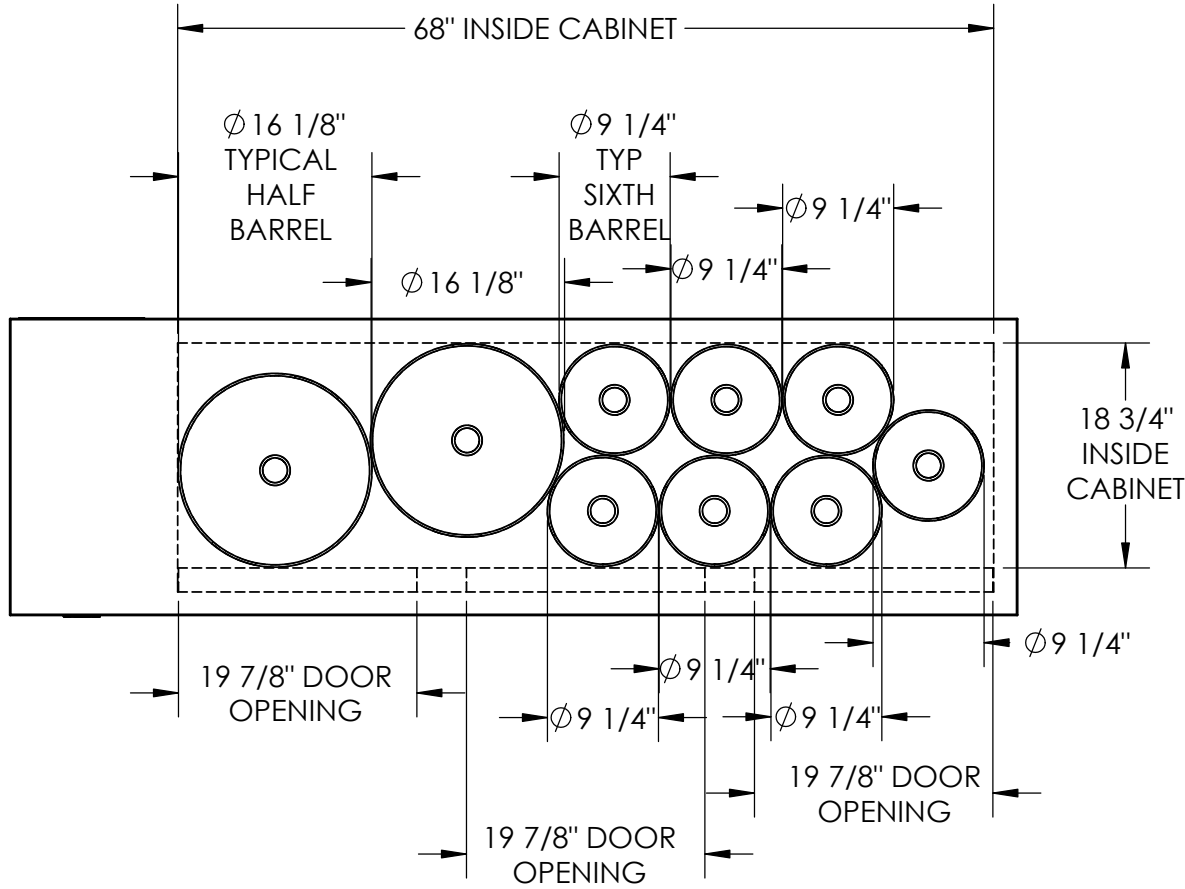
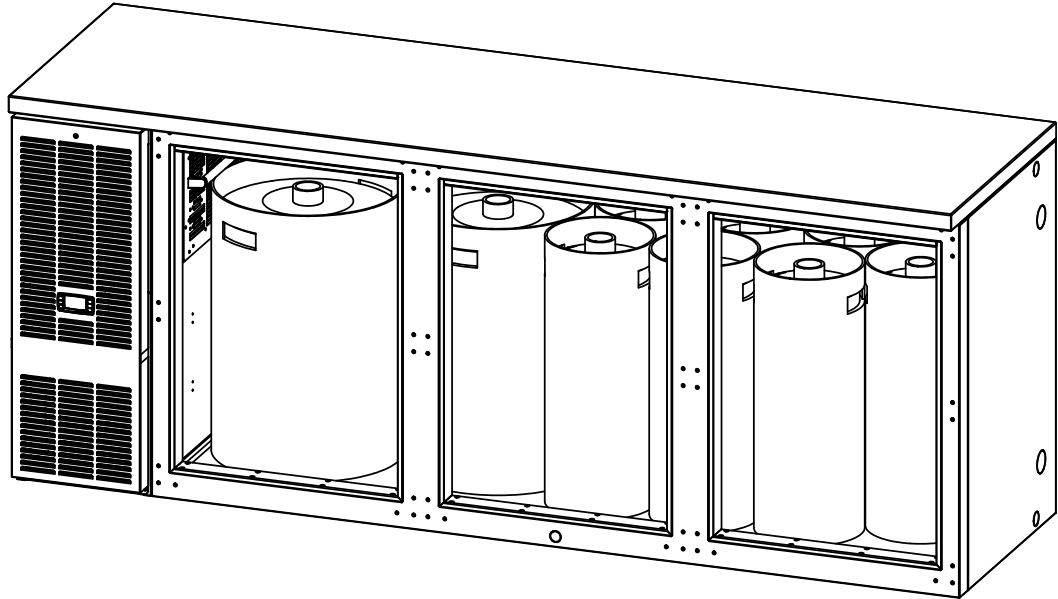

- NOTES:
1. KEG CAPACITY DIAGRAM IS SHOWN FOR MAXIMUM CABINET SPACE ONLY. CUSTOMER TO DETERMINE OPTIMUM PLACEMENT OF DIFFERENT KEG SIZES.
 2. KEG TO KEG SPACING & KEG TO WALL SPACING IS SHOWN AT 1/16".
 3. REFERENCE ASSEMBLY INUMBER: BBS84

PERLICK CORPORATION
MILWAUKEE, WI 53223
PROPERTY OF THE PERLICK CORP.
NOT TO BE COPIED OR USED DETRIMENTAL TO OUR INTERESTS

SCALE: 1:16
DR.: TJZ DATE: 5/22/13
95144
SHEET 7 OF 9

PRINTED
5/30/2013

KEG CAPACITY OF STANDARD 3 DOOR CABINETS (14 SIXTH BARRELS)

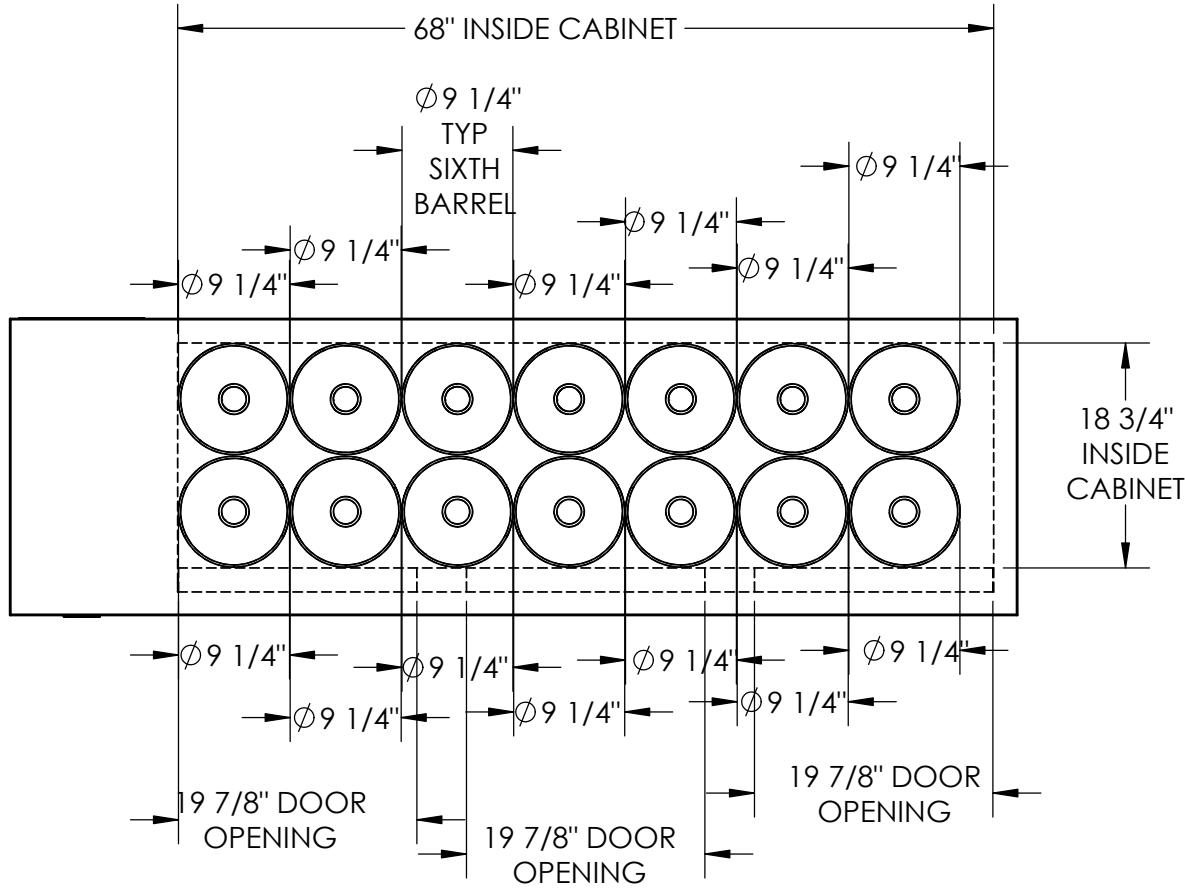
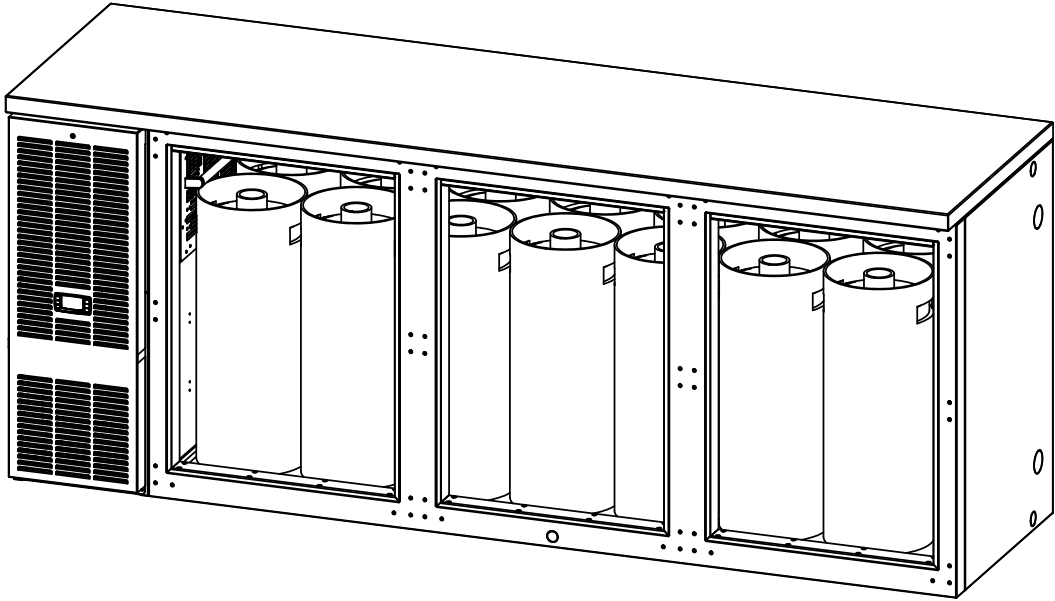

- NOTES:
1. KEG CAPACITY DIAGRAM IS SHOWN FOR MAXIMUM CABINET SPACE ONLY. CUSTOMER TO DETERMINE OPTIMUM PLACEMENT OF DIFFERENT KEG SIZES.
 2. KEG TO KEG SPACING & KEG TO WALL SPACING IS SHOWN AT 1/16".
 3. REFERENCE ASSEMBLY NUMBER: BBS84

PERLICK CORPORATION
MILWAUKEE, WI 53223
PROPERTY OF THE PERLICK CORP.
NOT TO BE COPIED OR USED DETRIMENTAL TO OUR INTERESTS

SCALE:	1:16
DR.:	TJZ DATE: 5/22/13
95144	
SHEET 8 OF 9	

PRINTED
5/30/2013

KEG CAPACITY OF STANDARD 3 DOOR CABINETS (4 SPECIAL RUBBER SIDED QUARTER BARRELS 17" DIA PONY)

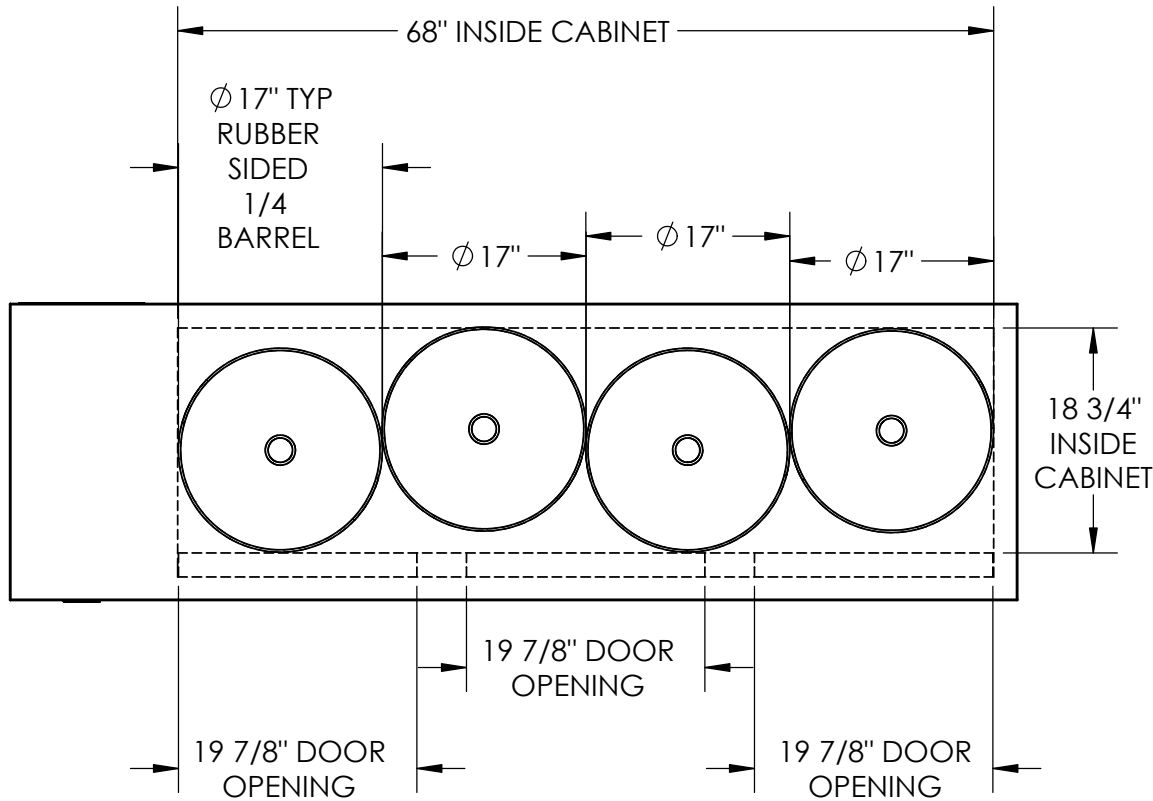
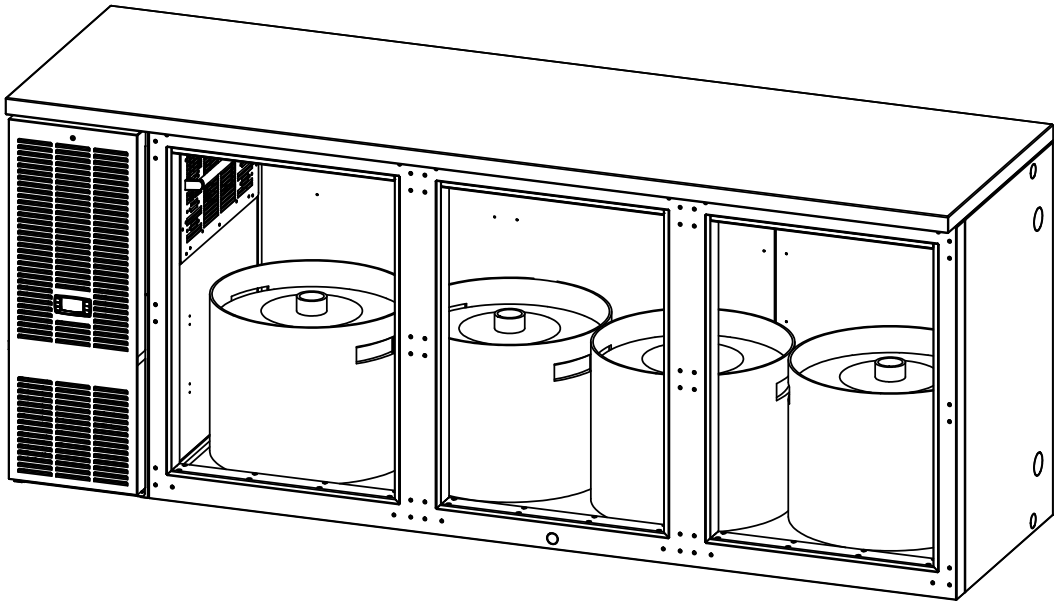

- NOTES:
1. KEG CAPACITY DIAGRAM IS SHOWN FOR MAXIMUM CABINET SPACE ONLY. CUSTOMER TO DETERMINE OPTIMUM PLACEMENT OF DIFFERENT KEG SIZES.
 2. KEG TO KEG SPACING IS AND KEG TO WALL SPACING IS 1/16".
 3. REFERENCE ASSEMBLY NUMBER: BBS84



PERLICK CORPORATION
MILWAUKEE, WI 53223
PROPERTY OF THE PERLICK CORP.
NOT TO BE COPIED OR USED DETRIMENTAL TO OUR INTERESTS

SCALE:	1:16
DR.:	TJZ DATE: 5/22/13
95144	
SHEET 9 OF 9	

PRINTED
5/30/2013