



Pick-up Perfect.



Stage Orders for Mobile Pick-up

The Metro To-Go Station in black epoxy finish highlights to-go orders and allows packaged product to take center stage. Eliminate congestion around counterspaces in the front-of-house while offering customers and delivery drivers a convenient designated spot to pick-up orders. Organize and alphabetize orders by utilizing label holders.

Easy order part numbers include everything pictured and ship in one box!

To-Go bags are props

Part #	Nominal D x W x H		Total Height (including sign)	
	(in.)	(mm)	(in.)	(mm)
CR1824TGSR	18x24x54	457x610x1372	62 1/4	1581
CR1836TGSR	18x36x54	457x914x1372	62 1/4	1581
CR1848TGSR	18x48x54	457x1219x1372	62 1/4	1581

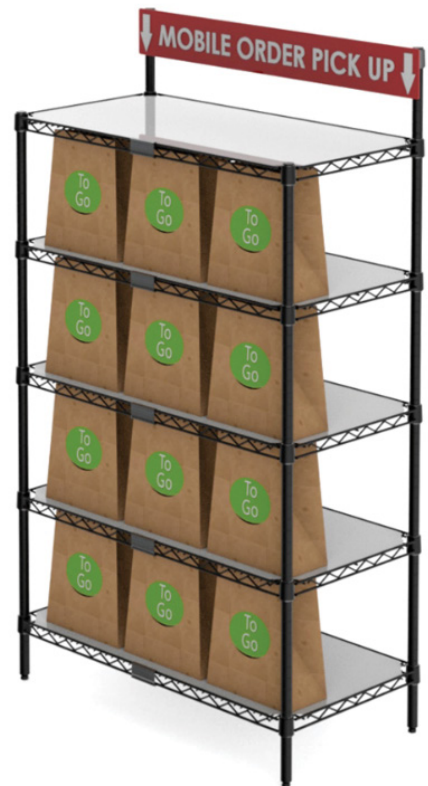

Pictured: CR1836TGSR



Metro® To-Go Station

Includes 'Mobile Order Pick Up' Sign

Adjustable SES shelves improve visibility and accessibility of to-go orders and keep them secure. Stage orders in the front-of-house for easy pick-up, and eliminate congestion around the register. This to-go station comes equipped with a pick-up sign to grab the attention of customers and delivery drivers, and provides them with a convenient pick-up experience.

Key Specifications:

- **Adjustable SES Shelves:** Hold orders of any size.
- **Pick-up Sign:** Grabs attention of customers and delivery drivers.
- **Label Holders:** Allows for easy organization and identification of orders.
- **Inlays:** Prevent small items from falling through wire shelves.
- **Black Epoxy Finish:**
 - Fits the aesthetic of any location.
 - Allows packaged meals to take center stage.



Part #	Description	Nominal D x W x H		Total Height (including sign)		Approx. Pkg. Wt.
		(in.)	(mm)	(in.)	(mm)	(lbs.)
CR1824TGSR	18x24 SES To-Go Station with Sign	18x24x54	457x610x1372	62 1/4	1581	57.8
CR1836TGSR	18x36 SES To-Go Station with Sign	18x36x54	457x914x1372	62 1/4	1581	72.6
CR1848TGSR	18x48 SES To-Go Station with Sign	18x48x54	457x1219x1372	62 1/4	1581	86.3

Sign Specifications:

- **Material:** Rigid styrene
- **Thickness:** 0.04"
- **Height:** 5"
- **How to Attach:**
 - Shipped with S-hooks attached to the back of the sign.
 - Slide the S-hooks over the hanger rail and into place.

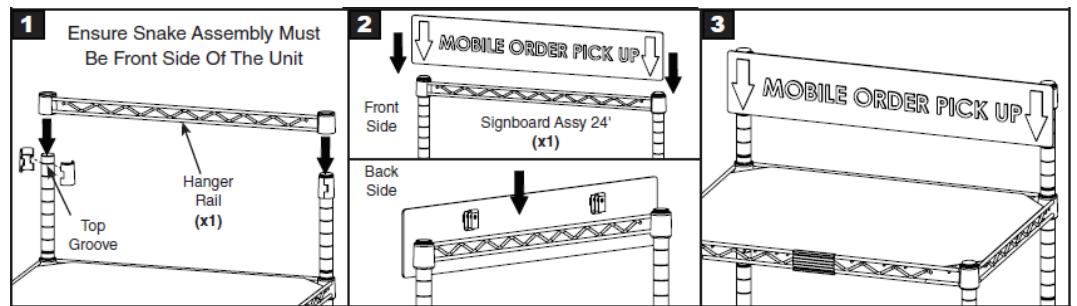

Visit www.metro.com or call 1-800-992-1776.

L11-003 6/20

© 2020 InterMetro Industries Corporation, Wilkes-Barre, PA 18705



We put space to work.®

an Ali Group Company



The Spirit of Excellence