

BUILT-IN (BOTTOM MOUNT) RECTANGULAR "ROUND CORNER" FOOD AND LIQUID WARMERS

MODEL BM-30DS

ELECTRICAL

MODEL	VOLTS	WATTS	AMPS	PHASE	FIELD WIRING GAUGE	TEMP. RATING
BM-30DS	120	1200	10.0	SINGLE	#14 AWG Cu	90°C MIN.
BM-30DS	240	1650	5	SINGLE	#14 AWG Cu	90°C MIN.
BM-30DS	208	900	4.3	SINGLE	#14 AWG Cu	90°C MIN.

CUTOUT DETAILS

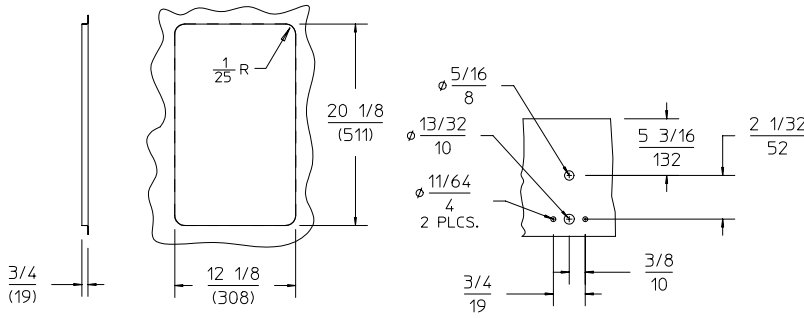

TOP CUTOUT

FRONT PANEL CUTOUT

PRODUCT DIMENSIONS

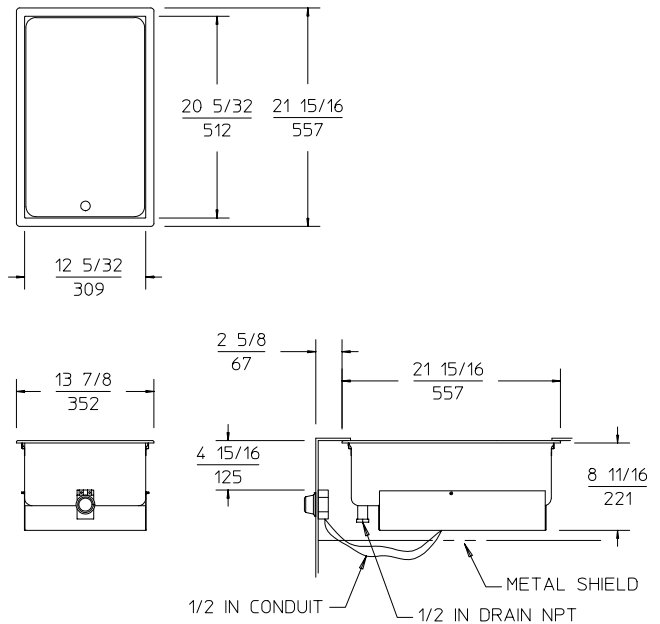

DETAIL 'A'

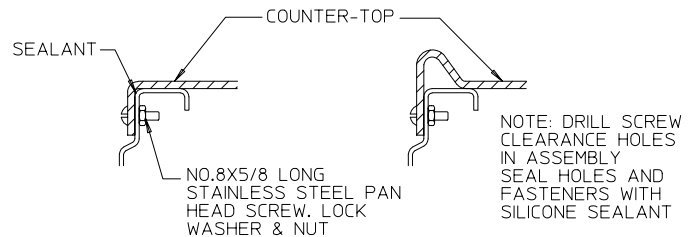

CLEARANCES

SUGGESTED CLEARANCE UNIT TO THE NEAREST SURFACE			
BACK	SIDE	BOTTOM	FRONT*
2 51	2 51	6 3/4 171	4 1/8 105

NOTE: DEPENDING ON THE INSTALLATION, CLEARANCES MAY BE REDUCED UPON FURTHER EVALUATIONS TO UL STANDARDS.

INSTALLATION INSTRUCTIONS

INSTALLER MUST MEET CONDITIONS OF ACCEPTABILITY OUTLINED BELOW UPON INSTALLATION:

1. This equipment shall be installed in an all metal counter.
2. A suitable electrical enclosure should be provided for the wiring extending from the control box to the main unit.
3. To prevent high ambient temperatures around electrical components, ventilation and temperatures of affected components should be monitored in the end-use installation.
4. Temperatures of any surfaces around the unit that could contact combustible materials in the end-use (such as in storage areas) should be monitored to determine compliance with temperature requirements for combustible materials.
5. Control switch should be installed in a suitable enclosure. Enclosure must meet all national and local electrical codes.
6. The locations, accessibility, and temperatures of the wiring compartment of this unit should be evaluated by UL in the end application.
7. The enclosure of the temperature control switch has not been subjected to any formal investigation and should be evaluated by UL in the final application.
8. The dead metal parts of the appliance should be reliably connected to the grounding means of the overall appliance and the grounding path resistance is to comply with the requirements set by national and local electrical codes.
9. Electrical spacings between uninsulated live-metal parts and dead-metal and between uninsulated live-metal parts of opposite polarity should comply with the requirements for the end use classification.
10. The suitability of the nameplate location should be evaluated in the end-use application.
11. User access to the heater element wiring through the bottom sheet steel enclosure should be evaluated by UL in the end application.

TO FABRICATE AND INSTALL:

1. Lay out cutout dimensions on countertop and control panel as shown in cutout details.
2. Cut and/or drill holes as required in countertop and apron.
3. Turn down flange with round corners (maximum 3/4 inch).
4. To install, position warmer underneath so that turn down is positioned onto embossed shoulders of warmer. Drill as required.
5. Remove warmer and apply a bead of silicone sealant to shoulder area. Remount and secure warmer to fixture with stainless steel screws (see Detail "A" above).
6. Mount control to apron.
7. Connect supply connection wiring to thermostat. Check nameplate for correct voltage.

NOTE: The BM-30DS warmer is supplied with a drain hole at one end and a 1/2 inch female N.P.T. drain nipple.

NOTE: INSTALLATION MUST MEET LOCAL AND NATIONAL PLUMBING AND ELECTRICAL CODES.