

## WTR/WTF CASTER OPTIONS

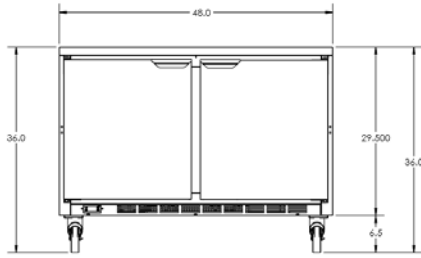

**00C31-038A**  
6" CASTERS - STANDARD  
401-249A / 401-250D  
00A31-034D-03 LEVELER

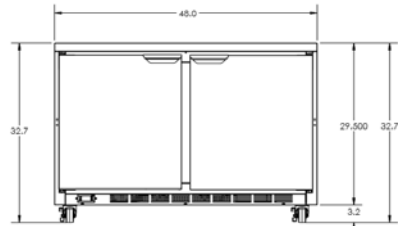

**00C31-041A**  
KIT - CASTER 3" SP/UC/WT/SU  
40153A/401-254A

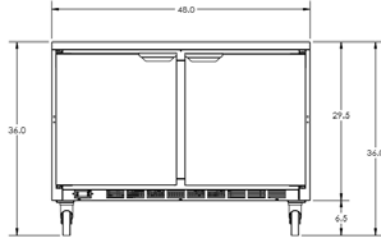

**00C31-044A**  
KIT - CASTER HEAVY DUTY SP-POP  
401-653A / 401-654A  
00A31-028B LEVELER

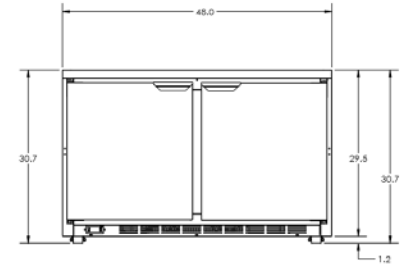

**00A31-045A**  
ROLLER KIT UC/WT/SU/SP

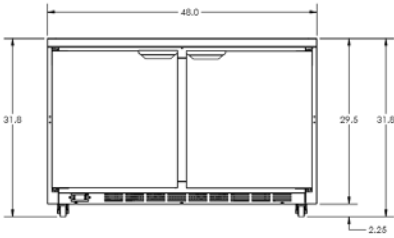

**00C31-049A**  
2-3/4" CASTERS - "LOW PROFILE"  
401-926D-01 / 401-926D-02

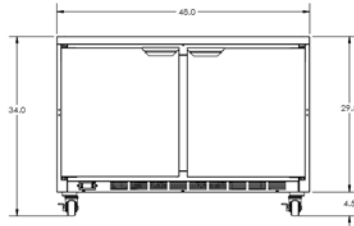

**00A31-051A**  
KIT - CASTER 3" WHEEL, 3.75" HEIGHT 500 LB  
401-633A / 401-634A  
00A31-031D-03 LEVELER

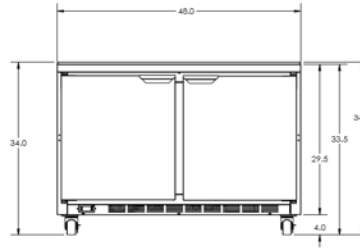

**00A31-052A**  
KIT - CASTER SPE, 34" CUTTING BRD HEIGHT  
3" CASTERS / 500#  
401-695A / 401-696A  
00C31-032D-03 LEVELER

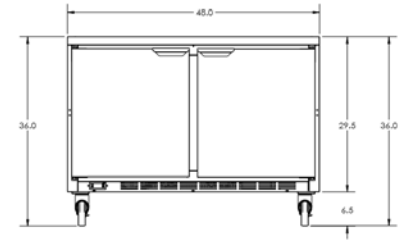

**00C31-054A**  
KIT - CASTER 36" WORK TOP HEIGHT, SPE/WT  
401-249A/401-250A  
00A31-030D-03 LEVELER

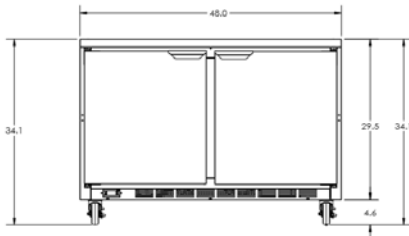

**00A31-059A**  
KIT - CASTER, SPE/WT 34-1/8" WORKTOP HEIGHT  
411-006A / 411-007A

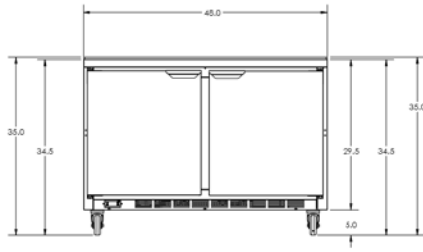

**00A31-061A**  
CASTER KIT-SPE/WT CUTTING BOARD HGT 35"  
411-927D-01 / 401-927D-02  
00A31-045D-03 LEVELER

PART NO.	DESCRIPTION	HEIGHT
00C31-038A	6" CASTER	36" H
00C31-041A	3" CASTER	32.7" H
00C31-044A	6" HEAVY DUTY CASTER	36" H
00A31-045A	ROLLER KIT	30.7" H
00C31-049A	2 3/4" LOW PROFILE CASTER	31.5" H
00A31-051A	3 3/4" CASTER	34" H
00A31-052A	3" CASTER	34" H
00C31-054A	6" CASTER	36" H
00A31-059A	4" CASTER	34.1" H
00A31-061A	5" CASTER	34.5" H

## UCR/UCF CASTER OPTIONS

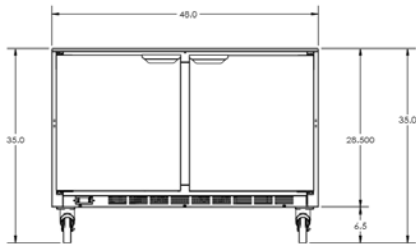

**00C31-038A**  
6" CASTERS - STANDARD  
401-249A / 401-250D  
00A31-034D-03 LEVELER

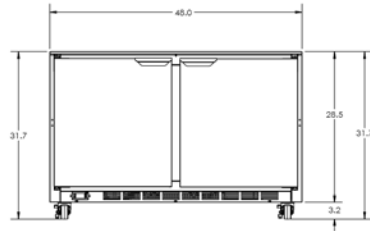

**00C31-041A**  
KIT - CASTER 3" SP/UC/WT/SU  
40153A/401-254A

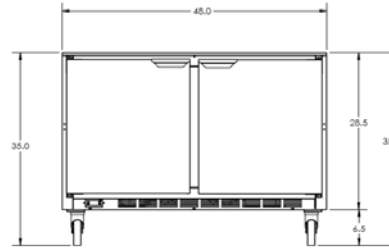

**00C31-044A**  
KIT - CASTER HEAVY DUTY SP-POP  
401-653A / 401-654A  
00A31-028B LEVELER

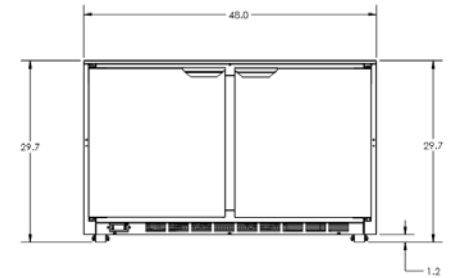

**00A31-045A**  
ROLLER KIT UC/WT/SU/SP

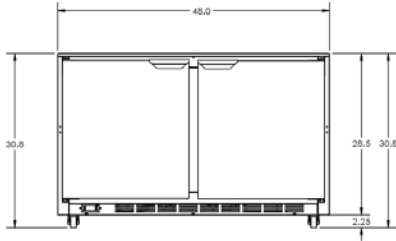

**00C31-049A**  
2 3/4" CASTERS - "LOW PROFILE"  
401-926D-01 / 401-926D-02

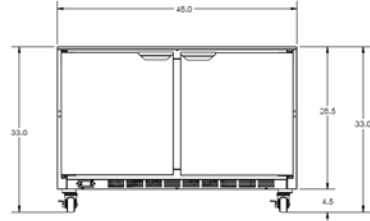

**00A31-051A**  
KIT - CASTER 3" WHEEL 3.75" HEIGHT 500 LB  
401-633A / 401-634A  
00A31-031D-03 LEVELER

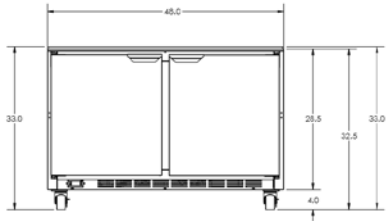

**00A31-052A**  
KIT - CASTER SPE/WT, 34" CUTTING BRD HEIGHT (UC 33")  
3" CASTERS / 500#  
401-695A / 401-696A  
00C31-032D-03 LEVELER

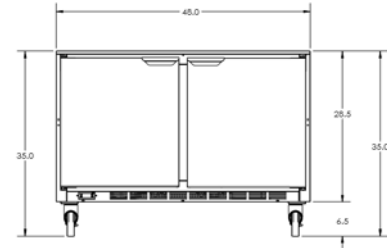

**00C31-054A**  
KIT - CASTER 36" WORK TOP HEIGHT, SPE/WT (UC-35")  
401-249A/401-250A  
00A31-030D-03 LEVELER

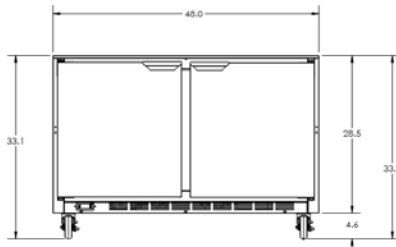

**00A31-059A**  
KIT - CASTER, SPE/WT 34-1/8" WORKTOP HEIGHT (UC-33-1/8")  
411-006A / 411-007A

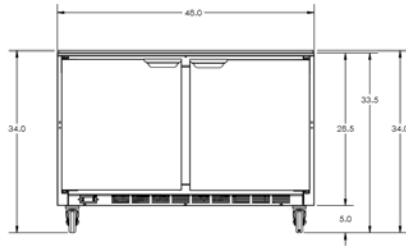

**00A31-061A**  
CASTER KIT-SPE/WT CUTTING BOARD HGT 35"(UC-34")  
411-927D-01 /401-927D-02  
00A31-045D-03 LEVELER

PART NO.	DESCRIPTION	HEIGHT
00C31-038A	6" CASTER	35" H
00C31-041A	3" CASTER	31.7" H
00C31-044A	6" HEAVY DUTY CASTER	35" H
00A31-045A	ROLLER KIT	29.7" H
00C31-049A	2 3/4" LOW PROFILE CASTER	30.8" H
00A31-051A	3 3/4" CASTER	33" H
00A31-052A	3" CASTER	33" H
00C31-054A	6" CASTER	35" H
00A31-059A	4" CASTER	33.1" H
00A31-061A	5" CASTER	34" H
00A31-067A	4" CASTER - ADA	33.67" H