

FORM NUMBER

KCTCDD-X-SRVI

PART DESCRIPTION

PARTS BAG, TOWER CONNECTION, DIRECT DRAW



Since 1917

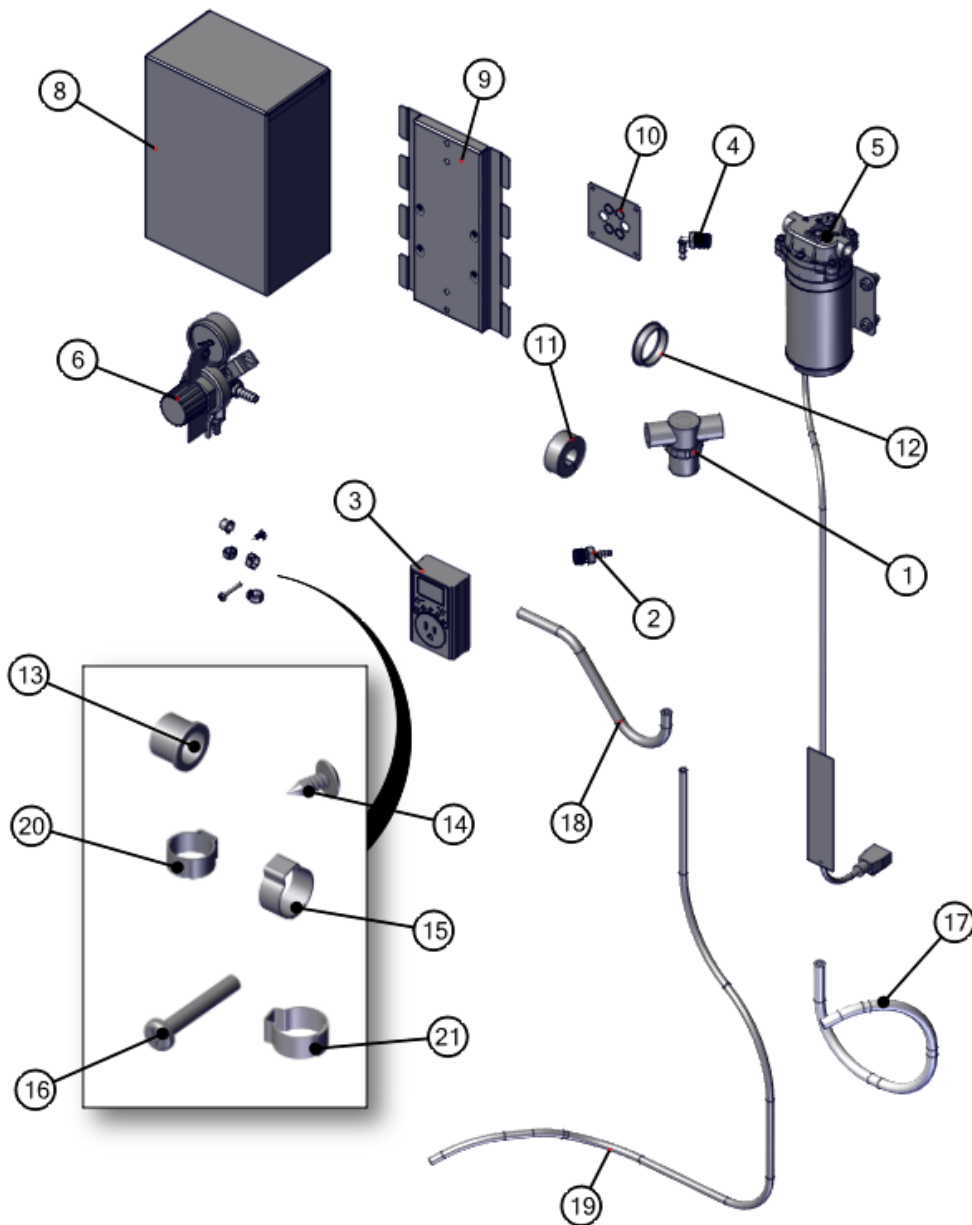

TOOLS REQUIRED

Philips Head Screwdriver

Hammer

Pliers

Tab Clamp Crimping Tool

Drill

10-32 Drill Bit

PARTS LIST

Item #	Part #	Description
1	1013378	FILTER, IN-LINE, PUMP, CRAFT COCKTAIL MIXING TANK
2	1013145	NIPPLE, 3/8" MPT X 1/4" BARB, 304 STAINLESS STEEL
3	1013381	TIMER, SWITCH OUTLET, PROGRAMMABLE, PLUG-IN
4	1024511	ELBOW, 1/4" ID HOSE X 3/8" NPT
5	1013289	PUMP, 3 CHAMBER DIAPHRAGM, 115 VAC, 3/8" CONNECT PORTS
6	1007859	REGULATOR MANIFOLD, SECONDARY CO2, 1 FAUCET, 1/4" BARB
8	1024282-1	PANEL, PUMP COVER, MIX COCKTAIL
9	1023952-1	BRACKET, PUMP MOUNTING, MIX COCKTAIL
10	1024478-1	PANEL, TUBE INLET, MIX COCKTAIL
11	70123-1	DOUGHNUT PLUG, 2" OD X 7/8" ID
12	C15967	SNAP BUSHING, 2.00", NYLON,
13	C14879	BUSHING, SNAP, .391"ID, NYLON,
14	M50050-466	#10X1/2" PH.TRUSS FULL CONTOUR HD.SMS#410SS, TY
15	C33037	CLAMP, STEPLESS EAR, .453-.551 RANGE, STAINLESS STEEL
16	M00494-129	SCREW, MACHINE,#10-32 X 1 1/4" PH PAN HD, STEEL, ZINC PLATED
17	1392R	AIR HOSE, RED, 9/16" OD X 5/16" ID, TO BE PRINTED
18	1392R-250	AIR HOSE, RED, 1/2"OD X 1/4"ID 100' SPOOL, **NO PRINTING**
19	67740	TUBING, 1/4"ID, WINE, FLAVOUR LOCK,BARRIERMASTER,500 FT.ROLL
20	54871-123	CLAMP, STEPLESS EAR, .386-.484 RANGE, STAINLESS STEEL
21	C31958	CLAMP, STEPLESS EAR, .520-.618 RANGE, STAINLESS STEEL

OPERATION #1

1. With a flat head screwdriver and hammer, punch out the knockout (inner and outer) on the sidewall of the unit.
 2. Once both knockouts are removed, remove the insulation between the inner and outer wall.
- If customer is planning on storing the gas tank on the outside of the unit or is supplying their own means of gas, continue to step #3 of this operation.
 - If customer is ordering a gas tank and plans on storing it inside the cabinet, continue to the next operation.
3. Drill a 5/8" hole into the side of the cabinet, 3 inches under the knockout. Drill through outer and inner wall
 4. Grind down any sharp edges.

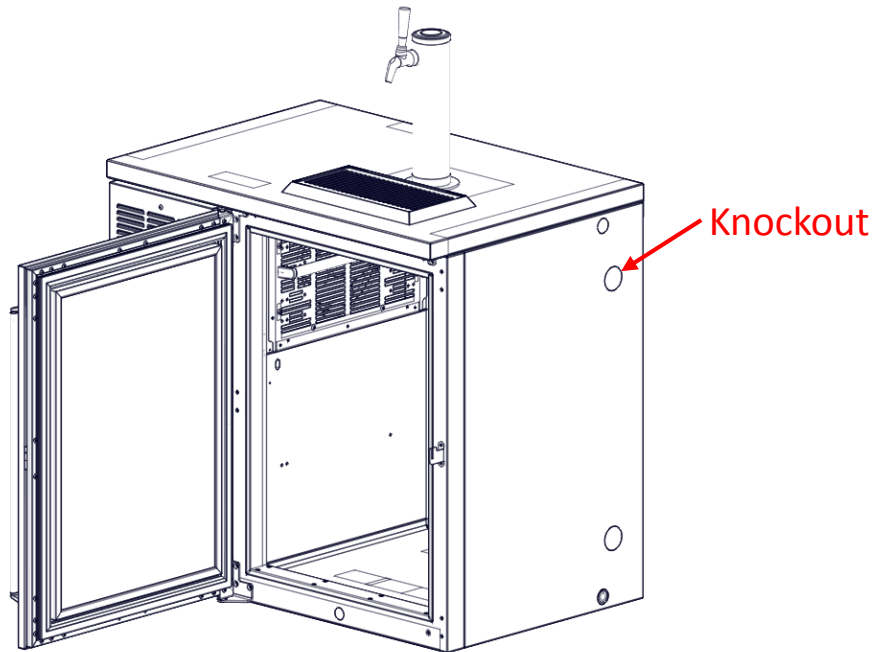

OPERATION #2

1. Place bracket 1024478-1 up against the side wall so that it covers the hole from the previous operation.
2. Once aligned, mark the four holes in the corner of 1024478-1 onto the cabinet with a marker.
3. Drill out the four holes with a #30 drill bit.
4. Knock out two of the holes in bracket (1024478-1). These will be used to run the beverage lines through.
5. Secure 1024478-1 to the side wall with four screws (M50050-466.)
6. Snap two bushings (C14879) into bracket (1024478-1).
7. Snap one bushing (C15967) into the hole on the inside wall.

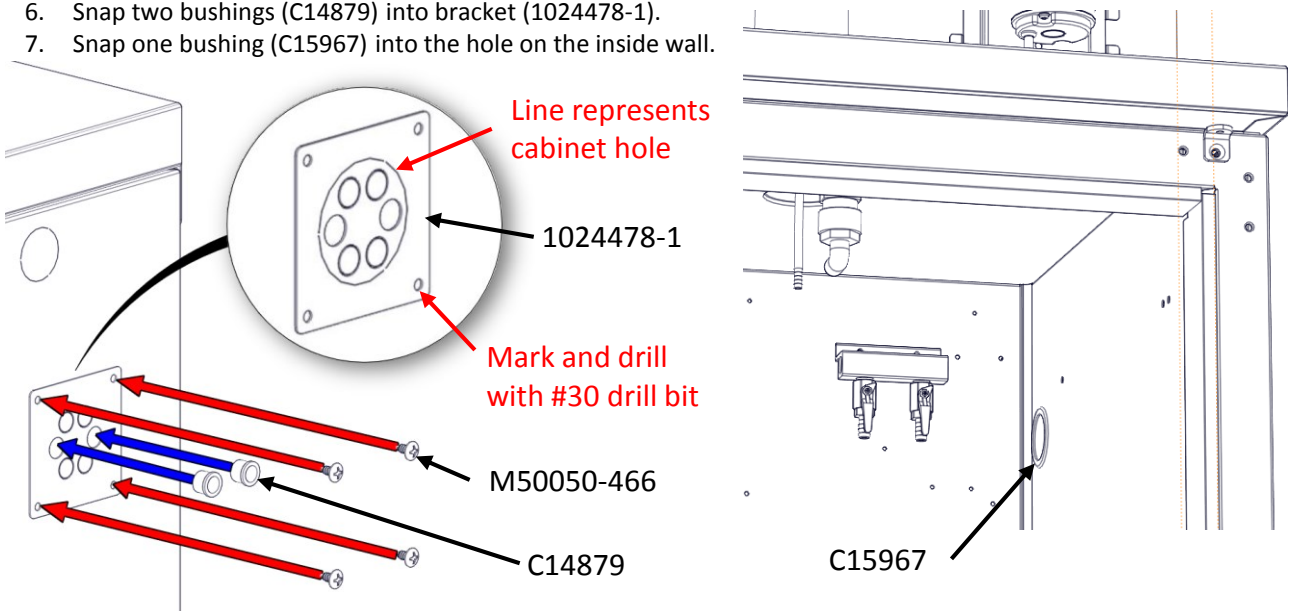

OPERATION #3

1. Determine if the pump will be mounted onto the side of the cabinet or if it will be mounted onto the wall.
 - a. This instruction will represent the pump being Wall Mounted.
 - b. Cabinet Mounted- Pump must always be mounted of the side wall furthest away from the refrigeration module.

Cabinet Mounted

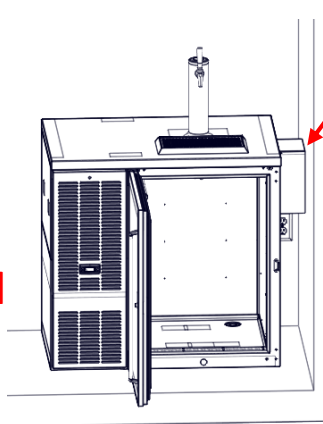

Wall Mounted

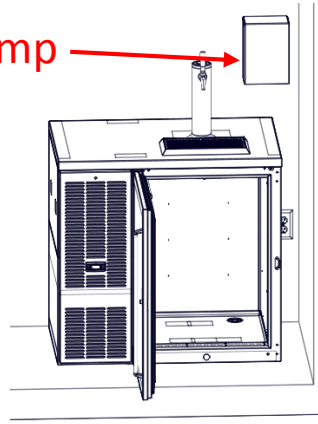

2. Kit comes with 32 feet of flavor locking tubing (67740). The 32 feet must be cut down into two sections to create the "In" and "Out" lines for the pump. To determine how far away the pump can be placed from the cabinet, first determine size of the cabinet and location of the keg. If a longer distance is required, contact Perlick Service Department. See Tube Routing Diagram for line hook up locations

Top View

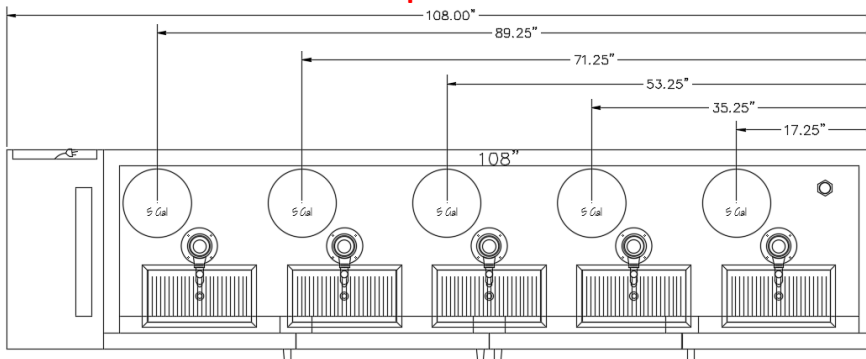

Front View

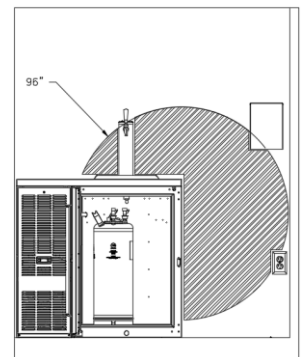

3. Once the Keg position and max distance have been determined, the position of the pump can be made.

Note: Pump must be mounted to the side of the unit or to a stud in the wall and within 6 feet of an outlet.

 2. Secure Pump Bracket (1023952-1) to the wall with four screws acceptable to local construction code.

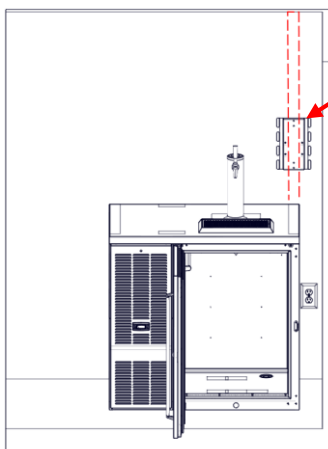

Wall Stud

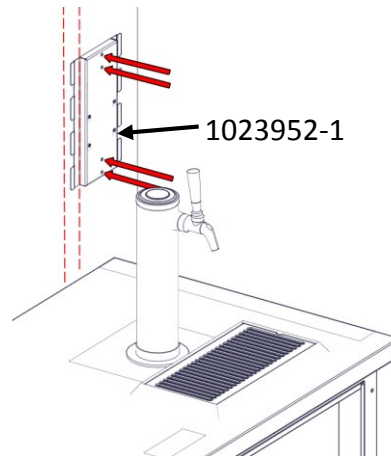

1023952-1

OPERATION #4

1. Tighten one Elbow (1024511) to each side of the pump (1013289).
2. Secure flavor locking tubing (67740) to each Elbow with one Clamp (54871-123) each.
3. Mark the ends to the tubes in a manor that helps identify the "IN" and "OUT" line.

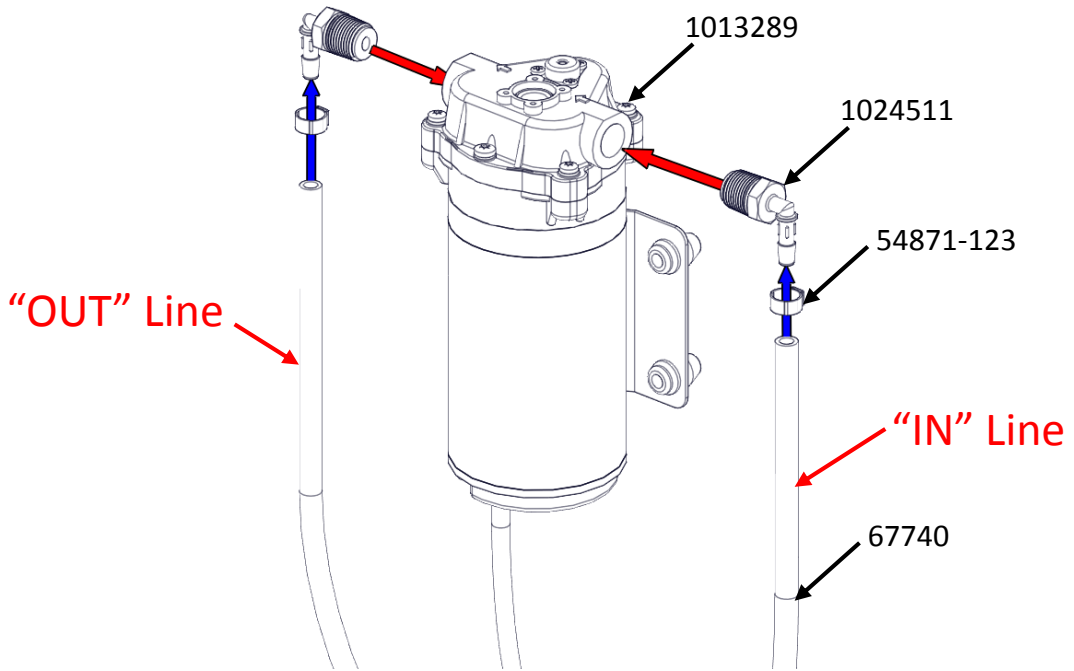

OPERATION #5

1. After tubes are secured to the pump. Mount the pump to the pump bracket with four #10-32 X 1 1/4" Pan head screws (M00494-129).

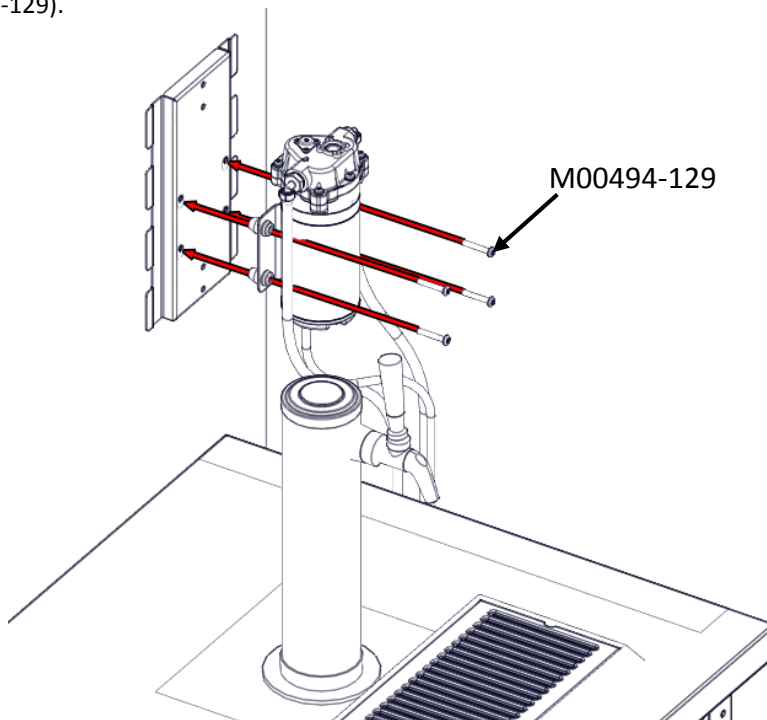

OPERATION #6

1. Now that the pump is mounted in place, feed both tube lines from the pump into the cabinet.

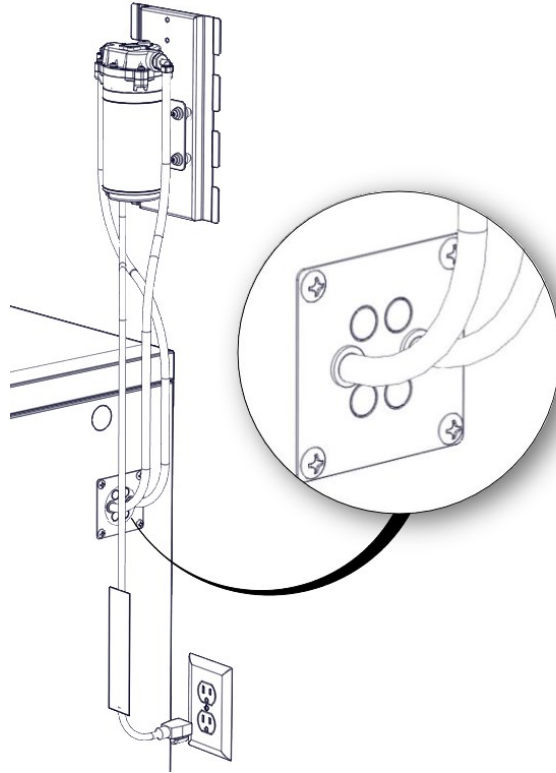

OPERATION #7

1. Once the tube lines are feed into the unit, insert two pieces of foam (70123-1) into the side wall hole to help insulate the unit.

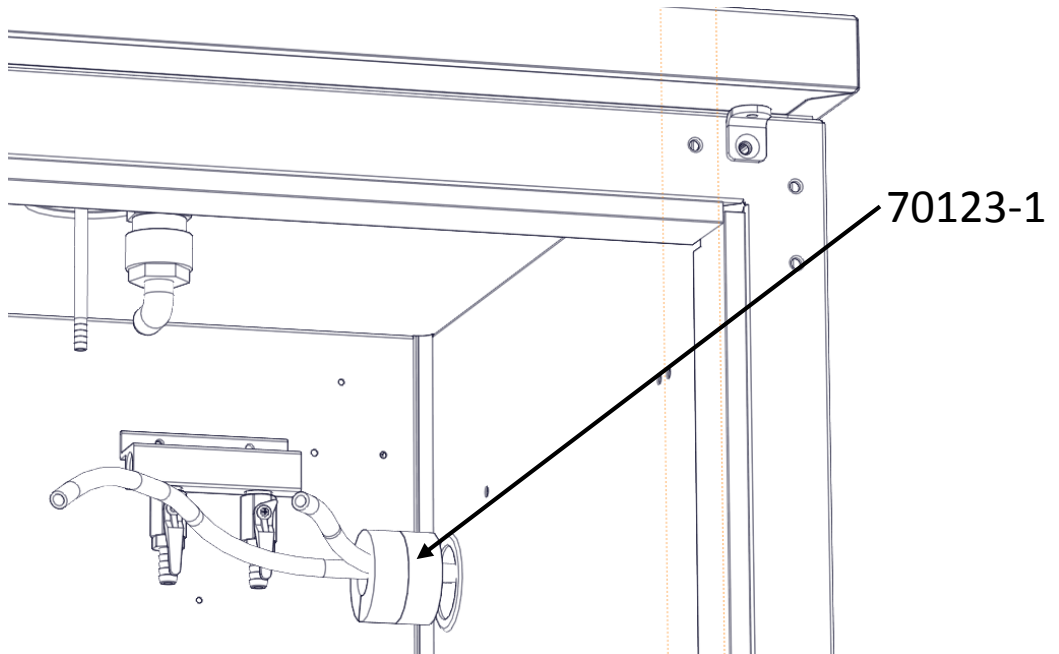

OPERATION #8

1. Attach the primary Regulator (2923C) to the gas tank (1013578)
2. Secure the Red Air Hose (1392R-250) to the primary Regulator (2923C) with one clamp (C33037).
3. Secure the Red Air Hose (1392R-250) to the secondary Regulator (1007859) with one clamp (C33037).

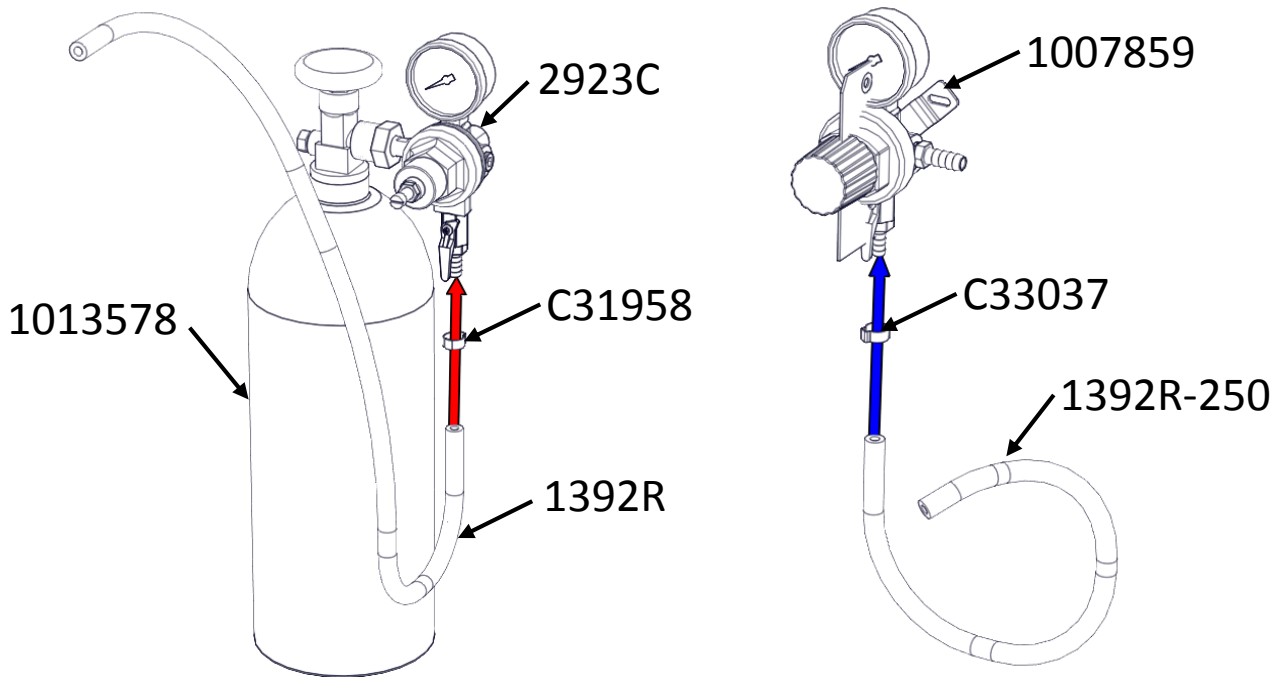

OPERATION #9

1. Secure the secondary regulator to the back wall of the unit with two screws (M50050-466).
2. Attach Air hose (1392R) to the secondary regulator to the Air distributor with two clamps (C31958). Multiple regulators can be attached to the air distributor depending on how dispensers the cabinet has.

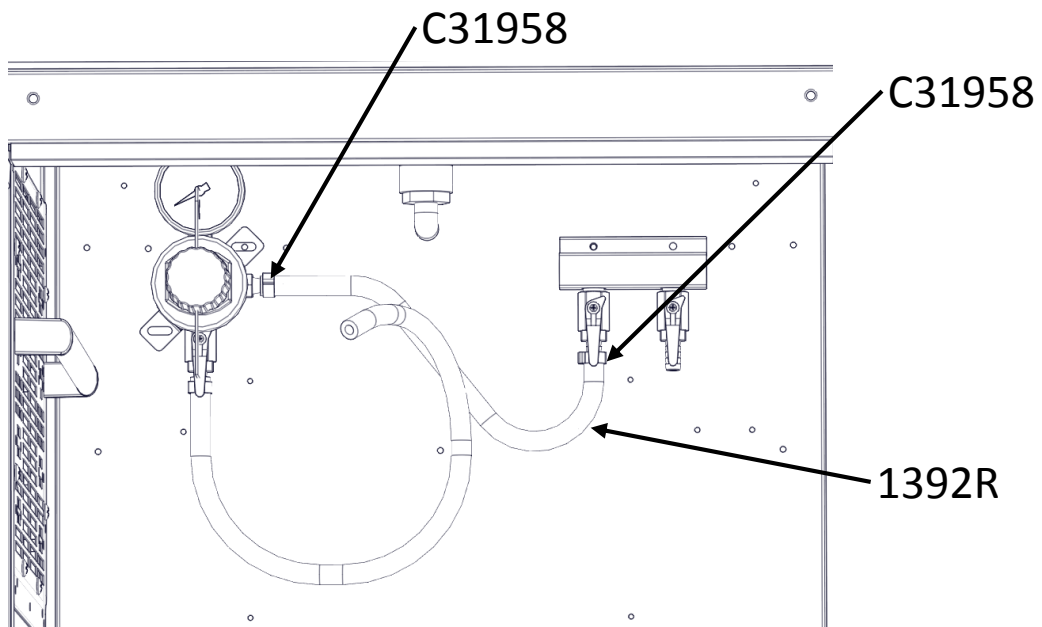

OPERATION #10

1. Secure the gas line from the primary regulator to the air distributor with one clamp (C31958)

If the gas tank is stored outside of the cabinet, run the gas line from the primary regulator through the side wall first.

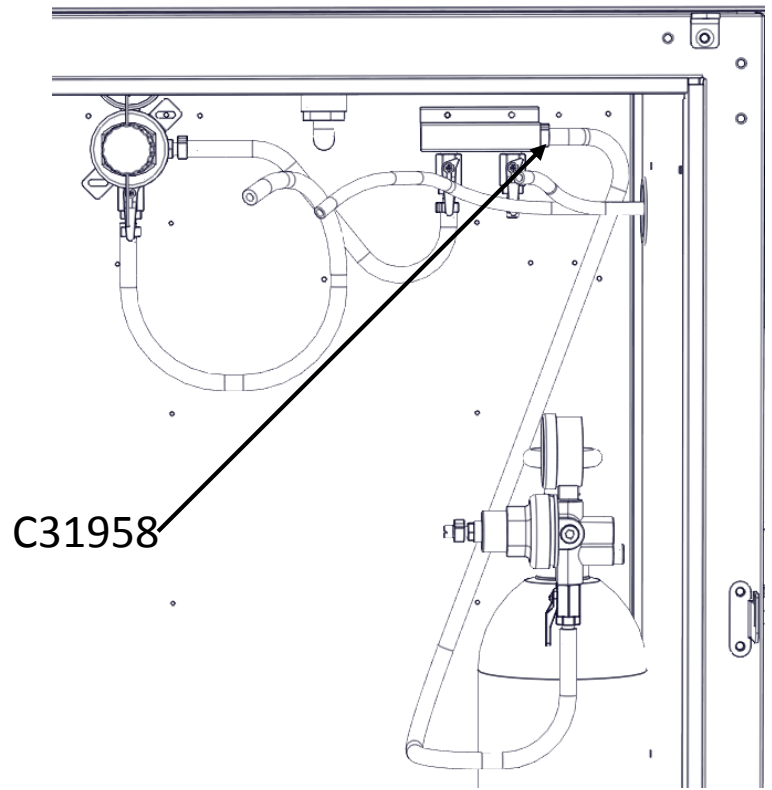

OPERATION #11

1. Place Keg into the cabinet.
2. Using Operation #13 (Tube Routing Diagram), determine the connection points of the remaining air hoses and flavor locking tubing. If lines are too long, cut tubing shorter for better assembly. However, 2 feet of addition tubing is suitable to help remove keg from cabinet.
3. Once lines have been cut to the proper length, attach all Air hoses and Taste locking tubing to the Keg.

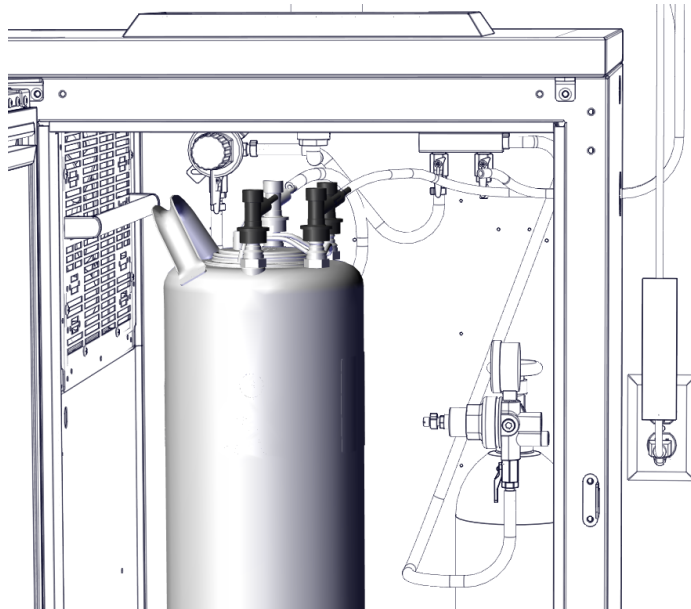

OPERATION #12

1. Attach the filter by first cutting the Keg "Out" flavor locking tubing.
2. Secure one barb (1013415) to each side of the filter (1013378).
3. Attach the filter (1013378) to the two sections of taste locking tubing with one clamp (54871-123) each.

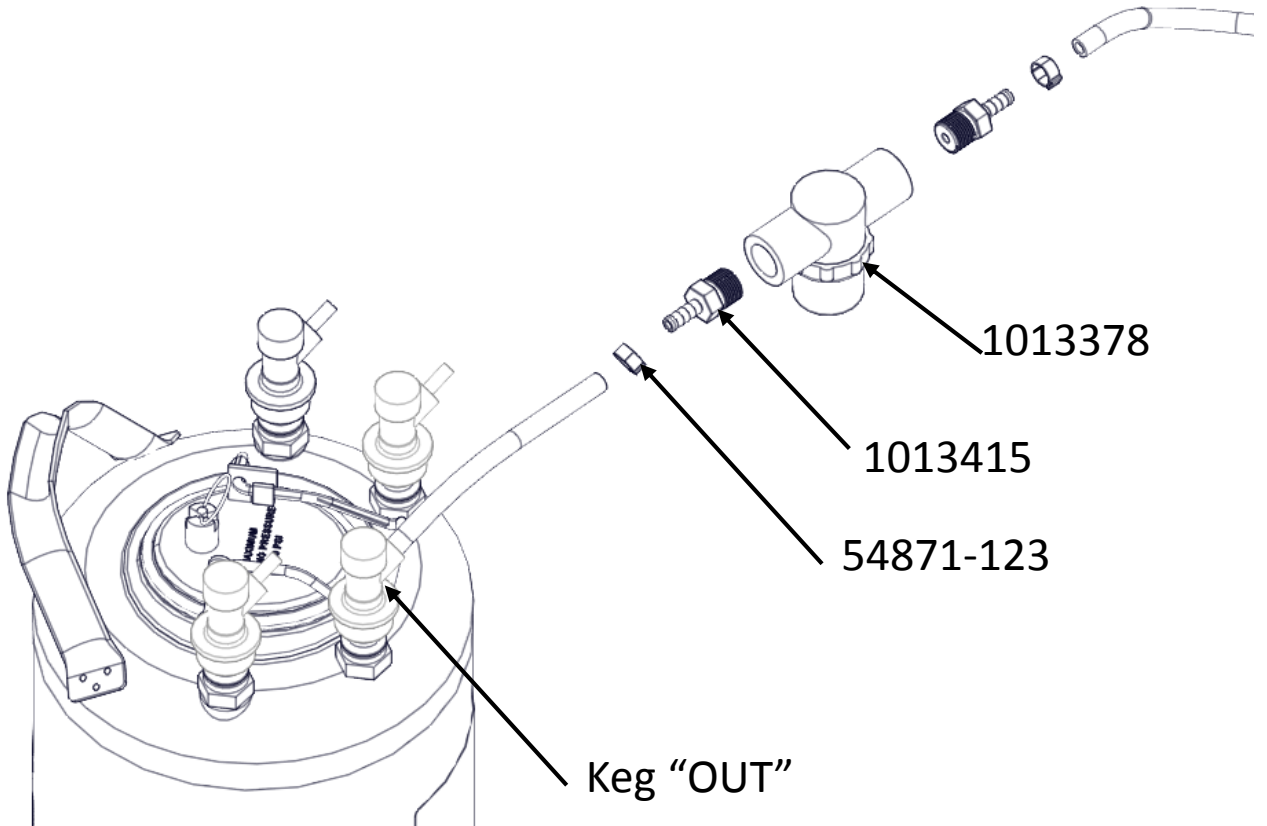

Tube Routing Diagram

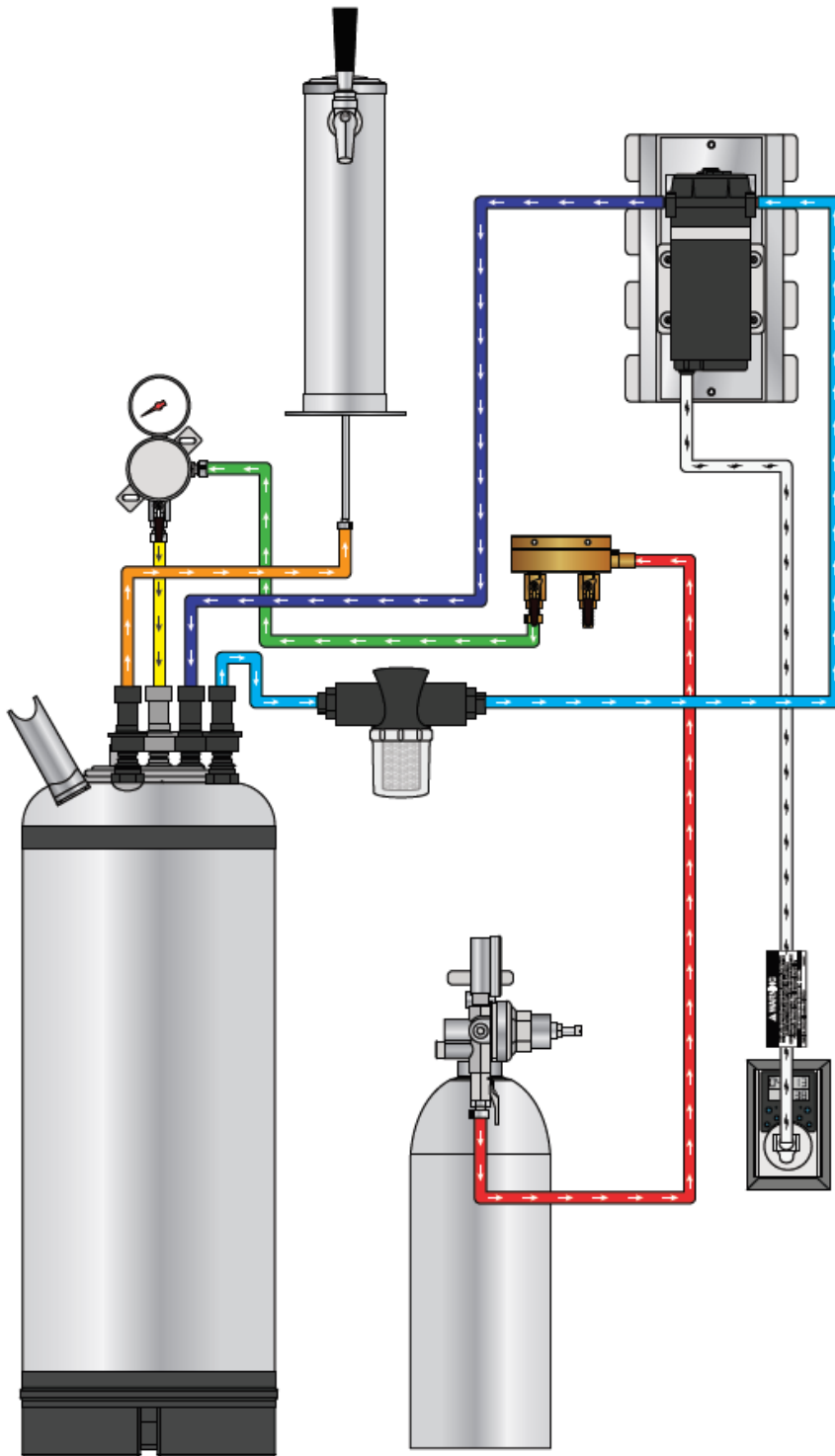

OPERATION #14

1. After all lines are hooked up, program the timer (1013381) using the instructions that is supplied with it.
2. Plug the timer into the wall and then the pump into the timer.

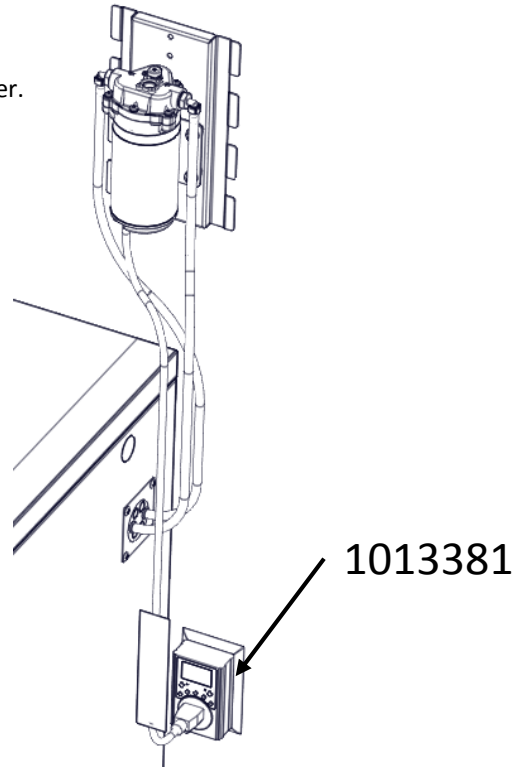

OPERATION #15

1. Slide the pump cover (1024282-1) over the pump.

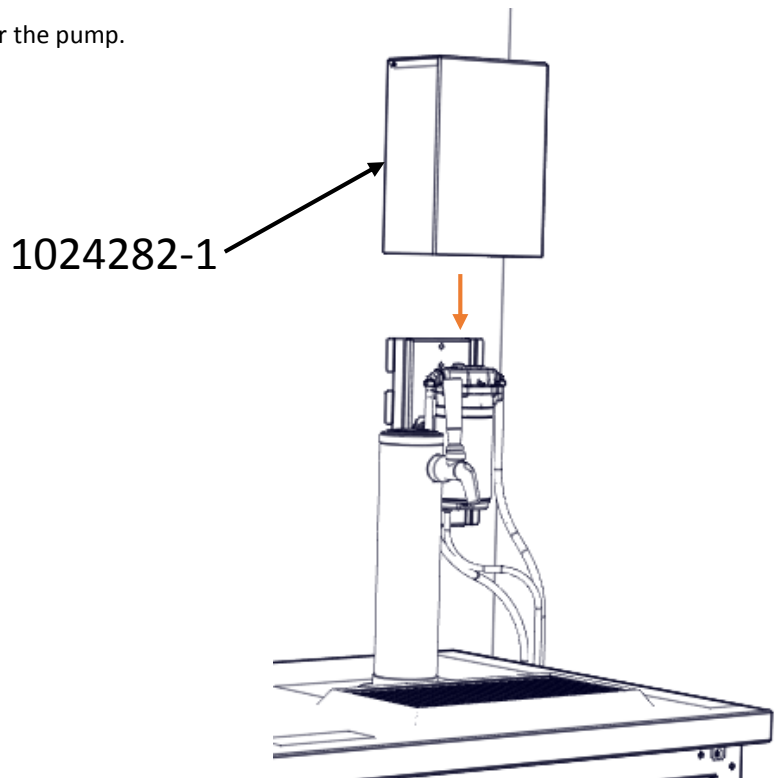

REV #	ECO #	DESCRIPTION	DATE	NAME
A	2019-0655	NEW RELEASE	9/23/2019	KDS