

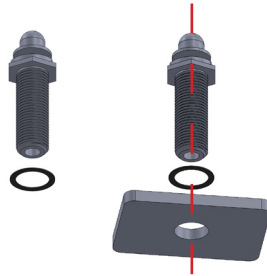

Included:
Glass Rinser & Faceplate

Tools Required:
Crescent Wrench
Channel Locks

Glass Rinser Install Guide



1. Place thin rubber seal on threaded stem. Then insert threaded stem into 7/8" hole.



2. From the bottom, place thicker rubber seal on threaded stem and push up until it contacts the bottom surface.

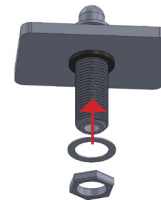

3. Place thin plastic washer on threaded stem. Then place metal locknut on threaded stem. Tighten locknut until glass rinser is fully secured.

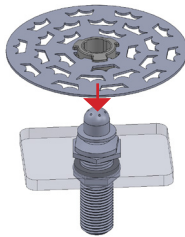

4. From the top, install stainless steel plate to glass rinser body. To install plate, place the center of the plate onto head of the rinser valve. Apply force until the plastic centerpiece is fully engaged with the head of the rinser.



5. Install Inline Pressure Regulator to incoming water line. Two 3/8" hose barbs (included) snap into regulator. Plumb regulator to braided, high pressure, flexible tubing on both ends, and secure with Stepless stainless-steel clamp.

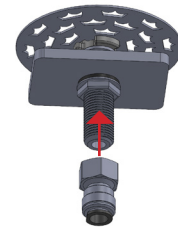

6. Connect the outlet from the regulator to the rinser water source to the threaded stem. The rinser uses 1/2" NPS thread and works with either compression fittings or plastic water line connectors.

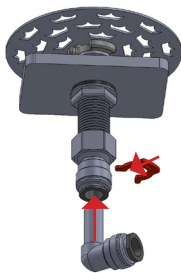

7. If a 90° elbow is required for the water line, insert the plastic elbow into the straight plastic water line connector installed in step 5 and slide the red plastic ring in to secure.

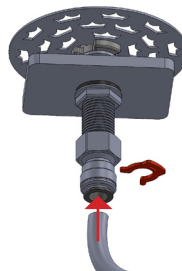

8. Insert a 1/2" OD water line tubing in the plastic fitting and slide the red plastic ring in place between water line connector to secure. Turn on the water line and check for leaks.

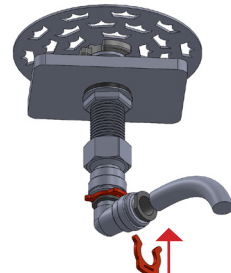

9. If using the 90° elbow, insert the 1/2" OD water line tubing into the plastic fitting of the elbow and slide the red plastic ring in place. Turn on the water line and check for leaks.