

****CAPSULE PAK™
LOCATION MAY VARY**

BUILDING CEILING

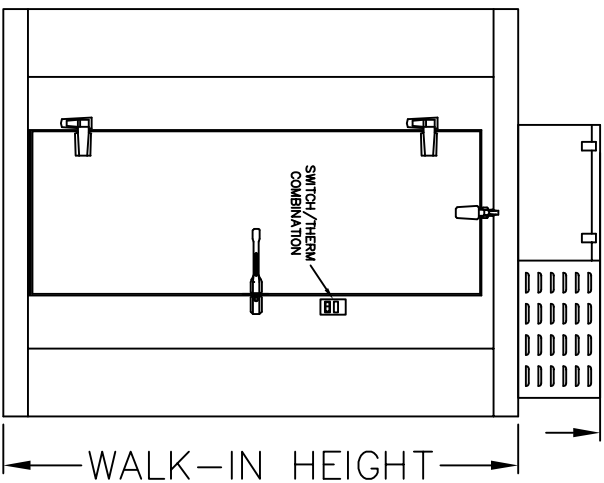

WALK-IN HEIGHT

- 6'7" (WITH FLOOR)
- 7'4" (LESS FLOOR) (STANDARD)
- 7'7" (WITH FLOOR) (STANDARD)
- 8'4" (LESS FLOOR)
- 8'7" (WITH FLOOR)

REFRIGERATION TYPE

- CEILING CAPSULE PAK™** (STANDARD)
- REMOTE
- NONE

LOCATION

- INDOOR
- OUTDOOR

DOOR SWING

- LEFT (SHOWN)
- RIGHT (DASHED)

TEMPERATURE

- 35° F
- 10° F

DOOR OPENING WIDTH

- 26" (STANDARD)
- 30"
- 36" (NOT AVAILABLE ON 6'7" HEIGHT)

PLEASE RETURN THE APPROVED DRAWINGS AS SOON AS POSSIBLE TO PREVENT ANY DELAY IN FABRICATION.

APPROVED

APPROVED AS NOTED

NOT APPROVED—RESUBMIT

SIGNED _____

DATE _____

IMPORTANT:
AFTER THE PRINT APPROVAL CHANGES MADE ADDITIONAL CHARGES AND THE POSSIBILITY OF A REVISED SHIPPING DATE

AVAILABLE DOOR LOCATION

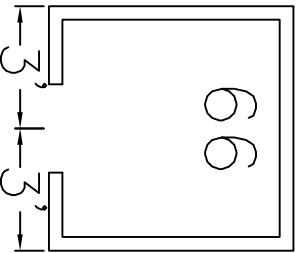

****One foot of clearance is needed between the top of the Capsule Pak™ refrigeration system and the building ceiling. Please refer to page 2 of the Capsule Pak™ specification sheet located on the Nor-Lake website for specific dimensions**

REV (B DEVINE) – 9/23/2020

| | | |
|-------------------------------------|---------------|---------|
| REFRIGERATED SOLUTIONS GROUP | DRN BY: KB | APP BY: |
| DESCRIPTION: KOLD LOCKER/QUICK SHIP | DATE: 9/14/17 | SC: NTS |
| SIZE: 6'0" x 6'0" | #: KL--66 | |