

OPERATOR MANUAL

IMPORTANT INFORMATION, KEEP FOR OPERATOR

This manual provides information on installation, operating, maintenance, trouble shooting & replacement parts for:

DROP-IN SERIES

COLD PANS:

RCP Series



THIS MANUAL MUST BE RETAINED FOR FUTURE REFERENCE. READ, UNDERSTAND AND FOLLOW THE INSTRUCTIONS AND WARNINGS CONTAINED IN THIS MANUAL.

WARNING / FOR YOUR SAFETY

Do not store or use gasoline or other flammable vapors and liquids in the vicinity of this or any other appliance.

WARNING

R290 flammable refrigerant in use. Improper installation, adjustment, alteration, service or maintenance can cause property damage, injury or death. Read the installation, operating and maintenance instructions thoroughly before installing or servicing this equipment.

NOTIFY CARRIER OF DAMAGE AT ONCE

It is the responsibility of the consignee to inspect the container upon receipt of same and to determine the possibility of any damage, including concealed damage. Unified Brands suggests that if you are suspicious of damage to make a notation on the delivery receipt. It will be the responsibility of the consignee to file a claim with the carrier. We recommend that you do so at once.

Manufacture Service/Questions 888-994-7636.

Information contained in this document is known to be current and accurate at the time of printing/creation. Unified Brands recommends referencing our product line websites, unifiedbrands.net, for the most updated product information and specifications.

PART NUMBER PP MNL1804, REV A (07/18)



A DOVER COMPANY

1055 Mendell Davis Drive
Jackson, MS 39272
888-994-7636, fax 888-864-7636
unifiedbrands.net

Table of Contents

Important Operator Notices	page 3
Labeling	page 4
Equipment Description	page 5
Installation	page 6-8
Operation	page 9-10
Maintenance	page 11
Troubleshooting	page 12
Service	page 13
Parts List	page 14
Electrical Schematic	page 15
Service Log	page 16
Warranty Policies	page 17-19

IMPORTANT - READ FIRST - IMPORTANT

Congratulations on your recent purchase of Unified Brands food service equipment, and welcome to the growing family of satisfied Unified Brands customers.

Our reputation for superior products is the result of consistent quality craftsmanship. From the earliest stages of product design to successive steps in fabrication and assembly, rigid standards of excellence are maintained by our staff of designers, engineers, and skilled employees.

Only the finest heavy-duty materials and parts are used in the production of Unified Brands brand equipment. This means that each unit, given proper maintenance will provide years of trouble free service to its owner.

In addition, all Unified Brands food service equipment is backed by some of the best warranties in the food service industry and by our professional staff of service technicians.

Retain this manual for future reference.

NOTICE: DUE TO A CONTINUOUS PROGRAM OF PRODUCT IMPROVEMENT, UNIFIED BRANDS RESERVES THE RIGHT TO MAKE CHANGES IN DESIGN AND SPECIFICATIONS WITHOUT PRIOR NOTICE.

NOTICE: PLEASE READ THE ENTIRE MANUAL CAREFULLY BEFORE INSTALLATION. IF CERTAIN RECOMMENDED PROCEDURES ARE NOT FOLLOWED, WARRANTY CLAIMS WILL BE DENIED.

MODEL NUMBER _____

SERIAL NUMBER _____

INSTALLATION DATE _____

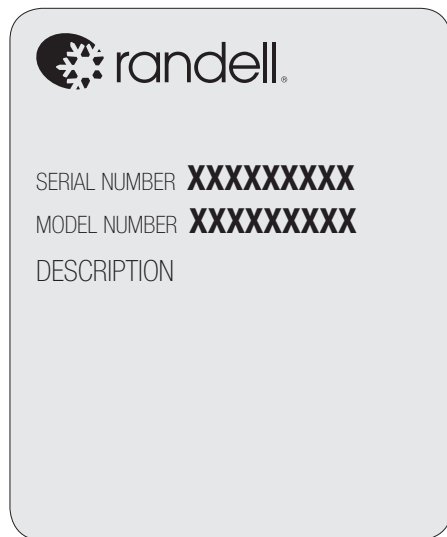

THE SERIAL NUMBER IS LOCATED ON THE UNDERSIDE OF THE COLD PAN NEAR THE DRAIN. AN EXAMPLE IS SHOWN BELOW.





Labeling

The following warning labels will be found on your equipment:

INTERIOR EVAPORATOR COVER

 DANGER RISK OF FIRE OR EXPLOSION. FLAMMABLE REFRIGERANT USED. DO NOT USE MECHANICAL DEVICES TO DEFROST REFRIGERATOR. DO NOT PUNCTURE REFRIGERANT TUBING. <small>RIESGO DE INCENDIO O EXPLOSIÓN. REFRIGERANTE INFLAMABLE UTILIZADO. NO UTILICE DISPOSITIVOS MECÁNICOS PARA DESCONGELAR EL REFRIGERADOR. NO PERFORE LA TUBERÍA DEL REFRIGERANTE.</small>	RISQUE D'INCENDIE OU D'EXPLOSION. INFLAMMABLE RÉFRIGÉRANT UTILISÉ. NE PAS UTILISER DE DISPOSITIFS MÉCANIQUES POUR DÉGIVRER LE RÉFRIGÉRATEUR. NE FAIRE AUCUN TUBE RÉFRIGÉRANT DE PONCTION. <small>SBK1,2</small>	WARNING  ALERTE <small>DO NOT REMOVE PANEL - HIGH VOLTAGE - QUALIFIED PERSONNEL ONLY NE PAS RETIRE LE PAINNEAU - HAUTE TENSION - PERSONNEL QUALIFIÉ SEULEMENT NO RETIRE EL PANEL - ALTA TENSIÓN - CALIFICADO PERSONAL</small>
		CAUTION  ATTENCIÓN <small>MOVING PARTS, DO NOT OPERATE WITH COVER REMOVED PIÉZAS MÓVILES NO PAS FABR FONCTIONNER SANS COUVERCLE LAS PIEZAS DE MOVIMIENTO NO FUNCIONAN CON LA CUBIERTA RETIRADA</small> <small>PP LBL1701</small>

NEAR MACHINE COMPARTMENT AND NAMEPLATE

 DANGER RISK OF FIRE OR EXPLOSION. FLAMMABLE REFRIGERANT USED. TO BE REPAIRED ONLY BY TRAINED SERVICE PERSONNEL. DO NOT PUNCTURE REFRIGERANT TUBING.	DANGER RISQUE D'INCENDIE OU D'EXPLOSION. RÉFRIGÉRANT INFLAMMABLE UTILISÉ. POUR ÊTRE RÉPARÉ QUE PAR UN TECHNICIEN QUALIFIÉ. NE PAS PERFORER LE TUBE RÉFRIGÉRANT.
	<small>PELIGRO RIESGO DE INCENDIO O EXPLOSIÓN. REFRIGERANTE INFLAMABLE UTILIZADO. DEBE SER REPARADO SOLAMENTE POR PERSONAL DE SERVICIO CAPACITADO. NO PERFORE LA TUBERÍA DEL REFRIGERANTE.</small> <small>SBK1,2,3</small>
 CAUTION RISK OF FIRE OR EXPLOSION. FLAMMABLE REFRIGERANT USED. CONSULT REPAIR MANUAL / OWNER'S GUIDE BEFORE ATTEMPTING TO INSTALL OR SERVICE THIS PRODUCT. ALL SAFETY PRECAUTIONS MUST BE FOLLOWED.	MISE EN GARDE RISQUE D'INCENDIE OU D'EXPLOSION. RÉFRIGÉRANT INFLAMMABLE UTILISÉ. CONSULTER LE MANUEL DE RÉPARATION / GUIDE DE L'UTILISATEUR AVANT D'ESSAYER D'INSTALLER OU DE RÉPARER CE PRODUIT. TOUTES LES PRÉCAUTIONS DOIVENT ÊTRE RESPECTÉES.
	<small>PRECAUCIÓN RIESGO DE INCENDIO O EXPLOSIÓN. REFRIGERANTE INFLAMABLE UTILIZADO. CONSULTE EL MANUAL DE REPARACIÓN / MANUAL DEL USUARIO ANTES DE INSTALAR O REPARAR ESTE PRODUCTO. DEBEN SEGUIRSE LAS PRECAUCIONES DE SEGURIDAD.</small> <small>SBK1,2,3</small> <small>PP LBL1703 REV A</small>

EXTERIOR OF UNIT

CAUTION RISK OF FIRE OR EXPLOSION. DISPOSE OF PROPERLY IN ACCORDANCE WITH FEDERAL OR LOCAL REGULATIONS. FLAMMABLE REFRIGERANT USED.	MISE EN GARDE RISQUE D'INCENDIE OU D'EXPLOSION. ÉLIMINER (or DISPOSER) CORRECTEMENT CONFORMÉMENT AUX RÉGLEMENTATIONS FÉDÉRALES OU LOCALES. RÉFRIGÉRANT INFLAMMABLE UTILISÉ.
	<small>PRECAUCIÓN RIESGO DE INCENDIO O EXPLOSIÓN. DESÉCHELO ADECUADAMENTE CONFORME A REGLAMENTOS FEDERALES O LOCALES. REFRIGERANTE INFLAMABLE UTILIZADO.</small> <small>SBK1,4</small> <small>PP LBL1704</small>

NEAR EXPOSED REFRIGERANT TUBING

CAUTION RISK OF FIRE OR EXPLOSION DUE TO PUNCTURE OF REFRIGERANT TUBING; FOLLOW HANDLING INSTRUCTIONS CAREFULLY. FLAMMABLE REFRIGERANT USED.	MISE EN GARDE RISQUE D'INCENDIE OU D'EXPLOSION EN RAISON DE LA PERFORATION DU TUBE RÉFRIGÉRANT; SUIVEZ ATTENTIVEMENT LES INSTRUCTIONS DE MANIPULATION. RÉFRIGÉRANT INFLAMMABLE UTILISÉ.
	<small>PRECAUCIÓN RIESGO DE INCENDIO O EXPLOSIÓN DEBIDO A LA PERFORACIÓN DE LA TUBERÍA DE REFRIGERANTE; SIGA CUIDADOSAMENTE LAS INSTRUCCIONES DE MANEJO. REFRIGERANTE INFLAMABLE UTILIZADO.</small> <small>SBK1,5</small> <small>PP LBL1705</small>

Equipment Description



RCP-4 Shown

MODEL	LENGTH	WIDTH	PAN CAPACITY 12" X 20"	CUTOUT DIM		HP	VOLTS	AMPS	NEMA	SHIP WT (LBS)
				LENGTH	WIDTH					
RCP-1	17 1/2"	26"	1	16"	24 3/4"	1/4	115/60/1	3.5	5-15P	110
RCP-2	30 1/4"	26"	2	28 3/4"	24 3/4"	1/4	115/60/1	3.5	5-15P	140
RCP-3	43 3/8"	26"	3	41 7/8"	24 3/4"	1/4	115/60/1	3.5	5-15P	175
RCP-4	56 1/4"	26"	4	54 3/4"	24 3/4"	1/4	115/60/1	3.5	5-15P	210
RCP-5	69 1/4"	26"	5	67 3/4"	24 3/4"	1/4	115/60/1	3.5	5-15P	245
RCP-6	82 1/8"	26"	6	80 5/8"	24 3/4"	1/4	115/60/1	3.5	5-15P	280
RCP-7	95"	26"	7	93 1/2"	24 3/4"	1/3	115/60/1	5.6	5-15P	315
RCP-8	108"	26"	8	106 1/2"	24 3/4"	1/3	115/60/1	5.6	5-15P	350
RCP-9	120"	26"	9	118 1/2"	24 3/4"	1/3	115/60/1	5.6	5-15P	385
RCP-2N	46"	18 5/16"	2	44 1/2"	17"	1/4	115/60/1	3.5	5-15P	140
RCP-3N	66 3/4"	18 5/16"	3	65 7/16"	17"	1/4	115/60/1	3.5	5-15P	175
RCP-4N	87 1/2"	18 5/16"	4	86 3/16"	17"	1/4	115/60/1	3.5	5-15P	210

Installation

CAUTION!

THIS UNIT CONTAINS R290 FLAMMABLE REFRIGERANT. USE CAUTION WHEN HANDLING MOVING AND USE OF THE REFRIGERATOR OR FREEZER. AVOID DAMAGING THE REFRIGERANT TUBING OR INCREASE THE RISK OF A LEAK.

THIS UNIT IS INTENDED FOR USE IN LABORATORIES IN COMMERCIAL, INDUSTRIAL, OR INSTITUTIONAL OCCUPANCIES AS DEFINED IN THE SAFETY STANDARD FOR REFRIGERATION SYSTEMS, ASHRAE 15.

FAILURE TO FOLLOW INSTALLATION GUIDELINES AND RECOMMENDATIONS MAY VOID THE WARRANTY ON YOUR UNIT.

IT IS IMPORTANT THAT YOUR UNIT HAS ITS OWN DEDICATED LINE. CONDENSING UNITS ARE DESIGNED TO OPERATE WITH A VOLTAGE FLUCTUATION OF PLUS OR MINUS 10% OF THE VOLTAGE INDICATED ON THE UNIT DATA TAG. BURN OUT OF A CONDENSING UNIT DUE TO EXCEEDING VOLTAGE LIMITS WILL VOID THE WARRANTY.

THE DANFOSS CONTROLLER HAS LOW VOLTAGE PROTECTION AND WILL NOT OUTPUT VOLTAGE TO THE COMPRESSOR IF VOLTAGE IS LESS THAN 104V.

IT IS IMPORTANT THAT A VOLTAGE READING BE MADE AT THE COMPRESSOR MOTOR ELECTRICAL CONNECTIONS, WHILE THE UNIT IS IN OPERATION TO VERIFY THE CORRECT VOLTAGE REQUIRED BY THE COMPRESSOR IS BEING SUPPLIED. LOW OR HIGH VOLTAGE CAN DETRIMENTALLY AFFECT OPERATION AND THEREBY VOID ITS WARRANTY.



SELECTING A LOCATION FOR YOUR NEW UNIT

The following conditions should be considered when selecting a location for your unit:

- Floor and Countertop Load:** The area on which the unit will rest must be level, free of vibration, and suitably strong enough to support the combined weights of the unit plus the maximum product load weight.
- Secure and Seal:** Once the drop in unit is installed into the counter it can be secured to the countertop by using the brackets supplied from the factory.
 - Locate square openings on exterior body of drop unit. Insert securing bracket as shown. Tighten screw to anchor the unit tightly to cabinet top.
 - Secure unit to top and seal with "NSF" approved silicone.
 - Install inside duct with thumb screws and adjust outside duct to fit between condenser coil and counter's louvered cutout
 - Secure outside duct in place with screws through pre-punched holes.
- Clearance:** See installation diagrams for minimum compartment dimension. Do not place any object that can block the ventilation exhaust from the machine compartment register. 20 inch clearance at the louvered end of the unit. Area of equipment must be free of all combustible materials.
- Ventilation:** The air cooled self contained unit requires a sufficient amount of cool clean air. The mechanical housing on all models (except RCP-1) can be rotated so that the condenser intake air can be in direct line with the cabinet fresh air opening. See page 8-9 for orientations. Also see wing nut image at left.
 - Loosen wing nuts located under cold pan body and rotate carriage to desired location.
 - Tighten wing nuts when rotation is complete.
 - Loosen nuts on each side of condenser shroud and extend to fresh air opening.
 - Tighten nuts on each side of condenser shroud

Avoid surrounding your unit around other heat generating equipment and out of direct sunlight. Also, avoid locating in an unheated room or where the room temperature may drop below 70° F (21°C) or above 86°F (32°C). It is important that drop in be installed with the condenser coil facing a ventilated opening in the cabinet. If factory supplied louver is not used, adequate airflow must be provided. See Air Flow guide below.

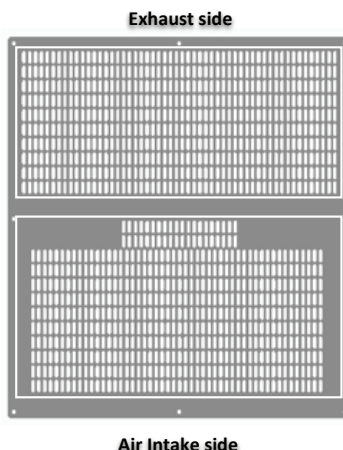

Exhaust

Total Exhaust Area = 88.7 in²

Exhaust Area slots : 10 x 54 = 540 slots

Perforation size : 0.75 in x .22 in (19 mm x 5.5mm)

Air Intake

Total Air Intake Area = 88.7 in²

Air Intake Area : 10 x 50 & 2 x 20 = 540 slots

Perforation Size : 0.75 in x .22 in (19 mm x 5.6 mm)

If the louver is to be changed/swapped with a different one, the effective area on the exhaust and intake should be maintained at all times to ensure adequate ventilation.

Installation

CAUTION!

THIS UNIT CONTAINS R290 FLAMMABLE REFRIGERANT. USE CAUTION WHEN HANDLING MOVING AND USE OF THE REFRIGERATOR OR FREEZER. AVOID DAMAGING THE REFRIGERANT TUBING OR INCREASE THE RISK OF A LEAK.

THIS UNIT IS INTENDED FOR USE IN LABORATORIES IN COMMERCIAL, INDUSTRIAL, OR INSTITUTIONAL OCCUPANCIES AS DEFINED IN THE SAFETY STANDARD FOR REFRIGERATION SYSTEMS, ASHRAE 15.

FAILURE TO FOLLOW INSTALLATION GUIDELINES AND RECOMMENDATIONS MAY VOID THE WARRANTY ON YOUR UNIT.

IT IS IMPORTANT THAT YOUR UNIT HAS ITS OWN DEDICATED LINE. CONDENSING UNITS ARE DESIGNED TO OPERATE WITH A VOLTAGE FLUCTUATION OF PLUS OR MINUS 10% OF THE VOLTAGE INDICATED ON THE UNIT DATA TAG. BURN OUT OF A CONDENSING UNIT DUE TO EXCEEDING VOLTAGE LIMITS WILL VOID THE WARRANTY.

THE DANFOSS CONTROLLER HAS LOW VOLTAGE PROTECTION AND WILL NOT OUTPUT VOLTAGE TO THE COMPRESSOR IF VOLTAGE IS LESS THAN 104V.

IT IS IMPORTANT THAT A VOLTAGE READING BE MADE AT THE COMPRESSOR MOTOR ELECTRICAL CONNECTIONS, WHILE THE UNIT IS IN OPERATION TO VERIFY THE CORRECT VOLTAGE REQUIRED BY THE COMPRESSOR IS BEING SUPPLIED. LOW OR HIGH VOLTAGE CAN DETRIMENTALLY AFFECT OPERATION AND THEREBY VOID ITS WARRANTY.

CAUTION!

UNIT MUST BE INSTALLED INTO IT'S OWN COMPARTMENT TO PROPERLY CONTAIN ANY REFRIGERANT LEAK. IT IS REQUIRED THAT NO ARCHING POTENTIAL COMPONENTS (GFCI) OR ELECTRICAL CONNECTIONS ARE BELOW 14.5" FROM THE BOTTOM OF THE CABINET.

INSTALLATION CHECKLIST

After the final location has been determined, refer to the following checklist prior to start-up:

1. Units must be installed in a minimum compartment size as indicated in the installation drawing.
2. Provided louver and air funnel must be installed in accordance with the installation drawings to ensure proper ventilation for system operation or in the event of a refrigerant leak. Compressor housing can be rotated 90 degree to align with the vented opening in the counter (see page 8 and 9). It is required that no arching potential components (GFCI) or electrical connections are below 14.5" from the bottom of the cabinet.
3. Check cord and plug of unit to assure no damage has occurred to these components.
4. Check all exposed refrigeration lines to ensure that they are not kinked, dented, or rubbing together after being installed into the counter.
5. Check that the condenser fans rotate freely without striking any stationary members.
6. Plug in unit and turn on main on/off power button on the controller.
7. Allow unit 50-60 min to cool down to temperature. If temperature adjustments are required, the control is located on the front panel. Confirm that the unit is holding the desired temperature.
8. Refer to the front of this manual for serial number location. Please record this information in your manual on page 3 now. It will be necessary when ordering replacement parts or requesting warranty service.

INSTALLATION - Minimum Cabinet Clearance

Minimum 20" clearance required for proper air flow.

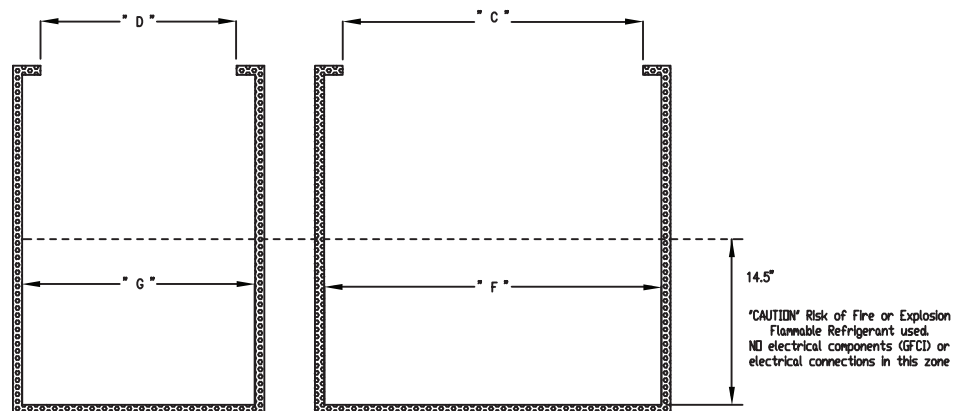

CABINET INTERNAL DIMENSIONS

Installation

CUT-OUT DIMENSION

MODELS	"A" (MIN) INCH	"B" (MIN) INCH	"C" (MIN) INCH	"D" (MIN) INCH	"E" (MIN) INCH	"F" (MIN) INCH	"G" (MIN) INCH
RCP - 1	17.5	26	16	24.75		19	27.5
RCP - 2	30.25	26	28.75	24.75	2.5 - 3.46	31.95	27.5
RCP - 3	43.37	26	41.87	24.75	2.5 - 3.46	44.87	27.5
RCP - 4	56.25	26	54.75	24.75	2.5 - 3.46	57.78	27.5
RCP - 5	69.25	26	67.75	24.75	2.5 - 3.46	70.69	27.5
RCP - 6	82.12	26	80.62	24.75	2.5 - 3.46	83.6	27.5
RCP - 7	95	26	93	24.75	2.5 - 3.46	96.5	27.5
RCP - 8	108	26	106.5	24.75	2.5 - 3.46	109.5	27.5
RCP - 9	120	26	118.5	24.75	2.5 - 3.46	121.5	27.5
RCP - 2N	46	18.32	44.5	16.8	2.5 - 3.46	47.5	19.78
RCP - 3N	66.75	18.32	65.3	16.8	2.5 - 3.46	68.3	19.78
RCP - 4N	87.5	18.32	86	16.8	2.5 - 3.46	89	19.78

CUT-OUT DIAGRAM: 2-9 PAN UNIT ONLY

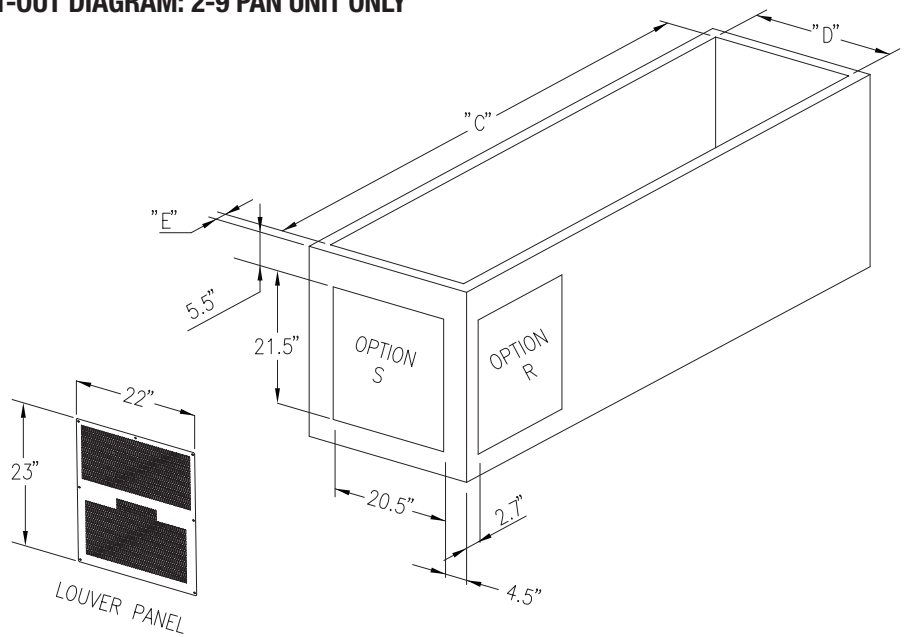

Operation

Allow unit to operate for approximately 50-60 min before placing in food.

AMBIENT CONDITIONS

Unit is designed for normal operating temperatures are between 70° F (21°C) and 86°F (32°C). Operating outside of those temperatures may cause premature product wear or failure. Unified Brands has attempted to preset the temperature control to ensure that your unit runs at an optimum temperature, but due to varying ambient conditions, including elevation, food type and your type of operation, you may need to alter this temperature using control adjustment until desired temperature is reached.

It is normal for the refrigerated cold well to develop an even layer of frost during operation. **NOTE:** Keeping the hinged cover closed as much as possible will prevent excessive frost buildup.

MORNING STARTUP





1. Cold pan cleaning may be performed at this time.
2. Turn on power to unit by either a switch or controller power button.
3. Allow 50-60 minutes for the cold pan to cool down before loading product.
4. Load the product and proceed with food preparation. **NOTE:** Product entering the cold pan must be at 37°F +/- 2°F or less. All pans should be in position.

EVENING SHUT DOWN

Remove product from the cold pan at the end of the day's preparation. The product may be discarded or stored in any commercial refrigerator.

1. Turn off power to unit by either a switch or controller power button. This will allow unit to thaw which allows for better operation when starting up unit for next day operation.
2. Unit cleaning may be performed at this time once the frost has melted off the surface. **NOTE:** Water may form small pools and have to be pushed to the drain for 100% draining.

DANFOSS CONTROLLER OPERATION

LED	FUNCTION
	Compressor energized & Evaporator fan de-energized
	Defrost in progress
	Fans delay after defrost completion
	Evaporator fan energize
	An alarm is occurring
°C / °F	Temperature unit

Operation

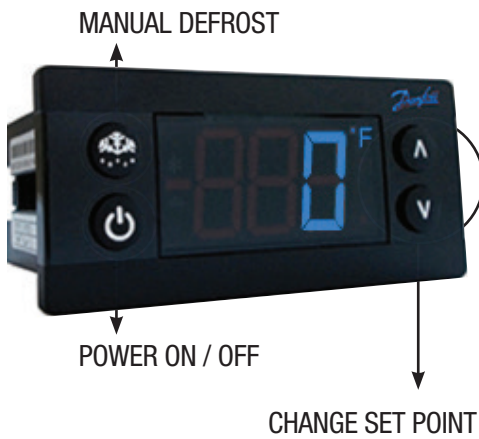

POWER ON / OFF: Press and hold the power button until LED display turns On / Off

MANUAL DEFROST: Press and hold “Defrost” Button

CHANGE SET POINT: To raise temperature

1. Press and hold “ \wedge ” to access set point.
2. When set point start flashing, Press “ \wedge ” to adjust set point
3. After 30 seconds, the display automatically reverts to showing the current temperature

CHANGE SET POINT: To lower temperature

1. Press and hold “ \vee ” to access set point
2. When set point start flashing, Press “ \vee ” to adjust set point
3. After 30 seconds, the display automatically reverts to showing the current temperature

CHANGE FROM °F /°C :

1. Press the up/down buttons simultaneously for 5 seconds to access the menu.
2. Password is requested. **Password is 000.**
3. Press the bottom left button to OK the password.
4. Using the up/down buttons, navigate to the “diS” level. Press the bottom left button to OK the selection.
5. Using the up/down buttons, navigate to the “CFu” level. Press the bottom left button to OK the selection.
 - a. “-F” designates Fahrenheit.
 - b. “-C” designates Celsius.
6. Press the top left button repeatedly to return to exit and return to the home screen.

Maintenance

DO NOT USE SHARP UTENSILS AND/OR OBJECTS.

DO NOT USE STEEL PADS, WIRE BRUSHES, SCRAPERS, OR CHLORIDE CLEANERS TO CLEAN YOUR STAINLESS STEEL.

**CAUTION
DO NOT USE ABRASIVE CLEANING SOLVENTS, AND NEVER USE HYDROCHLORIC ACID (MURIATIC ACID) ON STAINLESS STEEL.**

Unified Brands strongly suggests a preventive maintenance program which would include the following **Monthly** procedures:

1. Cleaning of all condenser coils. Condenser coils are a critical component in the life of the compressor and must remain clean to assure proper air flow and heat transfer. Failure to maintain this heat transfer will affect unit performance and eventually destroy the compressor. Clean the condenser coils with coil cleaner and/or a vacuum cleaner and brush. **NOTE:** Brush coil in direction of fins, normally vertically as to not damage or restrict air from passing through condenser.
2. Clean fan blades on the condensing unit.
3. Clean and disinfect drain lines with a solution of warm water and mild detergent.
4. Check silicone seal around drop in flange for peeling and cracks. Reapply with food grade silicone as necessary.

RECOMMENDED CLEANERS FOR YOUR STAINLESS STEEL INCLUDE THE FOLLOWING:

JOB	CLEANING AGENT	COMMENTS
Routine cleaning	Soap, ammonia, detergent Medallion	Apply with a sponge or cloth
Fingerprints and smears	Arcal 20, Lac-O-Nu, Ecoshine	Provides a barrier film
Stubborn stains and discoloration	Cameo, Talc, Zud, First Impression	Rub in the direction of the polish lines
Greasy and fatty acids, blood, burnt-on foods	Easy-Off, Degrease It, Oven Aid	Excellent removal on all finishes
Grease and Oil	Any good commercial detergent	Apply with a sponge or cloth
Restoration/Preservation	Benefit, Super Sheen	Good idea monthly

Reference: Nickel Development Institute, Diversey Lever, Savin, Ecolab, NAFEM

Proper maintenance of equipment is the ultimate necessity in preventing costly repairs. By evaluating each unit on a regular schedule, you can often catch and repair minor problems before they completely disable the unit and become burdensome on your entire operation.

For more information on preventive maintenance, consult your local service company or CFESA member. Most repair companies offer this service at very reasonable rates to allow you the time you need to run your business along with the peace of mind that all your equipment will last throughout its expected life. These services often offer guarantees as well as the flexibility in scheduling or maintenance for your convenience. For a complete listing of current Unified Brands ASA please visit www.unifiedbrands.net.

Unified Brands believes strongly in the products it manufactures and backs those products with one of the best warranties in the industry. We believe with the proper maintenance and use, you will realize a profitable return on your investment and years of satisfied service.

Troubleshooting

This unit is designed to operate smoothly and efficiently if properly maintained. However, the following is a list of checks to make in the event of a problem. Wiring diagrams are found at the end of this manual.

SYMPTOM	POSSIBLE CAUSE	PROCEDURE
Unit does not run	No power to unit	Plug in unit or check switch is in the On position
	Control in OFF position	Turn controller on
	Faulty control	Call for service at 888-994-7636
Unit too cold	Incorrect set point	Adjust control set point
Unit too warm	Incorrect set point	Adjust control set point
Unit noisy	Vibration in the cabinet	Inspect for loose parts

When in doubt, turn unit off and call for service at 888-994-7636 or email tsrandell@unifiedbrands.net.

Service

CAUTION!

COMPONENT PARTS SHALL BE REPLACED WITH FACTORY OEM PARTS. SERVICE WORK SHALL BE DONE BY FACTORY AUTHORIZED SERVICE PERSONNEL, SO AS TO MINIMIZE THE RISK OF POSSIBLE IGNITION DUE TO INCORRECT PARTS OR IMPROPER SERVICE.

CAUTION!

BEFORE MAKING ANY REPAIRS, ENSURE THE UNIT IS DISCONNECTED FROM IT'S POWER SOURCE.

This piece of equipment uses a R290 Refrigeration system. This equipment has been clearly marked on the serial tag the type of refrigerant that is being used. There is also a warning labels stating that the unit contains R290 refrigerant.

No smoking or open flames when servicing this equipment. If needed, use a CO² or dry-power type fire extinguisher

Only authorized service technician, certified in R290 system should service this equipment.

MANIFOLD SET

A R134A manifold set can be used for servicing this equipment.

REFRIGERANT RECOVERY

Follow all national and local regulations for R-290 refrigerant recovery.

LEAKING CHECKING AND REPAIR

Leak check an R290 system the same way you would an R134a or R404A system with the following exceptions.

1. Do not use a Halid leak detector on a R290 system.
2. Electronic leak detector must be designated specifically for combustible gas.

Use of a bubble solution or an ultrasonic leak detector are acceptable.

When repairing a leak, it is recommended using oxygen free dry nitrogen with a trace gas not exceeding 200PSI.

When accessing an R290 system, piercing valves are not to remain on the equipment in a permanent manner. After charge is recovered, Schrader valves are to be installed on the process stubs. Proper charge is to be weighed into the system and the system is to be leak checked afterwards.

The R290 equipment must have red process tubes and other devices through which the refrigerant is serviced, such as any service port. This color marking must remain on the equipment. If marking is removed, it must be replace and extend at least 2.5 centimeters (1") from the compressor.

CHARGING

Follow the charge amount specified on the data tag. It is recommended to use the shortest hoses possible to prevent undercharging.

- Ensure the system is sealed and leak checked
- Evacuate system to a minimum 500 micron
- Weigh in correct charge
- Leak check the system again
- Bleed the refrigerant from the high side hose to the low side hose
- Disconnect the hoses
- Remove line taps

Parts List

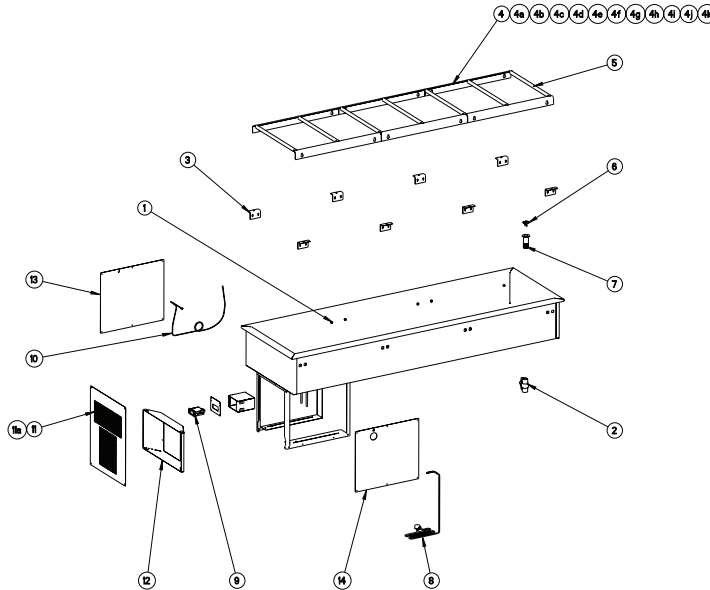

ITEM	PART NUMBER	DESCRIPTION	RCP-1	RCP-2	RCP-3	RCP-4	RCP-5	RCP-6	RCP-7	RCP-8	RCP-9	RCP-2N	RCP-3N	RCP-4N
1	HD PIN001	PIN, KEY PAN RAIL 1/2DIAx1/4, 1/4-20x3/8SHNK	-	-	-	-	-	-	-	-	-	-	-	-
2	PB VLV9909	BALL VALVE, 1" PVC THREADED	-	-	-	-	-	-	-	-	-	-	-	-
3	RP CLP0102	HOLD DOWN CLIP COLD PANS AND PLATE CHILLERS	-	-	-	-	-	-	-	-	-	-	-	-
4	RP BRK013	CLIPS, PAN RAIL, RCP-1	X	-	-	-	-	-	-	-	-	-	-	-
4a	RP BRK027	CLIPS, PAN RAIL, RCP-2	-	X	-	-	-	-	-	-	-	-	-	-
4b	RP BRK019	CLIPS, PAN RAIL, RCP-3	-	-	X	-	-	-	-	-	-	-	-	-
4c	RP BRK026	CLIPS, PAN RAIL, RCP-4	-	-	-	X	-	-	-	-	-	-	-	-
4d	RP BRK032	CLIPS, PAN RAIL, RCP-5	-	-	-	-	X	-	-	-	-	-	-	-
4e	RP BRK025	CLIPS, PAN RAIL, RCP-6	-	-	-	-	-	X	-	-	-	-	-	-
4f	RP BRK1807	BRACKET, PAN RAIL, RCP-7	-	-	-	-	-	-	X	-	-	-	-	-
4g	RP BRK1808	BRACKET, PAN RAIL, RCP-8	-	-	-	-	-	-	-	X	-	-	-	-
4h	RP BRK1809	BRACKET, PAN RAIL, RCP-7	-	-	-	-	-	-	-	-	X	-	-	-
4i	RP BRK1809	BRACKET, PAN RAIL, RCP-2N	-	-	-	-	-	-	-	-	-	X	-	-
4j	RP BRK1008	KEY HOLE SUPPORT BRACKET	-	-	-	-	-	-	-	-	-	-	X	-
4k	RP BRK0907	BRACKET, PAN RAIL, RCP-4N	-	-	-	-	-	-	-	-	-	-	-	X
5	RP BAR012	ADAPTER BAR, 12 5/8" X 7/8"	-	-	-	-	-	-	-	-	-	X	X	X
5	RP BAR0100	ADAPTER BAR, 20.5" X 7/8"	X	X	X	X	X	X	X	X	X	-	-	-
6	RP DSN001	DRAIN SCREEN	X	X	X	X	X	X	X	X	X	X	X	X
7	HD DRN1702	DRAIN, ABS, GRAY	X	X	X	X	X	X	X	X	X	X	X	X
8	EL WIR1703	POWER CORD, 9' 16/3 W/90*	X	X	X	X	X	X	X	X	X	X	X	X
9	RP CNT1803	CONTROL, DANFOSS RCP-290, PRE-PROGRAMMED	X	X	X	X	X	X	X	X	X	X	X	X
10	RF CNT1603	THERMISTOR, QTI, AIR SENSOR, BLACK, 10'	X	X	X	X	X	X	X	X	X	X	X	X
11	RP LVR1801	LOUVER, FLAT (T28-00010)	X	-	-	-	-	-	-	-	-	-	-	-
11a	RP LVR1802	LOUVER, FLAT (T28-00045)	-	X	X	X	X	X	X	X	X	X	X	X
12	RP FNL1801	FUNNEL, CONDENSING UNIT, (T28-0044)	-	X	X	X	X	X	X	X	X	X	X	X
13	RP PNL1801	SIDE, PANEL, LEFT (T28-0047)	X	X	X	X	X	X	X	X	X	X	X	X
14	RP PNL1802	SIDE, PANEL, RIGHT (T28-0048)	X	X	X	X	X	X	X	X	X	X	X	X

Parts List

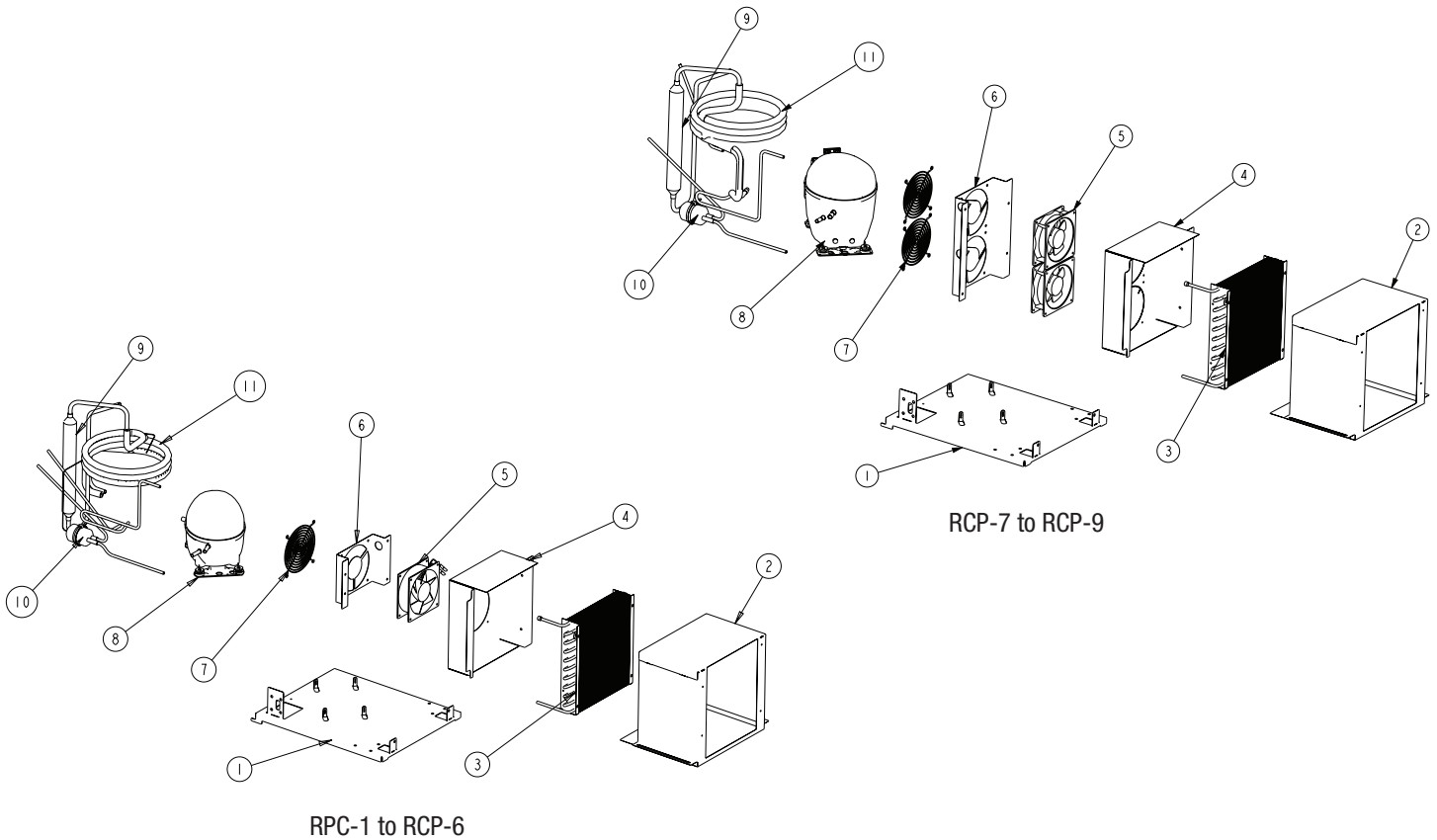

ITEM	PART NUMBER	DESCRIPTION														
			RCP-1	RCP-2	RCP-3	RCP-4	RCP-5	RCP-6	RCP-7	RCP-8	RCP-9	RCP-2N	RCP-3N	RCP-4N		
1	RP MNT1801	MOUNT, COMPRESSOR BASE SKID, (T28-0041)	X	X	X	X	X	X	X	X	X	X	X	X	X	X
2	RP SHD1802	SHROUD, CONDENSER COIL, (T28-0042)	X	X	X	X	X	X	X	X	X	X	X	X	X	X
3	RF COI1603	CONDENSER COIL	X	X	X	X	X	X	X	X	X	X	X	X	X	X
4	RP SHD1803	FAN SHROUD, SINGLE FAN, 123 MM DIA.	X	X	X	X	X	X	-	-	-	X	X	X	-	-
4	RP SHD1804	FAN SHROUD, DOUBLE FAN, 116 MM DIA	-	-	-	-	-	-	X	X	X	-	-	-	-	-
5	RF FAN0601	FAN, AXIAL, CONDENSER	X	X	X	X	X	X	-	-	-	X	X	X	-	-
5	RF FAN1701	FAN, NMB, CONDENSER	-	-	-	-	-	-	X	X	X	-	-	-	-	-
6	RP HSG1801	FAN SHROUD, SINGLE FAN SHROUD BRACKET, 123 MM DIA	X	X	X	X	X	X	-	-	-	X	X	X	-	-
6	RP HSG1802	FAN SHROUD, DOUBLE FAN SHROUD BRACKET, 116 MM DIA.	-	-	-	-	-	-	X	X	X	-	-	-	-	-
7	RF FAN1602	FAN GUARD	X	X	X	X	X	X				X	X	X	-	-
7	RF FAN0703	FAN GUARD	-	-	-	-	-	-	X	X	X	-	-	-	-	-
8	RF CMP1604	COMPRESSOR, 1/4HP, R290, EMBRACO EM2X3125U	X	X	X	X	X	X				X	X	X	-	-
8	RF CMP1702	COMPRESSOR, 1/3HP R290, EMBRACO FFU130UAX	-	-	-	-	-	-	X	X	X	-	-	-	-	-
9	RF ACM1701	ACCUMULATOR	X	X	X	X	X	X	X	X	X	X	X	X	X	X
10	RF FLT9902	FILTER DRYER	X	X	X	X	X	X	X	X	X	X	X	X	X	X
11	RP WRP1802	CAP TUBE WRAP W/ HEAT EXCHANGE, RCP-1 to RCP-6, RCP-2N to RCP-4N	X	X	X	X	X	X	-	-	-	X	X	X	-	-
11	RP WRP1803	CAP TUBE WRAP W/ HEAT EXCHANGE, RCP-7 to RCP-9	-	-	-	-	-	-	X	X	X	-	-	-	-	-

Electrical Schematic

POWER SUPPLY
115V-60HZ-1PH
CORD WITH
GROUNDED CAP
NEMA # 5-15P

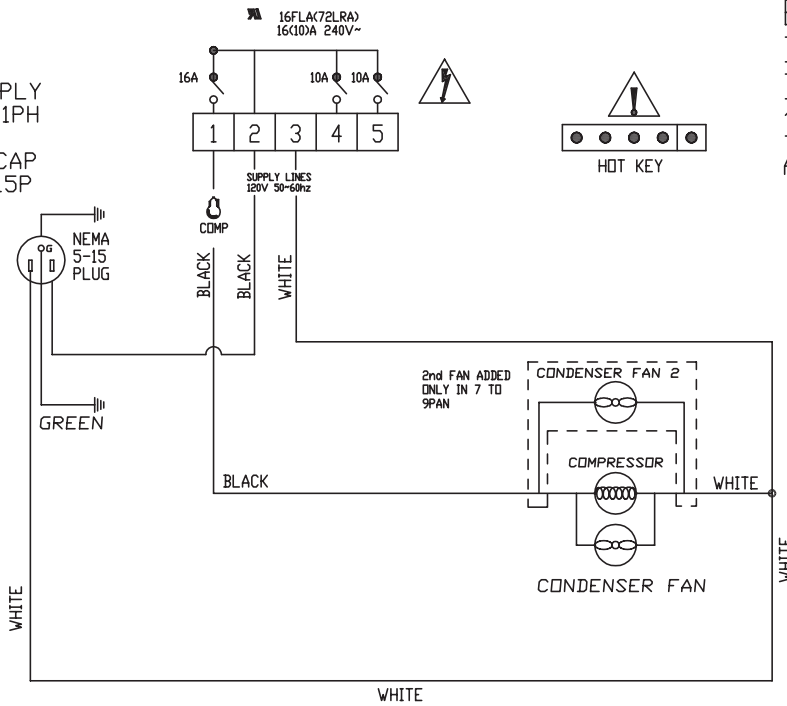

ELECTRICAL DIAGRAM
DROP IN
DANFOSS ERC112C CONTROL
115V W/FAN FUNCTIONS
ALL WIRES 18 AWG

Warranty Policies

Congratulations on your purchase of a Unified Brands Brand piece of equipment. Unified Brands believes strongly in the products it builds and backs them with the best warranty in the industry. Standard with every unit is the peace of mind that this unit has been thoroughly engineered, properly tested and manufactured to excruciating tolerances, by a manufacturer with over 30 years of industry presence. On top of that front end commitment, Unified Brands has a dedicated staff of certified technicians that monitor our own technical service hotline at **1-888-994-7636** to assist you with any questions or concerns that may arise after delivery of your new Unified Brands equipment.

PARTS WARRANTY

1. One year parts replacement of any and all parts that are found defective in material or workmanship. Unified Brands warrants all component parts of manufactured new equipment to be free of defects in material or workmanship, and that the equipment meets or exceeds reasonable industry standards of performance for a period of one year from the date of shipment from any Unified Brands factory, assembly plant or warehouse facility.

NOTE: warranties are effective from date of shipment, with a thirty day window to allow for shipment, installation and set-up. In the event equipment was shipped to a site other than the final installation site, Unified Brands will warranty for a period of three months following installation, with proof of starting date, up to a maximum of fifteen months from the date of purchase.

2. Free ground freight of customer specified location for all in warranty parts within continental U.S. Component part warranty does not cover glass breakage or gasket replacement. Unified Brands covers all shipping cost related to component part warranty sent at regular ground rates (UPS, USPS). **Freight or postage incurred for any express or specialty methods of shipping are the responsibility of the customer.**

LABOR COVERAGE

In the unlikely event a Unified Brands manufactured unit fails due to defects in materials or workmanship within the first year, Unified Brands agrees to pay the contracted labor rate performed by an Authorized Service Agent (ASA). Any work performed by a non-ASA will not be honored by Unified Brands. Please consult Unified Brands Technical Support (888-994-7636) for a complete listing of ASAs or visit the service page of our website: www.unifiedbrands.net. Warranties are effective from date of shipment, with a thirty day window to allow for shipment, installation and setup. Where equipment is shipped to any site other than final installation, Unified Brands will honor the labor warranty for a period of ninety days following installation with proof of starting date, up to a maximum of six months from date of purchase.

Temperature adjustments are not covered under warranty, due to the wide range of ambient conditions.

To request a warranty approval number, call our Field Service Department at: 1-888-994-7636

WHEN OPTIONAL 5 YEAR COMPRESSOR WARRANTY APPLIES

1. Provide reimbursement to an ASA for the cost of locally obtained replacement compressor in exchange for the return of the defective compressor sent back freight prepaid. **NOTE:** Unified Brands does limit amount of reimbursement allowed and does require bill from local supply house where compressor was obtained (customer should not pay servicing agent up front for compressor).
2. Provide repair at the manufacturing facility by requiring that the defective unit be sent back to Unified Brands freight prepaid. Perform repair at the expense of Unified Brands and ship the item back to the customer freight collect.
3. Furnish a replacement compressor freight collect in exchange for the return of the defective compressor sent back freight prepaid.
4. Furnish complete condensing unit freight collect in exchange for the return of the defective condensing unit sent back freight prepaid. (Decisions on whether or not to send complete condensing units will be made by Unified Brands in-house service technician).

Warranty Policies

WHEN OPTIONAL LABOR EXTENSION POLICY APPLIES

Unified Brands will provide reimbursement of labor to an ASA for any customer that has an optional labor extension of our standard warranty. (Contracted rates do apply) Unified Brands offers both 1 and 2 year extensions. Labor extensions begin at the end of our standard warranty and extend out 9 months to 1 calendar year or 21 months to 2 calendar years from date of purchase. Please contact Unified Brands technical service hotline at 1-888-994-7636 for details and any question on Authorized Service Agents (ASA).

WHEN EXPORT WARRANTIES APPLY

1. Unified Brands covers all non-electrical components under the same guidelines as our standard domestic policy.
2. All electrical components operated on 60Hz are covered under our standard domestic policy.
3. All electrical components operated on 50Hz are covered for 90 days from shipment only.
4. Service labor is covered for the first ninety days with authorization from the factory prior to service being performed.
5. Inbound costs on factory supplied items to be responsibility of the customer.
6. Extended warranty options are not available for parts, labor, or compressors from the factory.

ITEMS NOT COVERED UNDER WARRANTY

1. Maintenance type of repairs such as condenser cleaning, temperature adjustments, clogged drains, unit leveling and re-application of silicone.
2. Unified Brands does not cover gaskets under warranty. Gaskets are a maintenance type component that are subject to daily wear and tear and are the responsibility of the owner of the equipment. Because of the unlimited number of customer related circumstances that can cause gasket failure all gasket replacement issues are considered non-warranty. Unified Brands recommends thorough cleaning of gaskets on a weekly basis with a mild dish soap and warm water. With proper care Unified Brands gaskets can last up to two years, at which time we recommend replacement of all gaskets on the equipment for the best possible performance.

NOTICE: FOOD LOSS IS NOT COVERED UNDER WARRANTY

3. Repairs caused by abuse such as broken glass, freight damage, or scratches and dents.
4. Electrical component failure due to water damage from cleaning procedures.
5. Improper installation of equipment.
6. Repairs performed outside of Unified Brands' Authorized Service Agent network.

QUOTATIONS

Verbal quotations are provided for customer convenience only and are considered invalid in the absence of a written quotation. Written quotations from Unified Brands are valid for 30 days from quote date unless otherwise specified. Unified Brands assumes no liability for dealer quotations to end-users.

SPECIFICATION & PRODUCT DESIGN

Due to continued product improvement, specification and product design may change without notice.

Warranty Policies

SANITATION & SAFETY REQUIREMENTS

Product is designed to meet NSF sanitation and performance requirements, and UL safety requirements. Unified Brands is not responsible for specific local requirements unless made aware of them prior to bid process. Additional costs may apply.

CANCELLATIONS

Orders canceled prior to production scheduling entered into engineering/production and cancelled are subject to a cancellation charge (contact factory for details).

STORAGE CHARGES

Unified Brands makes every effort to consistently meet our customer's shipment expectations. If after the equipment has been fabricated, the customer requests delay in shipment, and warehousing is required:

1. Equipment held for shipment at purchasers request for a period of 30 days beyond original delivery date specified will be invoiced and become immediately payable.
2. Equipment held beyond 30 days after the original delivery date specified will also include storage charges.

SHIPPING & DELIVERY

Unified Brands will attempt to comply with any shipping, routing or carrier request designated by dealer, but reserves the right to ship merchandise via any responsible carrier at the time equipment is ready for shipment. Unified Brands will not be held responsible for any carrier rate differences; rate differences are entirely between the carrier and purchaser. Point of shipping shall be determined by Unified Brands (Weidman, MI/Prior, OK/Jackson, MS). At dealer's request, Unified Brands will endeavor whenever practical to meet dealer's request. Freight charges to be collect unless otherwise noted.

DAMAGES

All crating conforms to general motor carrier specifications. To avoid concealed damage, we recommend inspection of every carton upon receipt. In the event the item shows rough handling or visible damage to minimize liability, a full inspection is necessary upon arrival. Appearance of damage will require removing the crate in the presence of the driver. **A notation must be placed on the freight bill and signed for by the truck driver at the time of delivery.** Any and all freight damage that occurs to a Unified Brands piece of equipment as a result of carrier handling is not considered under warranty, and is not covered under warranty guidelines. Any freight damage incurred during shipping needs to have a freight claim filed by the receiver with the shipping carrier. Consignee is responsible for filing of freight claims when a clear delivery receipt is signed. Claims for damages must be filed immediately (within 10 days) by the consignee with the freight carrier and all cartons and merchandise must be retained for inspection. Internal or concealed damage may fall under Unified Brands responsibility dependent upon the circumstances surrounding each specific incident and are at the discretion of the Unified Brands in-house service technician.

RETURNED GOODS

Authorization for return must first be obtained from Unified Brands before returning any merchandise. Any returned goods shipment lacking the return authorization number will be refused, all additional freight costs to be borne by the returning party. Returned equipment must be shipped in original carton, freight prepaid and received in good conditions. Any returned merchandise is subject to a minimum handling charge (contact factory for details).

INSTALLATION

Equipment installation is the responsibility of the dealer and/or their customer. Unified Brands requires all equipment to be professionally installed.

PENALTY CLAUSES

Dealer penalty clauses, on their purchase order or contractually agreed to between the dealer and their clients are not binding on Unified Brands. Unified Brands does not accept orders subject to penalty clauses. This agreement supersedes any such clauses in dealer purchase orders.



1055 Mendell Davis Drive • Jackson MS 39272
888-994-7636 • 601-372-3903 • Fax 888-864-7636
unifiedbrands.net