

OWNER'S MANUAL

# iLume

2791-ILT400



**Spring**<sup>TM</sup>  
**USA**

## Before you begin

---

To ensure safe operation, read the following instructions in their entirety.

### **WARNING**

Warning is used to indicate the presence of a hazard that can cause severe personal injury, death, or substantial property damage if the warning is ignored.

### **CAUTION**

Caution is used to indicate the presence of a hazard that will or can cause minor personal injury or property damage if the caution is ignored.

### **NOTICE:**

Notice is used to note information that is important but not hazard-related.

To reduce risk of injury or damage to the equipment:

- Plug only into grounded electrical outlets matching the nameplate rated voltage
- Do not power the equipment with extension cords, power strips, or multipurpose sockets
- Do not daisy chain more than (3) units together
- Equipment should only be used in a flat, level position
- Do not obstruct or cover the equipment in any way when in use
- Do not touch the heating element or shade when in use; surfaces will be hot
- Do not operate unattended
- Closely supervise equipment operating in public areas and/or around children
- Do not operate if equipment has been damaged or is malfunctioning in any way
- Keep equipment and power cord away from open flames, electric burners or excessive heat
- Unplug equipment and let it cool before cleaning
- Unplug when not in use
- Save this manual for future reference

## Function

---

Spring USA's iLume is a streamlined, heat lamp with an adjustable height and ability to be manipulated in multiple different configurations making the heat lamp easily adaptable to any application.

The unit was designed specifically for keeping prepared food warm. Food must be at or above serving temperature before being placed under the heat lamp.

### **NOTICE:**

The heat lamp only maintains temperature - it does not cook or continue to cook food.

## Electrical Requirements

---

Item#	Voltage	Phase	Hertz	Watts	Amps	Plug
2791-ILT400	120	1	60	400	2.5	NEMA 5-15P

## Daisy Chaining

---

The iLume has a built-in receptacle located in the back of the base of the unit that allows for daisy chaining. The maximum number of iLume heat lamps allowed for daisy chaining into one 15-amp/120-volt circuit is 3 lamps.

## Installation

---

Inspect all part of the iLume prior to installation. If the unit is damaged, do not use. Contact a supplier for a replacement heat lamp. To use the heat lamp, place the unit on a flat, level surface and plug into a grounded electrical outlet.

## How to operate

---

Turn the iLume ON using the ON/OFF power switch located on the back of the base of the unit. The iLume is ON when the LED lights found in the shade of the lamp illuminate.

The heating element will begin to heat immediately.

**CAUTION**

Risk of fire or electric shock. Only operate this equipment with food in place.

The iLume LEDs will always be ON and emit light when the unit is ON. There are (2) light settings - HIGH and LOW. The HIGH setting is intended for use in settings with a considerable amount of surrounding light and provides a spotlight on the food. The LOW setting is intended for use in settings with little to no surrounding light. To change the light setting, simply press the light switch found on the back of the base of the unit.

See Figure 1 below for reference.

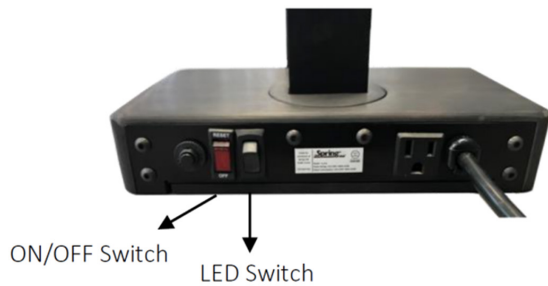

**Figure 1. Switches on Back of Base**

To adjust the height of the lamp, simply grasp the stem of the lamp and/or the loop end caps of the shade and manually move the shade. The iLume is designed to hold any manually manipulated position.

See Figure 2 below.



**Figure 2. Loop End Caps**

**NOTICE:** Lowering the height of the lamp will increase the heat transferred to the food. Increasing the height of the lamp will decrease the heat transferred to the food.

**CAUTION**

Do not grasp the shade or heating element directly when the unit is ON. Surface will be hot.

To turn the shade perpendicular to the stem of the unit, simply grasp the loop end caps of the shade and turn the head of the lamp.

See Figure 3 below.

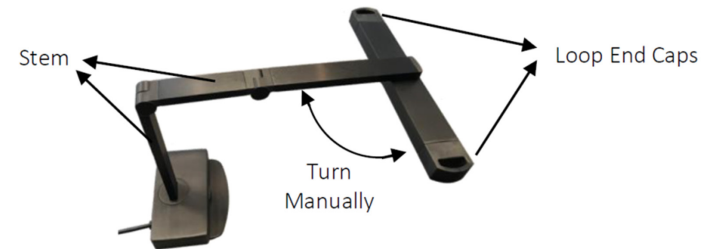

**Figure 3. Shade Perpendicular to Stem**

After use, always turn the iLume OFF using the ON/OFF power switch located on the back of the base of the unit and allow the unit to cool before handling.

## Safety Feature

The iLume is equipped with a safety feature that will shut the power off if the unit is not in an upright position or in a case of tipping or falling, to avoid causing a fire

- When the vertical stem of the heat lamp is tilted at an angle greater than 10 degrees, the heat lamp will shut off automatically. It will automatically turn back ON when it is returned to its upright position within approximately 2 seconds.



**Figure 4. Vertical Stem Tilted to the Vertical**

- When the heat lamp shade is tilted at an angle greater than 15 degrees, the heat lamp will shut off automatically. It will automatically turn ON again when the heat lamp cover is returned to its horizontal position within approximately 2 seconds.



**Figure 5. Lamp Shade Tilted to the Horizontal**

## Maintenance

To clean the iLume, turn the unit off, unplug the unit from its power source and allow to cool before handling. Wipe the unit down with a sponge or cloth with a mild dishwashing liquid. Be sure to avoid the heating element located in the shade of the unit. This does not need to be wiped down. See Figure 6 below.

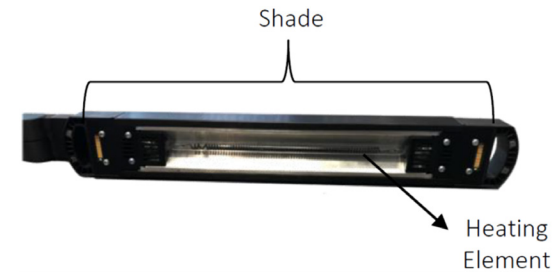

**Figure 6. Underside of Shade**

Dry with a clean, soft cloth. Never use any abrasive pads or scouring powders. Completely dry the lamp before installing. Do not immerse the heat lamp directly in water for cleaning – this will damage the unit.

To easily transport or store the iLume, ensure the shade of the lamp is parallel to the stem and manually manipulate the lamp until it is in the folded position shown below in Figure 7. The loop end cap closest to the base will fit around the tab located in the front of the base to help keep the unit in the folded position. See Figure 8 for reference.

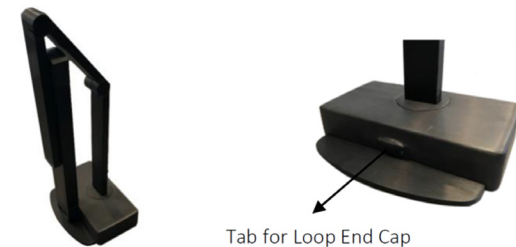

**Figure 7. Folded Position**      **Figure 8. Tab on Front of Base**

## Troubleshooting

---

Error	Cause	Solution
Lamp will not turn on	The unit is not switched on	Check that the unit is plugged in correctly and switched on
	The plug and/or cord are damaged	Call Spring USA Service Department, 1-630-527-8600
	Power supply	Check power supply

## Service & Repair

---

Never attempt to service any part of the iLume. Attempting to service the heat lamp on your own, or through an unauthorized repair facility, automatically voids your warranty, contact our Service Department at 630-527-8600. For service forms, visit the Spring USA website, [www.springusa.com](http://www.springusa.com)

## Warranty

---

For Limited Warranty information, visit the Spring USA website at [www.springusa.com/warranty](http://www.springusa.com/warranty)



THE EVOLUTION OF INTELLIGENT DESIGN

**127 Ambassador Drive, Suite 147  
Naperville, IL 60540-4079  
P: 630-527-8600  
F: 630-527-8677  
[springusa@springusa.com](mailto:springusa@springusa.com)  
[www.springusa.com](http://www.springusa.com)**