

## TRAYSLIDES: G-SERIES 1-SECTION HEATED CABINET



Parts	Universals		#1 Trayslides		#4 Trayslides	
Kit Model	G1ACC-TK4		G1ACC-TK1		G1ACC-TK2	
	Model #	QTY	Model #	QTY	Model #	QTY
Top Pilasters: Left Front, Right Rear	342-60171-01	2	342-60169-01	2	342-60169-01	2
Bottom Pilasters: Left Front, Right Rear	342-60171-02	2	342-60169-02	2	342-60169-02	2
Top Pilasters: Right Front, Left Rear	342-60172-01	2	342-60170-01	2	342-60170-01	2
Bottom Pilasters: Right Front, Left Rear	342-60172-02	2	342-60170-02	2	342-60170-02	2
Thumb Screws	351-15822-07	24	351-15822-07	24	351-15822-07	24
Trayslide Inserts	701-60039-00	14	701-60032-00	16	340-04842-00	4

### RECOMMENDED TOOLS:

Flathead Screwdriver, Rubber Mallet and Phillips Head Screwdriver (Optional).

## INSTALL UNIVERSALS



Bottom Support 18x26 or 12x20 Pans

**KIT:** G1ACC-TK4

**TRAYSLIDE PART:** 701-60039-00

- (Fig. 1a) Identify the top side of each pilaster.
- Remove the factory installed shelves, pins, and pilasters.
- (Fig. 3a-3b) Install the top section pilasters with 3 thumb screws each.
  - Hand tighten the thumb screws, check that the pilasters are parallel with the sides of the cabinet, and then tighten down with a flathead screwdriver.
  - If you cannot get to the screws with a screwdriver you will need to remove the heating element on the side of the cabinet with a Phillips Head screwdriver to tighten the thumb screws.
- Repeat step 2 with the bottom section pilasters.

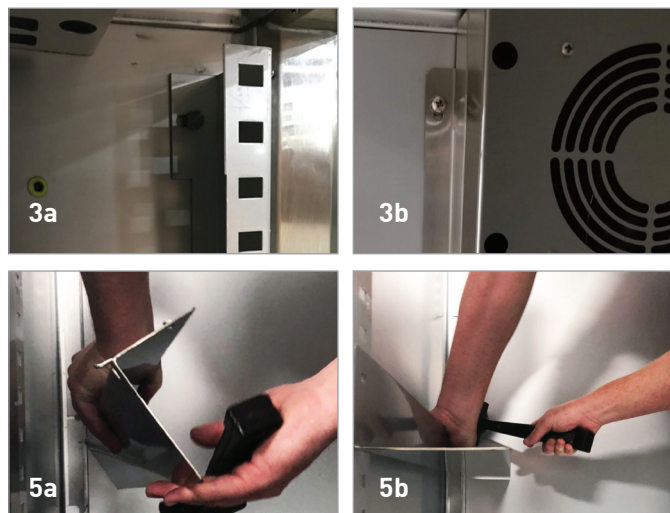

- If the heating element was removed, re-install the heating element back into its original position before installing the trayslides.
- (Fig. 5a-5b) Begin installing the trayslides on one side from bottom to top.
    - Insert the bottom set of tabs into the slots at the desired height.
    - On one side, insert the top tab into the pilaster slot, and tap the top of the trayslide near that pilaster with a rubber mallet.
    - Repeat on the other side of the trayslide while being careful not to unseat the side that was installed first.
    - Once both ends are seated in the pilaster slots, tap the top of the trayslide with a rubber mallet near both pilasters to secure it.
  - Repeat step 5 on the other side of the cabinet.
    - Be sure to check that the trayslides match up with the ones installed on the other side.
  - Test on all sets of trayslides to make sure that the pilasters and trayslides have been installed level.

## INSTALL #1 TRAYSLIDES



**Bottom Support of 18x26 Sheet Pans**

**KIT:** G1ACC-TK1

**TRAYSLIDE PART:** 701-60032-00

1. (Fig. 1a) Identify the top side of each pilaster.
2. Remove the factory installed shelves, pins, and pilasters.
3. (Fig. 3a-3b) Install the top section pilasters with 3 thumb screws each.
  - Hand tighten the thumb screws, check that the pilasters are parallel with the sides of the cabinet, and then tighten down with a flathead screwdriver.
  - If you cannot get to the screws with a screwdriver you will need to remove the heating element on the side of the cabinet with a Phillips Head screwdriver to tighten the thumb screws.
4. Repeat step 2 with the bottom section pilasters.

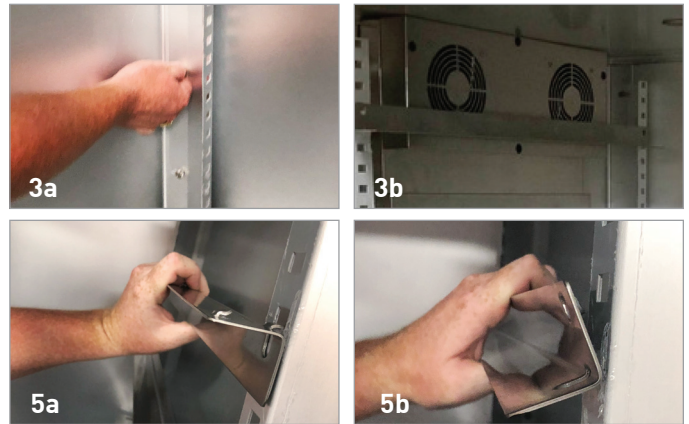

- If the heating element was removed, re-install the heating element back into its original position before installing the trayslides.
5. (Fig. 5a-5b) Begin installing the trayslides on one side from bottom to top.
    - (Fig. 5a) Insert the bottom set of tabs into the slots at desired height.
    - (Fig. 5b) On one side, insert the top tab into the pilaster slot, and tap the top of the trayslide near that pilaster with a rubber mallet.
    - Repeat on the other side of the trayslide while being careful not to unseat the side that was installed first.
    - Once both ends are seated in the pilaster slots, tap the top of the trayslide with a rubber mallet near both pilasters to secure it.
  6. Repeat step 5 on the other side of the cabinet.
    - Be sure to check that the trayslides match up with the ones installed on the other side.screwdriver.
  7. Test on all sets of trayslides to make sure that the pilasters and trayslides have been installed level.

## INSTALL #4 TRAYSLIDES



**Lip Support of 18x26 Sheet Pans**

**KIT:** G1ACC-TK2

**TRAYSLIDE PART:** 340-04842-00

1. (Fig. 1a) Identify the top side of each pilaster.
2. Remove the factory installed shelves, pins, and pilasters.
3. (Fig. 3a-3b) Install the top section pilasters with 3 thumb screws each.
  - Hand tighten the thumb screws, check that the pilasters are parallel with the sides of the cabinet, and then tighten down with a flathead screwdriver.
  - If you cannot get to the screws with a screwdriver you will need to remove the heating element on the side of the cabinet with a Phillips Head screwdriver to tighten the thumb screws.

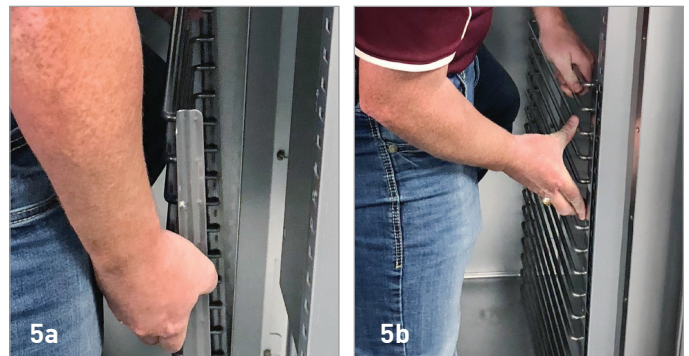

4. Repeat step 2 with the bottom section pilasters.
  - If the heating element was removed, re-install the heating element back into its original position before installing the trayslides.
5. (Fig. 5a-5b) Begin installing the trayslides on one side from bottom to top.
  - Insert the bottom set of tabs into the slots at desired height.
  - On one side, insert the top tab into the pilaster slot, and tap the top of the trayslide near the pilaster with a rubber mallet.
  - Repeat on the other side of the trayslide while being careful not to unseat the side that was installed first.
  - Once both ends are seated in the pilaster slots, tap the top of the trayslide with a rubber mallet near both pilasters to secure it.
6. Repeat step 5 on the other side of the cabinet.
  - Be sure to check that the trayslides match up with the ones installed on the other side.
7. Test on all sets of trayslides to make sure that the pilasters and trayslides have been installed level.