

Vi Tap 2 Cut Sheet

Vivreau's award-winning Vi Tap, a signature system in our portfolio, is the perfect water dispenser to suit all your needs at the touch of a button.

Project: _____

Item#: _____

Quantity: _____



Standard features:

- Commercial designed dispense tap with LED lights and electronic touch pad
- High performance remote chiller delivering 21 gal/80L per hour of chilled still or sparkling water
- Hygienic protective shield over the internal nozzle
- Specialized nozzle with zero-splash flow
- 0.2 sub-micron activated carbon block filtration
- Drip tray with direction connection to wastewater system

Ideal for:

VIP lounges, office pantries, staff break rooms, server beverage counters, hospitality environments or wellness and spa areas

Average output capacity:

21 gal/80L per hour of chilled still or sparkling water

Options & Accessories:

- Choose from a range of colors to match your decor: 
- Antimicrobial films to be attached on the touchpad.
- Natural and Organic flavor collections available to provide a health-minded alternative to sugary sodas and expensive fruit infused service.



STILL



SPARKLING

Specifications	
Design / Type finish	Tap system / Chrome
Unit dimensions under the sink (W X H X D)	15 " X 20 " X 18 1/2 " inch 38.1 X 50.8 X 46.9 cm (chiller-carbonator) 5 " (diam) X 14 " (H) inch 12.7 X 35.5 cm (chiller filter) 4 3/4 " (diam) X 19 " (H) inch 12 X 48.2 cm (boiler filter)
Unit dimensions incl. drip tray (W X H X D)	5 2/5 " X 12 5/8 " X 6 2/5 " inch 13.7 X 33 X 16.2 cm
Weight	7.4 lbs 3.3 kg (dispensing head) 73 lbs 33 kg (chiller-carbonator) 3 lbs 1.3 kg (chiller filter) 7 lbs 3.1 kg (boiler filter)
Millwork (Drilling templates attached on page 2)	
Fits into base cabinet with the following dimensions (W X H X D)	24 " X 29 1/2 " X 24 " inch 60.9 X 74.9 X 60.9 cm
Tap head clearance	Tap height: 12 5/8 " (32) cm plus additional 6", (15.2 cm) clearance for operation
NOTE: Tap must be mounted directly above the main system	
Electrical	
Electrical Requirement	(1) 20amp electrical circuit (NEMA 5-20R) 120V, 60Hz (11 amps)
CO2	
CO2 (customer supplied)	If connecting to a bulk or existing CO2 system, a CO2 line terminating at a 1/4" (0.6 cm) barbed shutoff valve must be available within 40" (101.6 cm) of the System installation site, 100psi minimum pressure.
Plumbing	
Water connection	1 potable 1/2" (1.2 cm) cold water supply terminating in a 1/2" (1.2 cm) ball valve with a 1/2" (1.2 cm) female pipe thread
Drip tray drain	Customer needs to supply a rigid vertical pipe that drains to a properly trapped drain according to local codes. The vertical pipe for the drip tray drain must be located inside the installation cabinet and must be at least 1 1/4" (2.7 cm) ID.
Minimum water pressure	50 PSI
Minimum water flow	80 gallons, 302.8 L per hour
NOTE:	
<ul style="list-style-type: none"> • Any incoming water temperature above 60°F (15.5°C) will severely compromise the ability for the system to maintain a cold water supply. • Ensure that there is sufficient room for a 12" (30.4 cm) long fitting tube connected to the shut-off valve. Top of waste up stand should be a maximum of 24" (60.9 cm) from the base of the unit. 	

Vi Tap Standard View for Worktop Cutout

There are four holes to be drilled.
2x mounting holes, **1x** drain hole, **1x** tap hole

THIS DRAWING IS NOT TO SCALE

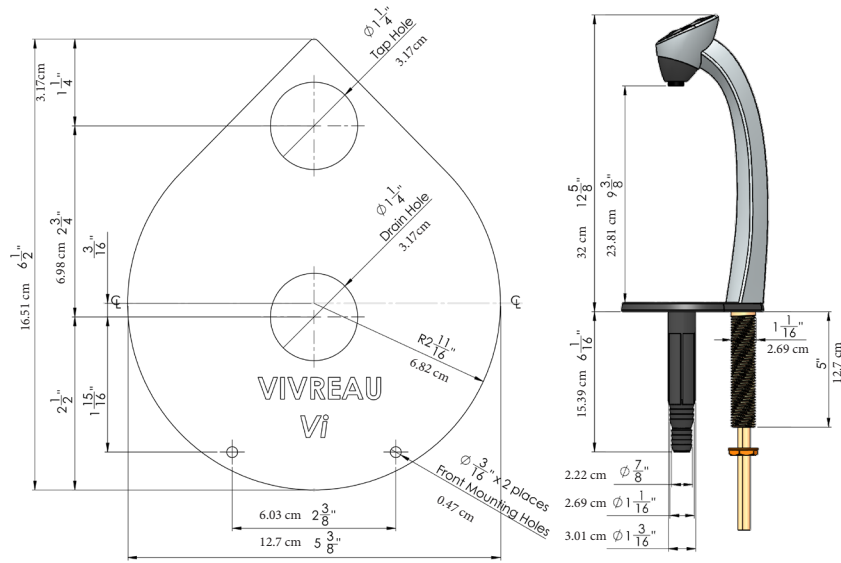

Approved Methods of Cabinet Ventilation

The cabinet may be ventilated in several different ways to prevent excessive heat build-up. The methods shown all take advantage of natural circulation by placing two grilles or cut-outs; one near the base and the other at the top of the enclosure.

Please note, all vents must open to fresh air in a free and unobstructed area and 24 square inches of opening is required for each of the top and bottom vents (48 square inches in total).

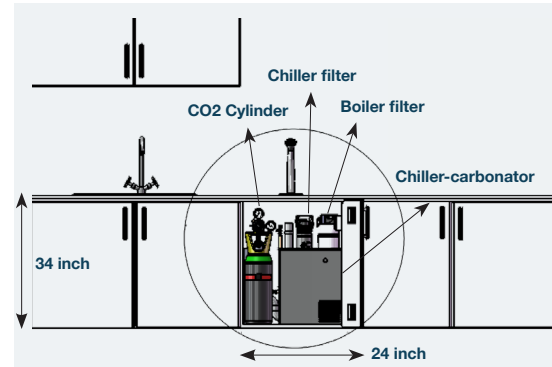

4) Top Ventilation

Countertop cutout can be used as a top ventilation option.

1) Front Ventilation

Showing Ventilation grills cut in a standard door panel.

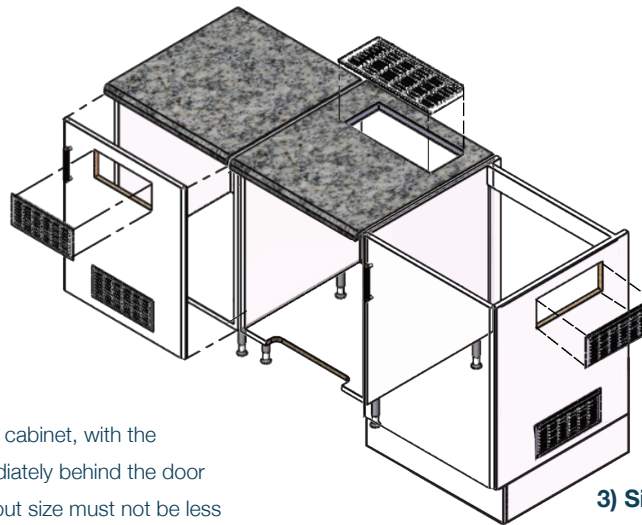

2) Base Cutout

Ventilation can be made to the base of the cabinet, with the removal of a narrow section of floor, immediately behind the door and trim with roll edging strip. Typical cut-out size must not be less than 12.0" wide x 2" deep (24 sq inch).

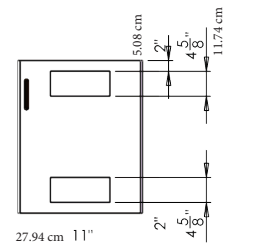

Cut-out detail for the available 12" (30.48 cm) VIVREAU grill, shown in a 23.5" (59.69 cm) [24"] wide door

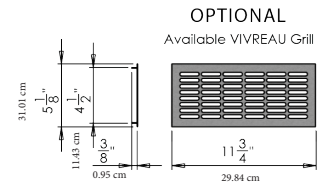

3) Side Ventilation

Ventilation grilles cut in the side of a standard cabinet. The grilles may be fitted on either side.

DOES NOT OPEN INTO AN ENCLOSED CABINET

Consultant specification:

Vivreau Water Dispensing System, single tap, fully integrated undercounted, micro-filtered, chilled still & sparkling drinking water, touch control dispenser, chiller-carbonator, water filter, Mavea descaling filter, zero splash, anti-flood detection, removeable dispense nozzle, component format, ETL, NSF (24" X 29 1/2" X 24" inch cabinet required for installation, for indoor use only)

All Vivreau products are Intertek and NSF Certified.