



F16SD

31.5" (80cm) Deep Sliding Door Utility Stands

Project _____
 Item _____
 Quantity _____
 CSI Section 11400
 Approved _____
 Date _____

Models

- F16SD36 - 36" length sliding door utility stand
- F16SD48 - 48" length sliding door utility stand
- F16SD60 - 60" length sliding door utility stand
- F16SD72 - 72" length sliding door utility stand

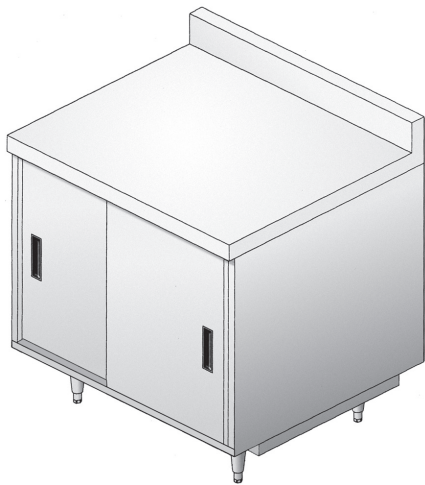

F16SD36

Standard Features

- Top is constructed of 16-gauge stainless steel
- Work height is 36"
- Two pieces of 14-gauge U-channel are welded and glued under the top for strength and sound deadening
- Two shelves constructed of stainless steel with double hemmed nosing with bracing under center shelf and bracing under bottom shelf and sound-deadening adhesive
- 14-gauge leg rails that run the entire length of the unit
- Handles are recessed black plastic and held in with a positive lock system
- Units are standard with unfinished ends
- One year parts and 90 day labor standard warranty

Options & Accessories

- Stainless steel back
- Stainless steel end
- Laminate facing
- Laminate back
- Laminate end
- Fixed or adjustable height casters
- Urn trough

Specifications

Top is constructed of 16-gauge stainless steel, with integral 2.12" (5cm) square nosing on front and 4" (10cm) high by 2" (5cm) thick backsplash on rear.

Base is provided with (2) 22-gauge stainless steel shelves. Shelves have a 5.62" (14cm) turn-up in rear. (2) sliding doors mounted on rollers to overhead track enclose cabinet front. Doors are constructed with 22-gauge stainless steel fronts and 22-gauge galvanized back panel. Shelf sides are constructed of stainless steel. Optional ends are constructed of 22-gauge stainless steel.

Legs: Unit is mounted on 6.13" (16cm) high adjustable stainless steel legs.



F16SD: 31.5" (80cm) Deep Sliding Door Utility Stands



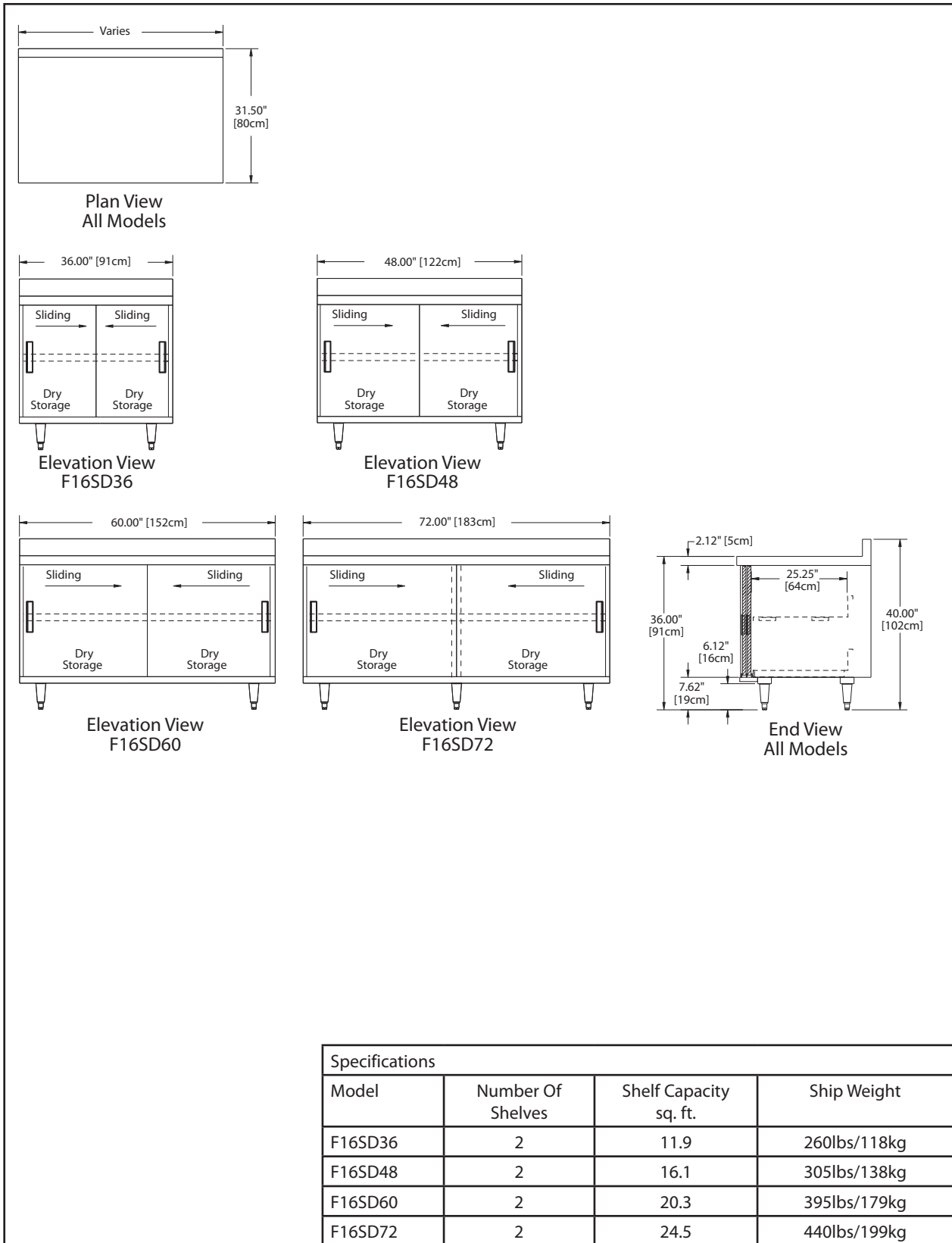

Delfield reserves the right to make changes to the design or specifications without prior notice.