



- Designed by beer-industry experts for performance and value.
- Front breathing for cooling and exhaust.



MBB36-E
Black



MBB36G-E
Black with Glass Door



MBB36S-E
Stainless Steel



MBB36GS-E
Stainless Steel with Glass Door



*Adjustable Digital Thermostat!
Easy to read exterior mounted*



Listed by Edison Testing Laboratories.
Conforms to UL & NSF Standards.

Part No.	Door Type	Door Type	Finish	Doors	Shipping Weight	
<input type="checkbox"/> MBB36-E	Solid	<input type="checkbox"/> MBB36G-E	Glass	Black	1	78 kg 172 lbs
<input type="checkbox"/> MBB36S-E	Solid	<input type="checkbox"/> MBB36GS-E	Glass	Stainless Steel	1	78 kg 172 lbs

Operating Performance

Keg Capacity of 1/2 Kegs	1	Running Amps	1.5
Cubic Feet (liters)	7.8 (220)	Voltage	115/60/1
Shelves, Flat - Included	1	Plug Type	NEMA-5-15P
Shelves, Dividers - Included	1	Cord Length	8'
Cans 12 oz (355ml)	TBD	Refrigerant	R290
Approval	ETL Listed	Charge oz	3.5
Compressor HP	1/10	Working High/Low Pressure	300 psig / 150 psig
Exterior	All Models: 18 gauge 201 grade stainless steel (s/s) top, 22 gauge solid doors, 24 gauge steel front, sides and back. Black Models: Front, sides, back and doors black vinyl over steel. S/S Models: Front, sides, back and doors are s/s.		
Interior	20 gauge stainless steel floor and walls, rugged false floor, reinforced frame		
Ventilation	Front breathing for cooling and exhaust		
Plumbing	Automatic condensate evaporator, no drain connection required. Evaporator condensate has been plumbed to a condensate pan located in the compressor housing		
Insulation	Foamed-in-place using high density, CFC-free polyurethane; 2" top, walls and floor		
Accessories	Casters or 6" fixed legs (order separately)		

Dimensions

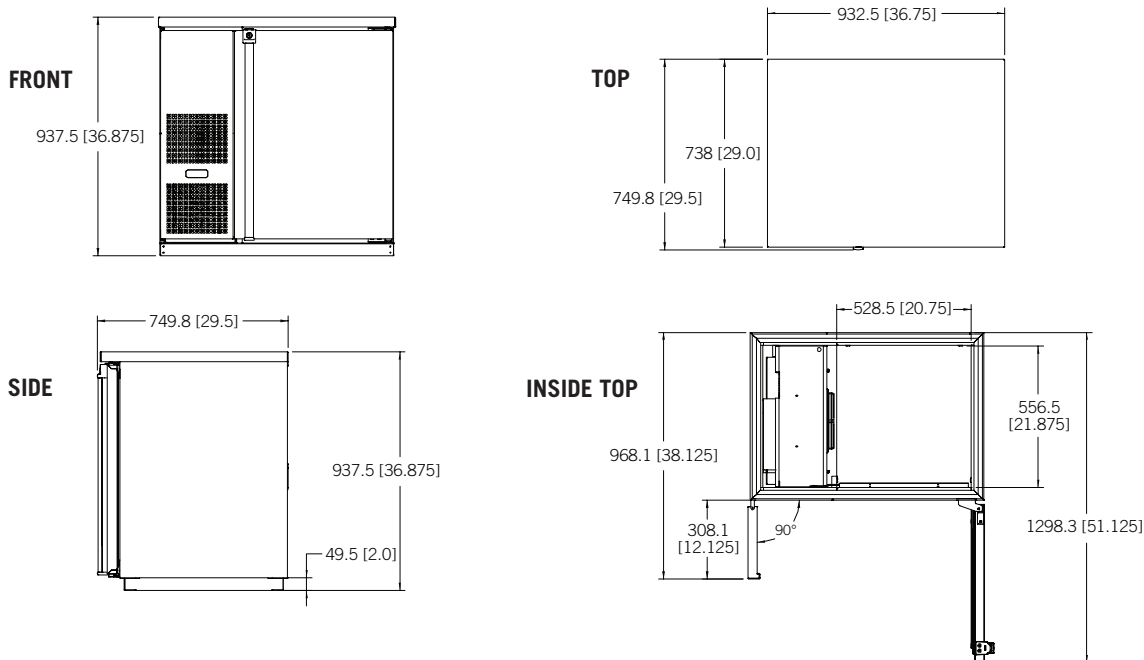

Toll-Free: 1-866-327-4159
www.micromatic.com

West

19791 Bahama St.
Northridge, CA 91324
Tel. (818) 701-9765
Fax. (818) 701-9844

Central

10726 North Second St.
Machesney Park, IL 61115
Tel. (815) 968-7557

Southeast

2386 Simon Ct.
Brooksville, FL 34604
Tel. (352) 799-6331

Northeast

4601 Saucon Creek Rd.
Center Valley, PA 18034
Tel. (610) 625-4464
Fax. (610) 625-4466