

COMPETITOR SERIES®



C-GF25-HC



C-GF36-HC



C-GF50-HC

GLASS FROSTER FREEZERS

- Beautiful ergonomic construction
- Black corrosion resistant steel exterior, stainless steel interior and stainless steel top
- Digital temperature controller and read-out
- Forced air refrigeration system
- Side mount compressor
- Safety-grip door handles
- Temperature Range: -5°F (~) 2°F
- Space saving, sliding glass doors
- Leveling feet included
- Accessory: optional casters upon request
- All Natural R290 Hydrocarbon Refrigerant
- US Department of Energy Certified
- Migali® Protection Plan: 2 Year Parts & Labor Warranty, 5 Years Compressor Warranty

MODEL	DOORS	CAPACITY CU/FT	TEMPERATURE RANGE	SHELVES	H/P	AMPS	VOLTAGE	PLUG TYPE	REFRIGERANT	EXTERIOR DIMENSIONS W X D X H	INTERIOR DIMENSIONS W X D X H	PACKAGED DIMENSIONS W X D X H	WEIGHT	PACKAGED WEIGHT
C-GF25-HC	1	4.1	-5° F (~) 2° F	4	1/3	1.3	115/60/1	Nema 5-15P	R290	26 x 28 x 34.25	22 x 23 x 26	30 x 34 x 38	128 lbs.	159 lbs.
C-GF36-HC	1	8.5	-5° F (~) 2° F	4	1/2	1.9	115/60/1	Nema 5-15P	R290	36 x 28 x 34.25	31.9 x 23 x 15.75	40 x 34 x 38	159 lbs.	198 lbs.
C-GF50-HC	2	12.2	-5° F (~) 2° F	6	1/2	3.96	115/60/1	Nema 5-15P	R290	49.5 x 28 x 34	45.4 x 23 x 26	56 x 34 x 38	181 lbs.	225 lbs.

FOR COMMERCIAL USE ONLY

NOTE: MIGALI® RESERVES THE RIGHT TO CHANGE SPECIFICATIONS WITHOUT NOTICE



TOLL FREE: 800.852.5292
WEB: www.migali.com



DIMENSIONAL DRAWINGS

C-GF25-HC

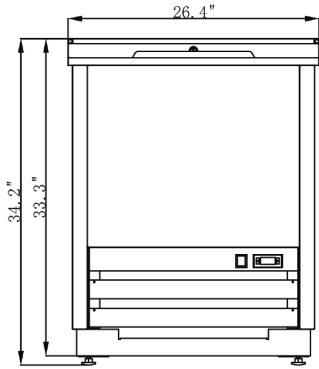

C-GF36-HC

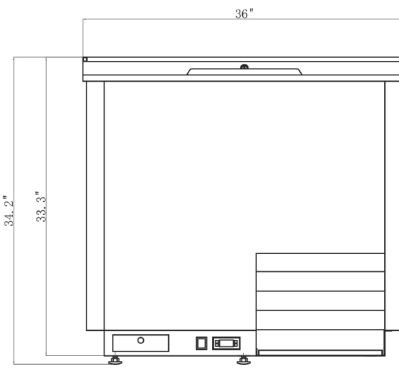

C-GF50-HC

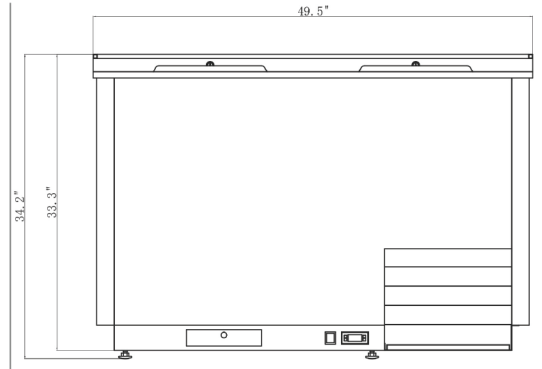

**C-GF25-HC
TOP VIEW**

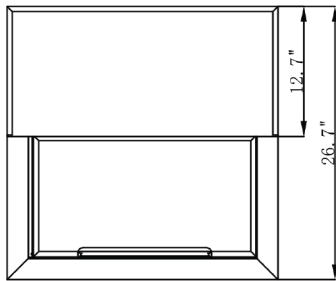

**C-GF36-HC
TOP VIEW**

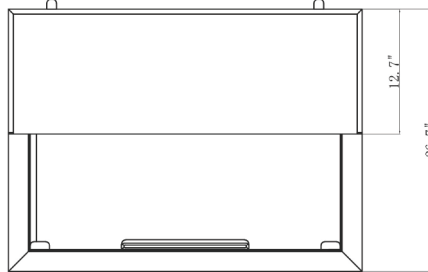

**C-GF50-HC
TOP VIEW**

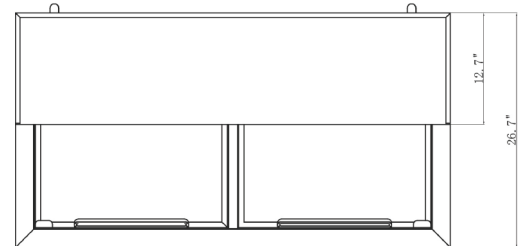

SIDE VIEW (1,2,3) DOOR MODELS

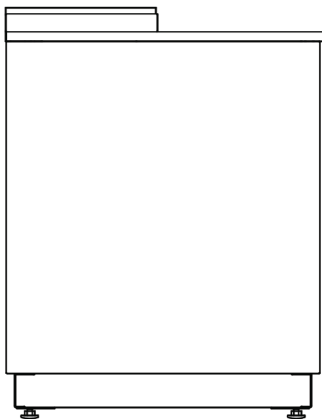

MIGALI® REMAINS AN AMERICAN FAMILY COMPANY SINCE 1955