



Stainless Solid



Black Solid



White Solid

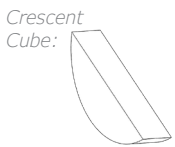

## Key Features

- Makes crescent shaped cubes approx. 1/2" W x 3/4" H x 2 1/4" L
- Produces up to 25 lb of ice per day
- Stores 25 lb of ice
- On / off switch
- White interior
- Stainless steel handle (7/8" diameter)
- Field reversible door is shipped right-hand hinged
- Built-in or freestanding
- No drain required

## Model Details

Model	Voltage/Hz	Door Swing	Finish	Shipping Weight
UACR015-SS01A	115 / 60	Field Reversible	Stainless Solid	73 lb
UACR015-BS01A	115 / 60	Field Reversible	Black Solid	73 lb
UACR015-WS01A	115 / 60	Field Reversible	White Solid	73 lb

## Accessories

Model	Description	Finish	Shipping Weight
ULAWATERHOOKUP	Braided Water Supply Line Kit	N/A	2 lb

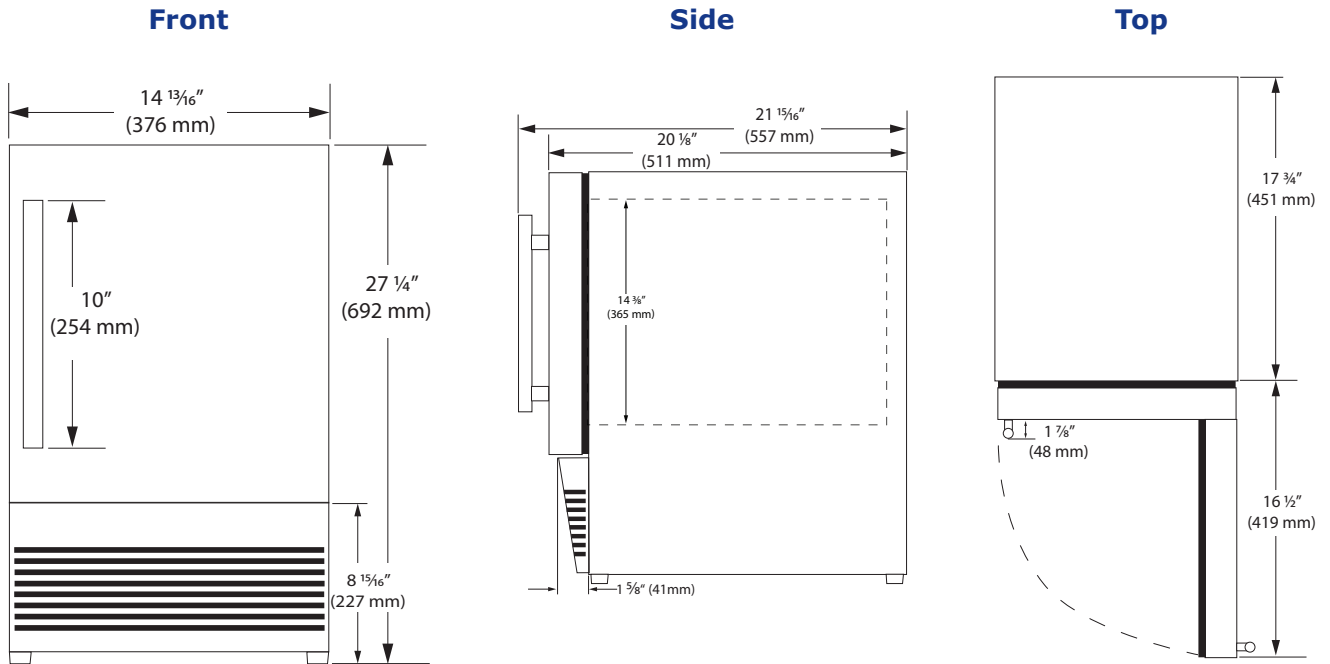

**Back**

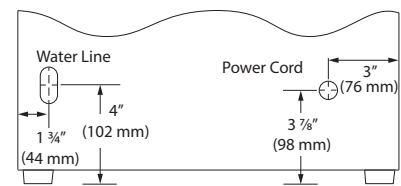

**Cabinet Cut-Out**

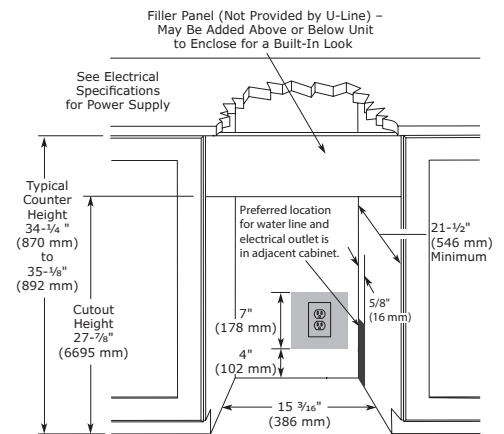

**Specifications**

Model	ACR015
Amps: Running	2.5
Control Type	On/Off Switch
Defrost Type	Manual
Dimensions: Product Depth	20 3/32" / 509 mm
Dimensions: Product Height	27 1/4" / 629 mm
Dimensions: Product Width	14 13/16" / 376 mm
ENERGY STAR	N/A
Ice Production Per Day	25 lb
Product Weight: Max	67 lb
Refrigerant Type	R600a (1.06 oz)

**Installation Notes**

- No additional clearance is needed for ventilation
- Do not obstruct front grille air flow

**Warranty**

- 1 Year (parts & labor) / 5 year sealed system (parts)
- + **Additional 1 Year (parts & labor) warranty at no cost with product registration**

See complete warranty for details

