



Model: _____ Item #: _____ Date: _____

Project: _____ Qty: _____ Approved By: _____

Combination Ice Bins with 8" Bottle Storage

Royal Series Underbar



KR19-MS32L-10

Standard Features

- 12" deep ice bin with 1" drain, 1/2" drain with cold plate units
- Insulated 8" bin for storage of liquor bottles, cheater bottles, elixir bottles, etc.
- Insulated bin section with 1" drain
- Soda line access cutout in rear on cold plate units
- Optional built-in speed rail
- 7 or 10-Circuit cold plate available depending on model
- Ice bins with cold plates include 1/2" x 6" PVC tailpiece (1/2" - 20 male threaded)
- Ships as a complete station

Specifications

- Interior: 20 gauge stainless steel
- 12" deep ice bin section, 10" deep bottle section
- Front apron: 20 gauge stainless steel clad over 20 gauge galvanized steel
- Sides: 20 gauge stainless steel
- Backsplash: 20 gauge stainless steel
- Back & Bottom: 20 gauge galvanized steel
- 1" NPS drain, bottle section
- 1" IPS drain, ice bin
- Ice bin with cold plate includes 1/2" x 6" PVC tailpiece (1/2" - 20 threaded). PVC tailpiece required to avoid condensation through metal to metal contact.
- Cast aluminum post mix plate with 7 or 10 circuits depending on model. Plate is sealed into bottom. Each circuit is 5/16" OD stainless steel tubing. Two full with remainder to be half circuits. Bump and swedge fittings on ends.

Materials

Drains & Plumbing

Cold Plate

Tubing

Access (Cold Plate)

Insulation

Backsplash

Legs

- 3/4" x 3-1/2" cutout in left side of backsplash

- Foamed-in-place polyurethane

- 6-1/2"H x 1-1/2"D

- 1-5/8" tubular legs w/ grey plastic bullet foot



Cold Plate Units supplied with 1/2" x 6" PVC tailpiece (1/2" - 20 male threaded)
Model: **KR-CPN6**

Optional Speed Rails



RS-24



RD-24

Single Speed Rails

Model	Length
RS-26	26"
RS-32	32"
RS-34	34"
RS-38	38"
RS-40	40"
RS-46	46"

Double Speed Rails

Model	Length
RD-26	26"
RD-32	32"
RD-34	34"
RD-38	38"
RD-40	40"
RD-46	46"

Options & Accessories

Model	Description
KR-103	12" Deep Stainless Steel Divider for 19"D Ice Bins
KR-113	15" Deep Stainless Steel Divider for 19"D Ice Bins
KR-303	Left & Right End Side Splashes for 19"D Ice Bins
KR-310	Right End Side Splash for 19"D Ice Bins
KR-311	Left End Side Splash for 19"D Ice Bins

Model	Description
KR-401	Cap Catcher and Opener
KR-406	Faucet Installed Over Ice Bin
KR-421	2 Metal Wire Racks
KR-501	Towel Ring
KR-502	15" Deep Liner on Ice Station





Model: _____ Item #: _____ Date: _____

Project: _____ Qty: _____ Approved By: _____

Combination Ice Bins with 8" Bottle Storage

Royal Series Underbar

Top View

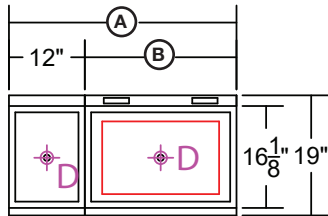

Front View

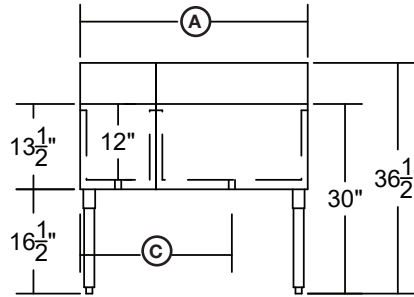

Front View - Cold plate models

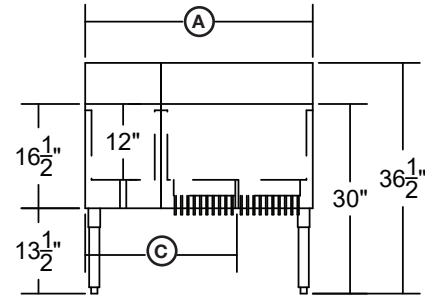

19" Depth							Cold Plate Models		
Overall Length	Depth	Ice Bin Length	Ice Bin Location	Left Side to Ice Bin Drain	Ice Capacity	Model	Wgt. (lbs.)	Models with Cold Plate	Wgt. (lbs.)
(A)		(B)		(C)					
26"	19"	18"	Right	17"	69	KR19-MS26R	80	KR19-MS26R-7	157
26"	19"	18"	Left	9"	69	KR19-MS26L	80	KR19-MS26L-7	157
34"	19"	18"	Center	17"	69	KR19-MS34C	90	KR19-MS34C-7	167
32"	19"	24"	Right	20"	92	KR19-MS32R	85	KR19-MS32R-10	162
32"	19"	24"	Left	12"	92	KR19-MS32L	85	KR19-MS32L-10	162
40"	19"	24"	Center	20"	92	KR19-MS40C	106	KR19-MS40C-10	183
38"	19"	30"	Right	22"	115	KR19-MS38R	99	KR19-MS38R-10	176
38"	19"	30"	Left	15"	115	KR19-MS38L	99	KR19-MS38L-10	176
46"	19"	30"	Center	22"	115	KR19-MS46C	113	KR19-MS46C-10	190

