



SPEC SHEET

KoolMore 25 in. Commercial Stainless Steel 1-Door Reach-In Refrigerator, 12 cu. ft.

SKU: RIR-1D-SS12C

FEATURES

- Digital temperature controls and display
- Stainless steel body
- Self-closing door with a stay-open feature for easy load
- Four casters with two breaks for increased mobility and easy cleaning
- Bottom mounted compressor
- Recessed door handles
- Includes pre-installed lock and key for guaranteed overnight freshness
- Preprogrammed digital controls feature auto-defrost
- Interior lighting
- ETL Listed for Safety and Sanitation



CLOSE UP IMAGES



TECHNICAL SPECS

Dimensions

Depth	23.5
Width	24.8
Height	63.3
Interior Depth	18.7
Interior Width	21.1
Interior Height	44.5
Shelf Width	20.2
Shelf Depth	17.7
Depth Including Handles	23.5
Depth Excluding Handles	23.5
Depth Less Door	20.7
Depth With Door Open 90 Degrees	46.4
Power Cord Length	98.5

Capacity

Gross Cubic Feet	11
Net Capacity Cu. Ft.	10.1
Individual Shelf Capacity	88l bs.

Features & Material

Door Style	Swing
Number Of Doors	1
Number Of Shelves	3
Defrost Type	Automatic
Refrigerant Type	R-290
Temperature Control Type	External Digital
Ambient Temperature Range	100 F
Temperature Range	33-40 F
Casters	4
Light Type	Fluorescent Bulb
Shelf Material Type	Epoxy Coated
Interior Material	Stainless Steel 201
Exterior Material	Stainless Steel 304

Electric Data & Certifications

Amps	3.1
Phase	1
Plug Type	NEMA 5-15P
Voltage	115
Certifications	ETL Listed for Safety and Sanitation

Plan View

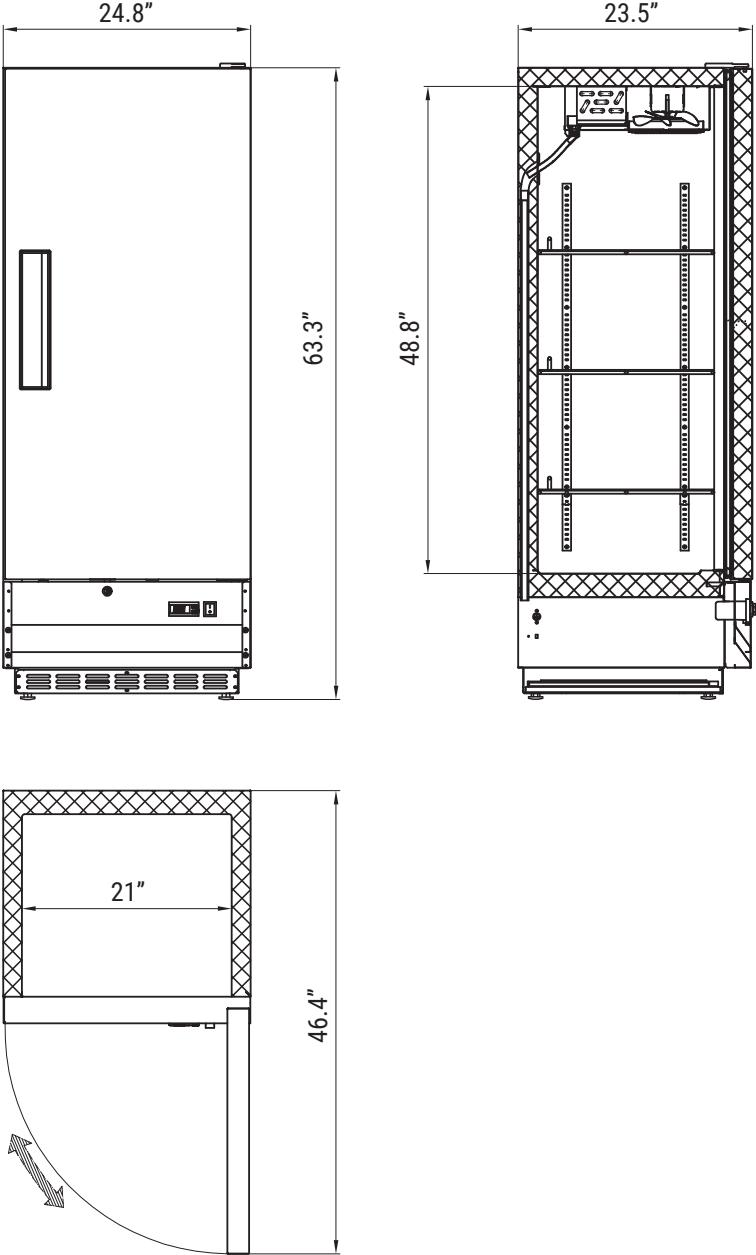

CERTIFICATIONS

The certification block contains two ETL logos. The first is labeled 'C-UL' and the second is labeled 'US'. Both logos include the text 'Intertek' and 'CERTIFICATION LIMITED'.



706 Eastern Parkway STE 1G, Brooklyn NY 11213
718-576-6342
info@koolmore.com