

# Glastender®

A family company manufacturing in the USA

[www.glastender.com](http://www.glastender.com)



C1RB48  
Stainless steel  
doors, and top



**Intertek**



**Intertek**

4004503

Conforms to NSF/ANSI STD 7  
and UL STD 471

Certified to CSA STD C22.2 No. 120

Listed to NSF Standard 7 for open  
food as a storage refrigerator

## Standard Features

- Remote refrigeration
- Stainless steel interior
- Locking door(s)
- LED interior lighting
- Heated mullion to minimize condensation
- Stainless steel evaporator housing with separate removable evaporator drain pan

Project: _____	AIA# _____
Item #: _____ Qty: _____	SIS# _____
Model #: _____	

## Coolers, One Zone, Remote, Bar Profile

**C1RB**

C1RB24, C1RB40, C1RB48, C1RB60,  
C1RB72, C1RB80, C1RB96

### CONFIGURATION HIGHLIGHTS



**DOORS  
IN NINE  
FINISHES**

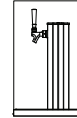

**DRAFT  
BEVERAGE  
COMPATIBLE**

## Configurable Options

### Temperature:

- Beer/Food - 34°F to 40°F
- White wine - 50°F to 55°F
- Red wine - 60°F to 65°F

### Expansion Valve Type:

- R134a/R513A
- R404A/R422A
- R448A/R452A
- R449A
- R407A/R407F
- R445A/R450A

### Refrigeration Hook-Up

#### Location:

- Left or Right

#### Door Style & Finish:

- Black vinyl-clad
- Stainless steel
- Jeweled stainless
- Laminated
- Unlaminated
- Glass, black vinyl-clad
- Glass, stainless steel
- Glass, jeweled stainless
- Glass, laminated

#### Door Hinge Location (specify for each door):

- Left or Right

#### Door Handle:

- Signature
- Pull-tab
- Tube

### Shelving (specify per door section):

- Three adjustable, coated-wire shelves
- Keg rack
- One upright and three horizontal storage pull-out wine shelf combination

### Top Style:

- No finished top
- Stainless top
- Laminated top

### Left and Right Side Finish:

- Black vinyl-clad
- Stainless steel
- Laminated

### Back Finish:

- Galvanized steel
- Stainless steel

### LED Lighting Style:

- Bright white (7,000k)
- Warm white (3,500k)
- Amber (2,700k)
- Blue

See page 5 for direct draw draft beverage towers and accessories

**Glastender, Inc.** • 5400 N Michigan Rd • Saginaw, MI • 48604-9780  
989.752.4275 • 800.748.0423 • Fax 989.752.4444  
[www.glastender.com](http://www.glastender.com)

Approval/Notes:

Specifications subject to change without notice. For current specifications please visit our website.

## Coolers - One Zone, Remote, Bar Profile

### Specifications

		C1RB24	C1RB40	C1RB48	C1RB60	C1RB72	C1RB80	C1RB96
Dimensions	Length	24"	40"	48"	60"	72"	80"	96"
	Number of Sections	1	2	2	3	3	4	4
	Door Opening	20"	16"	20"	16"	20"	16"	20"
Electrical	Electrical Supply	120V, 1 phase, 60 Hz, dedicated 15A circuit required						
	Full Load Amps	1.5						
	Plug Type	No plug, hard wire connection						
Refrigeration	Refrigerant	As specified						
	Compressor	N/A						
	System Capacity Requirements	800 BTUH	1100 BTUH	1200 BTUH	1400 BTUH	1500 BTUH	1700 BTUH	1900 BTUH
Plumbing	Drains via a supplied length of six foot 1/2" ID by 5/8" OD vinyl tubing via available knock-out holes, connection made in field							
Weight Bearing Capacity	Countertops and other accessories should not exceed 500 pounds per door							

#### Electrical

- 14 gauge wire connection is made inside the cooler next to evaporator housing - interior access is through one of the 3/4" side knock-out holes (electrician's choice)

#### Materials

- Stainless steel parts include: exterior sub-top, interior, front of cabinet, hinges, hinge and lock brackets, and optional legs
- Black vinyl-clad steel parts include: standard sides, doors and compressor cover
- Galvanized steel parts include: back and bottom
- Zinc plated CR steel parts include: leg sockets

#### Refrigeration

- Expansion valve & temperature control included; specify type when ordering
- BTU/hr design loads are figured assuming 85° F ambient, 15° F evaporator temperature, all glass doors, maximum internal loading, and average compressor cycling, no solar heat gain has been accounted for

### Capacities

	C1RB24	C1RB40	C1RB48	C1RB60	C1RB72	C1RB80	C1RB96
12 oz. bottles, cases	8.0	12.3	16.2	19.9	25.9	27.7	35.7
750ml wine bottles	60	126	152	216	256	294	354
1/2 barrel kegs	1	N/A	2	N/A	4	N/A	5
1/6 barrel kegs	2	6	7	10	11	14	17
<b>Capacity values below are per door/drawer section (750ml wine bottles)</b>							
Drawers	N/A	N/A	N/A	N/A	N/A	N/A	N/A
Upright pull-out	N/A	N/A	N/A	N/A	N/A	N/A	N/A
Horizontal pull-out	N/A	N/A	N/A	N/A	N/A	N/A	N/A
Combination pull-out	50	36	50	36	50	36	50



5400 N Michigan Rd • Saginaw, MI • 48604-9780  
 989.752.4275 • 800.748.0423 • Fax 989.752.4444  
[www.glastender.com](http://www.glastender.com)

Printed in USA

# Coolers - One Zone, Remote, Bar Profile

## Drawings

### PLAN VIEWS

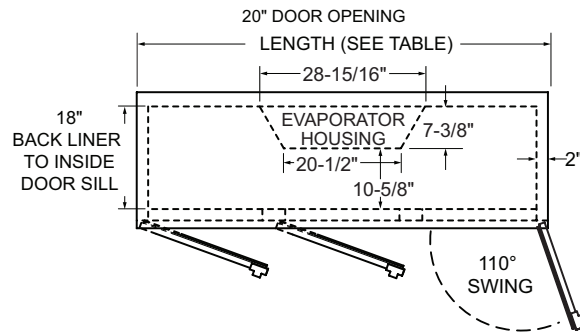
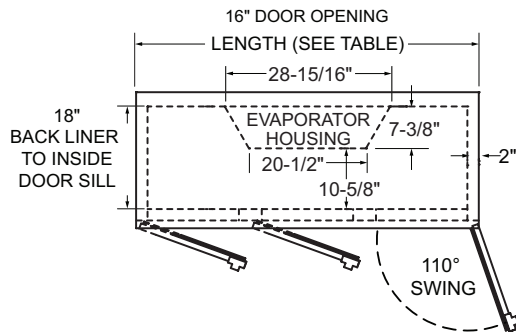

### FRONT VIEWS

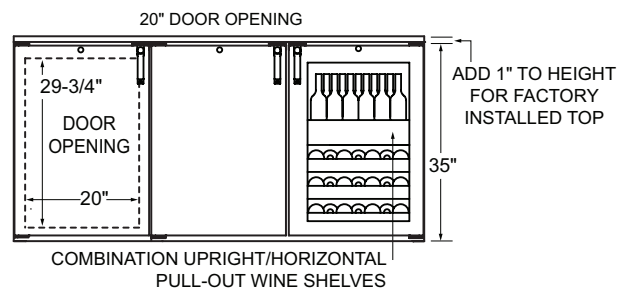
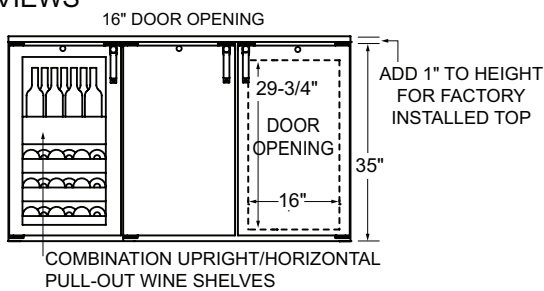

### SIDE VIEWS

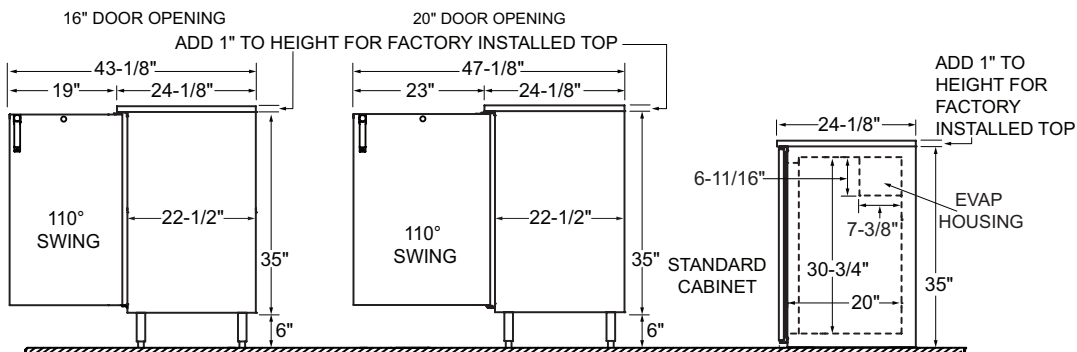

### OPTIONAL LEGS



# Coolers - One Zone, Remote, Bar Profile

## Refrigeration, Plumbing, and Electrical Access Locations

Knockout holes will appear on the side (and back of C1RB24) specified for refrigeration hook-up. The series of knockouts from top to bottom allow installation flexibility to run refrigeration lines, electrical, and drain lines in various locations. There are line covers provided on the interior of the box to cover the lines.

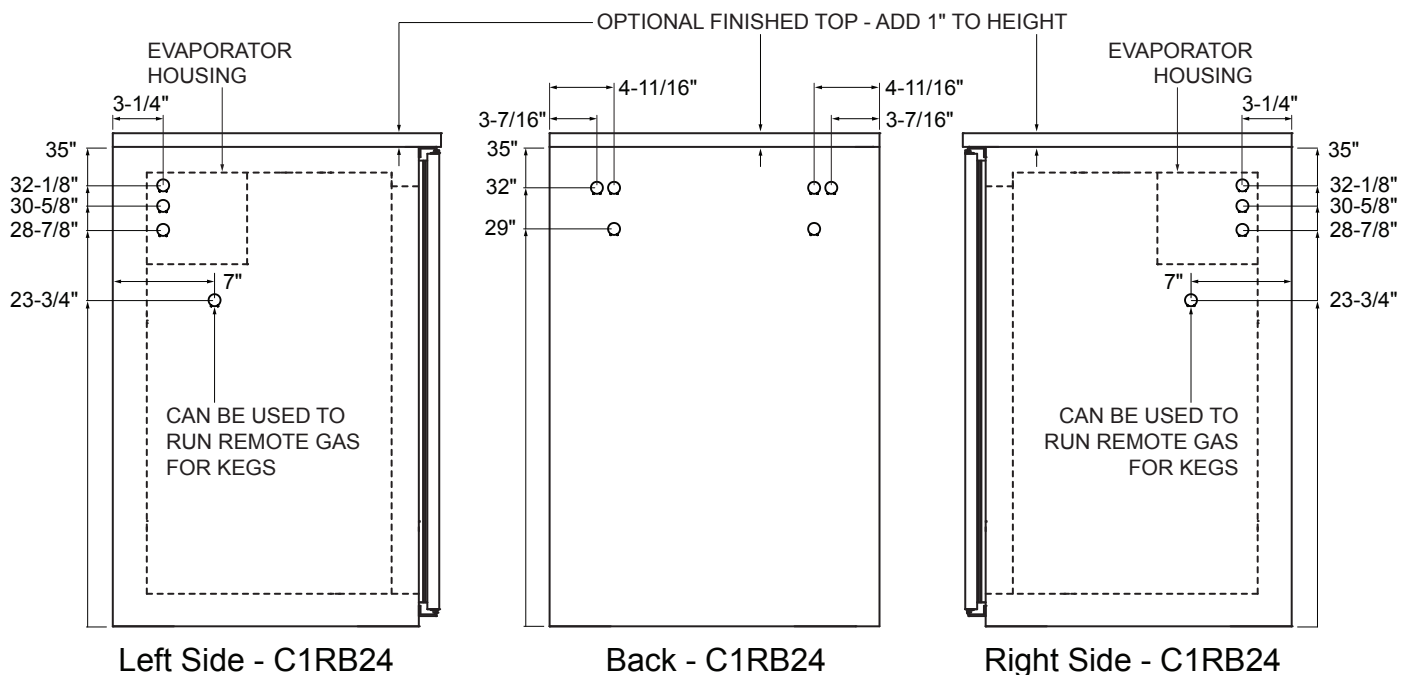
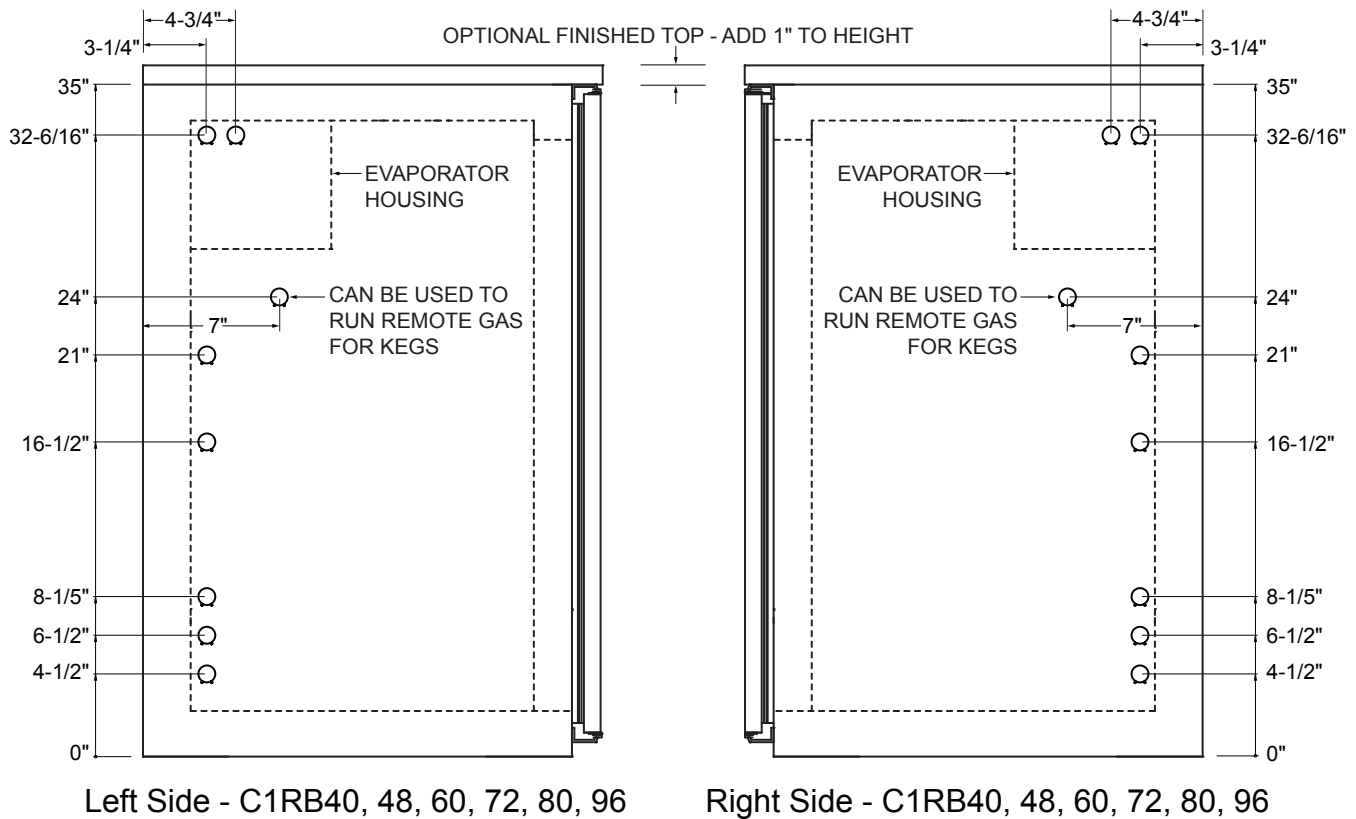

## Configuring Bar Profile Coolers for Draft Beverage Dispensing

All Glastender bar profile coolers can be configured for draft beverage dispensing. Please note that a minimum 17" wide door opening is required for full size (i.e., 16" diameter) 1/2 barrel kegs. Refer to the capacity statements in the Product Directory or Specification Sheet for the sizes and quantities of kegs each unit will hold.

## Direct Draw Draft Beverage Towers

Glastender Beverage Towers come standard with the stainless steel faucets and shanks necessary to dispense keg beer, wine, soda, coffee, or cocktails. See individual spec pages for complete information.

Look for the Draft Beer Compatible logo



CT-3-SS

Column Towers  
See spec page CT for complete information



BT-4-SS

Tee Towers  
See spec page BT for complete information

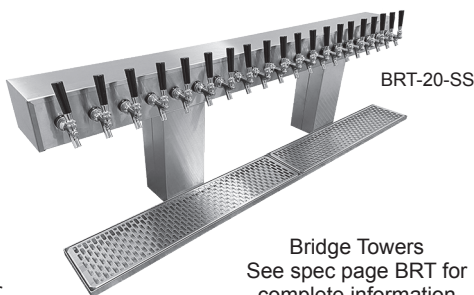

BRT-20-SS

Bridge Towers  
See spec page BRT for complete information



CBT-4-MF

Cobra Towers  
See spec page CBT for complete information

## Tower Cooling Kits

Direct draw beverage towers are chilled by air from inside the host cooler. This is especially important for draft beer, as warm faucets cause the beer to foam.

### TOWER COOLING KITS

MODEL	DESCRIPTION	WGT
TCK12-1	For 1 & 2-door coolers w/ one tower column	3#
TCK12-2	For 1 & 2-door coolers w/ two tower columns	6#
TCK34-1	For 3 & 4-door coolers w/ one tower column	8#
TCK34-2	For 3 & 4-door coolers w/ two tower columns	11#
TCKR-1	For remote coolers w/ one tower column	3#
TCKR-2	For remote coolers w/ two tower columns	6#

### PRIMARY REGULATOR KITS

Primary regulators are used to step down the CO<sub>2</sub> or nitrogen pressure from the main source. A tank mount CO<sub>2</sub> primary regulator attaches directly to the CO<sub>2</sub> tank. A bulk or in-line CO<sub>2</sub> primary regulator is used to splice into a CO<sub>2</sub> line when the CO<sub>2</sub> tank is shared by more than one system. A tank mount nitrogen primary regulator is used with pre-blended nitrogen and CO<sub>2</sub> or pure nitrogen gas. Each primary regulator kit includes 50 feet of nylon braided hose.

MODEL	DESCRIPTION	WGT
PRK-TC	Tank mount CO <sub>2</sub> primary regulator kit	15#
PRK-BC	Bulk CO <sub>2</sub> primary regulator kit	15#
PRK-TN	Tank mount nitrogen primary regulator kit	15#

### SECONDARY REGULATOR KITS

The REG-CO2-LP1 secondary regulator kit is normally mounted inside the direct draw cooler and connects to the gas line coming from the externally mounted primary regulator. For installations with more than one keg on tap, also order the appropriate manifold kit(s). When no external source of CO<sub>2</sub> is available, a 5 pound CO<sub>2</sub> cylinder may be stored inside the cooler, which will require the REG-CO2-HP regulator. A manifold kit will also be required if there is more than one keg on tap.

MODEL	DESCRIPTION	WGT
REG-CO2-LP1	Secondary regulator kit	7#
REG-CO2-HP	Primary regulator kit for use with 5# CO <sub>2</sub> tank	7#
MAN2	Two product manifold kit	2#
MAN3	Three product manifold kit	3#
MAN4	Four product manifold kit	4#
MAN5	Five product manifold kit	5#
MAN6	Six product manifold kit	6#

### ADDITIONAL ACCESSORIES

MODEL	DESCRIPTION	WGT
03004240	1/2" ID black drain line, per foot	N/A
05000400	5/16" ID red vinyl air line, per foot	N/A
05000386	1/4" ID nylon braided air line, per foot	N/A
05001066	Sanke keg tap, stainless steel probe	2#
05001026	Sanke keg tap, low profile	2#
05002019	U system keg coupler w/ss probe for Guinness and Harp	2#
05000368	Lock for beer faucet	2#
05000636	5# CO <sub>2</sub> tank (unfilled)	15#
LCK	Line cleaning kit	
06007084	Drain bottle	

