



**John  
BOOS**  
Since 1887

ITEM #: \_\_\_\_\_ QTY: \_\_\_\_\_

MODEL #: \_\_\_\_\_

PROJECT NAME: \_\_\_\_\_

090319

3601 S. Banker St. Effingham, IL 62401 • P.O. BOX 609 • Ph: (888) 431-2667 • Fax: (800) 433-2667

## "4CD4R5" DRAWER CABINET



### FEATURES:

- 14 GA STAINLESS STEEL FLAT TOP W/FRONT STALLION EDGE
- 18GA TYPE 300 STAINLESS STEEL BASE
- 3 TIER DRAWER (AVAILABLE WITH AND WITHOUT LOCKS)
- REMOVABLE DRAWER PANS
- ADJUSTABLE BULLET FEET
- OVERALL HEIGHT 40-3/4"

### CONSTRUCTION:

- TOP: STAINLESS STEEL TOPS ARE TIG WELDED, EXPOSED WELDS ARE POLISHED TO MATCH ADJACENT SURFACE

### MATERIAL:

- TOP: 14 GAUGE TYPE 300 STAINLESS STEEL
- BASE: 18 GAUGE TYPE 400 STAINLESS STEEL



4CD4R5-3024



### **DRAWER CABINET WITH RISER**

MODEL	QTY
4CD4R5-3024	
4CD4R5-3030	
4CD4R5-3024-L	
4CD4R5-3030-L	

# DETAILED SPECIFICATIONS

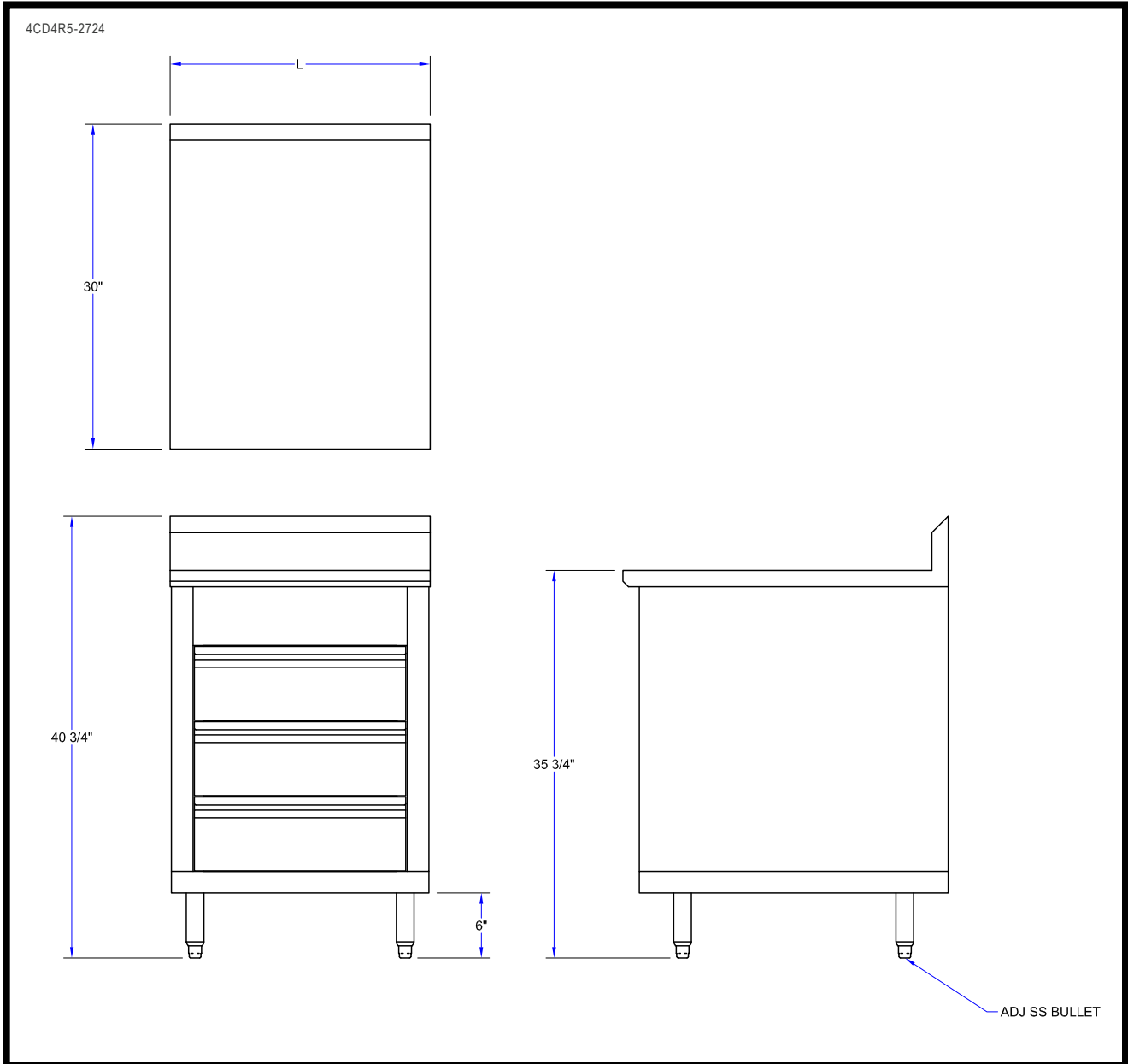

## DRAWER CABINET WITH RISER

MODEL	L	DESCRIPTION	WEIGHT (LBS)
4CD4R5-3024	24"	NO LOCKS	185
4CD4R5-3030	29-1/2"	NO LOCKS	216
4CD4R5-3024-L	24"	WITH LOCKS	185
4CD4R5-3030-L	29-1/2"	WITH LOCKS	216

SOME UNITS SHIP UNASSEMBLED FOR REDUCED SHIPPING COST. ALL DIMENSIONS ARE TYPICAL. TOLERANCE +/- .500"  
 John Boos & Co. is constantly engaged in a program of improving products and therefore reserves the right to change specifications without prior notice.



3601 S. Banker St. • Effingham, IL 62401 • PO BOX 609 • quotes@johnboos.com

022019



[www.johnboos.com](http://www.johnboos.com)

453